



we  clean

User Guide

Vax Careline: AU: 1300 361 505
NZ: 0800 800 900

Carpet Washer

Rapide
carpet washer *Deluxe*



Get Cleaning...

What's your Vax's model number?

8 8 0 0 0

What's your serial number? (Located on the base of the machine)

- - -

Note these down in case you need them in future. Please keep instructions for further use.

Machine Overview

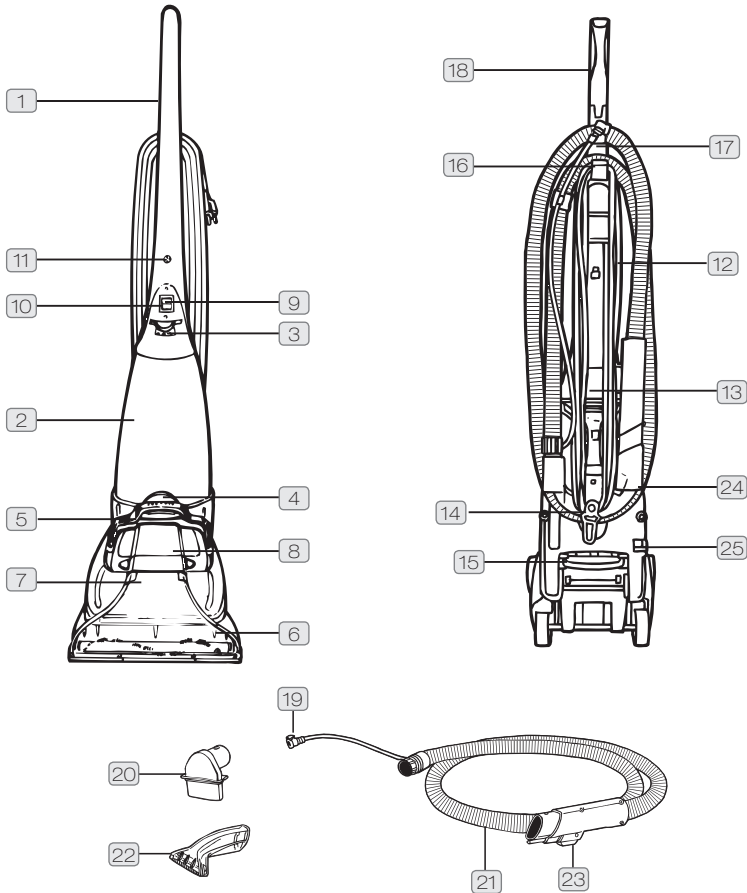

- | | | | | | |
|---|--------------------------------|----|--------------------------|----|------------------------------|
| 1 | Handle | 10 | Brush bar on/off switch | 19 | Upholstery water supply plug |
| 2 | Clean solution reservoir | 11 | Handle screw | 20 | Upholstery hose adaptor |
| 3 | Clean solution reservoir latch | 12 | Power cord | 21 | Upholstery hose |
| 4 | Dirty water tank latch | 13 | Carrying handle | 22 | Upholstery attachment |
| 5 | Dirty water tank handle | 14 | Quick cord release | 23 | Upholstery trigger |
| 6 | Rotating brush bar | 15 | Handle release pedal | 24 | Tool caddy /storage |
| 7 | Dirty water tank | 16 | Cord hook | 25 | Water supply socket |
| 8 | Dirty water tank lid | 17 | Cord clip | | |
| 9 | Vacuum on/off switch | 18 | Solution release trigger | | |

General Safety Information

FOR HOUSE HOLD USE ONLY.

When using the carpet washer, basic safety precautions should always be observed, including the following:

1. Do not leave the carpet washer unattended when plugged in. Unplug it from socket when not in use.
2. To prevent electric shock do not use outdoors.
3. Not to be used as a toy. Children should be supervised to ensure that they do not play with the appliance.
4. This appliance is not intended for use by persons (including children) with reduced physical, sensory or mental capabilities, or lack of experience and knowledge, unless they have been given supervision or instruction concerning the use of the appliance by a person responsible for their safety.
5. Use only as described in this manual.
6. Do not use the carpet washer if it has been dropped, damaged, left outdoors or dropped into water. Do not use the carpet washer with a damaged cord or plug. If the supply cord is damaged, it must be replaced by the manufacturer or a recommended Service Agent to avoid hazard and invalidating the guarantee.
7. Do not pull or carry by cord/hose. Do not use the cord/hose as a handle, close a door on the cord/hose or pull cord/hose around sharp edges or corners. Do not run the carpet washer over the cord/hose. Keep the cord away from heated surfaces.
8. Do not unplug by pulling on the cord.
9. Do not handle the plug or carpet washer with wet hands.
10. Do not put any objects into openings or operate with openings blocked, keep them free of anything that may reduce airflow.
11. Keep hair, loose clothing, fingers and all parts of the body away from openings and moving parts.
12. Do not use the carpet washer on any glowing, burning or smoking particles.
13. Do not use without the solution tank and dirty water tank in place.
14. Turn off all controls before unplugging.
15. Do not use to pick up flammable or combustible liquids such as petrol, or use in areas where they may be present.
16. Keep the unit on the floor.

17. Do not attempt to remove blockages with sharp objects as they may cause damage.
18. Store indoors put away after use to prevent tripping accidents.
19. Using improper voltage may result in damage to the motor and possible injury to the user. The correct voltage is listed on the rating label.
20. A hazard may occur if the carpet washer runs over the power supply cord.
21. To prevent dirty water from running into the motor, do not hold the appliance upside-down or lay on its side. Use appliance in normal cleaning position.
22. Use extra care when cleaning on stairs.
23. Do not carry appliance while motor is running.
24. Use only SAA approved 10 amp extension cords. Non-approved cords may overheat. Care should be taken to arrange the cord so that the cord cannot be tripped over.



WARNING: Always switch off and unplug your machine from the electrical outlet before filling and emptying the clean water tank, emptying the dirty water tank, before assembling, opening, before connecting/disconnecting the attachments, or carrying out maintenance or troubleshooting checks and storage.



NOTE: Carpets should be dry vacuumed thoroughly before washing.



IMPORTANT: If the hose or tools are blocked, switch off and unplug the carpet washer and remove the blockage(s) before re-starting your machine. See maintenance.



IMPORTANT: Cleaning filters maintains cleaning performance. Vax recommends that your filters should be checked and cleaned periodically. If your filters are washable make sure they are completely dry before inserting back into the machine.

This machine is intended for house hold use only, and NOT for commercial or industrial use.

PLEASE KEEP THESE INSTRUCTIONS FOR FURTHER USE.

Operation

Assembling your carpet washer

(Phillips screwdriver required)

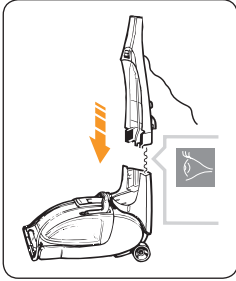

Stand the base in the upright position. Assemble the mid section onto the base, taking care not to trap internal mains wire.

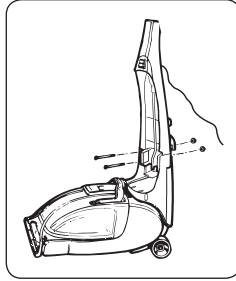

Insert the two nuts into the recesses located on the left and right sides of the base. While holding the nuts in place, insert the two medium length screws through the front of the mid section and tighten.

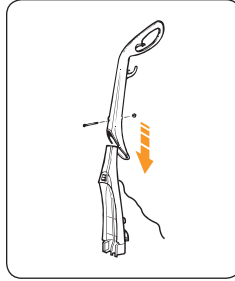

Slide upper handle down onto the unit. Insert nut into the recess in the back of the upper handle. While holding the nut in place, insert the long screw through the front of the upper handle and tighten. Run the mains wire above the upper cord hook and secure with the cord clip.

Tool Caddy Assembly

(Phillips screwdriver required)

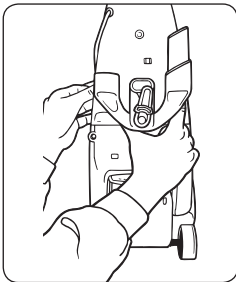

Align tabs on tool caddy with slots on midsection and snap into place.

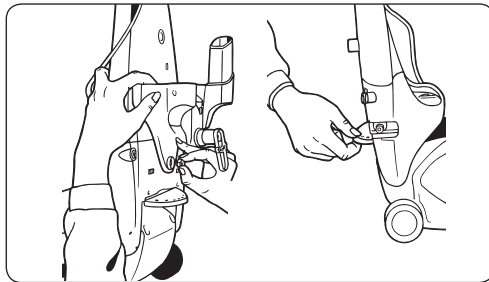

Place nut into recess on tool caddy and hold in place. Press handle release with your other hand to tilt the mid section backwards.

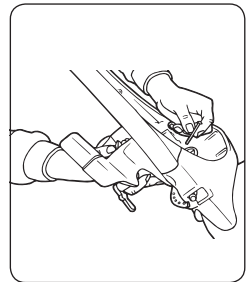

Place screw through centre of lower midsection and tighten.

Operation

Tool Caddy Use

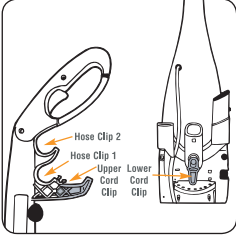

Wrap the cord around the upper and lower cord clips.

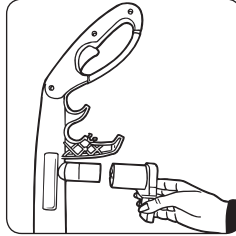

Detach the Upholstery hose adapter from the end of the hose and slide it onto the adapter post.

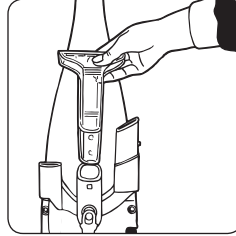

Slide the Upholstery tool into the middle slot of the lower tool caddy.

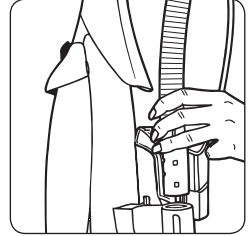

Slide the adapter end of the hose into the left slot on the lower tool caddy. Be sure to line up the pushpin with the slot and press down until secure in place.

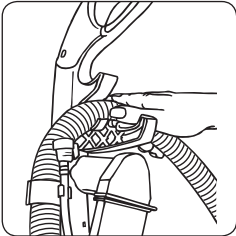

Run the hose to the upper caddy and press into hose clip #1. (See image above for hose clip position.)

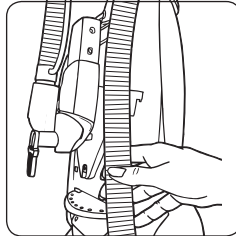

Continue wrapping the hose clockwise around the tool caddies, pressing the hose into the groove on the bottom of the lower tool caddy.

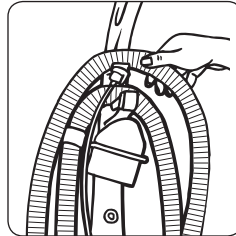

Run the hose back to the upper caddy and press into hose clip #2 (See image above for hose clip positions.)

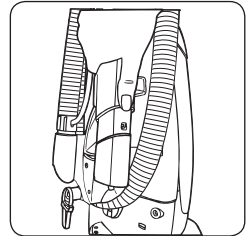

Lock the attachment end of the hose into place by pressing down onto the post located on the right side of the lower tool caddy, until secure in place.

Operation

How to operate your cleaner

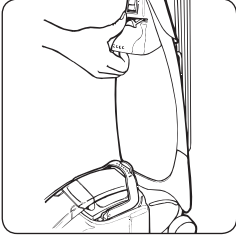

Important: Turn off when emptying and filling the reservoir.

Grasp the solution reservoir under the handle and press the release lever upward.

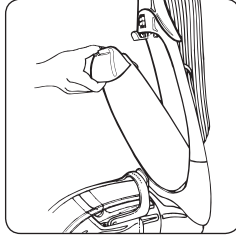

Tilt the solution reservoir away from the cleaner and remove.

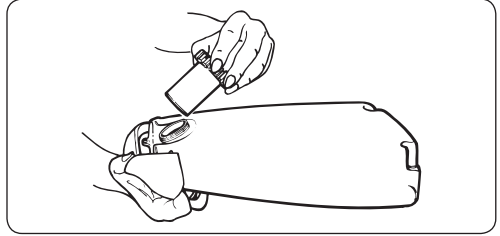

Unscrew the filler/measuring cap from the rear of the solution reservoir. Note: Always use the filler/measuring cap from the reservoir to determine precise solution quantity.

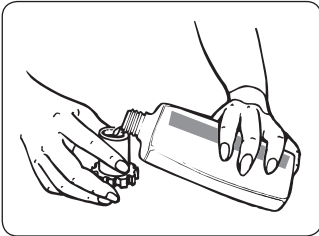

Fill the measuring cap 3 times with VAX AAA carpet cleaning solution and pour into the reservoir. Note: The cleaning solution supplied with your machine is VAX AAA Carpet Cleaner. When replenishing this item, please use VAX Carpet Cleaner, which is available in 1 litre bottles from your VAX stockist.

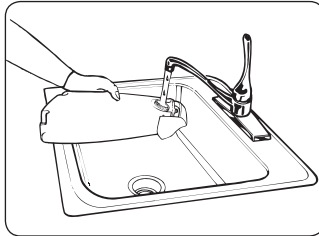

Fill the remaining space in the solution reservoir with tap water. Replace the measuring cap. Note: use only VAX AAA cleaning solution or VAX Carpet Cleaner. Using other cleaning solutions may result in excessive foaming. This may cause the float to shut off the cleaner prematurely. Using other cleaners will void your warranty.

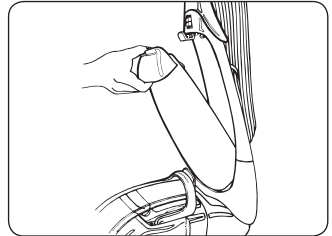

Place the bottom of the solution reservoir into the cleaner and push into place. There will be an audible click when the reservoir is in the correct position.

Operation

How to operate your cleaner continued...

Important: Never leave the cleaner unattended with the power on.

Vacuum carpets thoroughly with dry vacuum cleaner before washing.

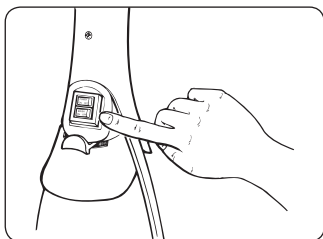

Plug the cord into a mains electricity socket. Turn the power and brush bar switches on. The switches are located on the front of the cleaner, above the solution reservoir. The power switch controls the vacuum motor and pump. The brush switch only turns the rotating brush bar on and off when the power switch is on.

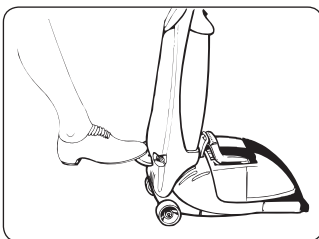

Press on the handle release pedal and pull the cleaner back into a reclined position.



While pressing the solution release trigger, pull the cleaner in a backward motion. Release the trigger and push forward over the same path to remove the dirty water and solution from the carpet. Repeat if necessary. For best results use a smooth steady action - keeping the nozzle flat against the carpet. When the dirty water reaches the max fill line on the dirty water tank, empty the tank.

Operation

Upholstery Cleaning

NOTE: Do not over saturate the upholstery.

IMPORTANT: For best cleaning results use steady, moderate, backward and forward motion.

Make sure upholstery is dry before use.

NOTE: If the hose attachment door is not replaced, there will be no suction through the nozzle and the unit will not operate properly.

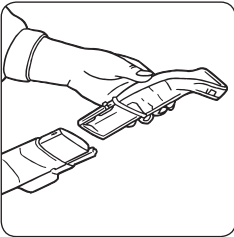

Put cleaner in its upright position. Remove tools from storage caddy. Assemble as shown. Connect the upholstery attachment to the trigger adapter.

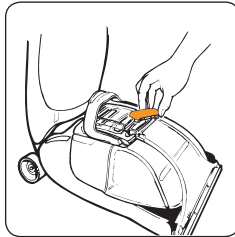

Remove the tank door from the top of the dirty water tank.

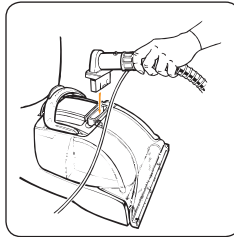

Insert the hose adapter into the top of the dirty water tank.

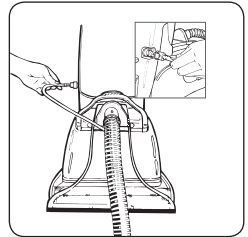

Connect the hose water supply plug into the socket on the lower left side of the cleaner.

Operation

Using the hose attachment

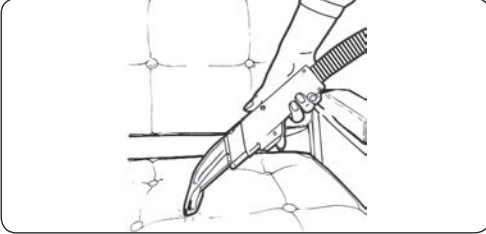

Turn power switch on and brush bar switch off. While depressing the solution spray trigger, pull attachment in backward motion. Release trigger and push attachment forward over the same path to remove dirty water and solution from upholstery. (For heavily soiled areas, repeat if necessary).

Storing tools Carry handle

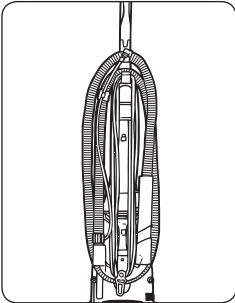

Place hose and upholstery attachments into their storing locations (page 4). Store for next use.



Grasp the handle on the back of the unit to move unit from room to room.

NOTE: DO NOT TRANSPORT THE CARPET WASHER WITH EITHER THE SOLUTION RESERVOIR OR DIRTY WATER TANK FULL.

Maintenance (Keep your Vax as good as new)

! **IMPORTANT:** Do not use the cleaner to pick up flammable or combustible liquids or chemicals. Do not use the cleaner to pick up detergents that contain solvent based ingredients.

! **WARNING:** To reduce the risk of electric shock, turn the machine off and unplug from electrical outlet before performing maintenance/troubleshooting checks..

Emptying the dirty water tank

IMPORTANT: The float in your Rapide is the blue piece in the dirty water tank lid. It will shut off the suction when the dirty water tank is full. However, the float may rise prematurely cutting off the suction before the dirty water tank is full under the following conditions:

1. Using a jerky, uneven motion while washing.
2. Tipping the cleaner and breaking the seal between the carpet and the nozzle on the machine.

Once the float is activated, empty the dirty water tank. If the tank doesn't appear full turn off the power switch and wait for the float to settle.

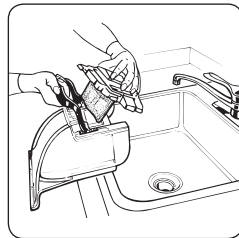
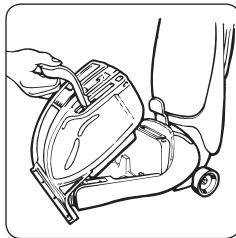
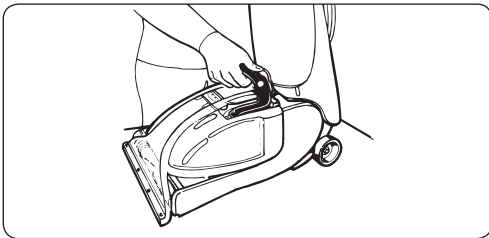

You will hear a distinct change in the noise coming from your cleaner when the tank is full and needs emptying.

Important: Unplug your cleaner before emptying the dirty water tank. Grasp the top of the dirty water tank handle and press the release latch.

Grasp the handle and pull up out of the base. Take care to ensure that dirty water does not leak from the front.

Remove dirty water tank lid.

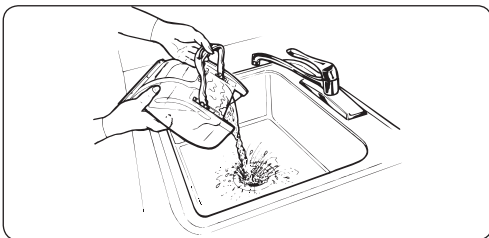

To empty the water tank grasp the handle with one hand and the nozzle with the other and empty into the sink.

Maintenance (Keep your Vax as good as new)

Cleaning the dirty water tank



Rinse the dirty water tank and filter thoroughly with warm water. You should allow them to dry fully before replacing them on your cleaner to prevent mildew.

Do not use any chemicals in the cleaning process.

Replacing the dirt water tank

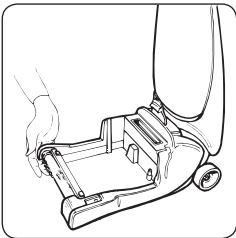

Lift the front of the carpet cleaner base off the carpet with one hand.

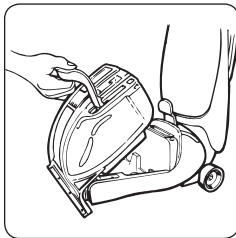

Grasp the handle and hook the front of the dirty water cleaner into the base, making sure that the front of the dirty water tank is resting on the base.

The dirty water tank has three tabs on the underside which **MUST** latch on to the underside of the base of the cleaner. The base must be lifted so that the nozzle is flush with the base of the cleaner.

Failure to install the dirty water tank correctly will result in poor dirty water pick up.

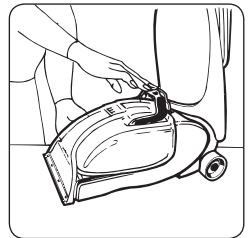

While making sure the dirty water tank is resting on the base, place the rear of the tank into the base of the cleaner, pushdown on the handle until it latches.

Maintenance (Keep your Vax as good as new)

Belt or brush removal and replacement

(Phillips screwdriver required)

The plug must be removed from socket outlet before cleaning or maintaining the appliance.

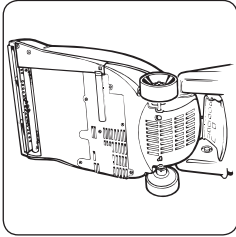

Switch off the mains power and unplug carpet washer. Remove the water tank.

Flip the cleaner on it's side to expose the nozzle base.

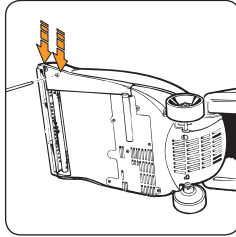

To remove the belt cover, use a phillips screwdriver to remove the two screws.

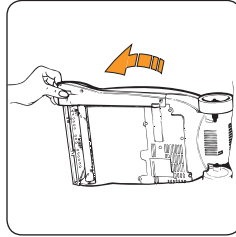

Grasp the belt cover near the belt roll and lift out.

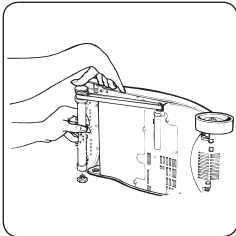

Grasp brush roll with one hand, using the other hand to keep tension on the belt while removing.

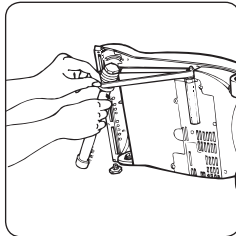

Lift up while your pulling it out.

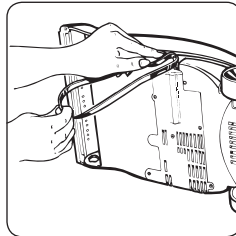

Slide the belt off the motor shaft and dispose.

Maintenance (Keep your Vax as good as new)

Belt or brush removal and replacement continued...

(Phillips screwdriver required)

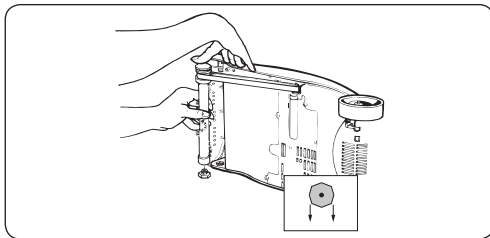

When replacing the belt, first slide it onto the motor shaft. Then slip the brush roll through the belt. Place the belt in the area of the brush without bristles. Slide the brush roll into the nozzle, ensuring that the brush roll end caps are orientated correctly, see inset picture. Manually turn the brush roll to check that it is fitted properly.

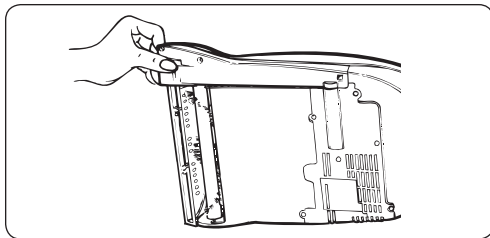

Replace the belt cover by inserting the end furthest from the brush first. Then replace the front of the belt cover before securing in place with the two screws.

FAQ's



WARNING: To reduce the risk of personal injury, unplug the carpet washer before performing maintenance/troubleshooting checks.

Problem	Cause	Solution
Cleaner won't run	Power cord not firmly pushed into a mains socket.	Plug cord in firmly.
	Blown house fuse or tripped circuit breaker.	Check fuse/breaker. Replace fuse or reset breaker.
Vacuum won't pick up/loss of suction	Dirty water tank is not installed correctly.	Refer to page 10 for fitting information.
	Dirty water tank is full.	See 'Emptying the dirty water tank'.
	Broken or worn belt.	Replace the belt.
	Brush roll is worn.	Replace the brush roll.
	Nozzle/dirt passage is clogged.	Remove obstruction.
	Float prematurely activated.	Refer "Important" notes on page 9.
Dust escaping from the Vacuum	Dirty water tank is full.	Empty dirty water tank.
	Dirty water tank is not installed properly.	Refer to page 10 for fitting information.
	Solution reservoir not installed correctly.	See 'How to operate your cleaner'.
Cleaner won't dispense solution	Solution reservoir not installed correctly.	See 'How to operate your cleaner'.
	Solution tank empty.	Fill tank see page 5.



we  to help

Don't take me back to the shop, simply call us

AU: 1300 361 505
 NZ: 0800 800 900 www.vax.com.au

This does not affect your statutory rights

Other Information

Vax Service & Help

Vax Careline:

Australia 1300 361 505

New Zealand 0800 800 900

Monday–Friday 8.30am to 5.00pm

If you have queries or concerns about using your Vax, call the Vax Careline. Calls are charged at the standard local rate. Please make a note of the serial number and model number of the vacuum cleaner before calling.

For the nearest Service Agent, please call the Vax Customer Careline or visit www.vax.com.au

Technical Specification

Voltage: 220-240V ~50Hz

Wattage: 600W

Capacity: Clean water tank: 3.5 Litres
Dirty water tank: 2 Litres

Cord length: 7.5m

Weight: 7.5kg

Filter: Float chamber filter

Subject to technical change without notice.



Double Insulated



N197



Indoor Use



Read Instructions

Manufacturer/EEC importer: Vax Limited, hereby on our own responsibility, declare that the Rapide series is manufactured in compliance with the following Directives:

Safety: 2006/95/EC Low Voltage Directive

EMC: 2004/108/EC Electromagnetic Compatibility Directive



Waste electrical products should not be disposed of with household waste. Please recycle where facilities exist. Check with your Local Authority or retailer for recycling advice.



we  clean

Distributed by Techtronic Industries Pty. Ltd.
Level 1, 660 Doncaster Road, Doncaster, Australia 3108.
www.vax.com.au Service Line: AU: 1300 361 505 / NZ: 0800 800 900