



Model No.: VUM33AS20G  
USER MANUAL

## IMPORTANT SAFETY INSTRUCTIONS

Before operating the appliance for the first time, read these instructions carefully. Please store this user manual for future reference.

1. Include this instruction manual when passing on the appliance to a third party.
2. This appliance is intended for household use only and must only be used indoors.
3. Use the appliance only for its intended purpose. Improper use may lead to hazards.
4. The appliance is only meant for vacuum cleaning of dry particles as stipulated in this instruction manual. Do not use it for other purposes.
5. No liability for any damage that occurs can be accepted in the event of improper use or incorrect handling.
6. Always use the appliance on an even, stable and dry surface.
7. To prevent damages and injuries use only original accessories or the ones recommended by the manufacturer.
8. Danger of suffocation! Keep all packaging materials away from children.
9. This appliance is not to be used by persons (including children) with reduced physical, sensory or mental capabilities, or lack of experience and knowledge, unless they have been given supervision or instructions concerning use of the appliance by a person responsible for their safety.
10. Children should be supervised to ensure that they do not play with the appliance.
11. Do not leave the appliance unattended when in use.
12. Protect the appliance against heat, dust, direct sunlight, moisture, dripping and splashing water. If the appliance is humid or wet, unplug it immediately.
13. Keep the appliance, power cord and plug away from flames or hot areas (e.g. ovens, hot gas or electric burners and other heat-producing appliances/ objects).
14. Do not insert any object into the appliance.
15. Before cleaning or storing the appliances, switch it off and always pull the plug from the socket (pull the plug, not the

cable). Remove all attached accessories before cleaning or storing the appliance.

16. Do not immerse the appliance, power cord or plug in water or any other liquids.
17. Never touch the appliance, power cord or plug with wet or damp hands.
18. Before you connect the appliance to the mains supply, ensure that the voltage on the rating label is the same as in your home.
19. Always unplug from the mains supply when not in use and before cleaning.
20. Do not operate the appliance if damaged or after the appliance malfunctions.
21. Any extension cable must be suitable for the appropriate power output being used.
22. Do not damage the power cord by pinching or by contact with sharp edges.
23. Check the appliance and the power cord regularly for possible damages. Should there be any signs that the cord is damaged in the slightest degree, do not use the appliance. Do not attempt to repair the appliance by yourself.
24. If the power cord is damaged, it must be replaced by a qualified electrician in order to avoid a hazard or the appliance must be disposed of.
25. Always carry the appliance by the carrying handle, never by the suction hose or cord.
26. Only use the accessories provided with the appliance.
27. Prior to using the appliance, make sure that the surface is free from pointed or sharp objects or large items. Otherwise, the appliance may be damaged.
28. Never use the appliance without the filters in place!
29. Do not suck up liquids!
30. Do not suck up hot ashes or pointed and/or sharp objects!
31. Check that the filters are inserted correctly!
32. Do empty the Dust Bin regularly for optimal operation of the vacuum.
33. Keep hair, clothing and body parts away from the vacuum nozzle during use!
34. Keep the appliance away from source of heat like radiators, oven, etc.!

GETTING TO KNOW YOUR CLEANER

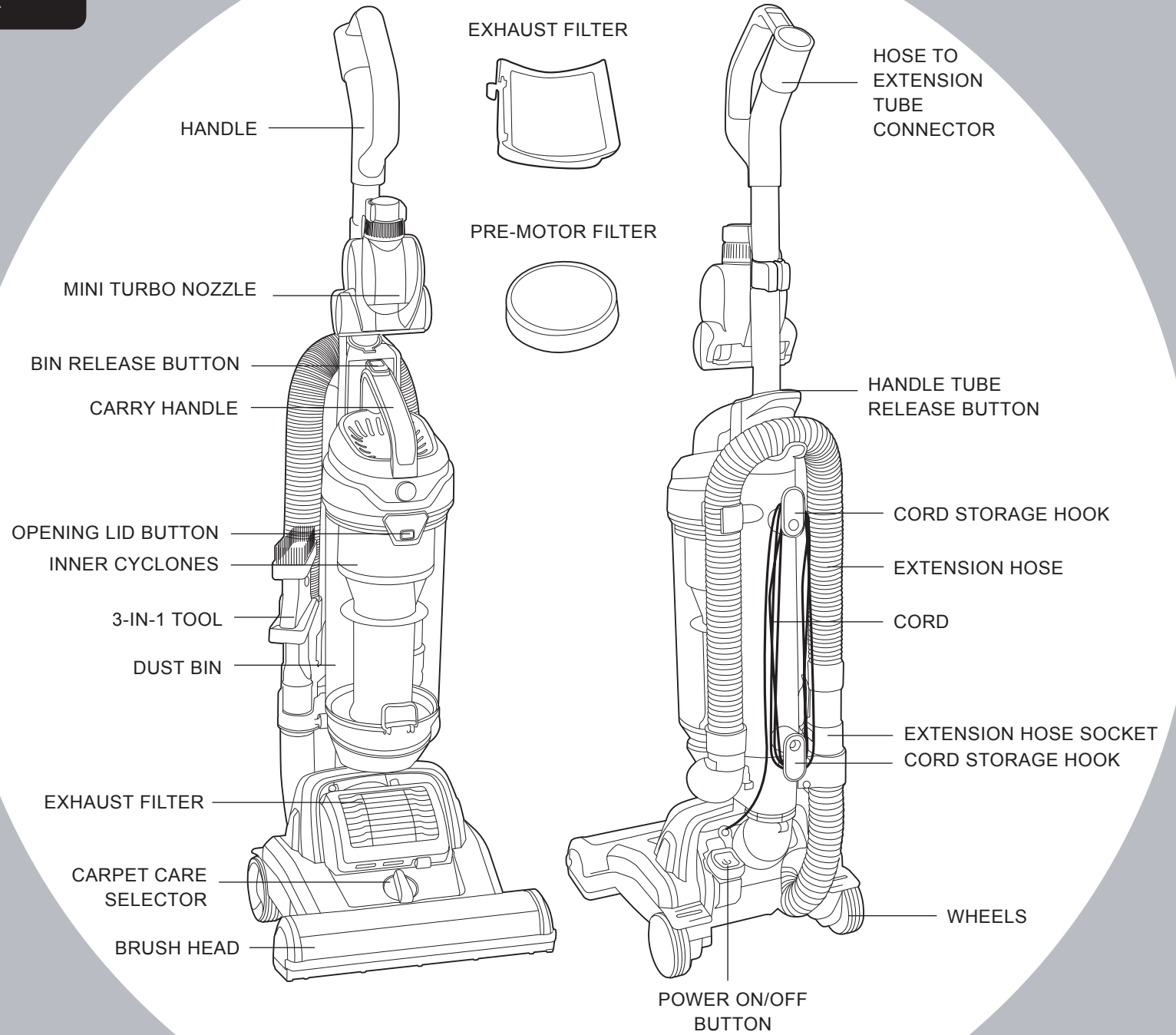

## PREPARING YOUR CLEANER

Insert the main handle in the cleaner body.

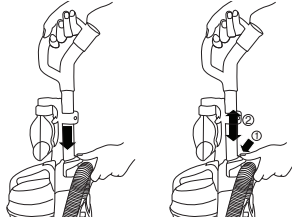

## SUPPLY CORD

Do not run over the supply cord.

Clip the supply cord in the cord clip at the back of the handle to avoid accidentally running the cleaner over the cord and causing any damage.



## MINI TURBO BRUSH ASSEMBLY

Put the mini turbo nozzle onto the holder.

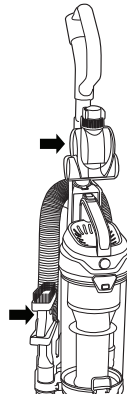

Put 3-in-1 tool onto storage area.

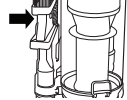

## POWER SWITCH

Plug in your machine and turn it on.

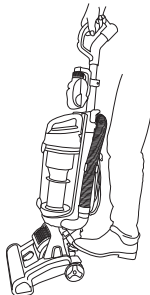

## CARPET CARE CONTROL SELECTOR

The carpet care control selector raises and lowers the height of the brush head.

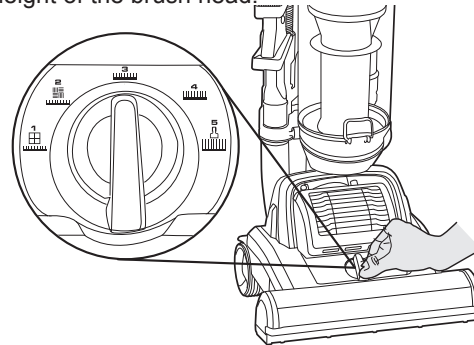

Ensure that the cleaner is in the upright (parked) position and move the selector to the required setting for the carpet type or floor covering.

To obtain the best performance it is recommended that the adjustment setting position 1 is used for the main cleaning operations. The other adjustment settings are for ease of use, use on longer pile carpets, or for specialist cleaning tasks.

### Settings

1. Short to medium pile carpets, hard wooden floors, wooden floor boards with crevices, ceramic tiles.
2. Medium pile carpets, delicate floor coverings such as vinyl or linoleum, parquet flooring.
- 3 or 4. For longer pile carpets the motion resistance may increase. Use these intermediate settings to reduce the force required to push the vacuum cleaner.
5. Long pile carpets, deep scatter rugs.

**Important:** Using this cleaner for loop pile carpets with pile greater than 30mm is not recommended. Please consult the floorcare/carpet manufacturer's recommended cleaning instruction before vacuuming.

**Important:** When cleaning delicate hard floors such as vinyl or linoleum the selector switch must be moved to position 2. Failure to do so may cause damage to the floor surface.

## CLEANER RELEASE

Press your foot lightly on the brush head and pull the cleaner backwards to recline.

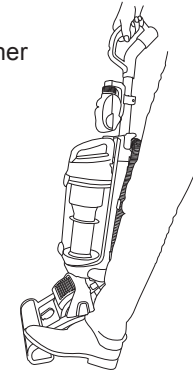

Twist the handle to manoeuvre under or around furniture.

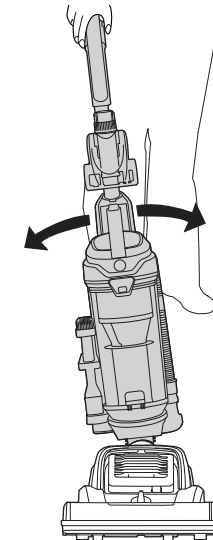



## CLEANING TOOLS

### Handle

All accessories can fit onto the end of the hose, and handle tube. Combine accessories depending on use.

### Mini Turbo Nozzle

The Mini turbo nozzle is ideal for removing pet hairs.  
DO NOT touch the rotating brush.

### 3-in-1 tool

a- dusting brush

b- crevice tool

press the button to release the brush and reveal the crevice tool

c- upholstery nozzle

turn brush upside down and attach to the crevice tool to use the upholstery nozzle

### Connecting Accessory to Hose

- 1 Pull out the hose connector from the extension hose socket.
- 2 Choose your accessory.
- 3 Connecting accessory to hose.

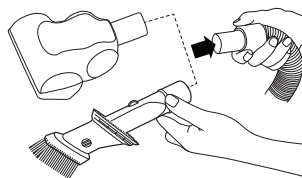
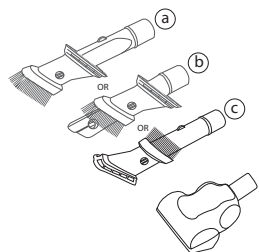
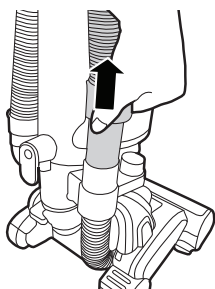

- 1 Remove handle tube.
- 2 Insert hose connector to the handle tube, then rotate hose connector to lock.
- 3 Connect accessory to the handle tube.

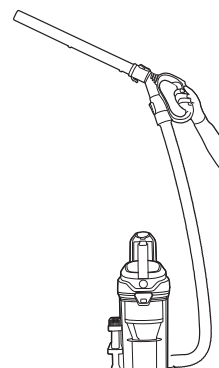
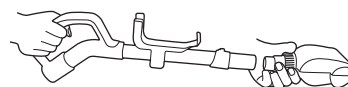
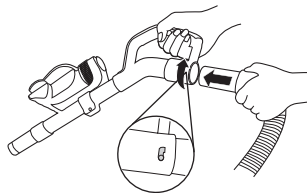
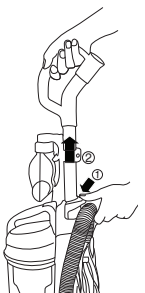

**IMPORTANT!** When using the cleaning tools please remember the vacuum cleaner has a constantly rotating agitator brushbar. So please ensure that the cleaner is in the upright position with the height control set to the maximum  and you hold the unit when using the cleaning accessories.

## CLEANING THE STAIRS

It is dangerous to place the cleaner above you when cleaning stairs.

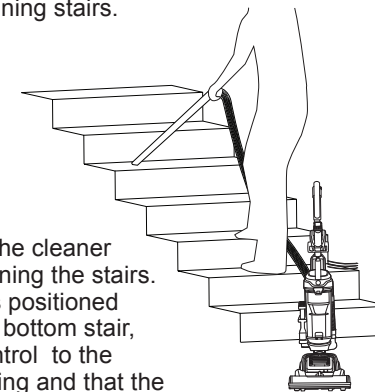

ALWAYS work with the cleaner below you when cleaning the stairs. Ensure the cleaner is positioned tightly up against the bottom stair, setting the height control to the maximum height setting and that the cleaning is being carried out safe manner with no risk to others .

## STORING THE CLEANER

Turn the cleaner off and remove the plug. Wind the power cord around the cord storage hooks.

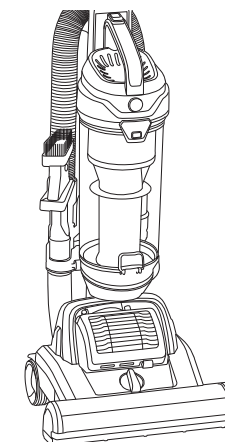

## EMPTYING THE DUST BIN

**! IMPORTANT:** Before emptying the bin, make sure vacuum cleaner has been switched off.

- 1 To remove the bin from the cleaner press the bin release button.

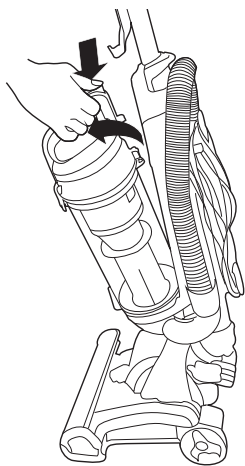

- 2 Hold the dust bin and press the easy open button.

The bin door will open and you can empty the bin with no dust contact.

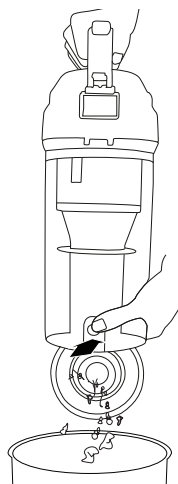

- 3 Once emptied, gently tap or shake the dust bin to release any excess dust.

**NOTE:** The Dust Bin must always be emptied when the dirt level reaches the "MAX" line.

## CLEANING THE PRE MOTOR FILTERS

- 1 Rotate the upper part of the dust bin to open.

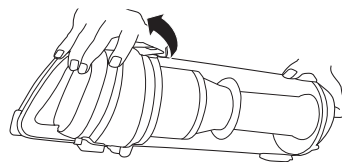

- 3 Gently tap the filter to release any excess dust.

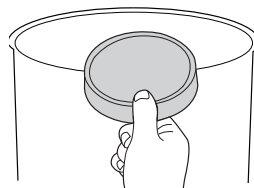

- 2 Take out the pre-motor filter.



- 4 Wash the pre-motor filter under warm water until the water runs clean. Remove excess water by shaking and leave to dry for 24 hours. Reassemble and refit filters to cleaner, only when they are completely dry.

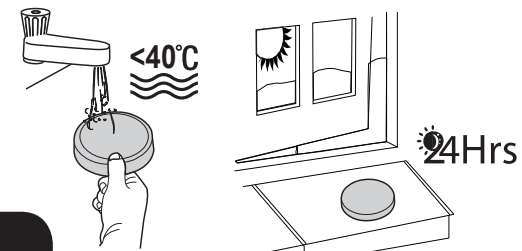

**! IMPORTANT!** Ensure the pre-motor filter and exhaust filters are reassembled to the cleaner before use.

## CLEANING THE EXHAUST FILTER

The exhaust filter should be washed every month. Remove the exhaust filter from your cleaner by sliding the lock switch to left. Gently tap the filter until no more dust can be seen falling out. Wash the HEPA filter under warm water until water runs clean.

Remove excess water by shaking and leave to dry for 24 hours. Refit filters only when completely dry.

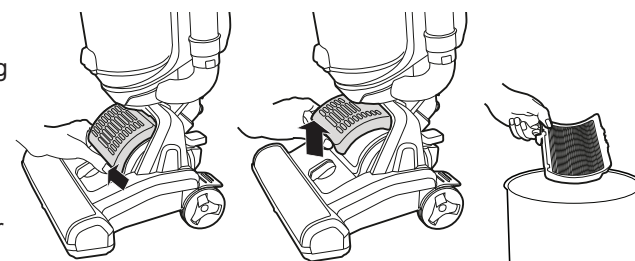

## CLEANING THE SEPARATION SYSTEM

- 1 Lift latch to open the bin lid and access the pre-motor filter.

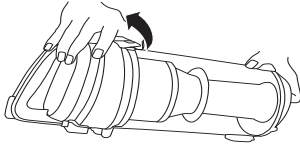

- 2 Take out the pre-motor filter.

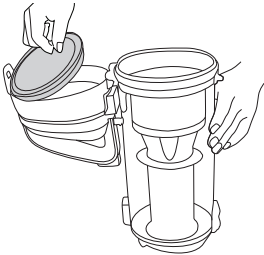

- 3 Pull the separation system out of the bin.

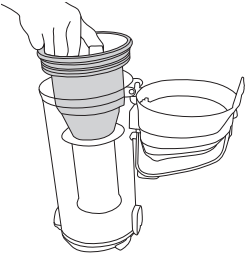

- 4 Clean the separation system with a dry cloth or dusting brush. Once clean reassemble and refit to the cleaner.

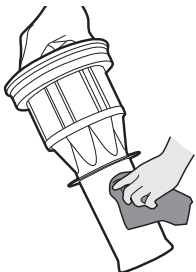

## CHANGING THE BELT

If your cleaner is not picking up efficiently, the belt or brushes (or both) may need replacing, but first please make sure you have:

- Emptied the bin
- Cleaned the filters
- Checked for blockages



**IMPORTANT:** Switch the cleaner off and remove the plug from the electricity supply before attempting any maintenance.

- 1 Turn the cleaner over and remove 7 retaining screws.

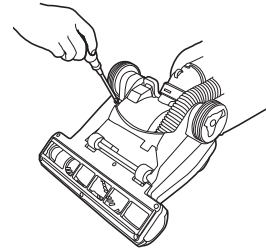

- 2 Remove the brush guard.

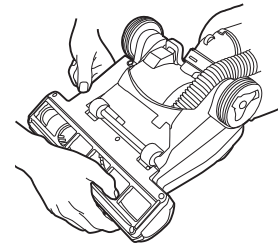

- 3 Remove brush assembly and check for wear on the belt. Loop the new belt around the motor and brush channel.

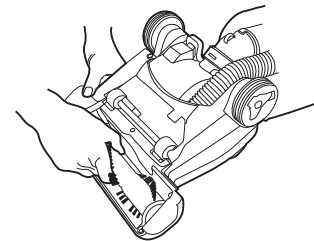

- 4 Hold the brush assembly and stretch the belt until the brush can be slotted back into the cleaner housing.

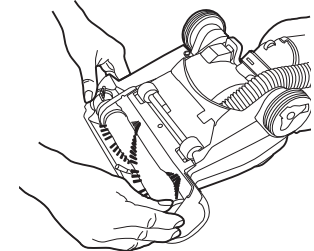

- 5 Rotate the brush to ensure free movement of the belt.

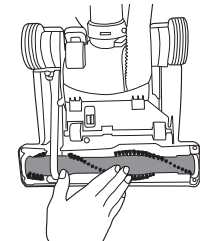

- 6 Refit the brush guard with 7 retaining screws

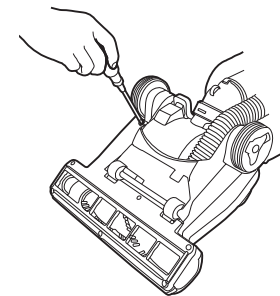

## CLEARING A BLOCKAGE

**NOTE:** If the brush is blocked and has stopped rotating, switch off and remove the plug from the electricity supply, then use a pair of scissors to cut through any threads or hairs caught around the brush. Reassemble the brush and brush guard.

**!** **IMPORTANT:** Switch the cleaner off and remove the plug from the electricity supply before attempting any maintenance.

Check the cleaning tools and hose for blockages.

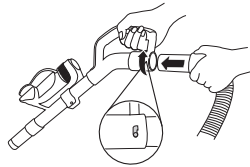

The hose can be removed at both ends.  
Use a flexible rod to remove any obstruction.

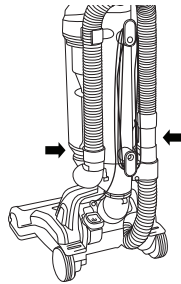

Turn the cleaner over and rotate the brushes to identify any obstructions including hair.

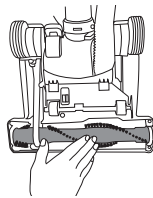

Remove a blockage from the mini turbo nozzle.  
Open the nozzle by rotating the lock ring, lift cover and remove the blockage.

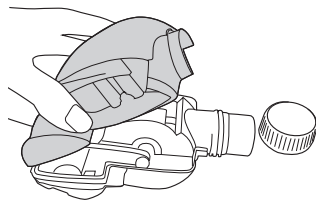



## User checklist

If your cleaner is not working properly run through the following checklist.

1. Is there a working electricity supply to the cleaner?  
*Check with another electrical product.*
2. Is the bin full or choked with fine dust?  
*To empty the bin, see the User Manual on P6.*
3. Is the hose blocked?  
*To clear a blockage, see the User Manual on P8.*
4. Is there a blockage in the cleaner base?  
*To clear a blockage, see the User Manual on P8.*
5. Are the filters blocked?  
*To clean filters, see the the User Manual on P6.*
6. Are the brushes rotating correctly?  
*To check the brushes, see the User Manual on P8.*
7. Has the cleaner overheated?  
*If so, it will take about 45 minutes to reset.*

## WARNING!

A thermal cut out switches off the cleaner to prevent overheating if it is used when full or there is a blockage or dirty filters. If this should happen switch off, unplug and correct the fault.

It will take about 45 minutes for the cut out to automatically reset.

**IMPORTANT:** Do not run cleaner over the supply cord as this could damage the supply cord insulation.

## 12 Month Warranty

Thank you for your purchase from Kmart.

Kmart Australia Ltd warrants your new product to be free from defects in materials and workmanship for the period stated above, from the date of purchase, provided that the product is used in accordance with accompanying recommendations or instructions where provided. This warranty is in addition to your rights under the Australian Consumer Law.

Kmart will provide you with your choice of a refund, repair or exchange (where possible) for this product if it becomes defective within the warranty period. Kmart will bear the reasonable expense of claiming the warranty. This warranty will no longer apply where the defect is a result of alteration, accident, misuse, abuse or neglect.

Please retain your receipt as proof of purchase and contact our Customer Service Centre on 1800 124 125 (Australia) or 0800 945 995 (New Zealand) or alternatively, via Customer Help at [Kmart.com.au](http://Kmart.com.au) for any difficulties with your product. Warranty claims and claims for expense incurred in returning this product can be addressed to our Customer Service Centre at 690 Springvale Rd, Mulgrave Vic 3170.

Our goods come with guarantees that cannot be excluded under the Australian Consumer Law. You are entitled to a replacement or refund for a major failure and compensation for any other reasonably foreseeable loss or damage. You are also entitled to have the goods repaired or replaced if the goods fail to be of acceptable quality and the failure does not amount to a major failure.

For New Zealand customers, this warranty is in addition to statutory rights observed under New Zealand legislation.

