

vax

Ultra Pro Powerhead VACUUM CLEANER

**CYCLONIC
BARREL
VACUUM**



LET'S GET STARTED.

2 YEAR WARRANTY

VX59

vax.com.au
vax.co.nz

Let's talk safety



Basic safety precautions

This vacuum cleaner is intended for household use only and NOT for commercial or industrial use.

READ ALL THE INSTRUCTIONS BEFORE USING THIS APPLIANCE

- Only use the vacuum cleaner indoors and keep the area you're cleaning well lit.
- Keep fingers, hair and loose clothing from moving parts and openings whilst using the vacuum cleaner.
- This appliance is not intended for use by persons (including children) with reduced physical, sensory or mental capabilities or lack of experience and knowledge unless they have been given supervision or instruction concerning use of the appliance by a person responsible for their safety.
Children should not play with the vacuum cleaner. Cleaning and user maintenance should not be made by children without supervision



Don'ts

- Do not pull or carry by cord, use cord as a handle, close a door on cord, or pull cord around sharp edges or corners. Do not place product on cord. Do not run appliance on cord.
- Don't handle the plug or use the vacuum cleaner with wet hands.
- Don't use the vacuum cleaner with incorrect voltage as this may result in damage or injury to the user. The correct voltage is listed on the rating label.
- Don't vacuum up hot coals, cigarette butts, ash, matches or smoking hot burning items or use in an area where there may be harmful fluids (chlorine, bleach, and ammonia drain cleaner).



Do's

- Always make sure the filter and dirt container are fitted correctly before using your vacuum cleaner.
- Turn off all controls on the vacuum cleaner before disconnecting or connecting the battery.
- Take extra care when cleaning on the stairs.
- Always switch off the vacuum cleaner before disconnecting or connecting the hose and accessories.
- Always protect the charger cord from heated surfaces or near open flames.

- Only Vax recommend tools and accessories should be used with this vacuum cleaner
- Vax recommends the use of a Residual Current Device rating of 30 mA or less.
- If the supply cord is damaged, it must be replaced by the manufacturer, or similarly qualified person in order to avoid a hazard, or invalidating the warranty.
- **CAUTION:** The hose contains electrical connections:
 - Do not use to suck up water
 - Do not immerse in water for cleaning
 - The hose should be checked regularly and must not be used if damaged
- **IMPORTANT:** The motor is equipped with a thermal cut-out. If for any reason the unit should overheat, the thermostat will automatically turn the unit off. Should this occur, unplug the vacuum cleaner from the electrical outlet and turn off the switch. Remove dirt container and empty. Clean filters. Allow the unit to cool for approximately one (1) hour. To re-start, plug into an electrical outlet and switch back on.

- Don't attempt to remove blockages with sharp objects as this may cause damage to the vacuum cleaner.
- Do not vacuum hard or sharp objects such as glass, nails, screws or coins etc.
- Do not vacuum plaster dust, concrete dust or any other building or vitreous material.
- Do not vacuum flour, baking soda or any other powder-based carpet refresher or deodoriser.
- Don't use this vacuum cleaner if it has been dropped, damaged or left outdoors.
- Don't vacuum up any flammable or combustible materials (lighter fluid, petrol, kerosene etc.) or use the vacuum cleaner in an area with explosive vapours or liquid.

- Use only SAA approved 10amp extension cords. Care should be taken to arrange the extension cord as it can be a trip hazard.
- Always carry the vacuum cleaner by the handle.
- Store your vacuum cleaner in a cool, dry area.
- Always keep the power cord away from the brushes whilst using your vacuum cleaner.

PLEASE KEEP INSTRUCTIONS FOR FURTHER USE.

Thank you for buying this Vax Ultra Pro Powerhead.

Taking care of your carpets and hard floors

The Vax Ultra Pro Powerhead is designed to make vacuuming carpets and hard floors regularly as effective and efficient as possible and this user guide will help you get the most out of your machine. Maintaining your carpets will ensure they keep their appearance for longer. You've chosen the carpets and hard floors for your home for a reason and Vax will help you take good care of them.

Taking care of your Vax Ultra Pro Powerhead

Also inside this guide are instructions on maintaining your new machine, so that it's always ready when you are to tackle your carpets and hard floors.

We're here if you need us

For troubleshooting simply visit or call:

Australia: 1300 361 505*
vax.com.au

New Zealand: 0800 800 900*
vax.co.nz

The Vax logo is displayed in a bold, orange, sans-serif font. The letters 'v' and 'a' are lowercase, while 'x' is uppercase. A registered trademark symbol (®) is located at the top right of the 'x'.

*Monday – Friday: 8:30am -5:00pm

Calls are charged at the standard local rate. Please make note of the serial number and model number of the product before calling.

Contents

Vax Performance

Let's talk safety

Getting to know your machine

Getting started

Using your machine

Taking care of your machine

What to do if it goes wrong

Getting in touch

Accessories

Notes

Included with your machine



Hose and handle



3 in 1 tool

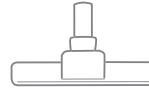

Hard floor brush



Telescopic extension wand

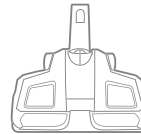

Motorised powerhead

Filters

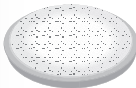

Pre-motor filter



HEPA post-motor filter

Getting to know your machine

Carry handle

Dirt container

Cyclone separator and shroud

Hose connector

Dirt bin release button

Cord rewind button

On/off button

Floor head parking slot

Wheel

Technical Specification

Name **Vax Ultra Pro Powerhead**

Voltage **220-240V ~ 50Hz**

Wattage **1500W**

Cord length **6m**

Weight **5.9kg**



Double Insulated



The product meets applicable regulatory requirements



Indoor Use



Read Instructions

Motorised Powerhead Specifications

Rated Voltage **220-240V ~ 50Hz**

Rated Input Power **120W**

Model Number **HW-PO6**

Accessories & Consumables

Filter pack*
VWCF

PLEASE READ 'LET'S TALK SAFETY' AT THE BEGINNING BEFORE USE

CAUTION: Always switch off the vacuum cleaner before connecting or disconnecting the hose/attachments, or removing and emptying the dirt container.

Keep you Vax like new

IMPORTANT: The condition of the filters affects the performance of your machine. Please check, clean and replace filters periodically (depending on the level of use). For full cleaning instructions, see "Cleaning the pre-motor filter" and "Cleaning the post-motor filter".

IMPORTANT: Do not use the vacuum cleaner with blocked filters and without all of the filters in place.

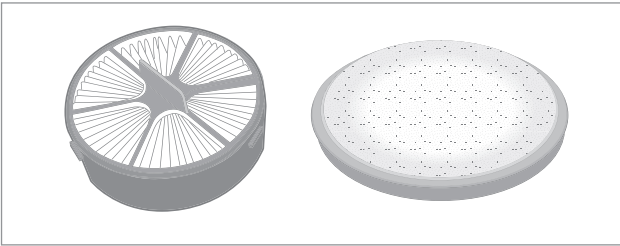

Connect Hose

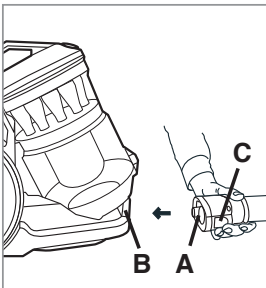

Push Hose Connector end (A) into opening (B) on front of cleaner.
To disconnect hose from cleaner, press release buttons (C) on sides of Hose Connector and pull out.

WARNING: Always turn off this appliance before connecting hose.

IMPORTANT: The flexible hose contains electrical wires for connection to the Power Nozzle and should not be used if damaged, cut, punctured, or wires are exposed.

Getting started

Connect wand

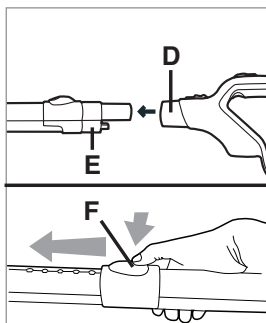

Push Hand Grip (D) firmly into end of Wand (E) until Latch clicks. Push button (F) on wand to utilize telescopic feature. To remove Wand from Hose, press on Wand Release Button on end of Wand and pull apart.

Connect nozzle

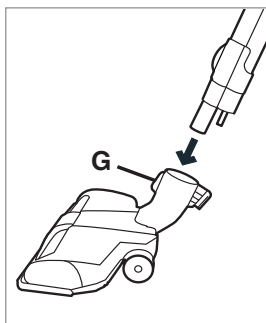

Push the opposite end of Wand firmly into Power Nozzle. To remove, press on Nozzle Release Button (G) and pull wand out to disconnect from nozzle.

WARNING: Always turn off this appliance before connecting Power Nozzle.

Cord release

Grasp the end of the plug and pull to release cord from cord reel.

WARNING: When pulling on the cord, yellow tape will identify when the cord is almost fully extended. When red tape is visible on the cord, the cord has reached its full length. (Do not pull the cord past the red tape.)

Carry handle

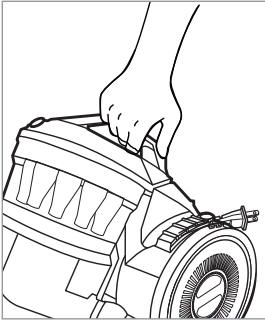

Use the carry handle located on the top of the canister to move the vacuum cleaner from room to room.

On-Off switch

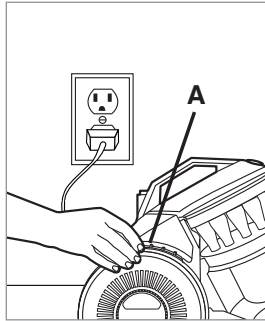

Insert the plug into the electrical outlet. Press the on/off pedal (A) on back of canister, to switch the cleaner on and press pedal again to turn the cleaner off.

Stair cleaning

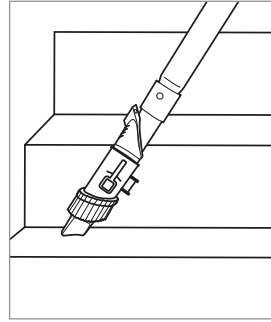

Clean stairs from bottom to top.

CAUTION: Use extra care when cleaning on stairs.

To avoid personal injury or damage, and to prevent the cleaner from falling, always place cleaner at bottom of stairs or on floor. Do not place cleaner on stairs or furniture, as it may result in injury or damage.

Using your machine

Floor surface selector

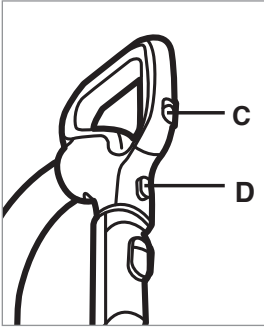

Carpet, Rug or Hard Floor Cleaning

Push brushroll button (C) to turn brushroll On and Off.

Brushroll on: Vacuums carpets.

Brushroll off: Vacuums hard floors.

Selector proper tool

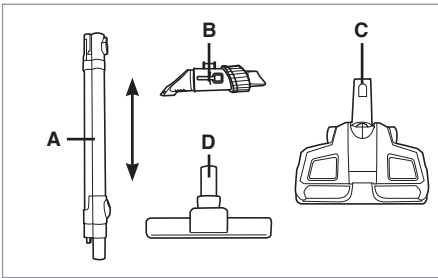

CAUTION: Not to be used for grooming a pet.

Variable Suction

Slide the Variable power slider (D) to close for maximum suction; open if power nozzle is difficult to push on some carpets or if lightweight rugs or draperies are being cleaned.

3-in-1 Combination Tool

Simply push the attachment firmly on the end of the wand or hose end. To remove tool, twist and pull apart gently and return to storage.

A. Telescoping Extension Wand: The telescoping extension wand can be lengthened or shortened by pushing the button in and sliding the wand apart or together as required.

B. 3 in 1 Combination Tool: Push lock button in to release dusting brush and slide down to revert to crevice mode. Crevice Tool may be used in tight spaces, corners and along edges in such places as dresser drawers, upholstered furniture, stairs and baseboards.

Dusting Brush may be used for furniture, table tops, books, lamps, lighting fixtures, venetian blinds, baseboards, shutters, and registers.

Furniture Nozzle may be used for upholstered furniture, draperies, mattresses, clothing, and carpeted stairs.

C. Motorised Powerhead: May be used for carpets, rugs and hard floor surfaces.

Brushroll on: Vacuums carpets.

Brushroll off: Vacuums hard floors.

D. Hard Floor Tool: Use hard floor tool to vacuum hardwood, laminate and ceramic floors.

Attaching tools

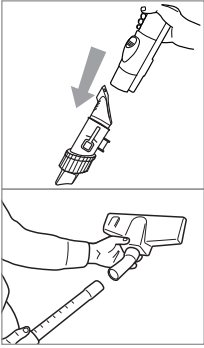

Tools may be attached directly to the hand grip or to the telescoping wand. Firmly push tool into the hand grip or wand. Twist tool slightly to tighten or loosen connection.

Cord rewind/storage

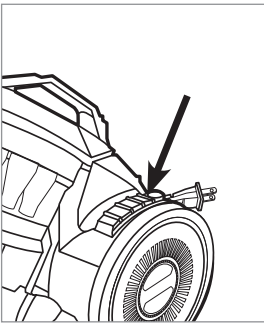

To return cord for storage, unplug from wall hold plug and press down Cord Release Pedal.

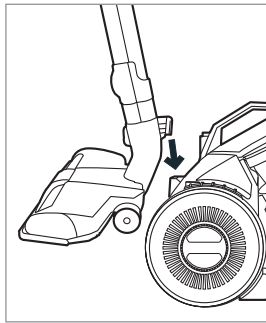

For convenience there is a parking slot located at the rear of the vacuum cleaner where the floor tool and hose can be parked for carrying and storage.

WARNING: Hold plug when rewinding onto cord reel. Do not allow plug to whip when rewinding.

Taking care of your machine

Cleaning the pre-motor filter

Familiarise yourself with these home maintenance tasks as proper use and care of your cleaner will ensure continued cleaning effectiveness.

Any other servicing should be done by an authorized service representative.

If appliance is not working as it should, has been dropped, damaged, left outdoors, or dropped into water, take it to a service center prior to continuing use.

IMPORTANT

An Auto Reset Thermal Protector has been designed into your cleaner to protect it from overheating. When the Auto Reset Thermal Protector activates the cleaner suction motor will stop running.

If the vacuum stops running proceed as follows:

1. Turn cleaner OFF and unplug it from the electrical outlet. *IMPORTANT: If left plugged in and turned on, the cleaner suction motor may restart unexpectedly.
2. Empty dirt cup.
3. Inspect the nozzle inlet, nozzle connector, hose connector, hose, wand, primary filter and HEPA filter. Clear obstructions if present.
4. When cleaner is unplugged and motor cools for 30 minutes, the Auto Reset Thermal Protector will deactivate and cleaning may continue.

If the Auto Reset Thermal Protector continues to activate after following the above steps, your cleaner needs servicing.

Dirt cup

When to Empty

Empty the dirt cup and before the dirt reaches the max fill line or at the end of each cleaning session.

WARNING: To reduce the risk of personal injury - Unplug vacuum before cleaning or servicing. Do not use vacuum without dirt cup or filters in place. Very fine materials, such as face powder or cornstarch, may seal the filter and cause a reduction in performance. When using the vacuum for this type of dust, empty the cup and clean the filters often.

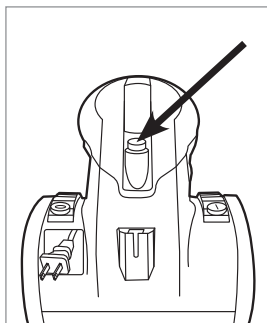

How to Empty

Press button on the handle located on the dirt cup lid and pull dirt cup out.

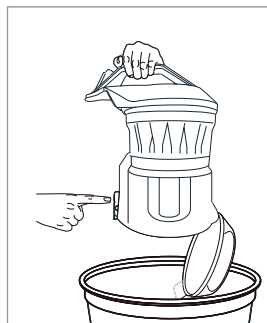

Holding dirt cup over trash receptacle, press dirt cup door release button to open and empty dirt cup. When all the dirt has fallen, close the dirt cup door and replace.

Taking care of your machine

Cyclone separator

WARNING: To reduce the risk of personal injury - Unplug vacuum before cleaning or servicing.
Do not use vacuum without dirt cup or filters in place.

IMPORTANT: The cyclone separator should not be submerged in water.

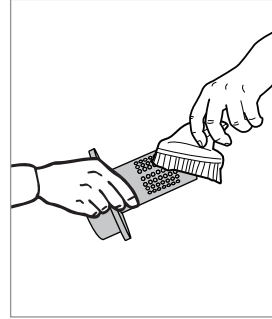
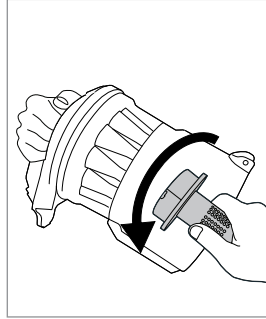
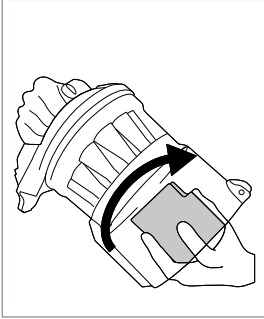

How to Clean

Remove dirt cup as described in "Dirt cup - How to Empty"

To remove inner shroud, hold the dirt cup and rotate the shroud clockwise.

Hold the dirt cup and turn the separator counter-clockwise.

Dirt and debris can be cleaned from the filter assembly with dusting brush or a towel or rag.

Replace the filter assembly on the dirt cup, and twist it clockwise to secure into position.

Replace dirt cup.

Taking care of your machine

Filters

Rinsable Filter

WARNING: To reduce the risk of personal injury - Unplug vacuum before servicing.
Do not use vacuum without dirt cup or filters in place. Allow filter to dry completely before replacing.

When to Clean

It is recommended that the Rinsable filter be checked and cleaned at least every 2 months or more frequently with heavy use.



How to Clean

Remove dirt cup as described in "Dirt cup - How to Empty"

Twist dirt cup lid counterclockwise and remove Rinsable filter.



Grasp tab on filter and remove from dirt cup.



Gently tap the filter on the inside of a trash receptacle to remove dust and dirt.

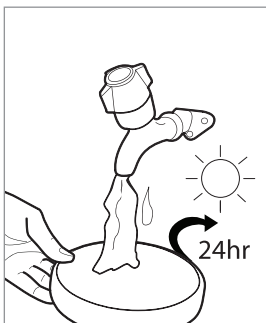

Hold Rinsable filter under running water to clean. Allow to air dry for 24 hours before replacing.

Replace filter in dirt cup and twist lid clockwise until secure.

Replace dirt cup.

IMPORTANT: Rinsable can be rinsed in warm water (max 40°C). Allow to air dry for 24 hours before replacing. Do NOT use any detergents or boiling water to wash filter.

Taking care of your machine

Filter made with HEPA

WARNING: To reduce the risk of personal injury - Unplug vacuum before cleaning or servicing.
Do not use vacuum without dirt cup or filters in place.

When to Clean

It is recommended that the Filter Made With HEPA be checked and cleaned at least every 2 months or more frequently with heavy use.

WARNING: DO NOT RINSE OR WASH THE FILTER MADE WITH HEPA.

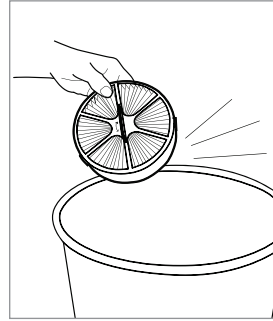
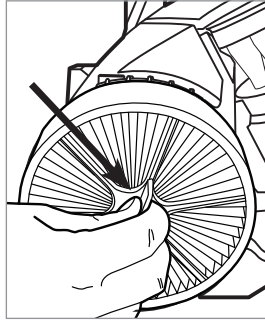
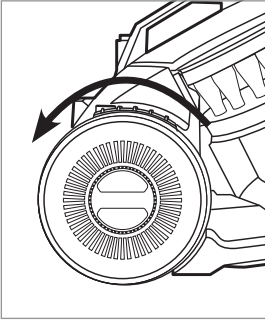

How to Clean

The Filter Made With HEPA is located inside the right wheel. Remove filter by turning the wheel cover counter-clockwise.

Fold down small tab to grasp filter in center of filter and pull out.

Gently tap the filter on the inside of a trash receptacle to remove dust and dirt. Place filter back into wheel and replace filter wheel cover.

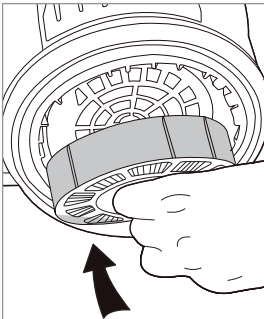

Place filter back into wheel. Replace the wheel cover by aligning with slots, push in and turn clockwise to lock into place.

Taking care of your machine

Lubrication

The motor and brushroll are equipped with bearings which contain sufficient lubrication for their lifetime. The addition of lubricant could cause damage. Do not add lubricant to motor or brushroll.

Checking for and clearing blockages

WARNING: To reduce the risk of personal injury - Unplug vacuum before cleaning or removing hose, wands, tools and accessories to check for or clearing blockages.

Low suction or pick up may be due to a blockage in the system. Refer to the following steps to check for blockages, continuing with each step until the blockage is found.

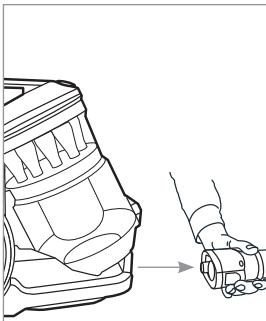

Checking vacuum connection: While vacuum cleaner is off and unplugged, remove hose from vacuum cleaner, visually check hose inlet on canister for blockages and remove if any is found. Reconnect hose.

CAUTION: Do not use sharp objects to clean out hose as they can cause damage.

Taking care of your machine

Checking for and clearing blockages

Checking hose: While vacuum cleaner is off and unplugged. Remove wand and all attachments from hose. Plug in vacuum and turn on. Check suction level at the end of the hose. If low suction is detected, turn off vacuum and unplug. Clear blockage in hose.

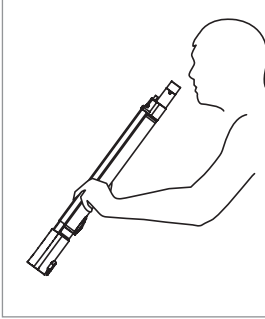

Check wand: Turn vacuum off and unplug. Remove wand from hose AND remove nozzle from wand. Visually inspect wand looking through from one end to the other. If daylight cannot be seen, clear blockage.

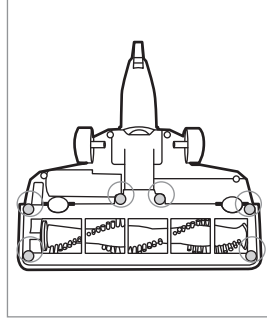

Check nozzle: While vacuum is off and unplugged, detach nozzle from wand. Turn vacuum over so bottom side is facing up. Remove 6 screws from bottom plate as shown.

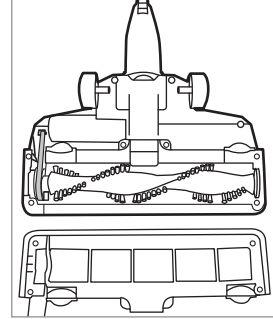

Pivot bottom plate out to access brushroll.

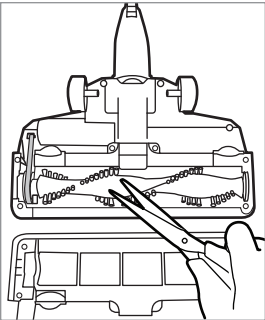

Clean debris from brushroll. Also check and clear any blockages in nozzle around wand connection. Reposition bottom plate and refasten all (6) screws.

What to do if it goes wrong

Problem

Vacuum cleaner won't pick up

Solution

- The filters may be clogged – Refer to “Taking care of your machine” section regarding the filters.
- The dirt cup is full or blocked – Refer to “Taking care of your machine” section regarding the dirt cup.
- Dirt cup may be incorrectly installed – Refer to “Taking care of your machine” section regarding the dirt cup.
- Hose/Wand may be clogged – Refer to “Maintenance section”

Dust escaping from the vacuum

- The filters may not be installed correctly – Refer to “Taking care of your machine” section regarding the filters.
- The dirt cup may be incorrectly installed – Remove the Dirt Cup from the unit by pressing the Dirt Cup Release Button and reattach it to the unit, ensuring it is locked firmly back into place.
- The filters may be clogged – Refer to “Taking care of your machine” section regarding the filters.

The vacuum cleaner won't run

- It may not be plugged into the electrical outlet correctly – Ensure that the plug is pushed into the electrical outlet securely.
- No voltage in wall plug – Check the fuse or breaker in home.
- Blown fuse or tripped breaker – Replace fuse/reset breaker in home or consult an electrician.

The vacuum suction motor won't run

- The motor Thermal Protector may have tripped – Refer to the “Taking care of your machine” section regarding the Thermal Protector.

Motorised powerhead brushroll won't run

- Hose power cord not firmly plugged in – Plug firmly into receptacle on cleaner base.
- Broken or worn belt – Call AU 1300 361 505 / NZ 0800 800 900 for Customer Service.
- Brushroll switch set to “OFF” – Set Brushroll switch to “ON”.
- The motorised powerhead motor protector activated – Call AU 1300 361 505 / NZ 0800 800 900.
- Brushroll jammed – Refer to “Taking care of your machine” section.
- Hose/Wand may be clogged – Refer to “Taking care of your machine” section.

What to do if it goes wrong

Problem

Powerhead won't pick up

Solution

- Blockage in nozzle connector – Remove blockage.
- Brushroll not running – See section “Power nozzle brushroll won't run” above.
- Brushroll brushes worn – Replace brushes.

Accessories won't pick up properly

- The accessory may be blocked – Refer to “Taking care of your machine” section.

CAUTION: To reduce the risk of personal injury, unplug the product before performing maintenance/troubleshooting checks.

Taking care of you

We're here if you need us. For trouble shooting, simply call or visit:

Australia: 1300 361 505*

vax.com.au

New Zealand: 0800 800 900*

vax.co.nz

*Monday-Friday 8.30am to 5.00pm

Don't forget your accessories!

Order at: www.vax.com.au / www.vax.co.nz

Filter Pack

Model no. VWCF

Includes pre-motor filter and pre-motor filter.





Notes



vax[®]

Distributed by Techtronic Industries Australia Pty. Ltd.
31 Gilby Road, Mt Waverley, VIC 3149 Australia.
Careline AU: 1300 361 505 www.vax.com.au
Careline NZ: 0800 800 900 www.vax.co.nz