

Shark[®]

**LIFT-AWAY™ PRO
STEAM POCKET® MOP**

S3901NZ

OWNER'S GUIDE

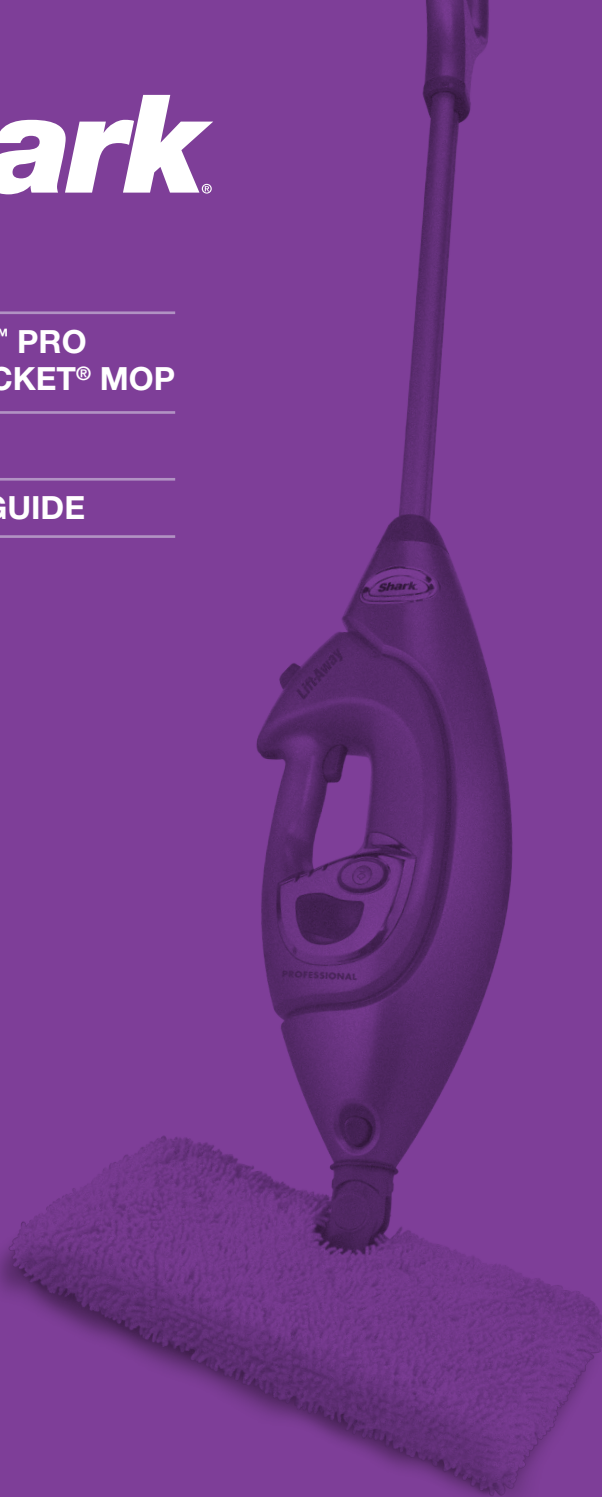

IMPORTANT SAFETY INSTRUCTIONS

For Household Use Only

WHEN USING YOUR SHARK® LIFT-AWAY™ PRO STEAM POCKET® MOP, BASIC SAFETY PRECAUTIONS SHOULD ALWAYS BE FOLLOWED, INCLUDING THE FOLLOWING:

READ ALL INSTRUCTIONS BEFORE USING YOUR SHARK® LIFT-AWAY™ PRO STEAM POCKET® MOP.

DANGER OF SCALDING.

Please use caution when using the steam mop. The steam emitted from the steam mop is very hot.

IMPORTANT:

This appliance is not intended for use by persons with reduced physical, sensory or mental capabilities, or lack of experience and knowledge, unless they have been given supervision or instruction concerning use of the appliance by a person responsible for their safety.

Children shall not use or play with this appliance. Close supervision is necessary to keep appliance out of reach of **children** during use and cooling.

WARNING: TO REDUCE THE RISK OF FIRE, ELECTRIC SHOCK OR INJURY:

1. Use the system only for its intended use.
2. **DO NOT** use outdoors.
3. **DO NOT** leave the appliance unattended when plugged in. Always unplug the power cord from the electrical outlet when not in use and before servicing.
4. **DO NOT** allow the appliance to be used by children. Close attention is necessary when used near children, pets or plants.
5. Use only as described in this manual.
6. Use only manufacturer's recommended accessories.
7. **DO NOT** use with damaged cord or plug. Contact Customer Services or Service Center for the repair or replacement of the line cord.
8. **DO NOT USE** if the appliance is not working, has been dropped, dropped into water, damaged or left outdoors.
9. **NO SERVICEABLE PARTS.** Incorrect re-assembly or repair can cause a risk of electrical shock or injury to persons when the appliance is used. Contact Customer Service or Service Center for the repair or replacement under the warranty agreement.
10. To protect against a risk of electric shock, **DO NOT** immerse the steam mop into water or any other liquids.
11. **DO NOT** handle plug or steam mop with wet hands or operate appliance without shoes.
12. **DO NOT** pull or carry by power cord, use power cord as handle, close a door on the power cord, or pull the power cord around sharp edges or corners. Keep power cord away from heated surfaces.
13. **DO NOT** unplug by pulling on power cord. To unplug, grasp the plug not the power cord. Do not use extension cords or outlets with inadequate current carrying capacity.

14. **DO NOT** put any objects into openings. Do not use with any opening that is blocked.
15. **DO NOT** put hands or feet under the steam mop. Unit gets very hot.
16. Use **ONLY** on flat, horizontal surfaces. Do not use on walls, counters or windows.
17. **DO NOT** use on leather, wax polished furniture or floors, synthetic fabrics, velvet or other delicate, steam sensitive materials.
18. Liquid or steam must not be directed towards equipment containing electrical components, such as the interior of ovens.
19. **DO NOT** add cleaning solutions, scented perfumes, oils or any other chemicals to the water used in this appliance as this may damage the unit or make it unsafe for use. If you live in a hard water area, we recommend using distilled water in your steam mop.
20. When in use, **NEVER** turn the appliance over or on its side. **NEVER DIRECT STEAM TOWARDS PEOPLE, ANIMALS OR PLANTS.**
21. **NEVER LEAVE THE STEAM MOP IN ONE SPOT ON ANY SURFACE FOR ANY PERIOD OF TIME WHEN THE CLEANING POCKET IS ATTACHED AS THIS WILL DAMAGE YOUR FLOORS.**
22. Carefully remove the cleaning pocket immediately after you have unplugged and allowed the steam mop to cool.
23. When cleaning the steam mop, unplug the power cord from the electrical outlet and clean with a dry or damp cloth. Do not pour water or use alcohol, benzene or paint thinner on the unit.
24. Extreme caution should be exercised when using this appliance to clean stairs.
25. Never use steam mop without the cleaning pocket attached.
26. Keep your work area well lit.
27. Store steam mop indoors in a cool, dry place.
28. To avoid circuit overload, do not operate another appliance on the same socket (circuit) as the steam cleaner.
29. **If an extension cord is absolutely necessary, an extension cord rated a minimum of 15 ampere, 2.08mm² (14 AWG) cord should be used. Cords rated for less amperage may overheat. Care should be taken to arrange cord so that it cannot be pulled or tripped over.**
30. **DO NOT** leave unattended when the system is connected to a power supply or electrical outlet. Turn off all controls before unplugging the unit.
31. **DO NOT** store unit with damp or wet cleaning pocket attached. Never leave the steam mop in one spot on any surface for any period of time with a damp or wet cleaning pocket attached as this will damage your floors.
32. Always unplug and allow the steam mop to cool before removing or changing mop heads.
33. Make sure that the water tank door is closed when using the appliance.

 **WARNING:** Your steam mop is designed to clean hard floor surfaces that will withstand high heat. Do not use on unsealed wood or unglazed ceramic floors. On surfaces that have been treated with wax or some no wax floors, the sheen may be removed by the heat and steam action. It is always recommended to test an isolated area of the surface to be cleaned before proceeding. We also recommend that you check the use and care instructions from the floor manufacturer.

SAVE THESE INSTRUCTIONS

THIS MANUAL COVERS MODEL NUMBER:
S3901NZ 11

TECHNICAL SPECIFICATIONS

Voltage: 220-240V~, 50/60Hz.
Power: 1250 Watts
Water Capacity: 300 ml

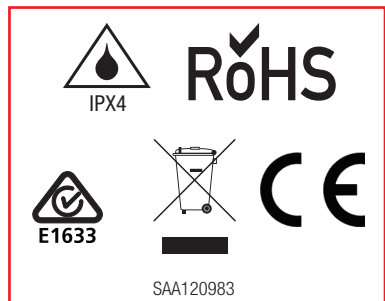

Contents

Thank you for
purchasing the
Shark® Lift-Away™
Pro Steam Pocket®
Mop.

| | |
|---|----|
| Getting Started | 5 |
| Assembling Your Steam Mop | 6 |
| Using Your Steam Mop | 8 |
| Using Your Carpet Glider | 11 |
| Using Your Handheld Steamer | 12 |
| Using Your Removable Handheld Steamer with Direct Steam Nozzle | 13 |
| Using Your Removable Handheld Steamer with Garment Steamer | 14 |
| Using Your Removable Handheld Steamer with Accessory Hose | 15 |
| Using Your Removable Handheld Steamer with Window Squeegee | 16 |
| Using Your Removable Handheld Steamer with Flat Scrubber | 17 |
| Using Your Removable Handheld Steamer with Cylinder Cleaning Tool | 18 |
| Using Your Removable Handheld Steamer with Grout Scrubber Brush | 19 |
| Care of Your Steam Mop | 20 |
| Troubleshooting Guide | 22 |
| Warranty and Registration | 24 |

Getting Started

When assembling your steam mop there may be a little water in or around the water tank. This is because we test all our steam mops 100% before you buy them, so you get a quality **Shark® Lift-Away™ Pro Steam Pocket® Mop**.

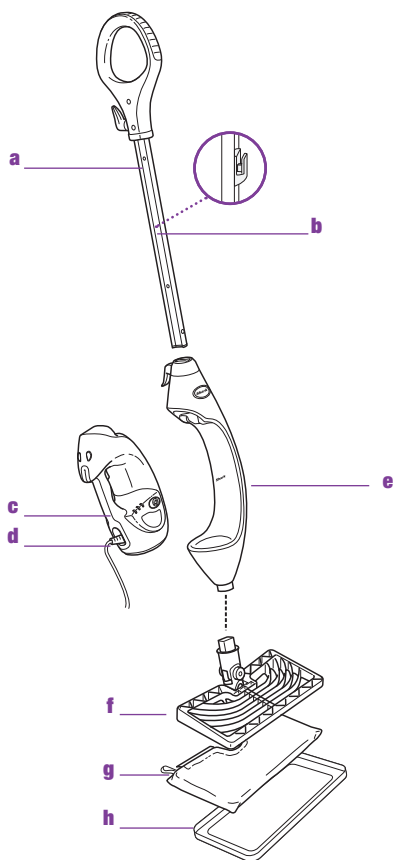

- a** Mop Handle
- b** Storage Clip for Direct Steam Nozzle
- c** Steam Trigger
- d** Removable Handheld Steamer
- e** Handheld Steamer Housing
- f** All-Purpose Mop Head
- g** Two-Sided All-Purpose Cleaning Pad for the All-Purpose Mop Head (x2)
- h** Carpet Glider

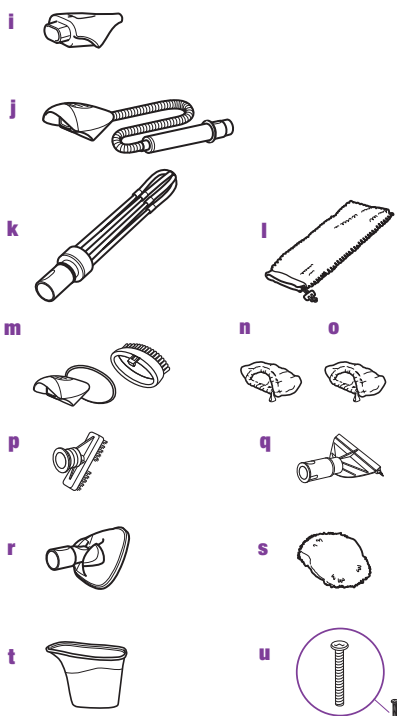

- i** Direct Steam Nozzle
- j** Accessory Hose
- k** Cylinder Cleaning Tool
- l** Cylinder Cleaning Pocket
- m** Garment Steamer Diffuser with Brush Attachment
- n** Garment Steamer Bonnet
- o** Garment Steamer Upholstery Bonnet
- p** Grout Scrubber Brush
- q** Squeegee Tool
- r** Flat Scrubber Tool
- s** All-Purpose Scrubber Pad for Flat Scrubber Tool
- t** Filling Flask
- u** (1) 6mm x 48mm Large Screw*

*Phillips or flat head screwdriver can be used.
Screwdriver not included.

Assembling Your Steam Mop

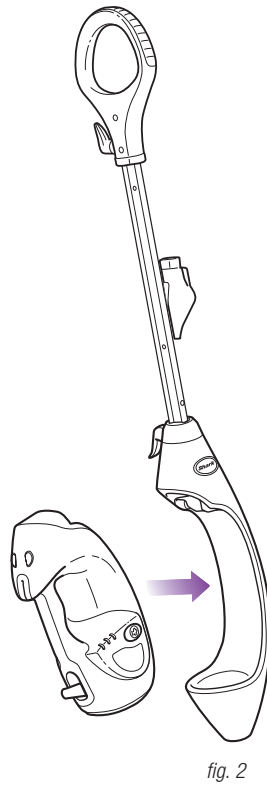
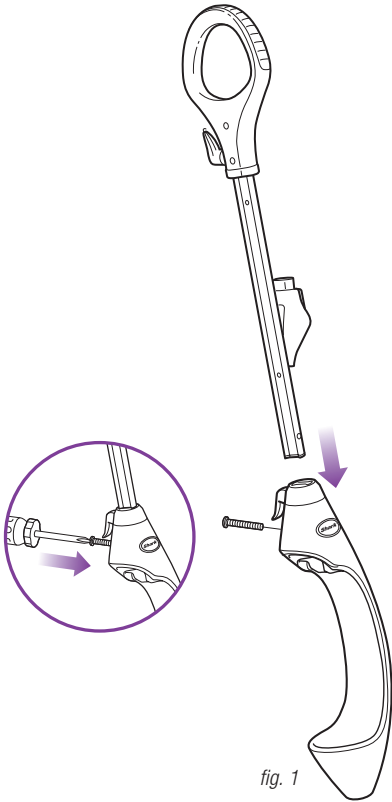

▲ IMPORTANT: Always make sure the mop is **UNPLUGGED** from the wall when not in use. **Never fill the mop, attach the mop head, change or remove the cleaning pocket when the mop is plugged into the wall.** To prolong the life of your Shark® Lift-Away™ Pro Steam Pocket® Mop we recommend using distilled water. Make sure you only add water to the tank. Chemicals or cleaning solution may damage the appliance and could be unsafe for you and your family.

STEAM MOP ASSEMBLY

- 1** Insert the Mop Handle end labelled “▼” into the Steam Mop Housing lined up with Shark®. Make sure it is inserted past the line printed on the pole. Secure the assembled handle and pole by using the large screw and a Phillips or a flat head screw driver (screwdriver not included). **(fig. 1)**
- 2** Insert the Handheld Steamer into the Steam Mop Housing. **(fig. 2)**

Assembling Your Steam Mop - cont'd

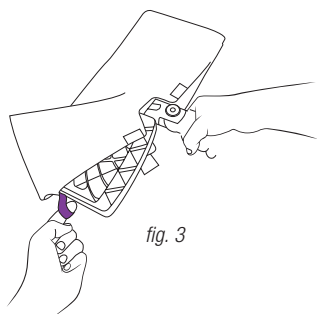

fig. 3

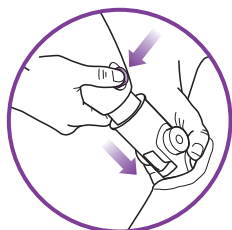

fig. 4

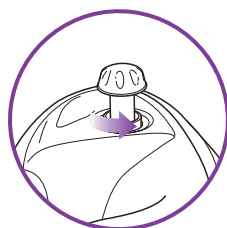
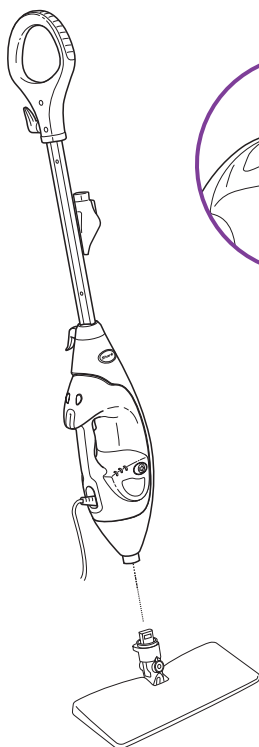

fig. 5

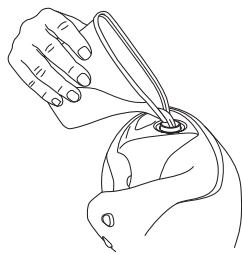

fig. 6

- 3 Use the lavender loop on the side of the cleaning pocket to slide the mop head into the pocket. Then secure the quick fasteners on the top of the pocket to lock in place. **(fig. 3)**
- 4 Snap the mop head into the mop body by lining up the groove on the back of the mop body with the groove on the back of the mop head. Push until you hear it latch into place. **(fig. 4)**
- 5 Turn the water tank cap counter clockwise and remove from the tank. **(fig. 5)**
Use the filling flask and pour water into the tank. Do not overfill. Replace the cap on the water tank. **(fig. 6)**

- ⚠ **IMPORTANT:** Do not use on unsealed wood or unglazed ceramic floors. On surfaces that have been treated with wax or some no wax floors, the sheen may be removed by the heat and steam action. It is always recommended to test an isolated area of the surface to be cleaned before proceeding. We recommend that you check the use and care instructions from the floor manufacturer.
- ⚠ **NOTE:** To prolong the life of your Steam Mop, we recommend using distilled water.

Using Your Steam Mop

- ⚠ IMPORTANT:** Make sure you do not use the mop without attaching a cleaning pocket and adding water to the tank first. When you are using the mop for the first time, it might take longer than the normal 30 seconds to start steaming.

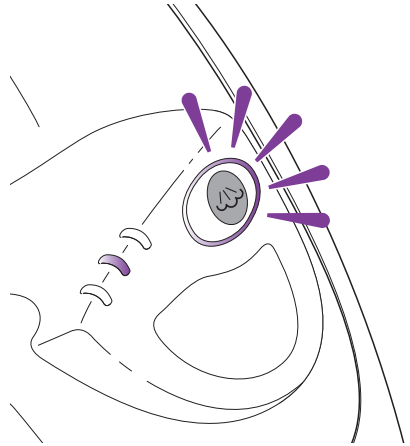
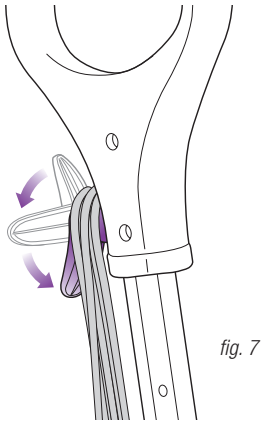

- ⚠ NOTE:** Sweep or vacuum your floors prior to cleaning with your Steam Mop.

- 1 Pull and twist the quick release cord holder to unwrap the power cord completely. Plug into an electrical outlet. **(fig. 7)**
- 2 The **ON/STEAM SETTING** button will flash blue. If the light does not turn on, reference the troubleshooting section on [page 22](#). **(fig. 8)**

Using Your Steam Mop - cont'd

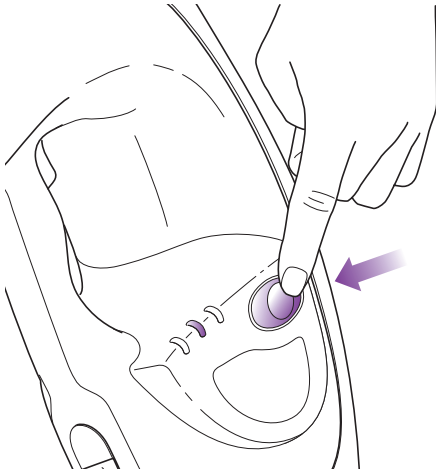

fig. 9

- 3 Press the **ON/STEAM SETTING** button once for **DUST** setting (**DUST** lighted setting indicator will flash and turn solid blue when it is ready to use). **DUST** setting is a light steam for a quick dusting and best dry time. (fig. 9)

Press the **ON/STEAM SETTING** button twice for **MOP**. **MOP** setting is for normal, everyday steam cleaning. (fig. 10)

Press the **ON/STEAM SETTING** button three times for **SCRUB**. **SCRUB** setting is for heavy cleaning and will leave floors damp.

After you have selected your desired steam setting, the setting indicator light will flash and turn solid blue when it is ready to use.

To better understand which steam setting to use for your cleaning task, see page 10.

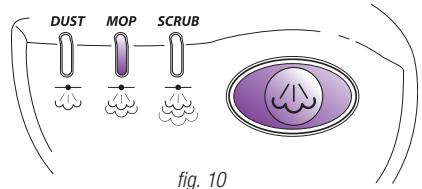

fig. 10

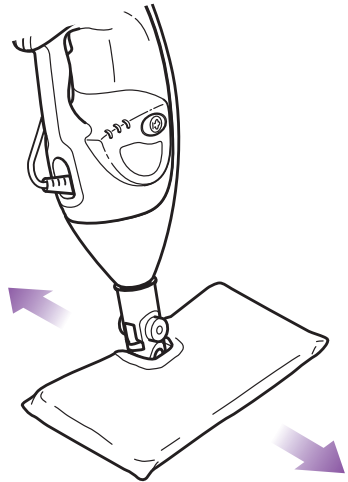





fig. 11

- 4 Clean your floors with a forward and backward motion. (fig. 11)

When you are done, press the **ON/STEAM SETTING** button until the light blinks blue as in standby mode.

- ▲ **NOTE:** When using your Shark® Lift-Away™ Pro Steam Pocket® Mop in **MOP** mode be careful not to press the steam trigger on the Handheld Steamer, as it will activate **STEAM SETTING** mode. If this happens, press the **ON/STEAM SETTING** button one time to reactivate your steam selection.

The Shark® Lift-Away™ Pro Steam Pocket® Mop has three unique steam settings so you can use the perfect amount of steam for the cleaning task at hand. See below for tips on when to use each setting.

| SETTING | IDEAL FOR THESE SURFACES | RECOMMENDED USAGE |
|---|---|---|
| DUST  | Laminate Bamboo Hardwood Marble | Light cleaning and dusting Loosen and lift light dirt Sanitise floors |
| MOP  | Hardwood Marble Tile Stone | Basic, everyday cleaning Remove spots and smaller messes Clean moderate and heavily-trafficked areas Sanitise floors |
| SCRUB  | Hardwood* Tile Stone Linoleum <hr style="border-top: 1px dashed black;"/> Carpet (with Carpet Glider) | Tough cleaning and removal of stuck-on messes and stains Deep clean heavily-trafficked areas Cut through heavy dirt and grime Sanitise floors Freshen area rugs and carpets |

* Scrub mode not recommended for continuous cleaning on hardwood

Using Your Steam Mop - cont'd

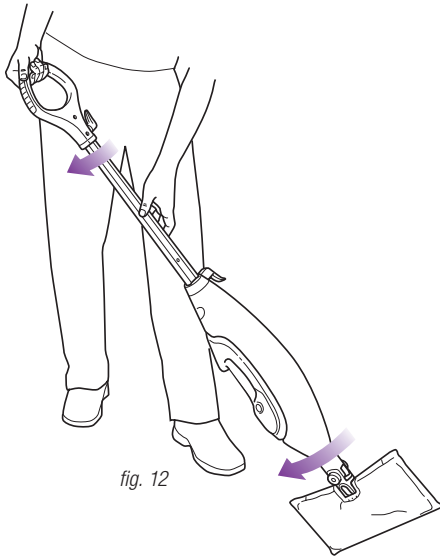

- When one side of the cleaning pocket gets dirty, just flip the mop and you can quickly start using the other side. **(fig. 12)**
 - When the water tank is empty, the Steam Mop will stop producing steam. You can refill the water tank at any time as long as the mop is unplugged from the outlet. Follow the instructions from page 7. **This applies to switching the cleaning pockets as well.**
- ▲ NOTE:** Please wait 2-3 minutes for the Steam Mop to cool off before switching the cleaning pocket. Never leave the Steam Mop with a damp/wet cleaning pocket on any floor.

Using Your Carpet Glider

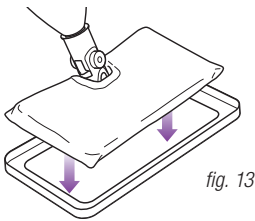

THE CARPET GLIDER

- The Carpet Glider can be used with the All-Purpose Head to lightly steam your carpet and area rugs. Just place the mop head with cleaning pocket attached into the glider. The recommended steam setting is **SCRUB** when using the Carpet Glider. **(fig. 13)**

 The Steam Mop will not clean your carpeting or area rugs. However, it is great for grooming and freshening.

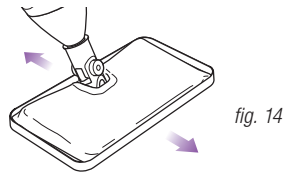

- Move the Steam Mop back and forth across a section of the carpet. **(fig. 14)**

Using Your Handheld Steamer

Your Shark® Lift-Away™ Pro Steam Pocket® Mop is designed to clean surfaces that will withstand high heat and moisture. Do not use on unsealed wood surfaces (especially wooden antique furniture), unglazed ceramic tile, painted surfaces or surfaces that have been treated with wax, oils, varnishes, or shellac. The sheen may be removed by the heat, steam, and friction of the cleaning tools. Lacquer and polyurethane coatings provide a hard durable protective finish that withstands moisture, but it is always recommended to test an isolated area of the surface to be cleaned before proceeding.

We also recommend you check the use and care instructions from the surface manufacturer.

When cleaning finished wood surfaces, use broad, continuous cleaning strokes. To prevent surface damage, avoid focusing steam or allowing the cleaning tools to sit in one spot for any amount of time.

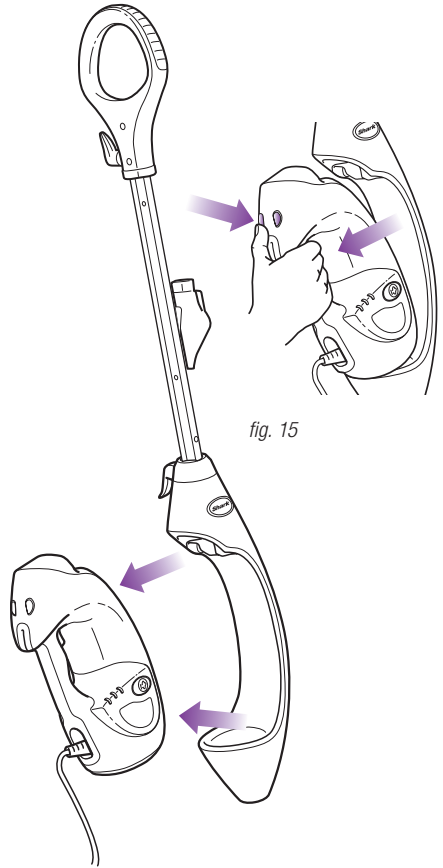

- 1 To remove the Handheld Steamer, press and hold down the Handheld Release Buttons while pulling out the Handheld Steamer. **(fig. 15)**

Using Your Removable Handheld Steamer with Direct Steam Nozzle

Cleaning Tip: The Direct Steam Nozzle creates direct steam spray to clean and sanitise hard to reach nooks & crannies and other places where germs may build up. Use the Direct Steam Nozzle to loosen and dislodge compact dirt often found in corner and tight places where traditional methods and cleaning tools tend to push dirt into, making it tough to reach and clean. Spray direct steam and wipe clean with a wet cloth or paper towel.

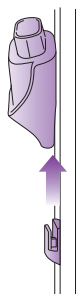

fig. 16

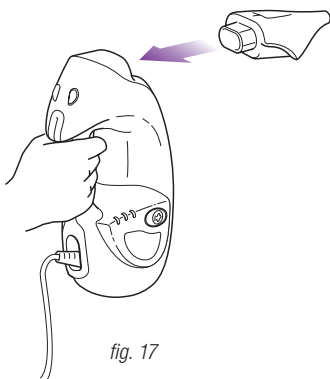

fig. 17

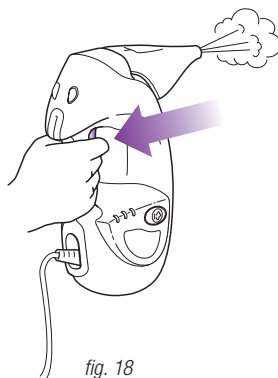

fig. 18

FOR SPOT CLEANING AND STEAMING

1 CAUTION: Do not press the steam trigger until the Direct Steam Nozzle is snapped into the main nozzle of your Handheld Steamer.

2 Remove the Direct Steam Nozzle from the storage clip on the mop handle and attach it by pressing the nozzle onto the Handheld Steamer until it clicks into place. (fig. 16, fig. 17)

3 The Handheld Steamer is automatically set to **SCRUB** mode. Squeeze the steam trigger to activate steam. To change modes press the **ON/STEAM SETTING** button to select either **DUST, MOP** or **SCRUB** mode. You can change the steam mode while the Handheld Steamer is in standby or in use. Once the selected setting indicator light has turned blue, hold down the steam trigger to start steaming. (fig. 18)

For effective cleaning, hold the steam output nozzle 2.5 - 5 cm away from the surface you're cleaning.

4 To remove the Direct Steam Nozzle, press and hold down the Handheld Release Buttons. Then slide out the Direct Steam Nozzle using the grip.

CAUTION: Do not press the steam trigger while removing the Direct Steam Nozzle. Avoid touching the tip of the Direct Steam Nozzle, as this will be very hot after steaming.

NOTE: The Handheld Steamer may continue to emit steam for a few seconds after the trigger is released. This is normal, and the steaming will eventually come to a stop.

Using Your Removable Handheld Steamer with Garment Steamer

Cleaning Tip: The Garment Steamer is ideal for removing wrinkles from clothing and freshening and grooming upholstery. A terry bonnet and frame with bristles provides controlled steaming for most types of clothing. A specialized micro-fibre bonnet is ideal for freshening couches and other upholstery, where odours may accumulate.

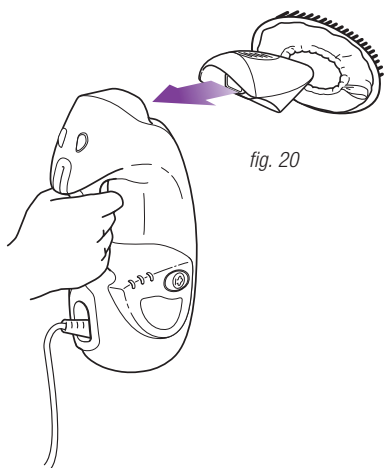
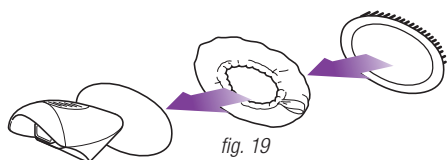

- ▲ CAUTION: Always determine colour fastness of any fabric, especially with reds or blues. Take a clean, moist, warm towel and gently rub a small area on the fabric that is as out of sight and out of the way as possible. If colour bleeds onto the towel, you may need to have the piece professionally cleaned.**
- ▲ CAUTION: Do not press the steam trigger while attaching or removing the Garment Steamer.**

- 1** Select either the thinner, terry cloth bonnet to steam your garments, or the thicker, shaggier bonnet to freshen upholstery.
- 2** Use the lavender loop on the side of the bonnet to slide over the nozzle opening of the Garment Steamer. The elastic around the bonnet should hold it firmly in place around the Garment Steamer opening.

- 3** Snap the frame with bristles over the Garment Steamer. For ease of use, we recommend that the bristles be placed at the top of the Garment Steamer bonnet. **(fig. 19)**
- 4** Attach the assembled Garment Steamer to the removable Handheld Steamer by snapping it into the main nozzle. **(fig. 20)**
- 5** Select the steam setting and wait until the selected setting indicator light turns solid blue. Press and hold the steam trigger button, and move slowly up and down over your garments or upholstery. **(fig. 21)**
- 6** To remove the Garment Steamer, press and hold down the Handheld Release Buttons. Then slide out the Garment Steamer using the grip on top of the Steamer.

Using Your Removable Handheld Steamer with Accessory Hose

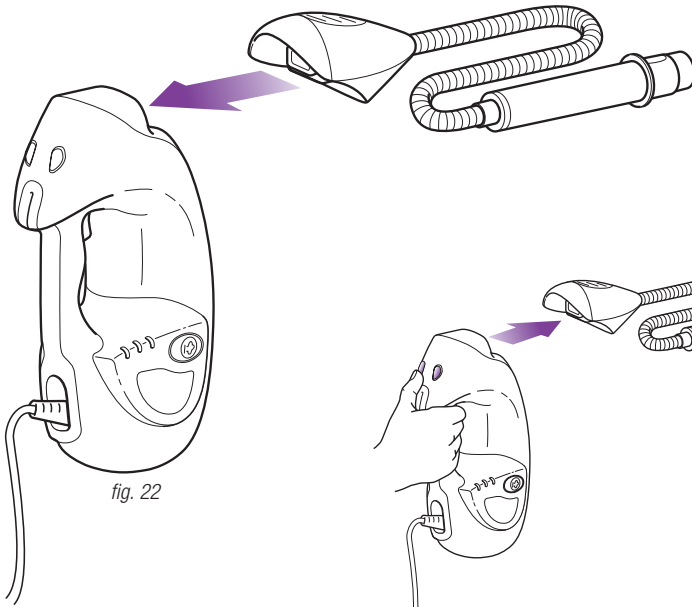

fig. 22

fig. 23

▲ CAUTION: Do not press the steam trigger while attaching or removing the Accessory Hose.

▲ CAUTION: Do not use the Accessory Hose without cleaning tools attached.

- 1 To use the Accessory Hose, first attach the Accessory Hose to the Handheld Steamer by snapping the Accessory Hose into the main nozzle. (fig. 22)
- 2 Select the desired cleaning tool for use. Follow the cleaning tool sub-assembly instructions for the selected tool.
- 3 To remove the Accessory Hose, press and hold down the Handheld Release Buttons. Then slide out the Accessory Hose using the grip. (fig. 23)

Using Your Removable Handheld Steamer with Window Squeegee

Cleaning Tip: To use the window squeegee, work with the vapour jet down using top to bottom movements. To do this without leaving streaks, use lateral movements from the top to the bottom of the surface.

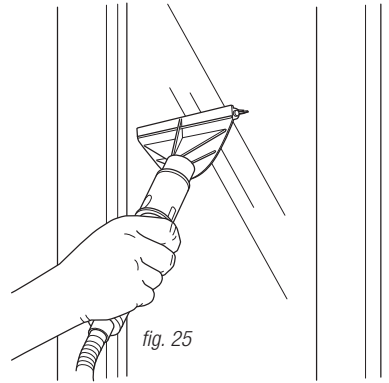
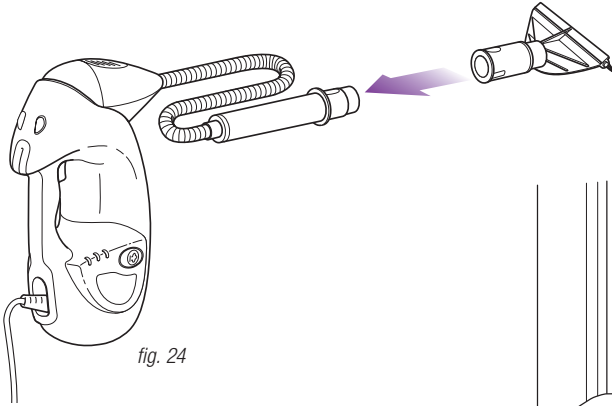

- CAUTION:** Always avoid any sudden changes in temperature to prevent breakage of cracks in windows.
- CAUTION:** Do not press the steam trigger while attaching or removing the Window Squeegee.
- 1 Attach the Window Squeegee by snapping into the handle of the Accessory Hose. (fig. 24)
- 2 Select either **DUST, MOP** or **SCRUB** mode by pressing the **ON/STEAM SETTING** button and wait until the selected setting indicator light turns solid blue. Hold down the steam trigger to start steaming. (fig. 25)
- 3 To remove the Window Squeegee, press and hold down the Accessory release button. Then slide out the Window Squeegee.

Using Your Removable Handheld Steamer with Flat Scrubber

Cleaning Tip: The Flat Scrubber is designed for cleaning a variety of surfaces and is exceptional on those that are large and flat including counter tops, table tops, walls mirrors, windows, stairs, shelves and other similar surfaces. Super absorbent micro-fibre bonnet loosens, lifts, and locks in dirt and grime while sanitizing at the same time.

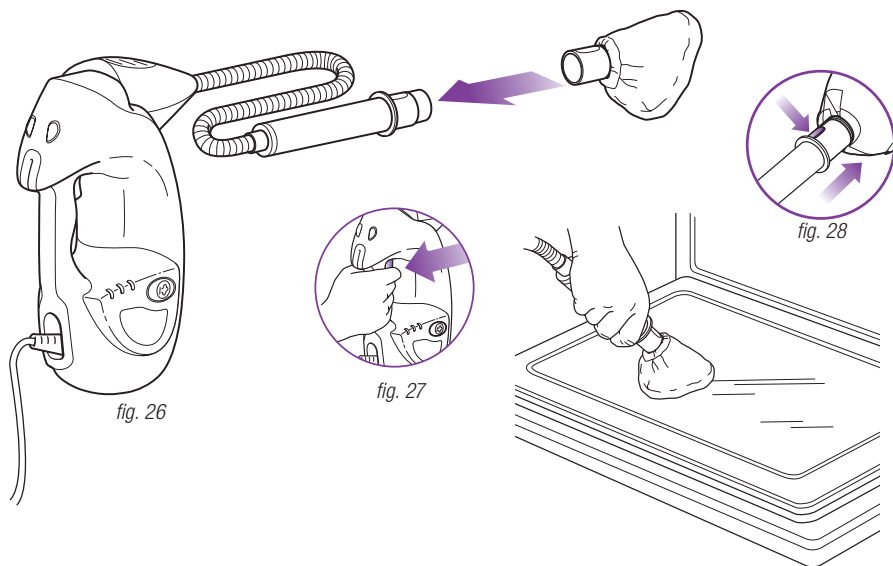

▲ CAUTION: Do not press the steam trigger while attaching or removing the Flat Scrubber Tool.

▲ CAUTION: Do not use the Flat Scrubber Tool without the All-Purpose Scrubber Pad attached.

1 To attach the All-Purpose Scrubber Pad, place the pad exterior side down on a flat surface (lavender tab indicates the bottom of the pad) and insert the top of the Flat Scrubber Tool into the top portion of the pad and then pull the pad over each side of the back edge.

2 Press the Flat Scrubber Tool onto the Accessory Hose until it clicks into place. **(fig. 26)**

3 Select either **DUST**, **MOP** or **SCRUB** mode by pressing the **ON/STEAM SETTING** button and wait until the selected setting indicator light turns solid blue. Hold down the steam trigger to start steaming. **(fig. 27)**

4 To remove the Flat Scrubber Tool, press and hold down the Accessory Hose release button. Then slide out the Flat Scrubber Tool. **(fig. 28)**

Using Your Removable Handheld Steamer with Cylinder Cleaning Tool

Cleaning Tip: The Cylinder Cleaning Tool provides controlled cleaning and reaches into narrow areas and around curved and contoured surfaces for steam dusting and fine cleaning activities. It is a great cleaning tool for in and around sinks, bathtubs, refrigerator doors, window sills, door jams and frames, exhaust and intake vents, banisters, railings, spindles, furniture, seating and more.

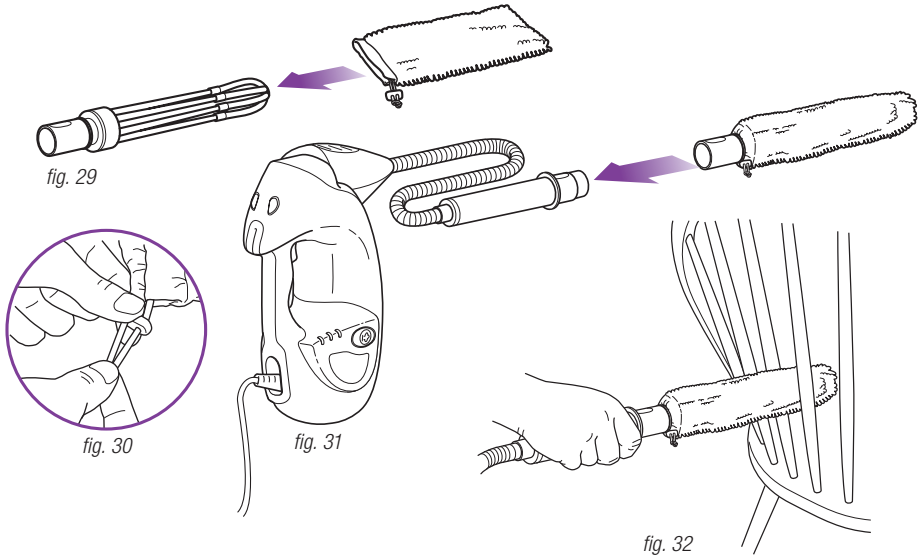

CAUTION: Do not press steam trigger while attaching or removing the Cylinder Cleaning Tool. Always use the Cylinder Cleaning Tool with Bonnet attached.

- 1 Slide the Cylinder Cleaning Pocket over the Cylinder Cleaning Tool frame until it is completely on. (**fig. 29**)
- 2 Close the cinch by pulling on the elastic band and sliding the locking bean to tighten. (**fig. 30**)
- 3 Attach the Cylinder Cleaning Tool by snapping into the handle of the Accessory Hose. (**fig. 31**)

- 4 Select either **DUST**, **MOP** or **SCRUB** mode by pressing the **ON/STEAM SETTING** button and wait until the selected setting indicator light turns solid blue. Hold down the steam trigger to start steaming. (**fig. 32**)
- 5 To remove the Cylinder Cleaning Tool, press and hold down the Accessory release button. Then slide out the Cylinder Cleaning Tool.

Using Your Removable Handheld Steamer with Grout Scrubber Brush

Cleaning Tip: the Grout Scrubber Brush is designed for removing stubborn messes in hard-to-reach nooks, corners and in grout where focused scrubbing power may be needed. The Grout Scrubber Brush can loosen and dislodge compact dirt often found in corners and tight places where traditional methods and cleaning tools tend to push dirt into, making it difficult to reach and clean. Scrub with the Grout Scrubber Brush and wipe clean with a cleaning cloth.

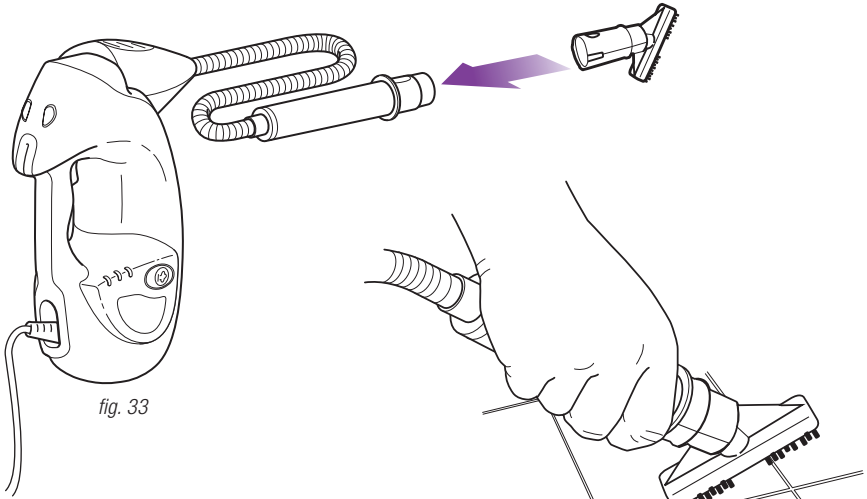

fig. 33

fig. 34

⚠ CAUTION: Do not press steam trigger while attaching or removing the Grout Scrubber Brush.

1 Attach the Grout Scrubber Brush by snapping into the handle of the Accessory Hose. **(fig. 33)**

2 Select either **DUST**, **MOP** or **SCRUB** mode by pressing the **ON/STEAM SETTING** button and wait until the selected setting indicator light turns solid blue. Hold down the steam trigger to start steaming. **(fig. 34)**

3 To remove the Grout Scrubber Brush, press and hold down the Accessory release button. Then slide out the Grout Scrubber Brush.

Care of Your Steam Mop

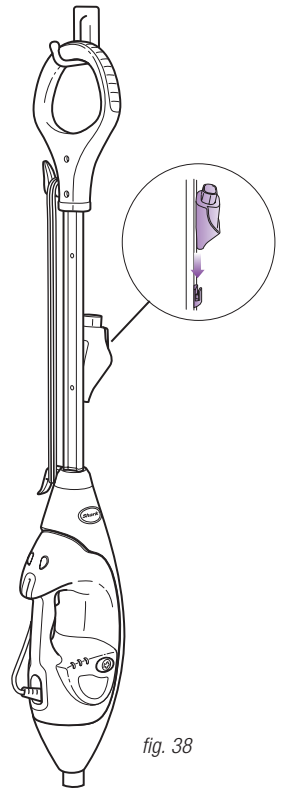
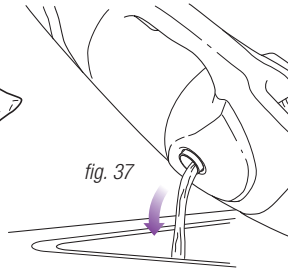
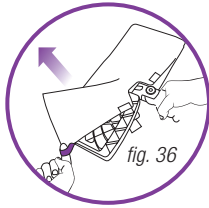
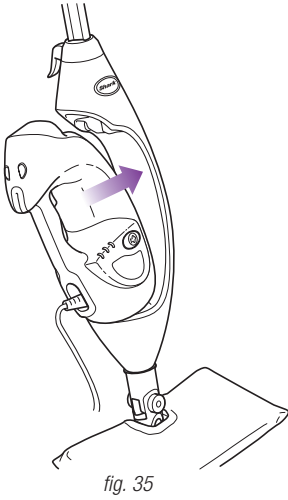

AFTER USE AND STORAGE

- 1 When you have finished using the Handheld Steamer, reattach it to the mop by first placing the bottom of the Handheld Steamer into the cradle of the mop housing. (fig. 35)
- 2 Then slide the top end of the Handheld Steamer into the mop housing and snap into place.
- 4 **NOTE:** Make sure all attachments are removed before reuniting the Handheld Steamer with the Steam Mop.
- 3 If you are also done mopping, press the **ON/STEAM SETTING** button until the LED light turns flashing blue. This stops the unit from steaming. Unplug the cord from the outlet and place the mop into the upright position. Let the unit cool for 2-3 minutes.

Remove the cleaning pocket by releasing the quick fasteners and using the lavender loop on the side of the pocket, avoiding contact with the hot pocket or dirt. (fig. 36)

- 4 Empty the water tank before storage. Remove the water tank cap and empty the tank over a sink. Replace the water cap. (fig. 37)
- 5 To store the Shark® Lift-Away™ Pro Steam Pocket® Mop hanging up, first remove the head (after it has cooled and the steam has been released) then hang on a large hook. (fig. 38)
- 6 Place the Direct Steam Nozzle on the storage clip for easy accessibility.

Care of Your Steam Mop- cont'd

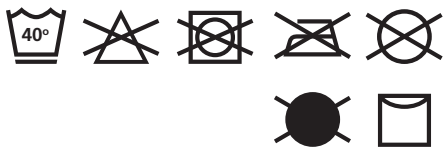
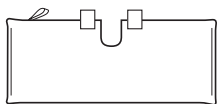

fig. 39

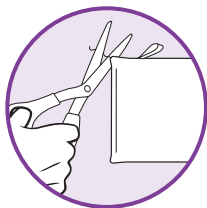

fig.40

CARE OF YOUR CLEANING POCKETS

- 1 We recommend washing your cleaning pockets separately from other fabrics to avoid picking up lint. For optimal cleaning performance pockets may need to be washed up to (3) three times. Only use liquid detergent (no powder detergent). Don't use any fabric softeners or bleach. Line dry. Do not tumble dry. (fig. 39)
 - 2 If there are loose threads on the cleaning pocket carefully cut the thread with scissors. Don't pull on them or cut at the base. (fig. 40)
- ▲ IMPORTANT:** The cleaning pocket may be very hot from the steam. Use caution when removing. Let the unit cool for 2-3 minutes.

DECALCIFYING YOUR STEAM MOP

Calcium and mineral deposits can build up and impact the performance of your steam mop over time. To extend the life of your product we recommend that you use distilled water.

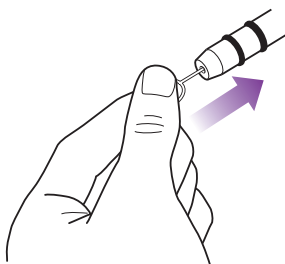

fig. 41

CLEANING THE NOZZLE

NOTE: To prevent clogging, it is recommended that you periodically clean the Direct Steam Nozzle and the extension hose stem with the cleaning tool provided or a paper clip.

- 1 Your Handheld Steamer should not normally require cleaning, however, should you notice a decrease in the steam output, it may be necessary to remove mineral deposits built up around the nozzles.
- 2 Unplug the cleaner from the electrical outlet.
- 3 Use the provided nozzle cleaner or a small diameter stiff metal wire, such as a straightened metal paper clip, and carefully insert the end of the wire into the nozzle orifice. See illustration above. (fig. 41)
- 4 Move the wire back and forth several times to remove any deposits.
- 5 Plug in the appliance to the power outlet and test steam output.

Troubleshooting Guide

| PROBLEM | POSSIBLE REASONS & SOLUTIONS |
|--|--|
| The Shark® Lift-Away™ Pro Steam Pocket® Mop will not turn-on. | Your steam mop should be securely plugged into an electrical outlet only. Check your fuse or breaker. |
| The unit will not make steam. | Is there water in the water tank? If not, add water to your steam mop following instructions on page 7. If the unit still does not make steam, follow the instructions on page 21 to clean the nozzle. |
| The Shark® Lift-Away™ Pro Steam Pocket® Mop leaves water on the floor. | Check to see if your cleaning pocket is too wet. We recommend you unplug the steam mop and change the cleaning pocket. Make sure the cleaning pocket is attached correctly. |
| Cannot select steam setting/ flashing blue light remains on. | If you have already plugged in your unit, unplug and try a different outlet. This may reset the standby mode. Add water to the tank and select steam setting by pressing the standby button. |
| The Shark® Lift-Away™ Pro Steam Pocket® Mop left a white spot on the floor. | Do not leave your steam mop on the floor with a damp or wet cleaning pocket. If you're using tap water, we recommend switching to distilled water. Make sure the cap is securely on the water tank. |
| Floors are cloudy, streaky or spotty after steaming. | The cleaning pocket might be dirty. Flip or change the cleaning pocket. If you washed the cleaning pocket with powder detergent, then your pocket could be damaged and require replacement. Contact our Customer Service Team for Replacement Pockets. This could also be an indication of prior soap or grease residue that has accumulated on the floor. As our steam mops use only a small amount of water, it may not be wet enough to rinse off the accumulation that the steam is bringing to the surface. We suggest rinsing the floor with nothing but water, letting it dry, and then steam mopping again with a clean pocket. One or more rinses generally removes the residue. A more stubborn case may require you to rinse the floor with a mix of one part vinegar and two parts water. |
| The Shark® Lift-Away™ Pro Steam Pocket® Mop is hard to push. | Make sure the cleaning pocket is attached correctly. Check to see if the cleaning pocket is excessively dirty. If so, replace the cleaning pocket. |
| The nozzle leaves water drops on the garment. | The small steam bonnet frame must be in place at all times during usage. The bonnet prevents water drops from being left on the garment and removes impurities from your water. If the steam bonnet is too wet or the frame has condensation, let the unit cool for 30 minutes, remove the steam bonnet and let it dry out before using again, or replace with a new steam bonnet. |

Notes

ONE (1) YEAR LIMITED REPLACEMENT WARRANTY STATEMENT

If your product becomes defective due to faulty material or workmanship within a period of 1 year from the date of purchase, we warrant to do the following:

- **For New Zealand Consumers:** We will replace the product with a new product, free of charge, or repair the product at our cost, at our discretion.
- **For Australian Consumers:** Our goods come with guarantees that cannot be excluded under the Australian Consumer Law. You are entitled to a replacement or refund for a major failure and for compensation for any other reasonably foreseeable loss or damage. You are also entitled to have the goods repaired or replaced if the goods fail to be of acceptable quality and the failure does not amount to a major failure.

Your warranty is subject to the following conditions:

- **DO NOT** operate the appliance with a damaged plug or cord, or if the unit has been dropped, damaged or dropped in water. To avoid the risk of electric shock, do not disassemble or attempt to repair the appliance on your own. If the supply cord is damaged, **it must be replaced by a qualified electrician in order to avoid a hazard.** Incorrect re-assembly or repair can cause a risk of electrical shock or injury to persons when the appliance is used.
- The product has not been misused, abused, neglected, altered, modified or repaired by anyone.
- The product has been subjected to fair wear and tear.
- The product has not been used for trade, professional or hire purposes.
- The product has not sustained damage through foreign objects, substances or accident.

Your warranty does not cover:

- Components that are subject to natural wear and tear caused by normal use in accordance with operating instructions.
- Unauthorised/improper maintenance/handling or overload is excluded from this warranty.
- For guarantee claims you will need to submit a proof of purchase in the form of a valid receipt that displays date and place of purchase.

This warranty does not replace but is in addition to your statutory rights.

This warranty does not apply to accessories supplied with the product.

This warranty applies only to the original purchaser and may not be transferred.

Replacement products will be covered by the limited warranty for the balance of the warranty period from the date of the original purchase.

Please note:

Only defective product or parts returned to place of purchase will be replaced under this warranty.

New Zealand Contact:

Brand Developers Limited
Unit H, 686 Rosebank Road,
Avondale, 1026 Auckland, New Zealand
FAX: +64 9 306 8203
NZ Customer Care 0800 002 999

Australia Contact

Brand Developers Aust Pty Ltd
461 Plummer Street,
PORT MELBOURNE, VIC 3207
FAX: +61 3 9681 7825
AUST Customer Care: 1800 890 840

Distributed by:

Brand Developers Aust Pty Ltd

461 Plummer Street

PORT MELBOURNE, VIC 3207

FAX: +61 3 9681 7825

AUST Customer Care: 1800 890 840



Brand Developers Ltd

Unit H, 686 Rosebank Road,

Avondale, 1026 Auckland,

NEW ZEALAND

FAX: +64 9 306 8203

NZ Customer Care: 0800 002 999



Technical Details

Model number: S3901NZ 11

Voltage: 220-240V~, 50/60Hz.

Power: 1250 Watts

Water Capacity: 300 ml

Made in China

Euro-Pro, Steam-Pocket and Shark are registered trademarks of Euro-Pro Operating LLC.

Lift-Away is a trademark of Euro-Pro Operating LLC.

COPYRIGHT © EURO-PRO OPERATING LLC 2015

Illustrations may differ from actual product. We are constantly striving to improve our products, therefore the specifications contained herein are subject to change without notice.

PRINTED IN CHINA

S3901NZ_11_IB_150319_1



SAA120983