



we  clean

# User Guide

Vax Service line AU: 1300 361 505

NZ: 0800 800 900

## 2 in 1 Cordless Stick Vac



we  clean

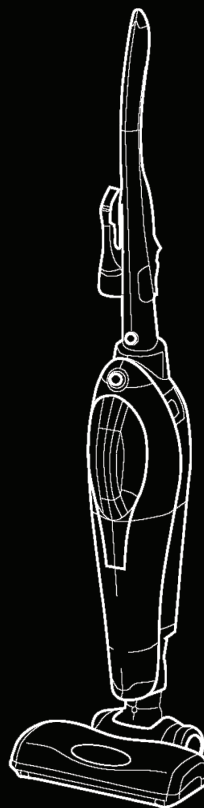

## Get Cleaning...

What's your Vax's model number?

V M S T 1 4 4 V

What's your serial number? (Located on the base of the machine)

-       -   -   -   -

Note these down in case you need them in future. Please keep instructions for further use.

[www.vax.com.au](http://www.vax.com.au)

# VMST144V

# Machine Overview

- 1 Handle
- 2 Upholstery brush
- 3 Crevice tool
- 4 Accessory hook
- 5 Handle button
- 6 Battery release button
- 7 Battery compartment
- 8 Power button
- 9 Carry handle
- 10 Dirt Cup
- 11 Roller brush release button
- 12 Roller brush
- 13 Dirt cup release button
- 14 Battery
- 15 Charger

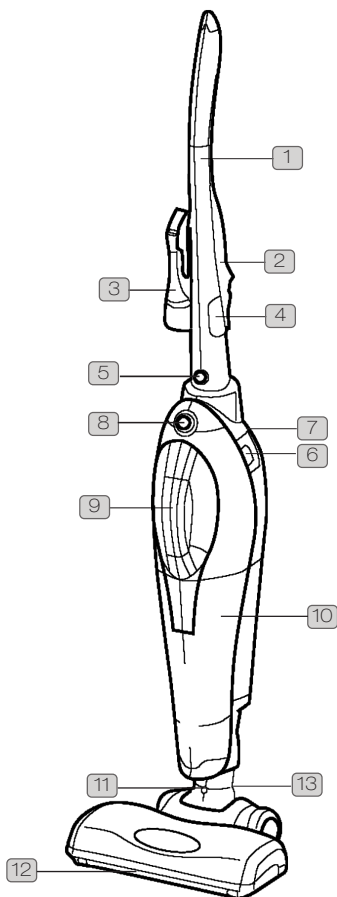
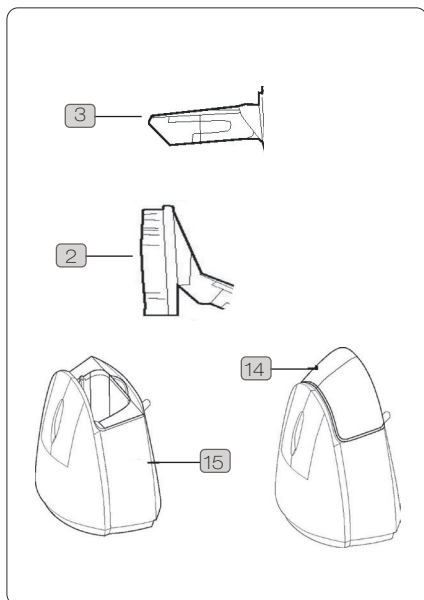

Unit

# General Safety Information

## FOR HOUSEHOLD USE ONLY.

When using the vacuum cleaner, basic safety precautions should always be observed, including the following:

1. Only use the vacuum cleaner indoors on dry surfaces.
2. Turn off the vacuum cleaner controls before disconnecting or connecting from the battery.
3. Always unplug the vacuum cleaner battery before connecting or disconnecting the vacuum accessories.
4. Children should be supervised to ensure that they do not play with the appliance.
5. This appliance is not intended for use by persons (including children) with reduced physical, sensory or mental capabilities, or lack of experience and knowledge, unless they have been given supervision or instruction concerning use of the appliance by a person responsible for their safety.
6. Use only as described in this manual. Use only Vax recommended attachments.
7. Do not use the vacuum cleaner if it has been dropped, damaged, left outdoors or dropped into water. Do not use the vacuum cleaner charger with a damaged cord or plug. If the supply cord is damaged, it must be replaced by the manufacturer, its service agent or similarly qualified persons in order to avoid a hazard.
8. Do not pull or carry charger by cord. Do not use the cord as a handle, close a door on the cord or pull cord around sharp edges or corners. Do not run the vacuum cleaner over the cord. Keep the cord away from heated surfaces.
9. Do not handle the plug or vacuum cleaner with wet hands. Do not use outdoors or on wet surfaces.
10. Do not put any objects into openings. Do not use with any openings blocked and do not restrict airflow. Keep all openings free of dust, lint, hair or anything that might reduce airflow.
11. Keep hair, loose clothing, fingers and all parts of the body away from openings and moving parts.
12. Do not pick up hot coals, cigarette butts, matches or any hot, smoking or burning objects.
13. Do not pick up flammable or combustible materials (lighter fluid, petrol, kerosene etc.) or use

in the presence of explosive liquids or vapours.

14. Do not vacuum up harmful or toxic material (chlorine, bleach, ammonia, drain cleaner etc.).
15. Do not vacuum up hard or sharp objects such as glass, nails, screws, coins, etc.
16. Do not use without ALL of the filters in place.
17. Take extra care when vacuuming on stairs.
18. Keep vacuuming area well lit.
19. Store the vacuum cleaner in a cool, dry area.
20. Turn off the on/off switch before unplugging the vacuum cleaner battery.

 **WARNING:** Always switch off and unplug the vacuum cleaner from the battery before assembling, opening or emptying the dirt container, or before connecting/disconnecting the attachments.

 **WARNING:** Do not recharge non-rechargeable batteries.

 **WARNING:** Indoor Use Only. 

 **CAUTION:** The vacuum cleaner is a very powerful unit. Before plugging the battery in make sure the switch is in the 'off' position. Hold the vacuum cleaner firmly when starting and in use.

 **IMPORTANT:** If the inlet, hose or telescopic tube is blocked, switch off the vacuum cleaner and remove the blockage(s) before re-starting the vacuum cleaner.

 **IMPORTANT:** Cleaning filters improves vacuum performance. Vax recommends that your filters should be checked and cleaned periodically. If your filters are washable make sure they are completely dry before inserting back into the vacuum cleaner.

 Read operator's manual

**This vacuum cleaner is intended for household use only and NOT for commercial or industrial use.**

**PLEASE KEEP INSTRUCTIONS FOR FURTHER USE.**

# Operation

Before assembling, please be sure that all parts and accessories are included by reviewing the Parts and Accessories List.

## Dirt Cup Assembly

As is shown in the Figure below, place the toll bar of the dust barrel on the back of the unit, and press down the dirt cup. When the front-end hook on the dirt cup is placed into the corresponding part on the unit completely, press firmly until a "click" is heard confirming it is securely in place. To remove the dirt cup, simply grasp the bottom end of the dirt cup and press the release button, while pulling away from the unit.

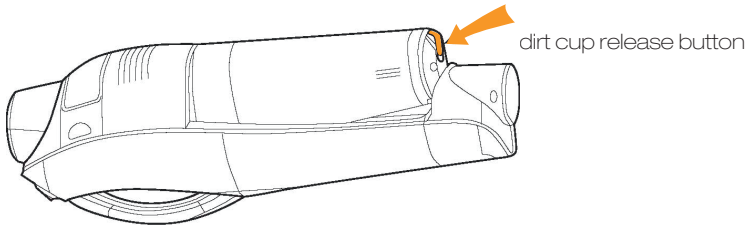

## Emptying the Dirt Cup

After removing the dirt cup as described above, you can now empty its contents.

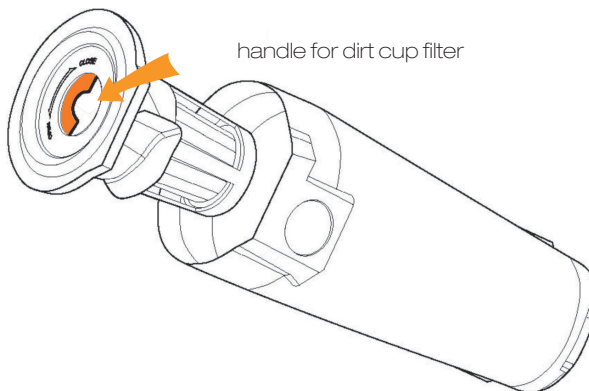

# Operation

## Assembly of Roller Brush

As is shown in the figure below, carefully insert the roller brush into the unit, making sure to align within the specific guide slots and ensuring electric contacts are fully aligned.

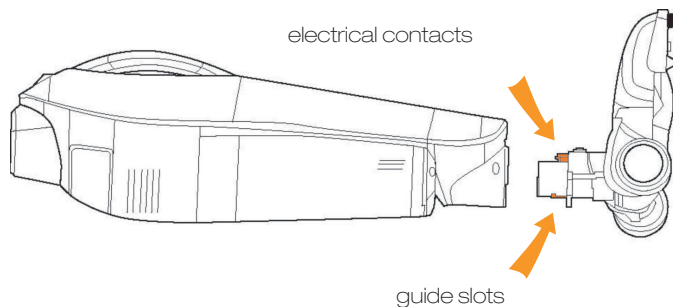

## Assembly of the Handle

As shown below, pressing the handle release button will allow for the handle to be removed from the main unit. To reinstall, simply reinsert the handle making sure the guide slots line up.

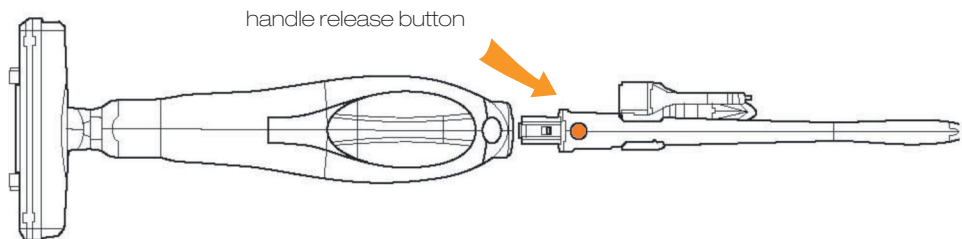

# Operation

1. It is necessary for the rechargeable battery to be fully charged prior to use.
2. The charger is uniquely designed for the rechargeable Ni-MH battery, rating:  
Input: 220-240V~50 Hz, 50mA; Output: 16V dc at 280mA; Class: II
3. After inserting the plug of the charger into the electrical socket, the power light (green) will illuminate. Insert the rechargeable battery module, this will cause the charge indicator light (red) to blink. Battery will be fully charged after 8 hours when red light is solid (not blinking).
4. Once the battery is fully charged, it can be placed into the unit. Before doing so, be sure to switch the power "OFF" to prevent any possible electrical discharge.

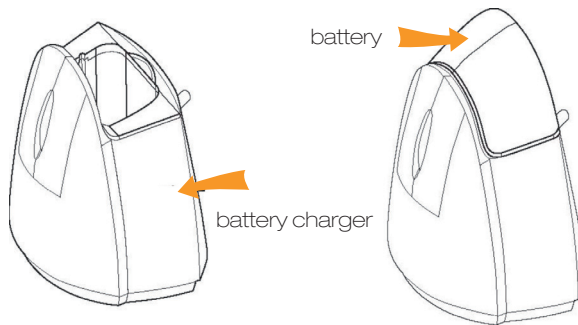

## Battery removal

Removing the rechargeable battery is done by simply pressing the battery release button located on the side of the unit as shown below.

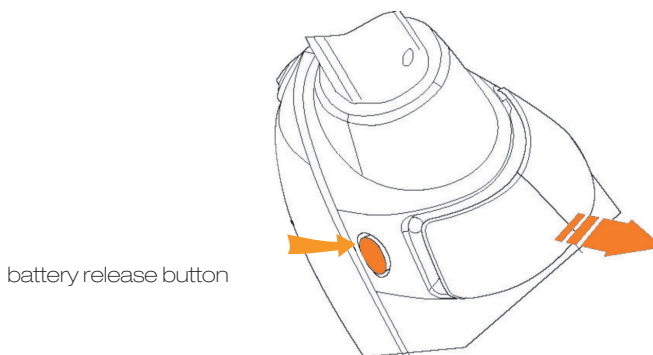

# Operation

## Accessory Items

Included with this unit are two accessory items: a crevice tool and upholstery brush.

### A) Crevice Tool

Shown below, the crevice tool is attached for cleaning in tight spaces.

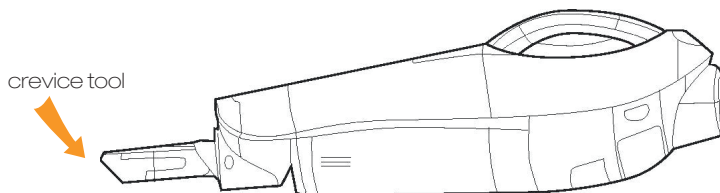

### B) Upholstery Brush

With the crevice tool still attached, affix the upholstery brush to the end of the crevice tool as indicated below.

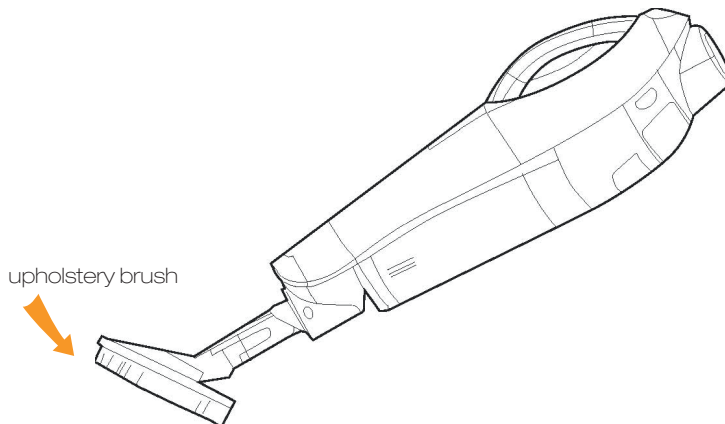

# Maintenance (Keep your Vax as good as new)

## 1. Dirt Cup filter

After emptying the dirt cup, the filter can also be cleaned at the same time. By grasping the filter screen guard in one hand, use the opposite hand to rotate the handle as indicated by the arrow direction shown on the top of the filter. Once removed, the filter can be shaken off to remove any collected debris.

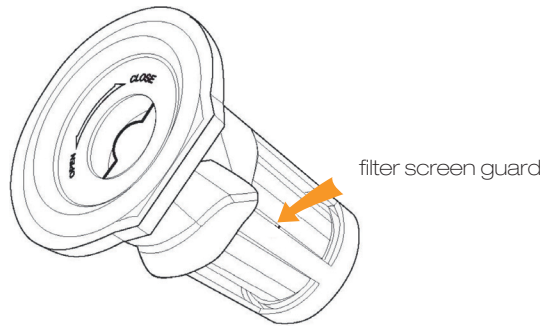

## 2. Air intake screen

As shown below, the air intake screen can be removed and cleaned in warm soapy water. Once completely dry, it can be placed back into the unit.

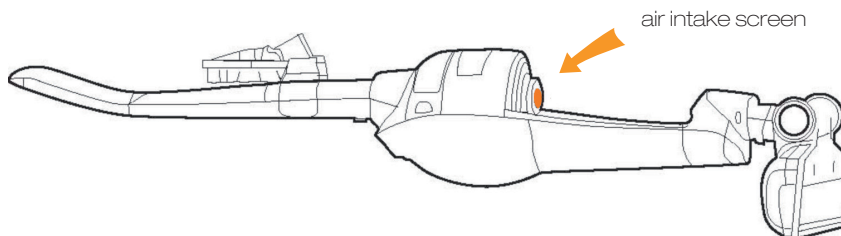



# FAQs



**WARNING:** to reduce the risk of personal injury, unplug the vacuum cleaner before performing maintenance/troubleshooting checks.

## Is there an accessory missing?

- Check the 'Machine Overview' page in this guide to make sure the part is definitely included in your unit.
- If it is missing, we're here to help. Simply call us on **AU: 1300 361 505 / NZ: 0800 800 900**

## Why won't the accessories pick up properly?

- The accessory may be blocked: Refer to the Maintenance section (Page 7).
- The accessory may be faulty: call our Vax Careline to order a replacement: **AU: 1300 361 505 / NZ: 0800 800 900**

## Why won't the vacuum cleaner pick up?

- The filters may be clogged: Refer to the Maintenance sections (Page 8).
- The Dirt Container is full or blocked: Refer to the Maintenance sections (Page 4,8).
- The Dirt Container may be incorrectly installed: Refer to the Maintenance sections (Page 8).

## Why is dust escaping from the vacuum?

- The filters may not be installed correctly. Refer to the Maintenance sections (Page 8).
- The Dirt container may be incorrectly installed: Remove the Dirt Container from the unit by pressing the Dirt Container Release Button (Page 4) and reattach it to the unit, ensuring it is locked firmly back into place.
- The filters may be clogged: Refer to the Maintenance sections (Page 8).

## What do I do if an accessory/the unit becomes damaged or broken?

- Visit [www.vax.com.au](http://www.vax.com.au) for parts and spares.
- Please call our Vax careline to purchase new spares or order a replacement:

**AU: 1300 361 505 / NZ: 0800 800 900**



we  to help

Don't take your machine back to the shop, simply contact us

**AU: 1300 361 505**  
**NZ: 0800 800 900**  
[www.vax.com.au](http://www.vax.com.au)

# Other Information

## Vax Service & Help

Vax Customer Careline AU: 1300 361 505 / NZ: 0800 800 900

Monday-Friday 8.30am to 5.30pm

Any queries or concerns about using the Vax, call the Vax Careline. Calls are charged at the Standard national rate.

Please make a note of the serial number and model number of the carpet cleaner before calling. For the nearest Service Agent, please call the Vax Customer Careline or visit [www.vax.com.au](http://www.vax.com.au)

## Technical Specification

### Vacuum Cleaner

Volts 14.4V d.c.  
Capacity: 700ml  
Filters: Air Inlet: HEPA & Mesh filter (washable)  
Air outlet: Foam filter  
Weight: 3.8kg

### Charger

Voltage Input: 220-240V~50Hz  
Output: 16V d.c at 280mA

Suitable for battery supplied with Vax Mach VMST144V Stick Vacuum Only.



N197



### Battery

Battery charge

time: 7-8 hours

Approx run

time: 12-18 minutes

Subject to technical change without notice.

Waste electrical products should not be disposed of with household waste. Please recycle where facilities exist. Check with your Local Authority or retailer for recycling advice.

# Notes

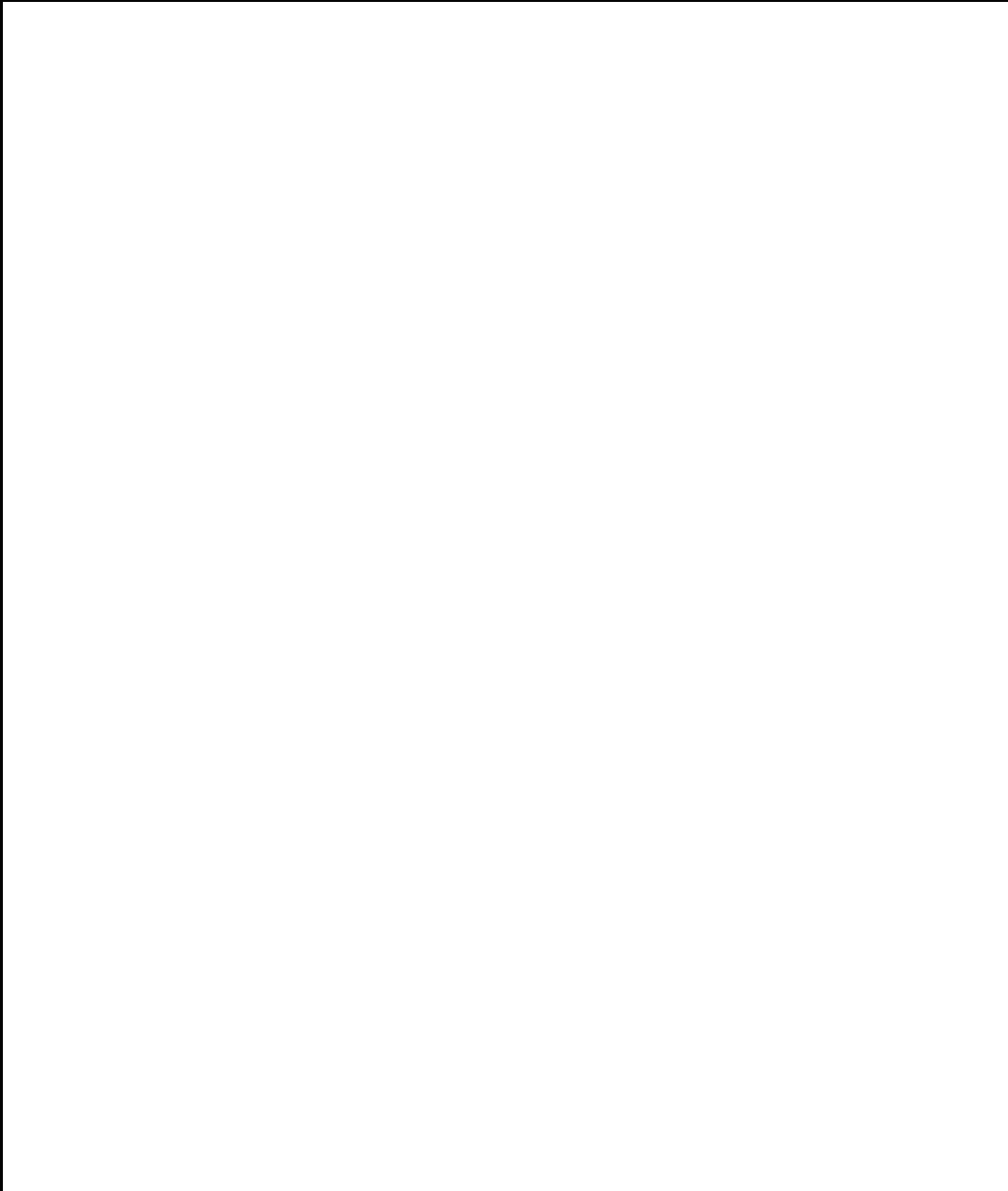



we  clean

Distributed by Techtronic Industries Pty. Ltd.  
Level 1, 666 Doncaster Rd, Doncaster, Australia 3108.  
[www.vax.com.au](http://www.vax.com.au). Service Line: AU: 1300 361 505 / NZ: 0800 800 900