



# 'DON'T TAKE IT BACK TO THE SHOP!'

Congratulations on the purchase of this Vax product. In the unlikely event of experiencing a problem, call

## VAXCARE



Australia **1300 36 4040**

(Monday - Friday 10am - 6pm EST)

Email: [vaxcare@vax.com.au](mailto:vaxcare@vax.com.au)

New Zealand **0800 800 900**

Email: [vaxnz@vax.co.nz](mailto:vaxnz@vax.co.nz)

[www.vax.com.au](http://www.vax.com.au)



[www.vax.com.au](http://www.vax.com.au)

**Vaxcare:**  
**AUST: 1300 36 4040**  
**NZ: 0800 800 900**

# Spirit VR300 RECHARGEABLE 2 IN 1 vacuum cleaner

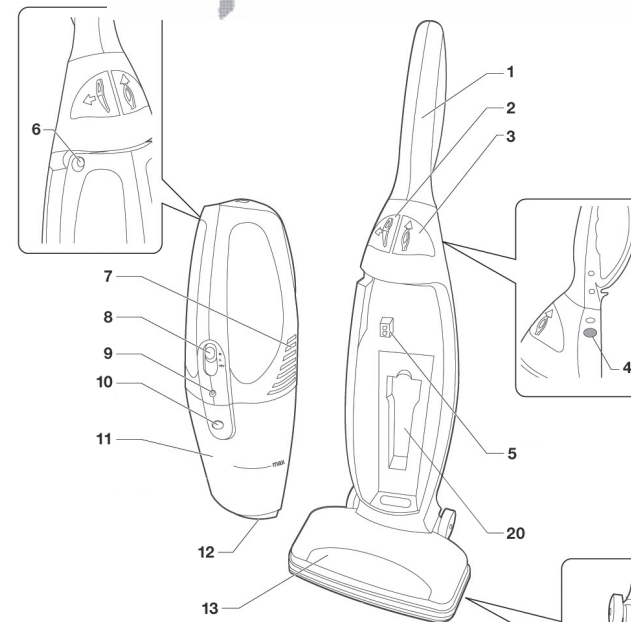

2. Power Unit/Hand Vac Release Button
3. Telescopic Handle Release Button
4. Handle Removal Button
5. Power Terminals
6. Charging Jack
7. Grill
8. On/Off Power Switch
9. Charging Light
10. Dust Cup Release Button
11. Dust Cup (container)
12. Suction Inlet
13. Brush Bar Window
14. Brush Bar
15. Motor Fan Grill
16. Filter Adapter
17. Dust Cup Filter
18. Transformer
19. Crevice Tool
20. Crevice Tool Storage Compartment

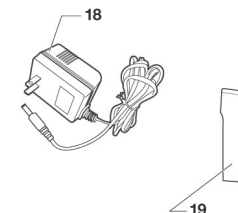
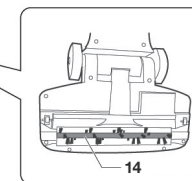
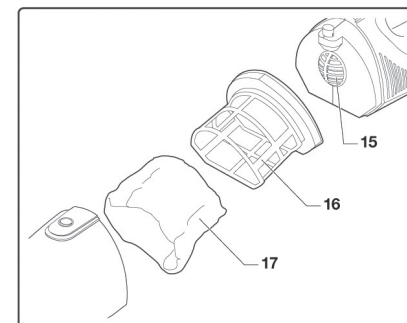

**\*Illustrations may differ from actual product**  
**NOTE:** Your cordless vacuum is supplied with the batteries uncharged. Charge the unit for 20 hours prior to first use is required.

## 1. Important Safeguards

When using this electrical appliance, basic precautions should always be observed, including the following:

READ ALL INSTRUCTIONS BEFORE USING THIS APPLIANCE

**WARNING:** To reduce the risk of fire, electrical shock, or injury:

1. Do not charge this unit outdoors.
2. Do not use outdoors or on wet surfaces.
3. This appliance is not intended for use by young or infirm persons unless they have been adequately supervised by a responsible person to ensure that they can use the appliance safely. Young children should be supervised to ensure that they do not play with the appliance.
4. Use only as described in this manual. Use only manufacturer's recommended attachments.
5. Do not use charger if power cord has been damaged. Do not use cordless hand vacuum or charger if it has been dropped, damaged, left outdoors, or dropped in water. Return it to an Authorised Vax Service Agent for examination, repair or adjustment.
6. Do not abuse the charger cord. Never carry the charger by the cord or yank to disconnect from an outlet; instead grasp the plug and pull to disconnect.
7. Keep charger cord away from heated surfaces.
8. This product includes rechargeable nickel cadmium batteries. Batteries must be recycled or disposed of properly. **Do not incinerate batteries or expose to high temperatures, as they may explode.**
9. Do not handle plug or appliance with wet hands.
10. Do not put any object into openings. Do not use with any opening blocked; keep free of dust, lint, hair and anything that may reduce air flow.
11. Keep hair, loose clothing, fingers, and all parts of body away from openings and moving parts.

12. Do not pick up anything that is burning or smoking, such as cigarettes, matches, or hot ashes.
13. Turn off all controls before unplugging.
14. Do not attempt to change accessories while unit is running.
15. Use extra care when cleaning on stairs.
16. Do not use to pick up flammable or combustible liquids such as gasoline or use in areas where they may be present.
17. Do not use charger with an extension cord. Plug charger directly into an electrical outlet. Use charger only in a standard (220-240V/50Hz) electrical outlet.
18. **Do not use the hand vacuum cleaner without dust cup filter in place.**
19. Store the cordless vacuum indoors. Put the cordless vacuum away after use to prevent accidents.
20. Leaks from battery cells can occur under extreme conditions. If the liquid, which is 20-35% solution of potassium hydroxide, gets on the skin - wash immediately with soap and water or neutralize with a mild acid such as lemon juice or vinegar. If the liquid gets into the eyes, flush immediately with clean water for a minimum of 10 minutes and seek medical attention.
21. Use only on dry, indoor surfaces.
22. Do not use for any purpose other than described in this user's guide.
23. Do not attempt to use the charger with any other product nor attempt to charge this product with another charger. **Use only the charger supplied with this appliance.**  
**WARNING:** Do not use to charge non-rechargeable batteries.
24. The battery must be removed from the appliance before it is discarded.
25. The battery is to be recycled or disposed of safely.
26. The appliance must be disconnected from the supply when removing the battery.
27. Turn off all controls before unplugging.

## SAVE THESE INSTRUCTIONS

For Household Use Only

## 8. Troubleshooting

### PROBLEM: Hand vacuum will not operate

**Cause:** Batteries discharged.

**Solution:** Charge unit.

---

**Cause:** Dead battery (battery won't hold charge).

**Solution:** Replace battery pack.

---

**Cause:** No power in electrical outlet supplying transformer.

**Solution:** Check fuse or breaker. Replace fuse/reset breaker

---

### PROBLEM: Motorised brush will not work

**Cause:** The agitator is blocked with debris or string.

**Solution:** Remove debris from agitator. If there is string or thread wrapped around the brush bar, carefully cut with scissors.

---

**Cause:** The belt is broken.

**Solution:** Call VAXCARE or take to an Authorised Vax Service Agent.

---

**Cause:** Power unit/hand vac is not seated correctly.

**Solution:** Seat the power unit/hand vac correctly.

---

### PROBLEM: Hand vacuum will not pick-up or suction power is weak

**Cause:** Dust cup container is full.

**Solution:** Empty dust cup container.

---

**Cause:** Dust cup filter needs cleaning or replacement.

**Solution:** Remove dust cup filter and check for object(s) in air duct and remove.  
Clean or replace dust cup filter.

---

**Cause:** Unit needs recharging.

**Solution:** Charge unit.

---

### PROBLEM: Dust escaping from hand vacuum

**Cause:** Dust cup container is full.

**Solution:** Empty dust cup container.

---

**Cause:** Dust cup filter is not installed correctly.

**Solution:** Review dust cup filter installation instructions.

---

**Cause:** Puncture/hole in dust cup filter.

**Solution:** Replace dust cup filter.

---

### PROBLEM: Battery will not hold charge

**Cause:** Battery has reached the end of its service life.

**Solution:** Call VAXCARE or take unit to an Authorised Vax Service Agent.  
Review battery removal and disposal section.

---

**Please Note:** The Dust Cup Filter is washable. It should, however, be replaced every three (3) to six (6) months depending on usage to ensure peak performance of your vacuum.

**Important:** Make sure that Dust Cup Filter has completely air dried before re-installing back in the hand vacuum.

**Warning:** Always remove the hand vacuum from the power unit before cleaning the power brush.

## 6. Battery Removal & Disposal

The cordless hand/stick vacuum is powered by Nickel-Cadmium (Ni-Cd) batteries, which must be recycled or disposed in accordance with local requirements. The battery pack used in this model is replaceable, however care should be taken when doing so. Follow these steps when replacement is required:

1. Remove the dust container by pressing the dust cup release button.
2. Turn the handheld on its side with the four screws facing towards you.
3. Using a phillips head screwdriver, remove all four screws and separate the two halves of the motor cover.
4. The battery is now accessible, and is comprised of two parts, linked together by a connecting wire. Be careful not to move any other components.
5. Disconnect the two battery clips from the battery terminals.
6. Remove the battery assembly from its locating compartment.
7. Fit the new battery into the battery compartment.
8. Reconnect the battery clips to the battery terminal.
9. Replace the outer cover and ensure that the two cover halves fit together properly.
10. Screw in the four screws removed earlier.
11. Charge the battery for a minimum of 20 hours before use.

**Call your nearest recycling centre or local authority for information on the recycling and disposal of Ni-Cd batteries. Do NOT** replace the batteries used in this product with any other type of battery.

### CAUTION:

- Use only with the battery pack supplied with the unit.
- Do not attempt to remove the battery pack from the unit to charge it.
- Never throw the battery pack or unit into a fire or incinerate.
- Do not attempt to remove or damage the battery casing.
- Battery must be recycled or disposed of properly at the end of its service life.



## 7. Technical Specifications

Model Name:	Spirit
Model Number:	VR-380
Part Number:	55000
Charger Supply Voltage:	220-240V/50Hz
Battery:	14.4 V Ni-Cd
Dust Capacity:	600ml
Filter:	Cage and Filter
Weight:	3kg

**Subject to technical change without notice**

### VAXCARE Service & Help AUSTRALIA 1300 36 4040 NEW ZEALAND 0800 800 900

If you have any queries or concerns about using your Vax, call VAXCARE. Please make a note of the serial number and model number of the appliance before calling.  
(Aust only: Mon-Fri. 10.00am to 6.00pm. EST)  
Calls are charged at the local rate.  
An answerphone is available outside of these hours.

There are over 300 approved Vax Service Agents in Australia and New Zealand. For the nearest Service Agent, please call VAXCARE or visit [www.vax.com.au](http://www.vax.com.au)

## 2.Assembly

**NOTE:** Ensure that the unit is not connected to the charger before assembling the handle.

1. Align the telescopic tube on the handle with the opening on the power unit housing (Fig/2.1).
2. Slide the telescopic tube into the opening until it is seated firmly into position.
3. Push on the telescopic handle release button to adjust the height of the handle.

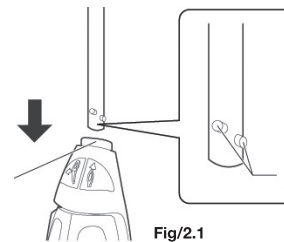

## 3. Charging Your Vacuum Cleaner

Before using the vacuum, charge the vacuum cleaner for a minimum of 20 hours.

**NOTE: Ensure that the On/Off switch on the hand vac is in the "Off" position before charging.**

**NOTE:** The power unit/hand vac does not have to be in the power unit/hand vac receptacle to charge the battery.

1. Place the vacuum near an electrical power outlet (220-240V/50Hz) and plug in the charger.
2. Connect the charger to the charging jack (Fig/3.1).

The red charging indicator light will illuminate when the vacuum cleaner is being charged.

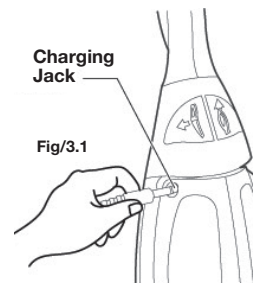

3. The vacuum cleaner will run for maximum operational time only if it has been fully charged. The normal full charging time for this vacuum is 20 hours. To fully charge the unit, run the vacuum cleaner until it stops, then fully recharge the battery.

**NOTE:** Peak performance may only be attained after the unit has been charged and discharged two (2) or three (3) times.

## To Maximize the Life of your Ni-Cd Batteries

1. Charge for a minimum of 20 hours before initial use. Failure to do so will significantly reduce the battery life.
2. **Do not store the unit with the charging adaptor attached and plugged in.**
3. Only recharge when the batteries are fully discharged (or as close to fully discharged as possible).
4. Do not store in areas of high temperature or humidity.
5. **NOTE:** Fully discharge, then completely re-charge the unit at least once a month.
6. After three (3) months of storage, the appliance should be fully discharged and then recharged to maximize battery power.
7. Only use the charger supplied. If other chargers are used, damage to the battery, appliance or personal property could be caused.
8. Ni-Cd batteries have a long useful life but at some time they will need to be replaced.

### NOTE:

1. The on/off switch must be in the "OFF" position in order to charge the unit.
2. If the appliance has never been used or has been stored for an extended period of time without use - it will take several complete charge and discharge cycles to fully charge the batteries for maximum performance.

## 4. Assembly of Dust Cup

**Note:** Ensure that the unit is not connected to the charger before fitting or cleaning the dust cup (container).

1. To open the dust cup compartment, push the dust cup release button and remove the dust cup container (Fig/4.1).
2. Ensure that the dust cup filter is inside, then re-attach the dust cup container to the hand vacuum (Fig/4.2).

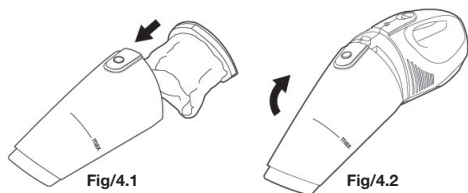

## Detaching the Power Unit/Hand Vac from the Power Unit Housing

**NOTE:** The floor brush will not function without the power unit/hand vac in place and fully charged.

1. To remove the power unit/hand vac from the power unit housing, depress the power unit/hand vac release button (Fig/4.3).
2. Grasp the handle of the power unit/hand vac and pull out.
3. To replace the power unit/hand vac into the power unit/hand vac receptacle, place the bottom of the power unit/hand vac into the receptacle first, then tilt towards the power unit housing until it audibly clicks into place.

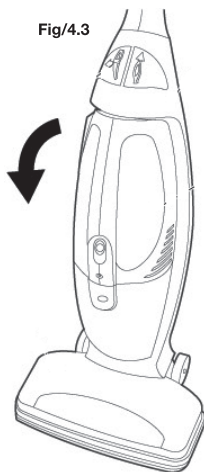

## 5. Using the Vacuum

**NOTE:** The floor brush will not function without the power unit/hand vac in place and fully charged.

The vacuum is ideal for cleaning stairs and awkward areas.

1. Ensure that the power unit/hand vac is in position on the power unit housing.

## Extending the Telescopic Handle

The vacuum is equipped with a telescopic handle to increase the reach when vacuuming.

1. To extend the handle, depress the telescopic handle release button (Fig/5.1).
2. Hold down telescopic handle release button while pulling the handle up until it clicks into place.
3. To decrease the length of the handle, depress the telescopic handle release button and push the handle in until it clicks into place.

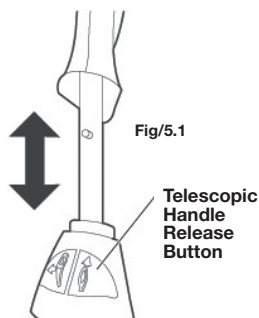

## Using the Crevice Tool

The crevice tool can be used by attaching it directly to the power unit/hand vac.

**To attach crevice tool to the power unit/hand vac:**

1. Remove the power unit/hand vac from the main unit.
2. Attach the crevice tool directly into the suction nozzle of the power unit/hand vac (Fig/5.2).

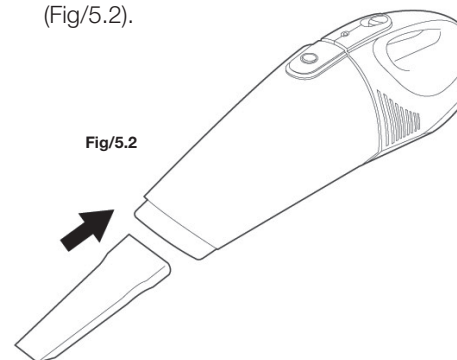

## 6. Changing & Cleaning the Dust Cup Filter

**Note:** Ensure that the unit is not connected to the charger before fitting or cleaning the dust cup (container).

**To achieve the best performance, empty the dust cup container and clean the dust cup filter after each use.**

1. Remove the power unit/hand vac from the power unit/hand vac receptacle.
2. To remove the dust cup container, press down on the dust cup release button and pull off the dust cup container.
3. Pull out the dust cup filter and empty the dust from the dust cup container (Fig/6.1).

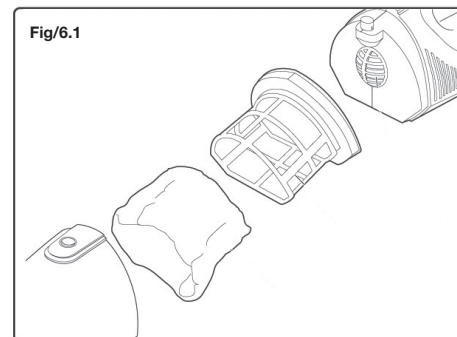

4. Rinse the dust cup filter in cold water. **Wait until it air dries completely before replacing it back into the dust cup container.**

Do not machine wash to clean the dust cup filter. Do not use a hair dryer to dry it. **Air dry only.**

5. Replace the dust cup filter carefully into the dust cup container. **NEVER** operate vacuum cleaner without dust cup filter in place.
6. Attach the dust cup container to the power unit/hand vac.

**CAUTION:** The suction nozzle must be open and free of any obstruction at all times to prevent the motor overheating which could cause damage.

**NOTE:** To ensure peak performance, it is recommended that the dust cup filter be replaced every three (3) to six (6) months depending on usage.

## Replacement Dust Cup Filters

Replacement dust cup filters are available from your Vax stockist or Vax direct. Phone Vaxcare or visit: [www.vax.com.au](http://www.vax.com.au)