

monster[®]



MONSTER COMPACT STEAM CLEANER (SC60) **INSTRUCTION MANUAL**



eurolflex[®]

Model #: SC60 AUS, NZ

IMPORTANT SAFE T

When using an electrical appliance, basic safety precautions should always be observed, including the following:

Read all instructions before using this appliance.

WARNING: To reduce the risk of fire, electrical shock, or injury:

1. This appliance is authorized for household/domestic use only. Commercial use will void the warranty.
2. Do not immerse the Steam Cleaner in water or other liquids. Always turn off and unplug appliance when filling with water.
3. Do not allow to be used as a toy. Close attention is necessary when used by or near children, pets or plants. Do not leave Steam Cleaner unattended. Always unplug unit when not in use. Keep out of reach of children.
4. Use only as described in this manual. Use only manufacturer's approved and supplied parts and accessories. Use of other accessories is not recommended and will void the warranty.
5. Do not use if the steam hose, accessories, power cord or plug has been damaged, or if any part of appliance has been dropped, damaged, left outdoors, or dropped in water. Do not attempt to disassemble or repair appliance. Return it to the manufacturer or an authorized service center for examination or repair.
6. Do not wrap cord too tightly around appliance. Never carry by the cord, or yank to disconnect from an outlet. To unplug, always grasp plug to remove from outlet – do not pull on cord.
7. Do not handle cord or appliance with wet hands or without shoes on.
8. Keep cord away from heated surfaces (e.g., cooking surfaces), and sharp edges and corners.
9. Follow all labels and marking instructions on Steam Cleaner.
10. Do not put any objects into openings. Do not use with any opening blocked.
11. Keep hair, loose clothing, fingers, and all parts of body away from openings and moving parts. The steam released from the appliance is extremely hot at the point that it exits the steam hose or accessory. Avoid direct contact with steam jet.
12. Before filling with water or emptying, always turn appliance off, unplug appliance and allow it to cool completely. Always turn the Boiler Cap slowly to open the boiler – this will allow any remaining steam to escape gradually.
13. Use caution while emptying the appliance. Contact with hot metal parts, hot water or steam may cause burns.
14. Be sure Boiler Cap is (and remains) closed during use.
15. Never use cleaning solutions, perfumes, oils or other chemical substances other than tap or distilled/demineralized water in the Steam Cleaner. Use of chemicals may damage appliance and will void your warranty.
16. When in use, never turn the appliance on its side. Do not direct steam at people, animals or other electrical equipment (i.e. inside an oven). The appliance should be used while the unit is resting on the ground.

SAFETY INSTRUCTIONS

SAVE THESE INSTRUCTIONS

17. Do not operate around flammable or combustible liquids such as gasoline, or in areas where fumes may be present. Do not operate outdoors if wet.
18. To reduce the likelihood of circuit overload, do not operate another high wattage appliance on the same circuit. Plug in to a standard earthed (220-240V, 50-60Hz) electrical outlet.

ATTENTION: This appliance is equipped with a 3-prong grounded power cord. Insert only into a 3-prong grounded electrical outlet. Do not try to remove the contacts of the grounded connection.

19. Do not use extension cords or outlets with inadequate voltage. Use a 10-ampere extension cord. Lower amperage cords may overheat.
20. Store appliance indoors in a cool, dry place, and out of reach of children when not in use.
21. If appliance is damaged, it must be repaired by manufacturer or its service agent, in order to avoid safety issues to the operator.
22. This appliance is not intended for use by persons (including children) with reduced physical, sensory or mental capabilities, or lack of experience and knowledge, unless they have been given supervision or instruction concerning use of appliance by a person responsible for their safety.
23. Read and follow all important notices in this guide.

CAUTIONS

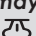
- *Always drain condensed water from hose before use or if unit has been left idle for a period of time. To drain hose, direct Nozzle into a sink or other appropriate container and slide the trigger forward on the Steam Gun. Once hose is emptied, normal use may be resumed. Never direct nozzle towards people, animals or plants.*
- *Extreme care should be taken when opening the Boiler Cap as it may become hot during use and escaping steam can cause scalding.* 

IMPORTANT

Please read all of the instructions for use and Important Safety Instructions carefully. Remove and discard all packaging materials and keep them out of the reach of children.

Please contact the Customer Support Line should you require further information or instructions not contained in this manual.

Euroflex discharges itself of any responsibility for damage or injury to persons or property, in the event that the appliance is damaged as a result of improper use, unauthorised repair, unauthorised maintenance work or use of the appliance that is not consistent with the instructions contained in this instruction manual.

One (1)
Steam Cleaner

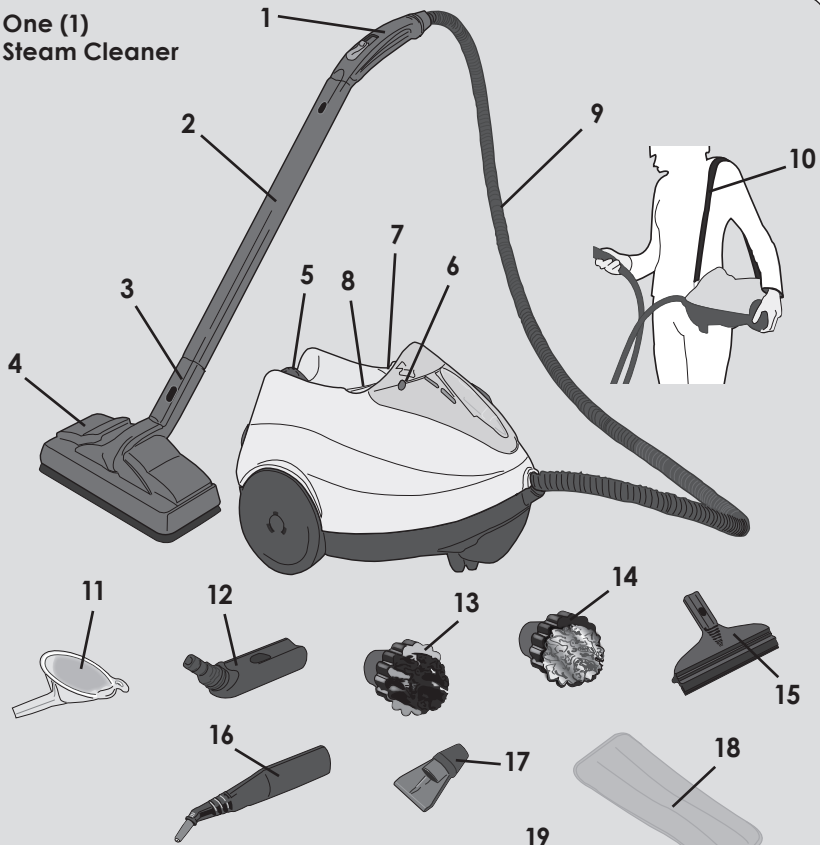

- 1 - Steam Gun
- 2 - (2) Extension Tubes
- 3 - Floor Brush Adapter
- 4 - Floor Brush
- 5 - Boiler Cap
- 6 - Power Indicator Light (orange)
- 7 - Steam Ready Light (green)
- 8 - Power Switch
- 9 - Flexible Steam Hose
- 10 - Shoulder Strap
- 11 - Filler Funnel
- 12 - Small Brush Adapter
- 13 - Nylon Detail Brush
- 14 - Brass Detail Brush
- 15 - Window Squeegee
- 16 - Detail Nozzle
- 17 - Scraper
- 18 - Floor Brush Microfibre Pad
- 19 - Caddy/Wall Bracket
- 20 - Small Brush
- 21 - Small Brush Microfibre Pad
- 22 - Bristle Tray
- 23 - Filling Jug

Technical Data

Adapter Input: 220-240V~, 50-60Hz
Power: 1450 watts
Boiler: Stainless Steel
Boiler Capacity: 1.2 liter/2 pints
Max. Steam Temp.: 130°C/266°F

1 The Compact Steam Cleaner Features

1. No need for detergents or chemicals. Just add water.
2. Lightweight and compact.
3. Ergonomic, lightweight Steam Gun.
4. Steam Gun locks in as carry handle.

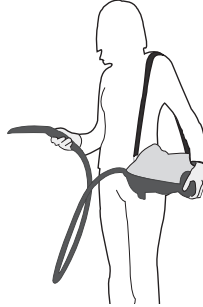

5. Versatile, quick-change accessories.

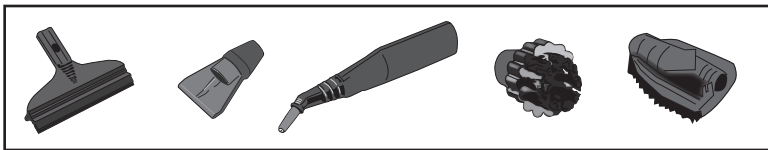

6. On/Off steam control.
7. Stainless Steel Boiler – non-corroding, reduces calcium buildup.
8. Multiple uses – clean bathrooms, kitchens, living areas, pet areas, appliances and much more.

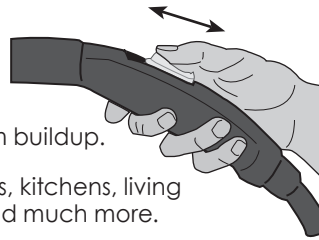

2 Accessories - Attachment & Descriptions

A. Connecting Floor Brush Adapter to Floor Brush

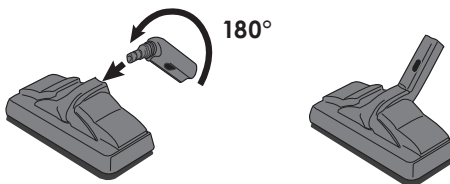

WARNING: Always ensure steam trigger is off and not steaming when attaching an accessory to the unit.

Continued on next page

2 Accessories *(continued)*

B. Attach Extension Tube to Window Squeegee

The Window Squeegee is very useful for cleaning large windows and glass.

To use: Connect Window Squeegee to Steam Gun or Extension Tube(s) for hard to reach surfaces. Apply steam liberally, rub with soft spongy edge, then remove excess water and dirt with squeegee edge. Wipe dirt from Squeegee blade.

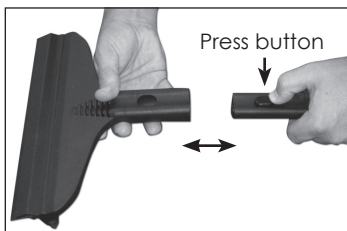

CAUTION: When cleaning windows, always avoid any sudden changes in temperature to prevent glass breakage or cracks.

C. Attach Extension Tube to Detail Nozzle

The Detail Nozzle is very useful for cleaning hard to reach areas. It is ideal for radiators, door and window tracks, shutters and sanitary fixtures.

To use: Attach Detail Nozzle directly to the Steam Gun or Extension Tubes.

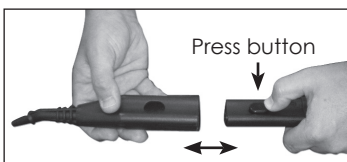

D. Attach Nylon or Brass Detail Brush to Detail Nozzle

The Nylon or Brass Detail Brush is best for cleaning grout between tiles, ceramic and marble.

To use: Push the Nylon/Brass Detail Brush on the end of the Detail Nozzle. (*Detail Nozzle should be connected to the Steam Gun or Extension Tubes.*)

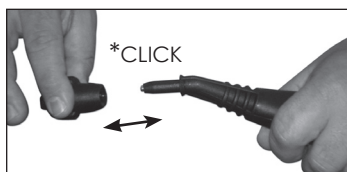

E. Attach Scraper to Detail Nozzle

The Scraper is best for removing small amounts of wallpaper and also anything that can be scraped from a flat surface, e.g., grease deposits in an oven. It is also useful when defrosting freezers.

To use: Push the Scraper on the end of the Detail Nozzle. (*Detail Nozzle should be connected to the Steam Gun or Extension Tubes.*)

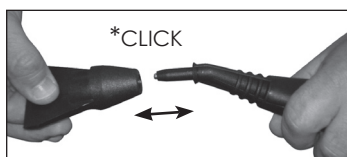

F. Connecting Brush Adapter to Small Brush

The Small Brush attaches to your Steam Cleaner just like the Floor Brush, and is used for smaller areas that the Floor Brush cannot easily reach, such as corners of floors and on stairs.

To use: Attach Small Brush to Small Brush Adapter. Attach Extension Tube to Adapter by pressing the locking button while sliding Tube into Brush Adapter. Be sure button and hole line up (see visuals "B" and "C" above) and button locks in place.

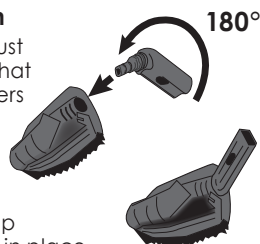

3 Filling Steam Cleaner with Water

WARNINGS

- Carefully read all instructions before removing Boiler Cap.
- Always switch off the appliance and be sure it has cooled before filling the Boiler.

IMPORTANT

Use ordinary tap water. Use distilled or demineralized water if tap water is too hard. DO NOT add detergents, perfumes, oils or other chemical substances.

Follow these instructions to avoid overfilling the Boiler.

- Be sure the appliance is switched off at the Power Switch and unplug the appliance from the power outlet.
- Carefully remove the Boiler Cap by turning it counter-clockwise.
- Pour in a maximum of 1.2 litres / 2 pints of water using the Filler Funnel provided. Do not overfill the Boiler, excess water in the Boiler will be flushed out of the unit, resulting in wet floors or wet surfaces when cleaning.
- Dry steam will only emit if the Boiler is not overfilled.
- Replace the Boiler Cap by turning it clockwise. Do not over-tighten the Boiler Cap, finger tight is sufficient.
- Plug electrical cord into a 3-prong grounded power outlet.
- Turn on the Power Switch.
- The Steam Cleaner will heat up, produce steam and the Boiler will become pressurised.
- When the green Steam Ready Light turns on the Steam Cleaner is ready to use. Note: the green Steam Ready Light may turn on and off during use, this is normal and not a fault.
- If using cold water, heating time is about 6-7 minutes. Using hot water will reduce the heating time.

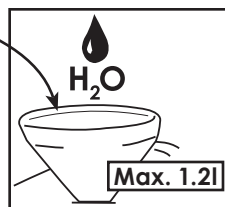
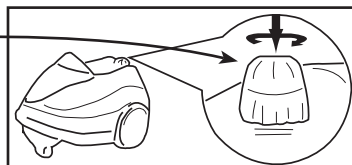

NOTE: Do not turn on Steam Cleaner if Boiler is empty.

4 Connecting Extension Tube(s)

- Attach one Extension Tube to Steam Gun on Flexible Steam Hose.
- To attach Extension Tubes together, press down the locking button while sliding Tubes together. Be sure button and hole line up and button locks in place. To disconnect, press the locking button and pull the two sections apart.

WARNING: Always ensure steam trigger is off and not steaming when attaching an accessory to the unit.

5 Attaching Floor Brush to Extension Tube

A. Attach Brush Adapter to Floor Brush

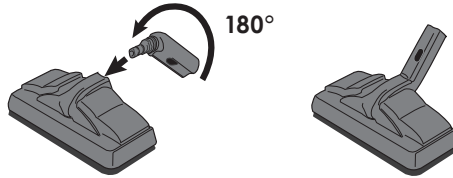

B. Attach Floor Brush & Adapter to Extension Tube

Attach Extension Tube to Brush Adapter by pressing the locking button while sliding Tube into Brush Adapter. Be sure button and hole line up and button locks in place. To disconnect, press the locking button and pull the two pieces apart.

6 Attaching Microfibre Pads to Brushes

A. Attaching Microfibre Pad to Floor Brush – A Microfibre Pad can be fitted on the Floor Brush to absorb dirt and protect delicate surfaces. It can also be used on vertical washable surfaces following the same procedure as for the floor.

1. Place Floor Brush on Microfibre Pad.

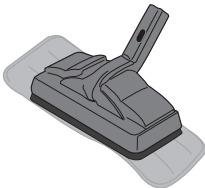

2. Place one end under pad holder (as shown).



3. Repeat for other end of Brush, pulling Pad to stretch it taut.



B. Attaching Microfibre Pad to Small Brush – A fitted Microfibre Pad should be placed over the bristles of the Small Brush to clean smooth surfaces such as kitchen cupboards, splash backs, countertops, etc. Fit the Small Microfibre Pad over the Small Brush as shown below.

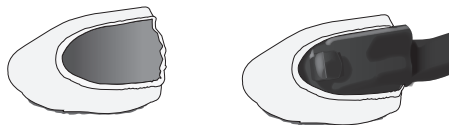

WARNING: The Microfibre Pad around the Floor Brush or the Small Brush can become hot enough to scald or cause burns. Make sure you let the Pad cool before touching it.

7 Attaching Bristle Tray to Floor Brush

For rough or textured floor surfaces, the steam may not be sufficient to dislodge dirt that is trapped within the surface of a rough or textured floor. In order to dislodge dirt trapped in the surface, the Bristle Tray will need to be attached to the bottom of the Floor Brush to help scrub the rough or textured surface.

1. Unscrew the screws found on the bottom of the Floor Brush, remove the smooth tray at the bottom of the Floor Brush.

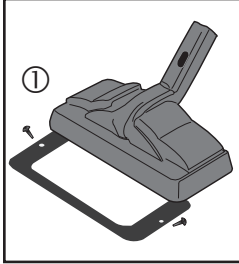

2. Insert the Bristle Tray and screw into place using the screws.

Use the bristles at the bottom of Floor Brush to help remove dirt trapped within the floor surface. Attach the Microfibre Pad to absorb the dirt. If the Microfibre Pad becomes too wet or dirty, replace with a clean pad and continue cleaning.

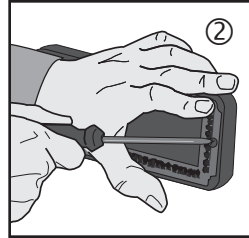

8 Attaching Shoulder Strap

Using the detachable Shoulder Strap allows for greater freedom of movement when both hands are needed for cleaning tasks, or to reach higher places.

To attach Shoulder Strap to the Steam Cleaner, simply snap Shoulder Strap hooks on the connecting rings found on unit.

When using Steam Cleaner with the Shoulder Strap, avoid rocking or tilting the unit excessively as this may cause water to enter the hose and be discharged along with the steam.

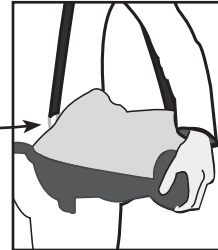

CAUTION: We recommend testing the weight of the Steam Cleaner before using it with the Shoulder Strap. This is to prevent potential injury and ensure it is not too heavy for you to carry comfortably.

9 Steam Release

To release steam from the Steam Cleaner, slide forward the trigger found on the Steam Gun. Steam will continue to be released while the trigger is in the forward position. To stop the steam, slide the trigger backward.

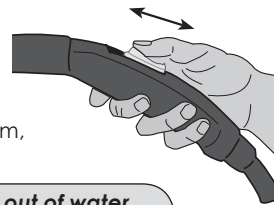

IMPORTANT: When the Steam Cleaner has run out of water, steam output will cease. Follow refill instructions (page 10) to use your Steam Cleaner again.

10 Refilling the Boiler During Use

When water in the boiler runs out, steam will stop emitting from the Steam Cleaner. To refill the Boiler with water, follow the steps below:

- Switch off the Steam Cleaner by depressing the Power Switch and unplug the appliance from the power outlet.
- Carefully and slowly turn the Boiler Cap counter-clockwise. If a hissing sound is heard, residual steam and pressure remain in the Boiler. Wait until the last of the steam and pressure escapes and the hissing stops before removing the Boiler Cap.
- Take care of where the Boiler Cap is placed as the underside of the cap is very hot. Ensure there are no children present who may pick up the hot cap and cause burns to themselves.
- Allow the Steam Cleaner to cool for at least 5 minutes before refilling with water.
- Refill the Boiler with a maximum of 1.2 litres (2 pints) of water using the Filler Funnel. (Note: only use the Filler Funnel supplied. Its nozzle is made from a heat resistant material to prevent it from melting when filling a hot boiler. Other plastic funnels can melt and become welded to the inside of the boiler spout, voiding the product's warranty).
- Be extremely careful when refilling with water, as the interior of the Boiler is very hot. Water may spurt out as hot water or hot steam causing burns.
- Do not overfill the Boiler, excess water in the Boiler will be flushed out of the unit, resulting in wet floors or wet surfaces when cleaning. Dry steam will only emit if the Boiler is not overfilled.
- Replace the Boiler Cap by turning it clockwise. Do not over-tighten the Boiler Cap, finger tight is sufficient.
- Turn on the Power Switch.
- The Steam Cleaner will heat up, produce steam and the Boiler will become pressurised.
- When the green Steam Ready Light turns on the Steam Cleaner is ready to use. Note: the green Steam Ready Light may turn on and off during use, this is normal and not a fault.
- If using cold water, heating time is about 6-7 minutes. Using hot water will reduce the heating time.

WARNING: Do not open the Boiler Cap until there is no steam being release from the Steam Gun. If the Boiler Cap is opened while there is hot steam and pressure in the Boiler severe burns and injury can occur. If the Boiler Cap is turned and steam/pressure start to escape from the Steam Cleaner, unplug the Steam Cleaner from the power outlet and let the unit cool down for at least 15 minutes before attempting to refill or use the Steam Cleaner.

11 Turning Steam Cleaner Off

- To turn Steam Cleaner off, press the Power Switch and unplug the electrical cord from the power outlet.
- Any remaining water can be left in the unit.

REMINDERS

- We recommend using distilled or demineralized water as the best way to care for and utilize your Steam Cleaner.
- If tap water is too hard, use distilled or demineralized water to avoid the risk of staining pale colored fabrics.
- Do not add detergents, perfumes, oils or other chemical substances.

12 Cleaning Steam Cleaner

We recommend you periodically clean the Steam Cleaner to prevent the accumulation of calcium, mineral deposits and other sediment caused by the use of tap water. After every 10-15 refills, fill the Boiler three-quarters full of hot tap water, shake several times and empty out the water into a sink. Repeat several times to ensure that the Boiler is flushed of any calcium or mineral deposits. Wipe the Steam Cleaner with a damp cloth and dry.

NEVER HOLD THE STEAM CLEANER UNDER THE TAP TO FILL. Use the Filler Funnel provided to fill the Boiler.

If distilled or demineralised water is regularly used in the Steam Cleaner, cleaning of the Boiler can be done less frequently. In some areas tap water is very hard, it is recommended that the Boiler is cleaned more frequently if hard water is used.

The cleaning of the Boiler and Steamer is the sole responsibility of the appliance owner. Calcium, mineral deposits and other sediments left to build up in the Steam Cleaner causing it to fail and/or the steam pathways in the Steam Cleaner to block, is not covered by the product warranty. Users must follow the cleaning instructions above.

If the Steam Cleaner and Boiler is not cleaned according to the instructions above and the product fails and/or the steam pathways are blocked, the appliance owner should send the product for servicing by contacting the Customer Support Line.

The Steam Cleaner is intended for domestic household use only. It is not intended for commercial use. Any use other than for domestic household purposes will void the product warranty.

13 Replacement of Brushes, Microfibre Pads and Accessories

The Nylon and Brass Detail Brushes and the Microfibre Pad for the Small Brush and Floor Brush provided with the Steam Cleaner are to get you started using your Monster Compact Steam Cleaner. As these brushes and microfibre pads become dirty or wear out, replacement brushes and microfibre pads can be purchased from the retailer from which you purchased your Steam Cleaner and/or from most other electrical appliance retail outlets.

It is normal to have replacements of the brushes and microfibre pads close at hand when doing cleaning as the brushes wear out or the microfibre pads become dirty.

Any of the other accessory tools are replaceable by contacting the Monster Customer Support Line.

14 Steam Cleaner Tips & Reminders

This steam cleaning appliance has many practical uses that have not been mentioned in this manual. Please refer to the Cleaning Reference Guild included with this manual for tips and suggestions of where and how to use the Steam Cleaner. Alternatively visit the website at www.euroflex.com.au for additional information or contact our Customer Support Line for assistance.

Steam cleaning allows the user to clean chemical-free by using the power of steam, in place of harsh chemical-based cleaners. The heat from the steam softens and loosens dirt on surfaces, while the steam pressure lifts the dirt away. All that is left to do is to wipe the surface to remove the dirt and moisture using a cotton cloth.

TIP: to get the best cleaning results use a microfibre cloth to wipe the dirt and moisture from the surface being cleaned. Microfibre is designed to pick up and hold dirt, a great aid in lifting and removing the dirt that the steam cleaner has softened and loosened. Also, Microfibre requires moisture to glide over surfaces, the steam cleaner provides moisture that the Microfibre needs to glide. Microfibre and Steam, a great cleaning combination!

Making Contact with Surfaces

The steam is at its hottest just as it leaves the nozzle/accessory. This is the area of the steam output that should be used to clean to achieve maximum performance. All accessories should make direct contact with the surfaces being cleaned to transfer the heat from the Steam Cleaner to the surface in order to soften and loosen dirt. If the accessory being used does not make contact with the surface, the desired results may not be achieved. If assistance is required contact our Customer Support Line.

TIP: steam will clean hard, sealed, non-porous surfaces in place of harsh chemical-based cleaners and detergents. For soft furnishings such as carpets, rugs, lounges, children's toys etc, steam will refresh and deodorise the fibres. Steam is not used to clean carpets, other than to spot clean. To clean carpets proper carpet cleaning equipment should be used.

Water

Use ordinary tap water for all cleaning. In hard water areas, we recommend distilled or demineralised water to reduce the formation of calcium and other mineral deposits in the Steam Cleaner. Use distilled or demineralised water when steaming light coloured fabrics to eliminate the possibility of hard water stains.

IMPORTANT: Do not add cleaning solutions, perfumes, oils or any other chemicals to the water used in the Boiler.

Temperature

The temperature in the stainless steel Boiler reaches about 130°C. The steam temperature just outside the tip of the nozzle/accessory is between 105°C and 115°C. The temperature of the steam falls to 38°C at a distance of 25cm from nozzle. This Steam Cleaner produces a drier steam which cools very rapidly to avoid burns and injuries. Steam must make direct contact with surfaces for it to clean effectively.

TIP: the hot steam can be used to kill dust mites in soft furnishings and mattresses. Steam cleaning is ideal for asthma sufferers, persons with skin sensitivities and anyone with chemical sensitivities.

15 Tool Caddy and Wall Bracket

A. Tool Caddy – Installation

The Tool Caddy allows you to store a variety of accessories/ attachments right on the Steam Cleaner, keeping them handy and ready for use.

Select which tools you will place in the Caddy according to the cleaning tasks you are going to perform.

Tool Caddy Installation:

- Hook the top front of the Tool Caddy over the two hooks on the back of the Steam Cleaner.
- Push the bottom part of the Caddy under the body of the cleaner and line up screw holes on the Caddy with the fixing lug holes on the Steam Cleaner body.

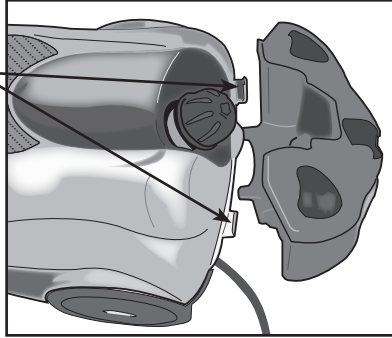

- Turn Steam Cleaner over and insert the two plastic-head screws through the fixing lugs into the screw holes and turn clockwise to tighten.

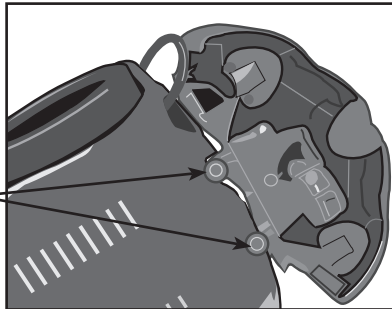

The Tool Caddy is now attached to the Steam Cleaner and ready for use.

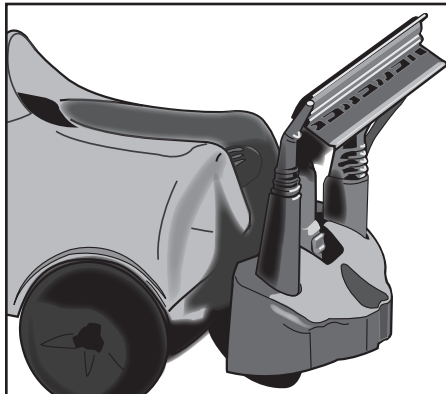

Continued on next page

B. Wall Bracket – Installation

IMPORTANT

The Tool Caddy MUST be installed on the Steam Cleaner before the Wall Bracket can be used.

WARNING!

*When storing the Steam Cleaner on the Wall Bracket, ensure that any tools on the Tool Caddy are not in a dangerous position.
Example: Extension Tubes could be a hazard if the rack is mounted at eye level.*

The Wall Bracket can be permanently mounted to a wall or inside a cupboard or closet. Slots on the underside of the Tool Caddy slide easily on to hooks on the Wall Bracket, giving you convenient off-the-floor storage.

Before attaching Wall Bracket, be sure that...

- there is enough room to accommodate the Steam Cleaner and Tool Caddy with tools attached
- there is at least 2.5"/6.5 cm clearance ABOVE where Bracket is mounted so the unit can slide down on to the Bracket hooks
- the surface that the Bracket is being mounted on is strong enough to hold the weight of the fully assembled Steam Cleaner
- you have obtained the necessary screws to mount the Bracket to the wall or cabinet

NOTE: *Be sure you are using the correct screw-type for the surface to which you are mounting the Bracket. Check manufacturer's recommendations or ask someone at your local hardware store what screw-type will work best, and be sure the screw head is large enough to cover the holes.*

Wall Bracket Installation:

- Hold Wall Bracket in desired location and mark the screw hole positions with a pencil (position Bracket over a stud, if possible).
- Check levelness of the location with a carpenter's spirit level.
- Screw the Wall Bracket firmly in place.

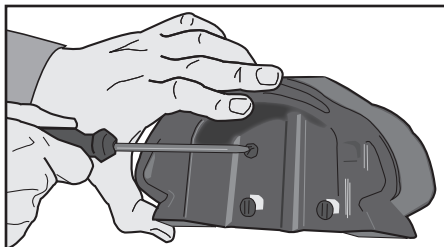

C. Wall Bracket – Placing Unit on Bracket

- Lift the Steam Cleaner above the Wall Bracket and line up the slots on the Tool Caddy with the hooks on the Bracket.
- Lower the Steam Cleaner until the slots fit over the hooks.
- Slowly slide the Steam Cleaner in place on the Wall Bracket.

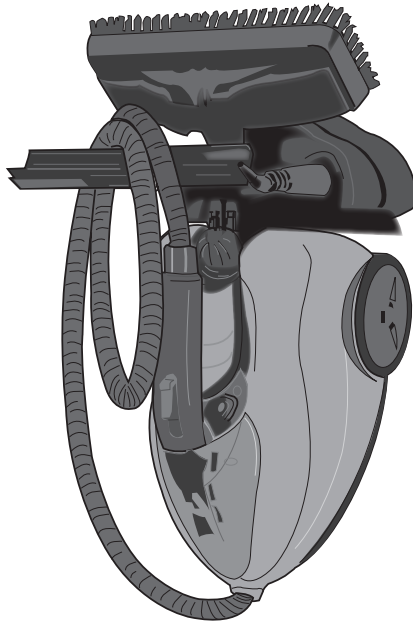

D. Wall Bracket – Removing Unit from Bracket

Slide Steam Cleaner up and off of Wall Bracket.

Customer Support

Customers needing assistance with their Monster Compact Steam Cleaner can call the Customer Support Line on the phone numbers listed below. Customers should also call the Customer Support Line if they require product warranty repair or post-warranty product servicing. Our friendly Customer Service Team can assist you to get the best cleaning results from your Steam Cleaner, they are full of helpful steam cleaning tips, too.

Monster Customer Support Line

AUSTRALIA 1800 663 866

NEW ZEALAND 0800 666 783

EUROFLEX Australia Pty Ltd

8 Success Way
WANGARA WA 6065
AUSTRALIA
TEL: 08 9302 2526
Email: admin@euroflex.com.au
Website: www.euroflex.com.au

EUROFLEX New Zealand Ltd

PO BOX 305 650
Triton Plaza
North Shore 0757
NEW ZEALAND
TEL: 0800 666 783
Email: admin@euroflex.com.au
Website: www.euroflex.com.au

EUROFLEX SRL

Via dei Colli, 153
31058 Susegana (TV)
ITALY
Tel: +39 0438 661711
Email: euroflex@euroflex.tv
Website: www.euroflex.tv

