

ULTA

VO

VA

ULTIMA PET PLUS

Instruction Manual

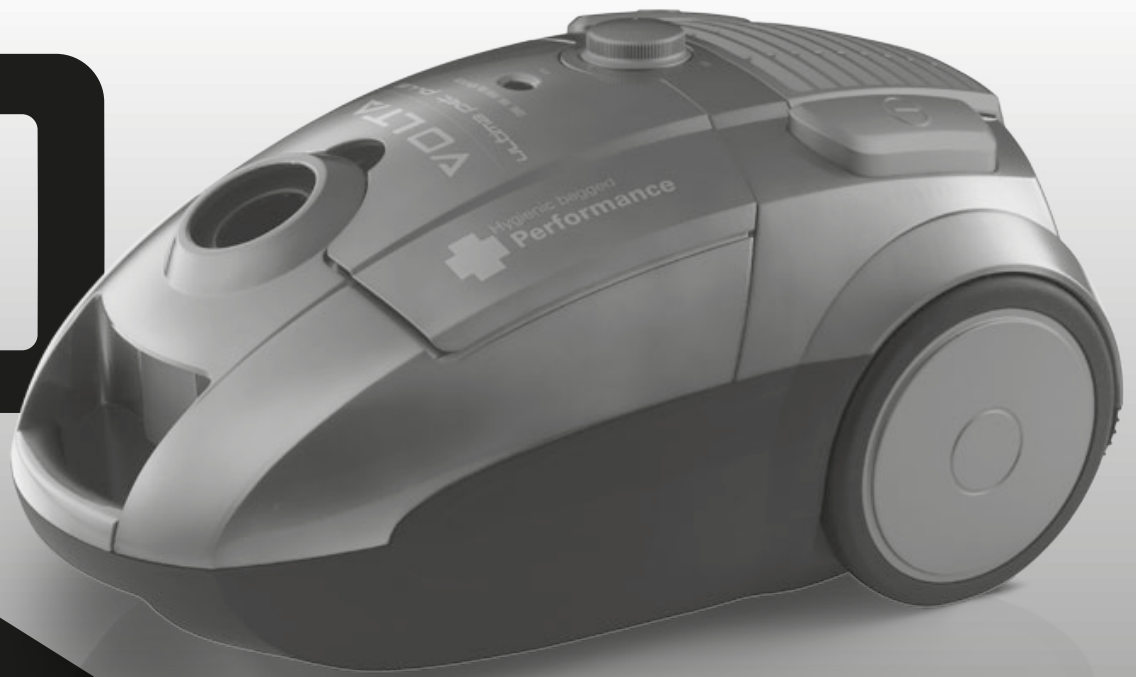

U6011

IMPORTANT SAFETY INSTRUCTIONS

IMPORTANT SAFETY INSTRUCTIONS READ ALL INSTRUCTIONS BEFORE USING (THIS APPLIANCE)

When using an electrical appliance basic precautions should always be followed, including the following. Before connecting the cleaner to an electrical supply outlet, ensure that the voltage marked on the rating plate (on the underside of the cleaner) is correct for your electrical supply. If it does not comply, do not use the cleaner prior to contacting the manufacturer.

WARNING – To reduce the risk of fire, electric shock, or injury:

1. Do not leave vacuum cleaner when plugged in. Unplug from outlet when not in use and before servicing.
2. To reduce the risk of electric shock, do not use outdoors or on wet surfaces.
3. This appliance is not intended for use by persons (including children) with reduced physical, sensory or mental capabilities, or lack of experience and knowledge, unless they have been given supervision or instruction concerning use of the appliance by a person responsible for their safety. Children should be supervised to ensure that they do not play with the appliance.
4. Use only as described in this manual. Use only manufactures recommended attachments.
5. Do not use with damaged cord or plug. If vacuum cleaner is not working as it should, has been dropped, damaged, left outdoors, or dropped in water, take it to a service centre before using.
6. Do not pull or carry on cord or use as a handle. Do not close door on cord, or pull around sharp edges or corners. Do not run vacuum cleaner over cord. Keep cord away from heated surfaces.
7. Do not unplug by pulling on the cord. To unplug, grasp the plug, not the cord.
8. Do not handle the plug or vacuum cleaner with wet hands.
9. Keep hair, loose clothing, fingers and all parts of body away from openings and moving parts.
10. Turn all controls off before unplugging.
11. Do not use to pick up flammable or combustible liquids, such as gasoline, or use in areas where they may be present.
12. Do not pick up anything that is burning or smoking, such as cigarettes, matches, or hot ashes.
13. Do not use without dust bag and/or filter in place.
14. Do not use extension cords or outlets with

- inadequate current carrying capacity.
15. We recommend you do not use your vacuum on carpet cleaning foams, sharp or heavy building materials or plaster dust. They could damage or clog the dustbag and cause failures to other key parts in your vacuum cleaner and render your warranty invalid.
16. Store your cleaner indoors in a cool, dry area.
17. Unplug electrical appliances before vacuuming them.
18. Please remove the plug from the socket outlet before cleaning or maintaining this appliance.
19. If the power cord is damaged, it must be replaced by the manufacturer, its service agent or similarly qualified person in order to avoid a hazard.

SERVICE & REPAIR

It is dangerous to alter the specifications or modify the product in any way. Under no circumstances should you attempt to repair the cleaner yourself. **NB!** To avoid injury and prevent damage to the vacuum cleaner a defective cord must only be replaced by an authorised service provider approved by the manufacturer to avoid a hazard. The vacuum cleaner should be serviced by an authorised service provider and only genuine Volta spare parts should be used.

Double Insulation

Your vacuum cleaner is double insulated. This means that all external parts are electrically insulated from the mains. This is done by placing insulation barriers between the electrical and mechanical components, making it unnecessary for the cleaner to be earthed.

WARNING: On collection of proprietary carpet conditioning powder, it is recommended that the dust container is emptied and the cartridge filter is cleaned after each use. Some of the preparations contain substances which if left in the vacuum cleaner for extended periods, could cause damage. Many air fresheners, household deodorants, sprays and polishes contain highly inflammable gas propellants, because of this it is particularly important that these products are used strictly in accordance with the relevant manufacturers instructions, it is essential that none of the above products are sprayed directly into the vacuum cleaner or any of the filters, hose assembly or dust chamber.

1.

PARTS IDENTIFICATION

ULTIMA PET PLUS U6011



1. Telescopic tube
2. Bent end handle
3. Flexible hose
4. Cable rewind pedal
5. Hose release buttons
6. Power control button /knob
7. On/off switch pedal
8. Front over lid latch
9. Combination floor nozzle
10. Hard floor nozzle
11. Turbo pet hair nozzle
12. Dusting brush, Crevice nozzle, Upholstery nozzle

2.

GETTING STARTED, ASSEMBLING YOUR VOLTA

Always be sure to fully assemble the vacuum cleaner before plugging it into the power outlet.

1. Insert flexible hose into the air intake duct on the top of appliance. Press until it clicks into position.

To release the flexible hose, press firmly the two release buttons on the hose sleeve and remove the hose from the air intake duct.



FITTING THE TELESCOPIC EXTENSION TUBE AND ACCESSORIES

1. Fit the telescopic extension tube to the bent end handle.



2. Fit the floor nozzle to the telescopic extension tube.



GETTING THE BEST CLEANING RESULTS

Your Volta is equipped with a number of different nozzles and accessories. Read below to learn more.

Combination floor nozzle



Ideal for cleaning both carpets and hard floor types. When cleaning carpets, the brush strip should be in the retracted position. Press the pedal on the top of the nozzle. When cleaning hard floors, release the pedal to lower the brush strip for soft cleaning.

Hard floor nozzle



Use the hard floor nozzle for larger hard floor areas to ensure gentle, scratch free cleaning.

Turbo nozzle



The turbo nozzle features an air driven brush roll which makes it ideal for efficient cleaning of carpets, and is particularly suited to removing pet hair.

Small accessories:



Crevice nozzle

Best used for cleaning in corners, between furniture and tight spaces.

Upholstery nozzle

This nozzle is ideal for loose fabrics, curtains and upholstery.

Dusting brush

For above floor cleaning of hard surfaces, such as table tops, benches and shelves.

READY TO CLEAN

1. Before using this appliance, unwind a sufficient length of cable and insert the plug in to the power outlet. A yellow mark on the power cable shows the ideal cable length. Don't extend the cable beyond the red mark.

2. Press the ON/OFF switch pedal to start the appliance.



3. To rewind the power cable, press the rewind pedal with one hand and guide the cable with the other hand to ensure that it does not whip causing damage.



4. Adjust the power control knob to regulate the suction level as required.



IMPORTANT MAINTENANCE TIPS

Your Volta is designed to provide efficient cleaning performance. Be sure to follow the below simple steps to ensure you get the best performance possible for years to come.

CHANGING THE BAG

Always operate the cleaner with paper or cloth dust bag installed. If you forget to attach the dust bag or attach it in the wrong manner, the dust cover may not close properly.

1. After removing the hose, open the front cover.
2. Raise the support of the bag to an upright position.
3. Remove the dust bag.
4. In case of paper bag, Replace the paper bag with new when it is full or dust bag indicator shows red.

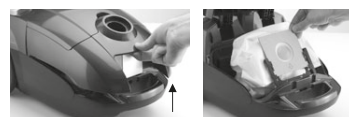

In case of cloth bag

Follow the above steps 1 - 3.

To open, slide the plastic clip off the bag Empty bag and refit the plastic clip

Note: The cloth bag may be washed in lukewarm water and dried completely. It should not be washed in washing machine.



5. Close the cover by pressing down until it is locked.
6. *Note: A cloth bag is not supplied with this product. To purchase a cloth bag, please return to the place of purchase or contact Electrolux on 1300 365 305 (Aus), 0508 730 730 (NZ).

CLEANING THE MOTOR FILTER

- This filter should be cleaned at least twice a year or when it becomes visibly dirty.
 - Always operate the cleaner with filter installed, otherwise reduced suction or motor damage may result.
 - Disconnect from electrical outlet, before cleaning the filter.
 - Do not use a washing machine to rinse filter.
 - Do not use hair dryer to dry it.
1. Remove dust bag by pulling dust bag collar frame upwards.
 2. Pull the filter holder upwards.
 3. Remove filter from holder.
 4. Rinse filter in lukewarm water and dry the filter completely.
 5. Put back filter into the filter holder and refit.

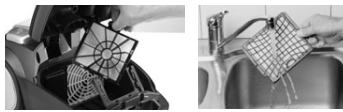

CLEANING AND REPLACING THE HEPA FILTER

The HEPA filter should also be cleaned twice a year, or when visibly dirty. This will help ensure the best possible filtration from your Volta.

1. Open the rear hood of the vacuum cleaner and lift out the HEPA filter.



2. To clean the filter, cover it with a sheet of paper with the frame facing up and tap it against a hard surface. This will help to dislodge excessive dust and dirt from the filter.

3. If necessary the HEPA filter can be rinsed under a tap using lukewarm water. Always rinse the filter with the frame facing down and never use cleaning chemicals. Never scrub or brush the filter.



4. Air dry the filter for 24 hours, away from direct sunlight before reusing it. If the filter appears damaged it is recommended to replace with a new filter. To purchase new filters contact Electrolux customer service on 1300 365 305 (AUS) or 0508 730 730 (NZ).

PRECAUTIONARY MEASURES

If the suction air flow is blocked, you should switch off the vacuum cleaner at once. First, clear the blockage from the hose and/or telescopic extension tube before you attempt to start the vacuum cleaner again.

1. Do not operate the vacuum cleaner too close to heaters, radiators, cigarette butts, etc.



2. Before you insert the plug into the power socket, make sure your hands are dry.



3. Before you start using the vacuum cleaner, please remove large or sharp objects from the floor in order to prevent damage to the paper bag.

4. When you want to pull the plug from socket, please do this at the plug itself and not by the electrical cable.



This vacuum cleaner is equipped with a cable and plug, which rolls up on activation of the rewind pedal. If the plug or cable is damaged, the plug and cable assembly must be replaced by returning the product to your local authorised Electrolux Service Provider in order to avoid a hazard.

WARNING:

On collection of proprietary carpet conditioning powders, plaster / concrete dust, it is recommended that the dust bag is changed. Some of the preparations contain substances which while left in the vacuum cleaner for extended periods could create damage.

Many air fresheners, household deodorants, sprays and polishes contain highly inflammable gas propellants. Because of this it is particularly important that these products are used strictly in accordance with the relevant manufacturers instructions. It is essential that none of the above products are sprayed directly into the vacuum cleaner or any of the filters, hose assembly or dust chamber.

TROUBLE SHOOTING AND CUSTOMER INFORMATION

You can perform your own troubleshooting at home based on the checklist given below. However, if the problem persists, please contact Electrolux on 1300 365 305 (AUS) or 0508 730 730 (NZ)

PROBLEM	POSSIBLE CAUSES	CORRECTIONS
Vacuum cleaner does not start.	Plug is not properly connected to the socket.	Check the plug connection or try another socket.
	Thermal protector activated due to high temperature.	Press the On/Off button and wait 20-30 minutes for the motor to cool down.
Filter indicator light stays on.	Dust bag is full.	Empty or replace the dust bag.
	Filters are clogged.	Clean or replace filters.
Reduction of suction capacity.	Suction hose is blocked.	Clean the hose.
	Nozzle is blocked.	Clean the nozzle.
	Dust bag is full.	Empty or replace the dust bag.
	Filters are clogged.	Clean or replace filters.
Over-heating.	Hose is damaged or broken.	Change the hose.
	Dust bag is full.	Empty or replace the dust bag.
	Filters are clogged.	Clean or replace filters.

KEEP THIS FOR YOUR RECORDS

To be completed by the Purchaser

Model

Serial No

Date of Purchase

Retailers Name

Retailers Address

.....

City..... **State**

Attach Your Purchase Receipt Here

Electrolux Small Appliances

Electrolux Pty Ltd ACN 000 015 136

57 - 63 Fairchild Street, Heatherton, VIC 3202, Australia

Ph: (03) 8581 7300 Customer Service - Ph: 1300 365 305

www.electrolux.com.au

Electrolux Small Appliances

A division of Electrolux (NZ) Limited

3 - 5 Niall Burgess Road, Mt. Wellington, Auckland, New Zealand

Ph: (09) 9573 2220 Customer Service - Ph: 0508 730 730

www.electrolux.co.nz

*Some models may be limited in availability or be available from certain stores only. Not all models and specifications are available at time of printing and not all models are available in NZ.

See your local Volta retailer or call the above phone numbers for further information if required.

*Due to the Electrolux policy of continual product development; specifications, colours and details of our products and those mentioned in this manual are subject to change without notice.