

Consumer Warranty

MyGenie would like you to enjoy your new purchase. This warranty card is provided to ensure that you get satisfaction. Our goods come with guarantees that cannot be excluded under Australian Consumer Law. You are entitled to a replacement or refund for a major failure for any other reasonably foreseeable loss or damage. You are also entitled to have the goods repaired or replaced if the goods fail to be of acceptable quality and the failure does not amount to a major failure. The benefits of this warranty are in addition to the consumer's rights and remedies under law.

Warranty Period

The warranty is 12 months from the date of purchase.

Registering Your Purchase

Please register your purchase on www.bdirect.com.au - register your purchase. Procedure for claiming under warranty. You now need to make a claim under this warranty please follow the prompts on www.bdirect.com.au - warranty claims or email direct to warranties@bdirect.com.au. Please retain your original receipt as proof of purchase.

Table of Contents	
Safety Instructions	1
Product Features	2
Product Illustrations	3-7
Main unit and accessories	3
Main Unit and Dust Bin	4
Charging Station	5
Remote Control Unit	6
Unit Display Panel	7
Product Operations	8-11
Battery Charging Methods	8
Cleaner Operating Methods	9
Schedule Cleaning Time	10
Cleaner Operations	11
Product Maintenance	12-13
Clean Side Brushes	12
Clean Dust Bin and Filters	12
Clean Sensors	13
How to install & install Mopping Pad	13
Troubleshooting	14-16
Error Codes Chart	14
Replaceable Modules	15
Battery Installation and Replacement	16
Unit Usage Limitation	16
Product Specification	17



Thank you for purchasing this product which has been made to demanding high quality standards and is guaranteed for domestic use against manufacturing faults for a period of 12 months from date of purchase.

For correct usage, read these instructions carefully and keep in a safe place for future reference.

Troubleshooting	
Battery Installation and Replacement	
A. Remove two screws from battery cover with screw driver.	
B. Open the battery cover.	
C. Take out the battery using the 2 strip holder on its sides.	
D. Disconnect the wire connector that connects the battery and unit.	
E. Put a new battery into battery slot with 2 strip holders face up.	
F. Reconnect the wire between the battery and unit correctly.	
G. Make sure the wire connector is stored on the cavity.	
H. Put the battery cover back and make sure side brush is not stuck in.	
I. Lock back battery cover with screws.	
Note: Only use factory authorized batteries	
Unit Usage Limitation	
The cleaner unit can ONLY be used at residential houses indoor and dry floor. It will clean the debris, dirt, dust, and pet hairs off the floor, and work well on hardwood, tile, linoleum, and low-pile (up to 0.5 inches) carpet.	

Product Specifications		
Classification	Item	Detail
Mechanical Specifications	Diameter	13.4" (340mm)
	Height	3.54" (90mm)
	Weight	6.6 Lbs (3.0Kgs)
Battery Specifications	Power voltage	14.4 V
	Battery specifications	2200mAh Li-Ion
AC Adapter Specification	Input	100~240V 50/60Hz 0.8A
	Output	24.0V/0.9A
Cleaning Specifications	Dust bin capacity	0.4L liters
	Charging type	Auto Charging/Manual Charging
	Cleaning mode	Auto, Spot, Edge, Daily Schedule
	Charging time	3-5 hours
	Cleaning time	About 90min
Main Unit Button Type	Touch (LED display)	

Troubleshooting	
Powerful Suction & Two Suction For Choice	
Powerful suction	
Suction power of this product reaches 40 W, ensuring that even tiny dust on the floor will be cleaned thoroughly.	
Two suction For choice	
There are two suction mode for your choice: normal suction, turbo suction (refer to the function of remote controller on pages 6); you can use normal suction mode for wooden tile floor for saving power consumption, use turbo suction mode for carpet floor or dirty floor for more effectively cleaning.	
User Friendly Design	
Easy operation	
Voice message guidance and touch screen operations. Just touch CLEAN key to start cleaning floor.	
Wash Dust Bin	
Empty and wash dust bin with water regularly for cleaning effectiveness.	
Four Cleaning Modes	
Four cleaning modes are provided to meet your needs. 1. Auto cleaning mode The cleaner will clean and vacuum the floor automatically and adjust its cleaning routine based on its environment. 2. Spot cleaning mode The cleaner will spend more time to clean dirty areas. 3. Edge cleaning mode The cleaner will clean the edge and corner of walls. 4. Scheduling mode You can schedule the cleaner to start cleaning at pre-defined time.	

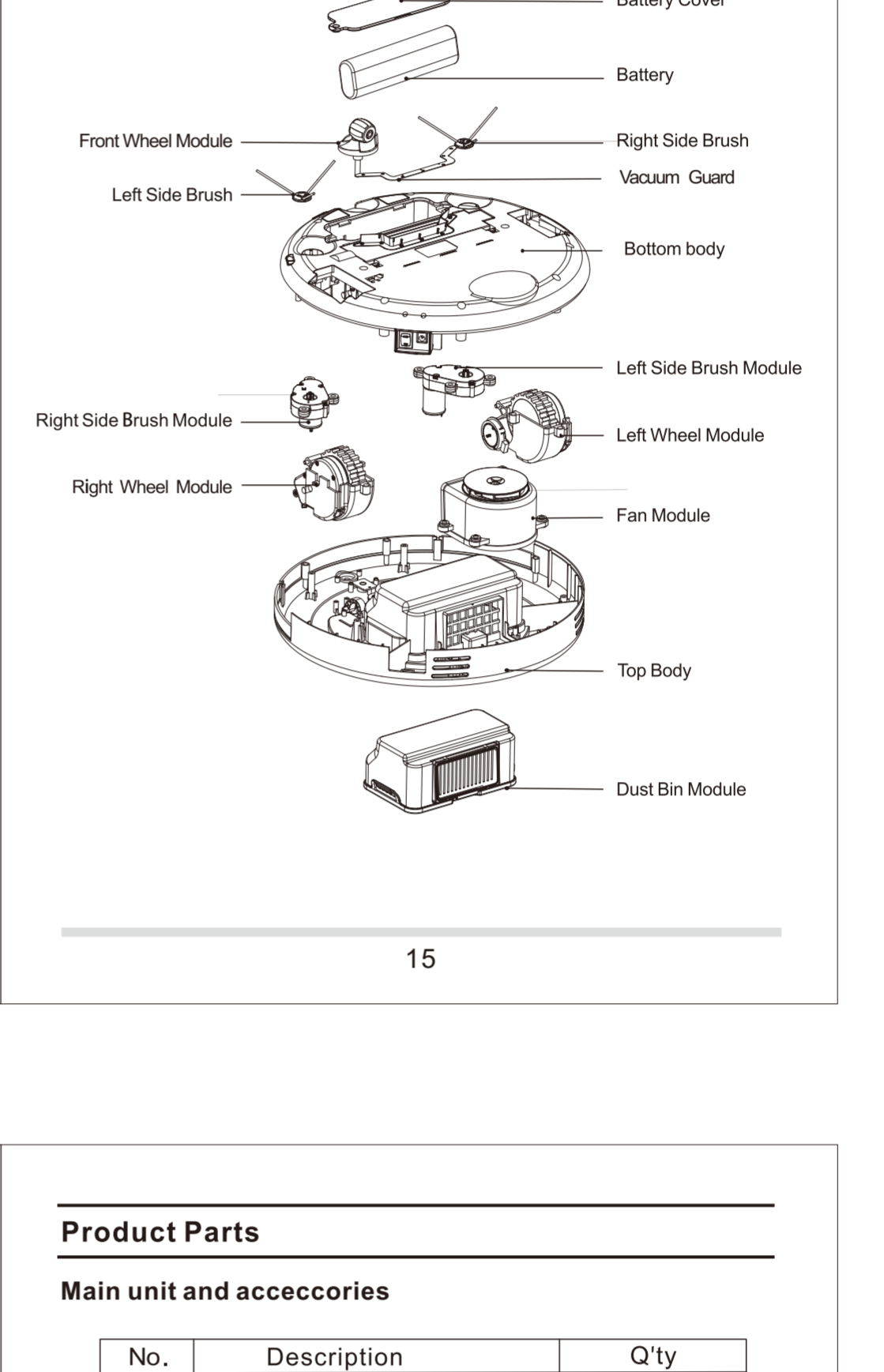

Troubleshooting		
Error Codes Chart		
Error code will show on display panel if there is a problem with the cleaner.		
Error Code	Reason	Solution
1	Cliff sensor fail	Cleaning the cliff sensor with a cotton swabs
2	Left or right wheel error	Remove hair and debris from the cleaner's wheels, push it in and out and check whether the wheel can turn freely
3	Left or right side brushes error	Remove and clean the side brushes
4	Unit is lifted up	Move the cleaner to flat floor
5	X	X
12	Low power	Move the cleaner to docking station for charging
13	The power of the cleaner isn't turned on or the battery isn't installed correctly	Turn the power switch to "ON" or insert the battery correctly
14	Front bumper error	Tap the front bumper heavily
15	Bumper sensor error	Cleaning the bumper sensor window
23	NTC error	Replace with new battery

Note: If the error condition is not resolved, do the following:
1. Restart the cleaner by switching off and on power switch.
2. If restarting doesn't work, remove battery for more than 10 minutes to reset system.
3. If it is still not working, then contact your local service center for repair.

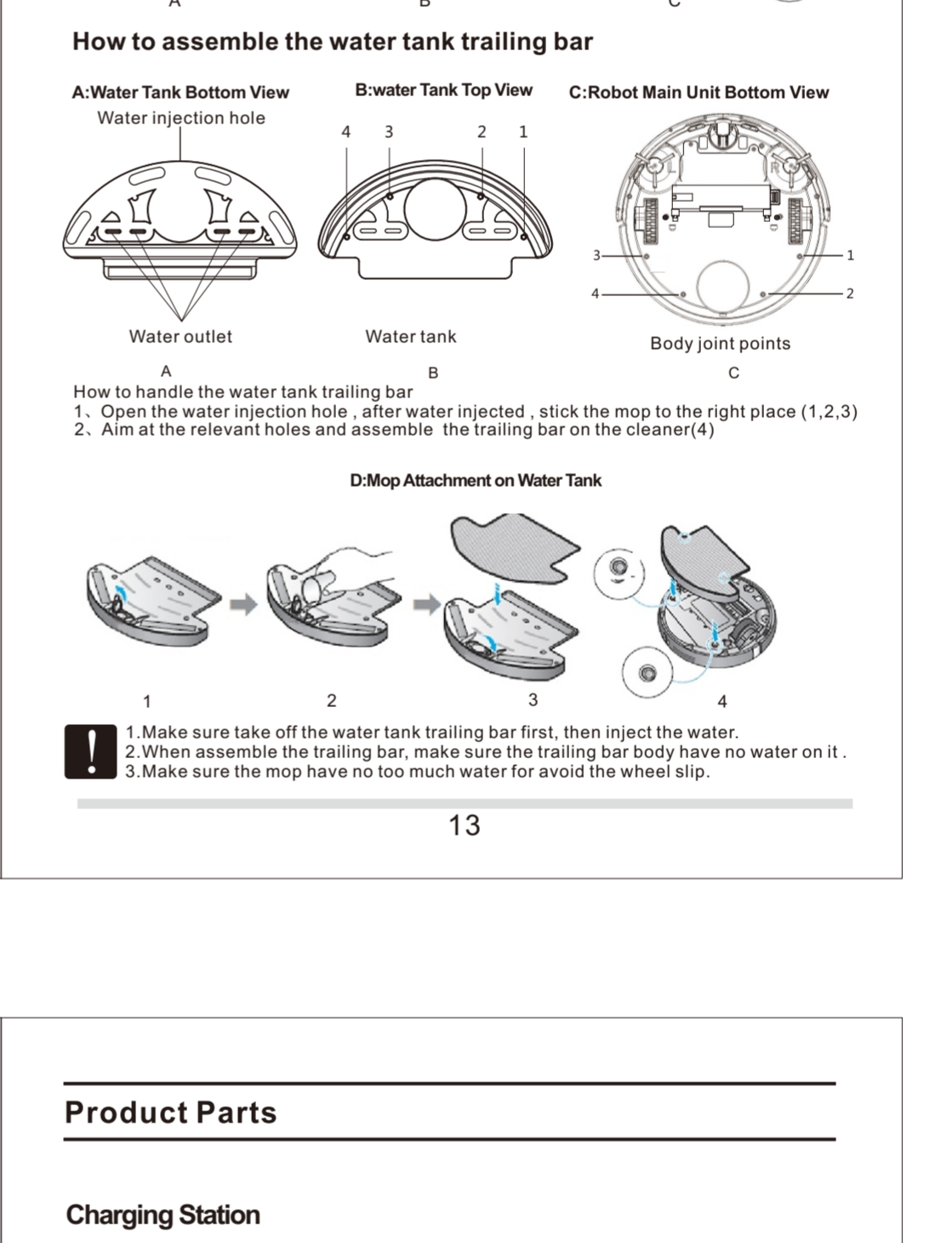
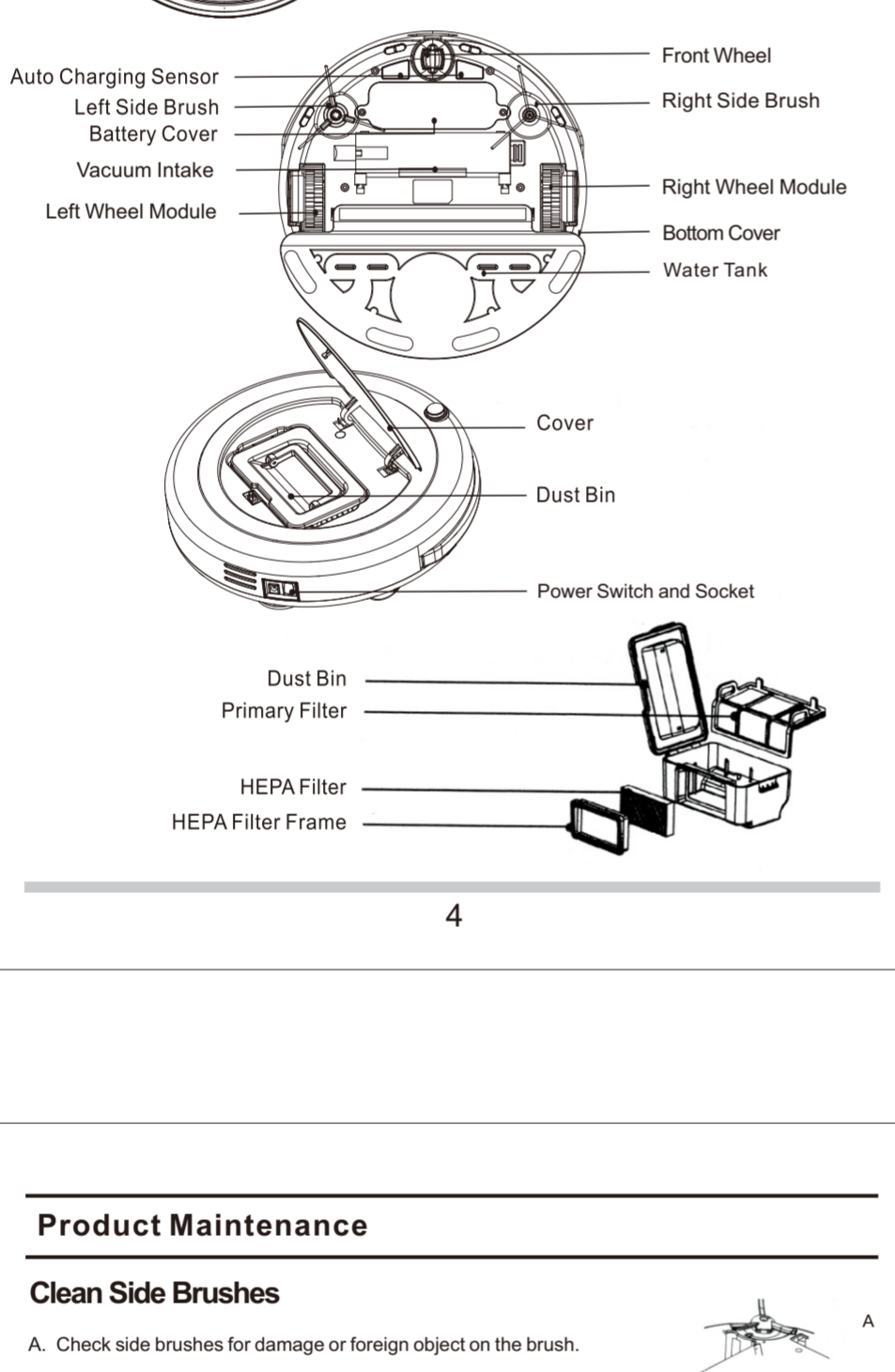
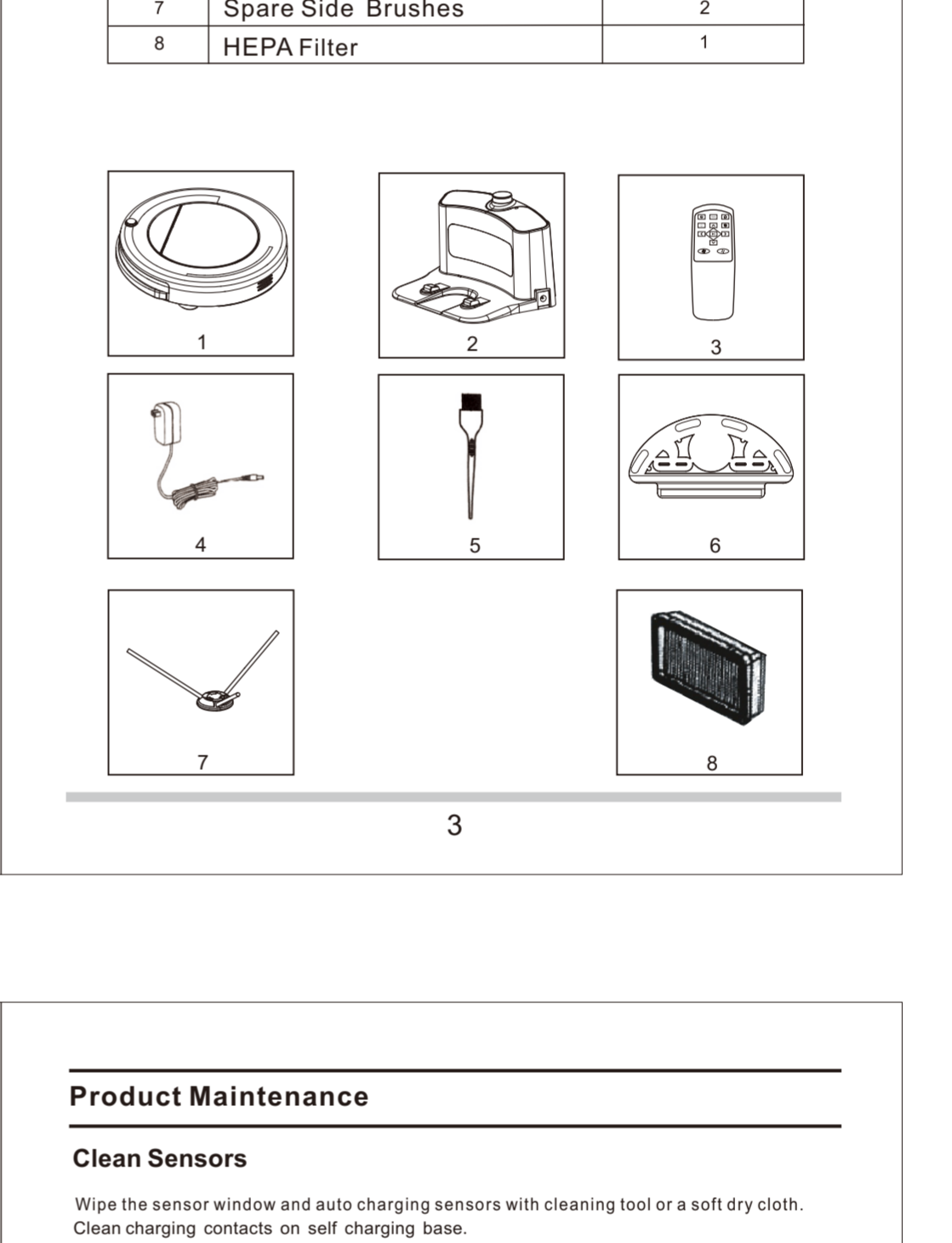

Product Maintenance	
Clean Side Brushes	
A. Check side brushes for damage or foreign object on the brush.	
B. Clean the side brushes.	
C. Pull out the side brushes.	
• Replace brushes with new ones • Insert the new brushes in place	
Clean dust bin and filter	
Note: After taking out dust bin, check if there is foreign object stuck or block the vacuum passage and clean it if necessary.	
A. Press "PUSH" to open the dust bin cover.	
B. Take out the dust bin.	
C. Separate HEPA filter from dust bin.	
D. Pull out dust bin top cover and take out primary filter.	
E. Empty dust bin and wipe the dust.	
F. Wash dust bin with water. Clean filters with cleaning brush tool. DO NOT wash it with water.	
Note: 1. Do not wash HEPA filter and replace it after one year of usage.	
G. Install primary filter and HEPA filter into dust bin.	
Note: 1. Install both HEPA and primary filters when they are dry. 2. Do not place HEPA and primary filters directly in the sun.	
H. Close dust bin cover and install it to main unit.	
Note: Dust bin and filters (including HEPA and filter) could be replaced if needed.	

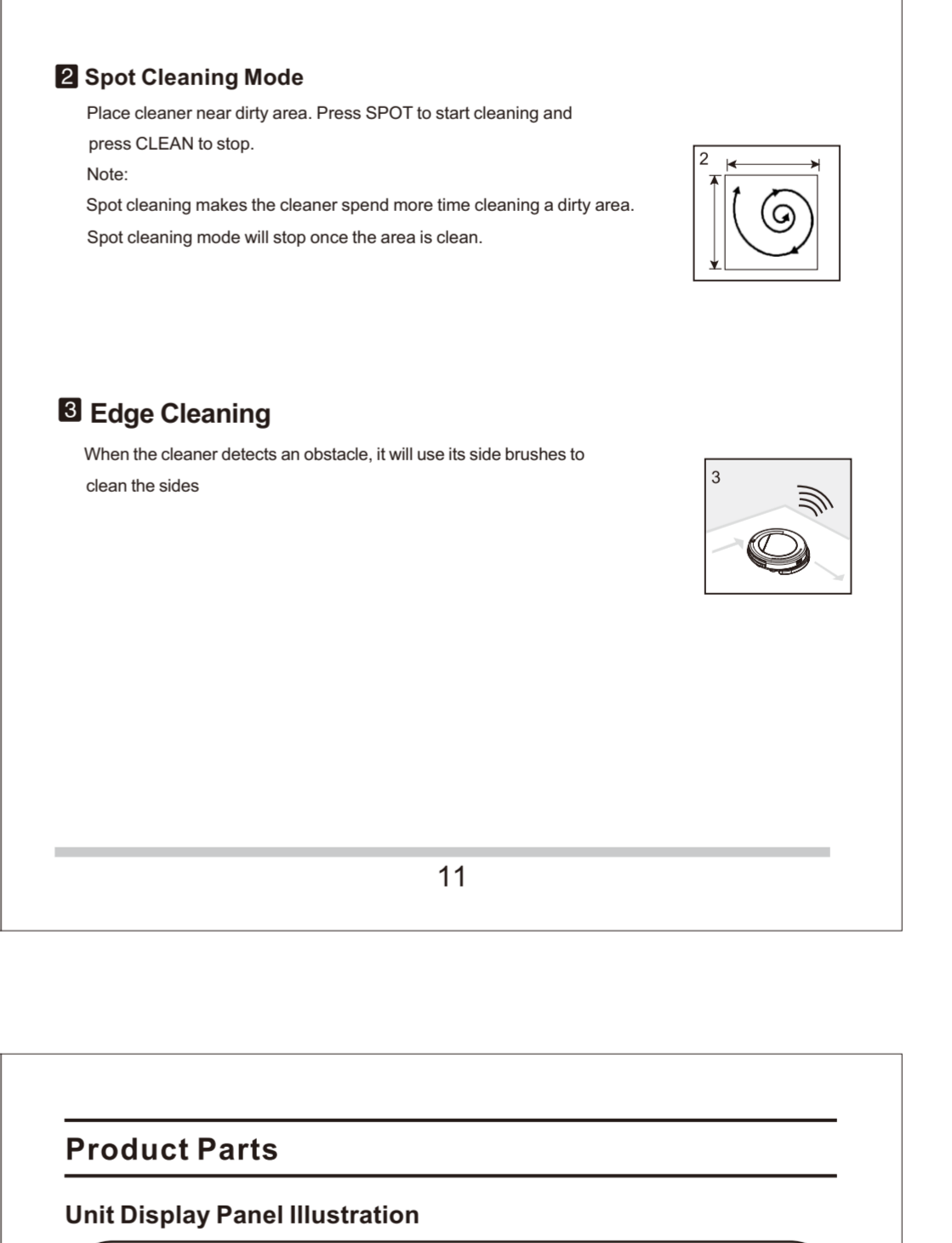
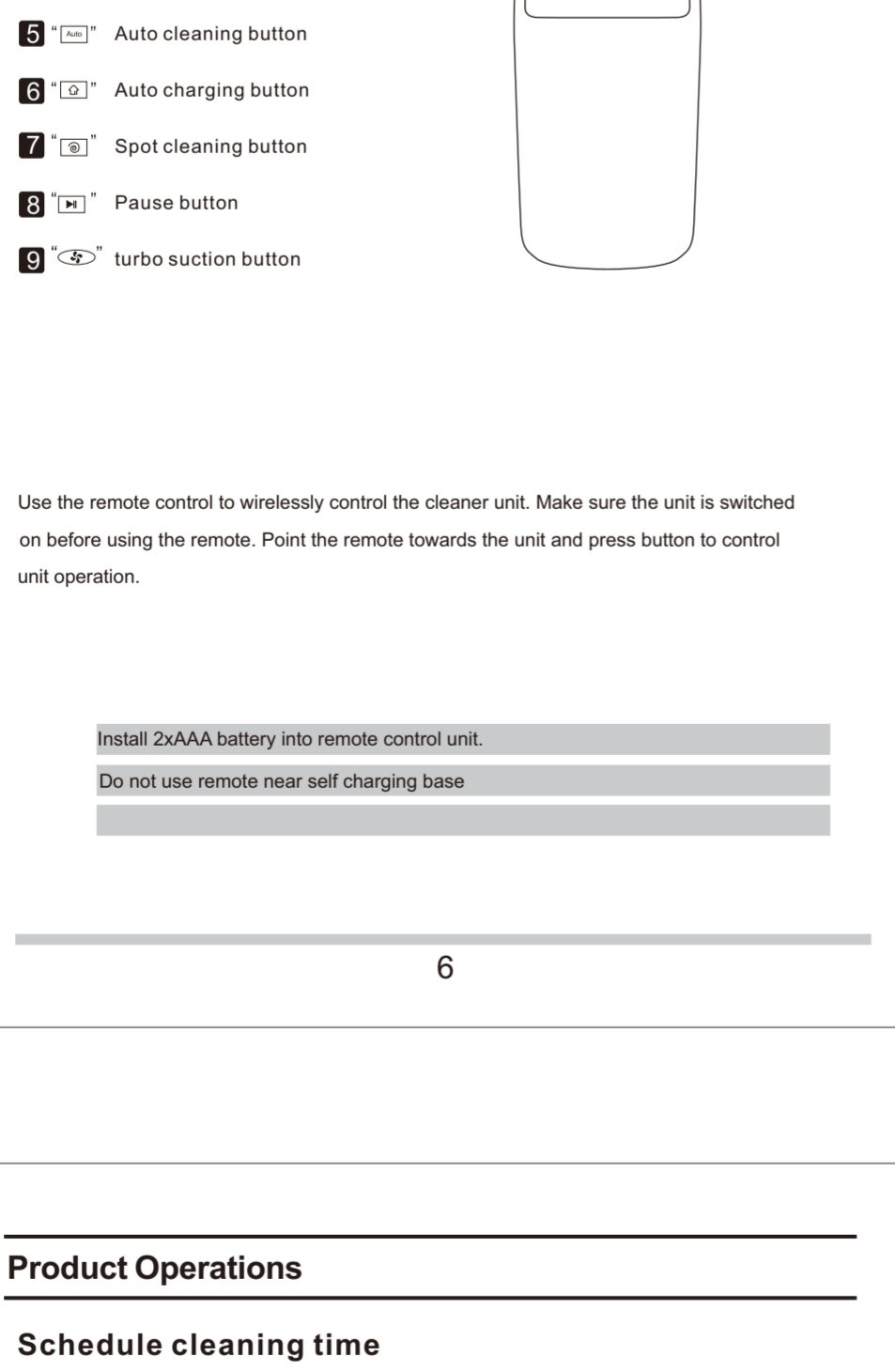
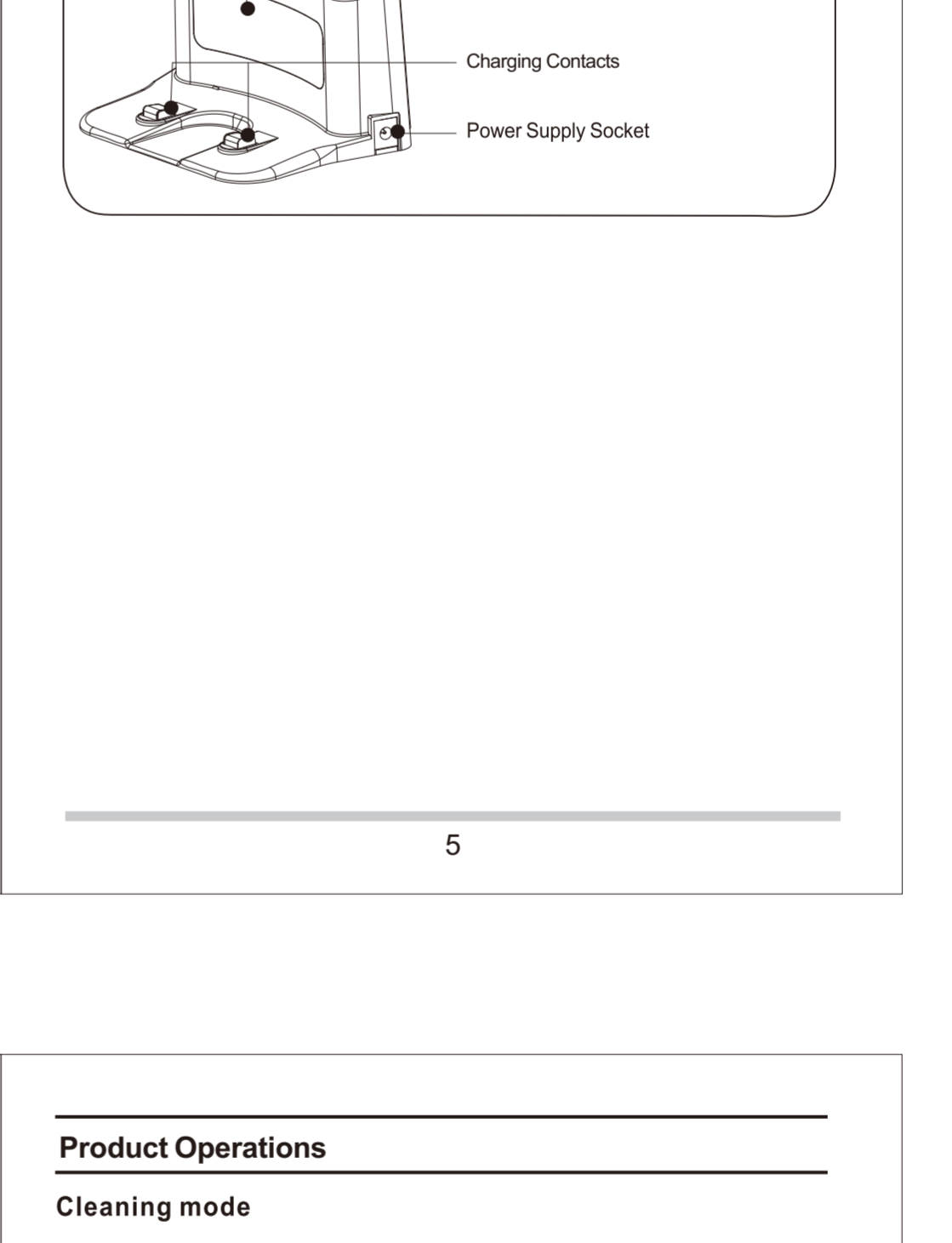

Product Operations	
Schedule cleaning time	
You can schedule the cleaner to do cleaning at pre-defined time every day. There is no real time clock setting function, you can set schedule delay cleaning time on LED display of the cleaner as the following steps:	
1. Turn on the cleaner.	
2. Press "ON" button on the remote controller to enter into delay cleaning time setting; then press "ON" or "OFF" button to choose delay cleaning hours (1 means start after 1 hours after the current time, ..., 5 means start after 5 hours after the current time). After choose the delay cleaning hour, press "ON" button to save and finish the scheduling. To cancel scheduling, press again "ON" button and then press "ON" button; the delay time will be erased.	
3. When scheduling ensure that the cleaner automatic delay start time is set at least 4 hours ahead to allow sufficient time for completely charging the battery.	
4. Once the scheduled cleaning cycle is over, and robot has had a full charge (e. LED display screen shows "1 2 3 4 5") you can press "clean" button on the LED display screen or "Auto" button on the remote control to start the robot for another cycle of cleaning in between scheduled cleaning cycles.	

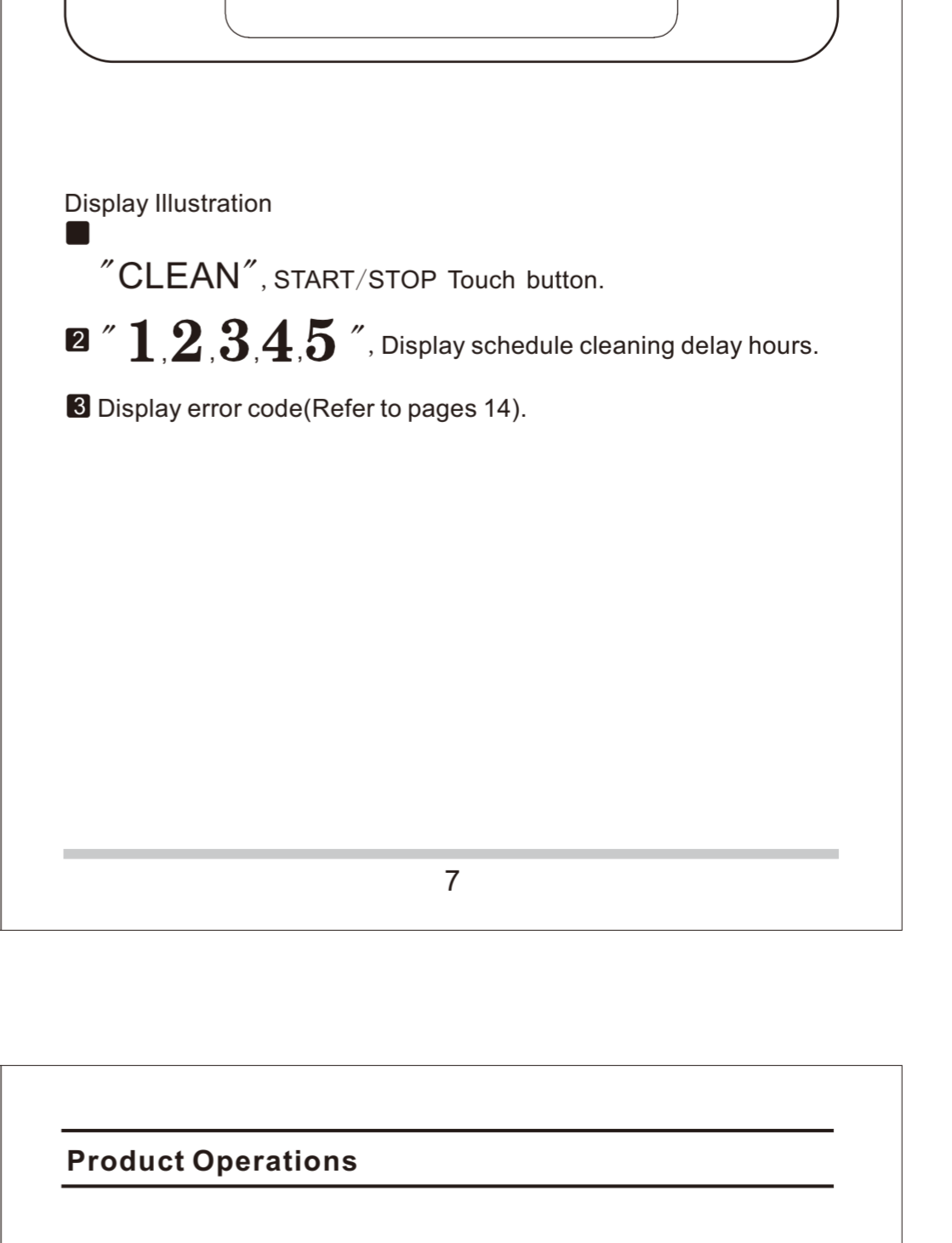

Product Operations	
Battery Charging Methods	
1. Place self charging base	
Remove obstacles about 3 ft. at two sides and about 6 ft. in front.	
2. Turn on the Power Switch at the side of cleaner, then display charging base	
(If the unit does not receive a command for 20 seconds, it will go into Sleep mode.) Note: A. Please leave the power switch on. If not, will not operate. B. If power switch is turned off, scheduling data will be erased. Caution: Before charging the cleaner, please make sure the power switch is turned on; otherwise, the cleaner can not be charged.	
3. Manual Charge Battery	
A. Plug adapter power cord to power socket first and plug AC adapter to wall outlet next. B. Connect charging base with AC adapter to power to wall outlet. * Press HOME button on cleaner unit or remote control to make cleaner return to charging base.	
Note: A. Turn on power switch before start to charge cleaner battery. B. When cleaner is charging, display 1 to 5. If full charged, display all "1 2 3 4 5". C. Before first use, charge the robot for 12 hours. When charging is finished, display panel will show code "1 2 3 4 5". D. Before first time use, let the cleaner do cleaning until battery is used up.	

