

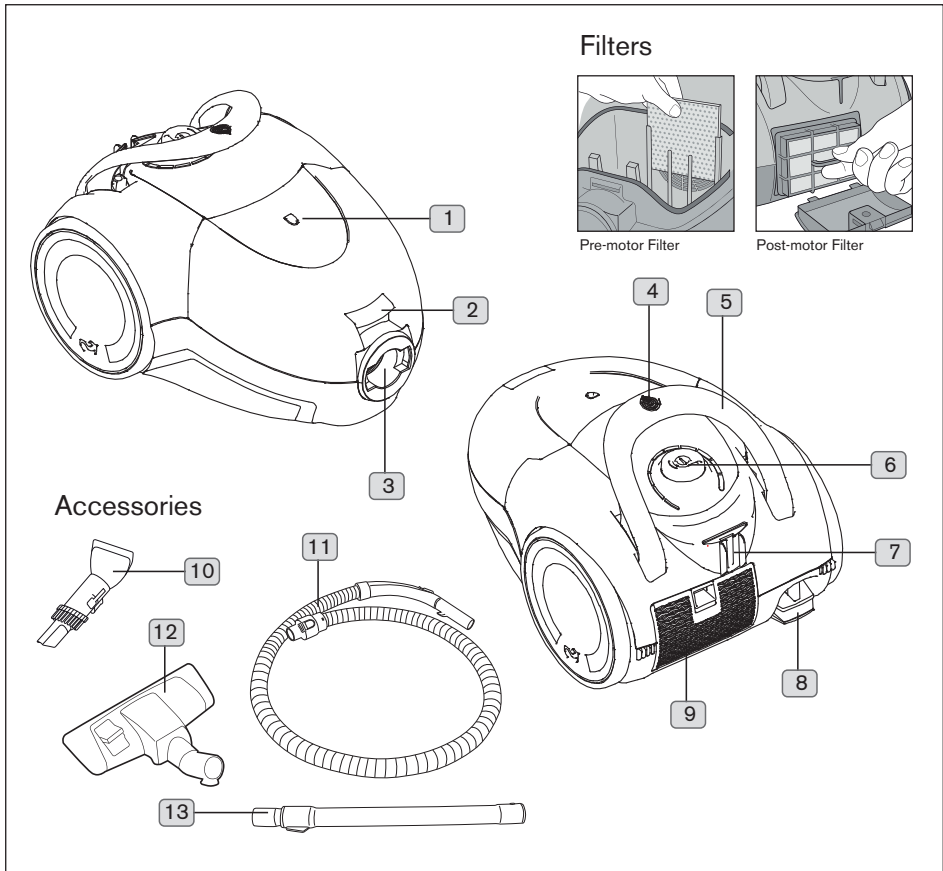

Dirt Devil Service Line: AU: 1300 361 505
NZ: 0800 800 900

MACHINE OVERVIEW



CYLINDER

1. Bag full indicator
2. Lid release button
3. Hose inlet
4. Cord rewind button (press down on handle)
5. Carry handle
6. On/off button, variable power dial
7. Floor tool parking slot
8. Plug
9. Post-motor filter cover

ACCESSORIES

10. 3-in-1 crevice tool, dusting brush and upholstery tool
11. Hose
12. Combination tool
13. Telescopic wand

FILTERS

- Pre-motor filter (located inside the dust bag cavity, behind the dust bag)
- Post-motor filter (located behind the exhaust filter cover)

SAFETY INSTRUCTIONS

THIS PRODUCT IS INTENDED FOR HOUSEHOLD USE ONLY. IF USED COMMERCIALY WARRANTY IS VOID.

When using the vacuum cleaner basic safety precautions should always be observed, including the following:

1. Only use the vacuum cleaner indoors on dry surfaces.
2. Turn off the on/off switch on the vacuum cleaner controls before disconnecting or connecting from the mains supply.
3. Always unplug the vacuum cleaner before connecting or disconnecting the vacuum hose and accessories.
4. Children should be supervised to ensure that they do not play with the appliance.
5. This appliance is not intended for use by persons (including children) with reduced physical, sensory or mental capabilities or lack of experience and knowledge, unless they have been given supervision or instruction concerning use of the appliance by a person responsible for their safety.
6. Cleaning and maintenance shall not be made by children.
7. The appliance should only be used as described in this user guide.
8. Only Dirt Devil recommended attachments should be used with this appliance.
9. Do not use this vacuum cleaner if it has been dropped, damaged, left outdoors or dropped into water. Do not use this vacuum cleaner with a damaged cord or plug.
10. Do not pull or carry this appliance by the cord. Do not use the cord as a handle, close a door on the cord or pull the cord around sharp edges or corners. Do not run the vacuum cleaner over the cord. Keep the cord away from heated surfaces.
11. Do not handle the plug or the vacuum cleaner with wet hands.
12. Keep hair, loose clothing, fingers and all parts of the body away from openings and moving parts.
13. Do not pick up any hot coals, ash, cigarette butts, matches or any hot, smoking or burning objects.
14. Do not pick up any flammable or combustible materials (lighter fluid, petrol, kerosene etc.) or use in the presence of explosive liquids or vapours.
15. Do not vacuum harmful or toxic material (chlorine, bleach, ammonia, drain cleaner etc.).
16. Do not vacuum hard or sharp objects such as glass, nails, screws, coins etc.
17. Do not vacuum plaster dust, concrete dust or any other building or vitreous materials.
18. Do not vacuum baking soda or any other powder-based carpet refresher or deodoriser.
19. Use only SAA approved 10amp extension cords. Non-approved cords may overheat. Care should be taken to arrange the cord so that the cord cannot be tripped over.

20. Store the vacuum cleaner in a cool, dry area.
21. Do not put any objects into openings. Do not use with any openings blocked and do not restrict airflow. Keep all openings free of dust, lint, hair or anything that might reduce airflow.
22. Do not use the vacuum cleaner with blocked filters and without all of the filters in place.
23. Take extra care when positioning the vacuum cleaner on the stairs.
24. Please ensure that the brushbar is turned off when you are vacuuming on the stairs.
25. Keep vacuuming area well lit.



WARNING: Always switch off and unplug the vacuum cleaner from the electrical socket before assembling, opening or emptying the dirt container, or before connecting/disconnecting the attachments.



CAUTION: The vacuum cleaner is a very powerful unit. Before plugging the cord into the electrical socket, make sure the switch is in the 'off' position.



IMPORTANT: If the inlet, hose or telescopic tube is blocked, switch off the vacuum cleaner and remove the blockage(s) before re-starting the vacuum cleaner.



IMPORTANT: Dirt Devil recommends the use of Residual Current Device Rating of 30mA or less.



IMPORTANT: It is very important that filters are kept clean to obtain maximum performance from your vacuum cleaner. Not cleaning and not replacing your filters regularly can reduce the suction power and cause overheating and permanent damage to the vacuum cleaner.



NOTE: If the supply cord is damaged it must be replaced by the manufacturer, or a similarly qualified person in order to avoid hazard, or invalidating the warranty.



IMPORTANT: The motor is equipped with a thermal cut-out. If for any reason the unit should overheat (eg. from blocked nozzles, a full dust container or unclean filters), the thermostat will automatically turn off the switch. Should this occur, unplug the vacuum cleaner from the electrical socket and turn off the switch. Remove dirt container and empty. Clean filters. Allow the unit to cool for approximately one (1) hour. To re-start, plug into an electrical socket and switch back on.

DAMAGE TO THE VACUUM CLEANER CAUSED AS A DIRECT RESULT OF NOT ADHERING TO THE GENERAL SAFETY INFORMATION AND THE INSTRUCTIONS IN THIS USER GUIDE INVALIDATES THE WARRANTY

PLEASE KEEP THESE INSTRUCTIONS FOR FUTURE REFERENCE

OPERATION

Assemble appliance and adjust accessories to surface

WARNING: Danger of injury! Only attach the accessory parts when the appliance is not connected to the power supply.

CAUTION: Before assembling, make sure that the accessory part suits the surface to be cleaned.

NOTE: Twist the accessory part when connecting them to the wand or hose so they are securely in place. Ensure that installed parts are secure by trying to pull them apart.

1. Assemble the appliance and accessory parts depending on the surface you want to vacuum clean (Fig. 1 – 10).
2. Ensure that the auxiliary air regulator is shut (Fig. 2).
3. If you use the telescopic tube (Fig. 3), adjust its length (Fig. 4).
4. If you use the combination floor tool (Fig. 5), using the rocker switch, set it to the floor to be cleaned (Fig. 6 hard floor, Fig. 7 carpet).

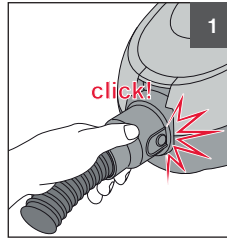

Attach hose to vacuum cleaner.

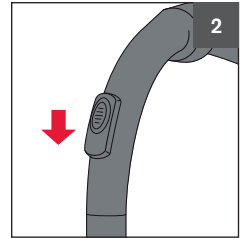

Close auxiliary air regulator.

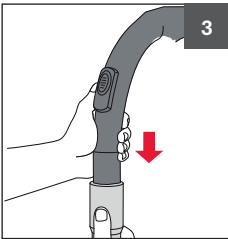

Connect hose to telescopic wand.

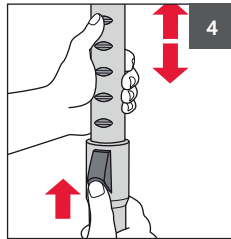

Telescopic wand height adjust.

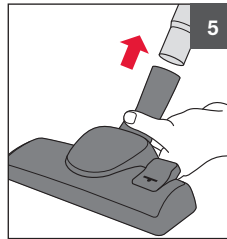

Combination floor tool.

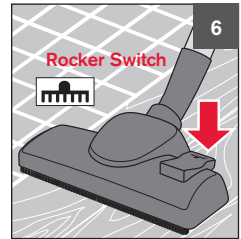

Hard floors.

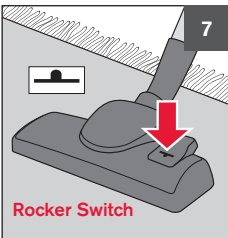

Carpet.

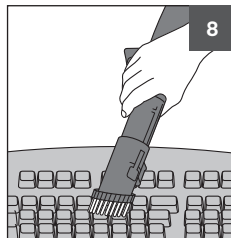

Dusting brush.

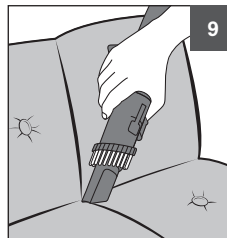

Crevice tool.

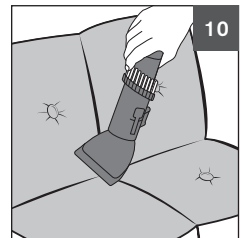

Upholstery tool.

Vacuum cleaning

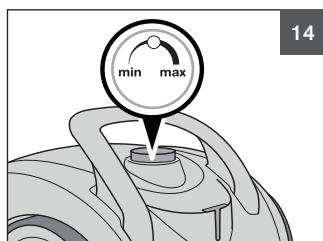
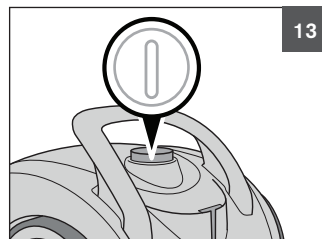
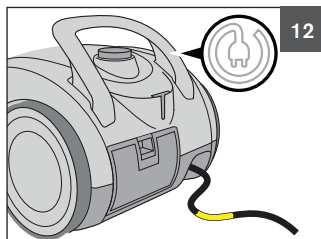
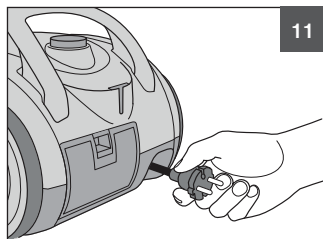

WARNING: Danger of injury! Check appliance and power cord before each use. A damaged appliance or power cord must never be used.

CAUTION: Only use the appliance with all filters clean, undamaged, dry and correctly fitted. Make sure that no objects obstruct the telescopic tube, the suction hose or other openings.

1. Pull the cable out of the appliance (Fig. 11) and plug into a socket.

WARNING: Danger of electric shock! If the red marking shows retract the cord by pressing the cord retract button to pull in the cord up to the yellow mark (Fig. 12) again.

2. Switch on the appliance using the on/off switch (Fig. 13).

3. Set the power to the setting that corresponds to the cleaning task. (Fig. 14).

NOTE: The auxiliary air regulator must be completely closed for vacuum cleaning. With the auxiliary air regulator you can quickly reduce the suction power, to release objects (such as curtains) that have been sucked in.

4. Vacuum clean (Fig. 15).

WARNING: Danger of injury! When vacuum-cleaning stairs make sure that you always stand on a higher level than the appliance.

WARNING: Keep the appliance out of the reach of children.

OPERATION

After use

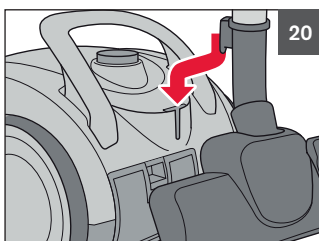
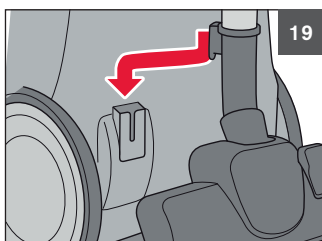
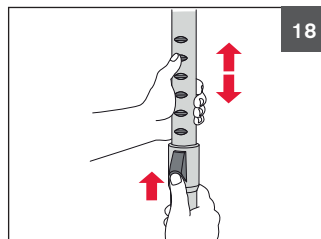
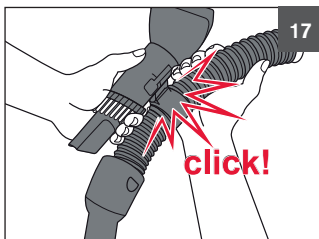
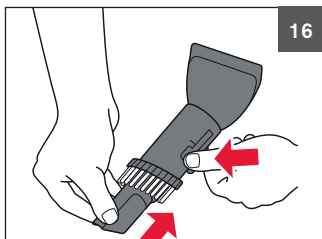

 **WARNING:** Danger of injury! After vacuuming, switch off the appliance and wind up the power cord. When winding up the cord keep the plug in your hand so that the cord does not cause injury.

 **CAUTION:** Never store the appliance next to heat sources (e.g. stoves or radiators). Avoid exposing it to direct sunlight. Store the appliance and accessories in a cool and dry location (Fig. 16 – 20).

 **CAUTION:** If you intend to store the appliance for a long period of time without use, it is recommended that the bag be replaced with a new one, refer to 'Changing the dust bag'.

Changing the dust bag

CAUTION: Switch off the appliance before changing the dust bag.

CAUTION: To avoid damage to the vacuum cleaner, never use the appliance without having inserted a dust bag. Otherwise, the appliance might be damaged.

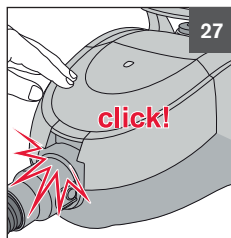
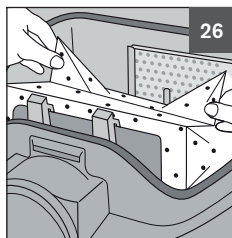
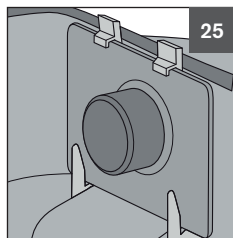
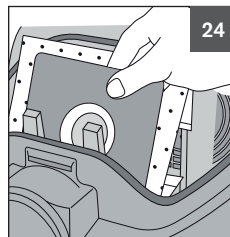
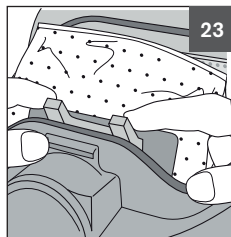
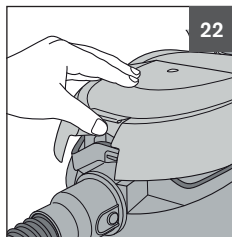
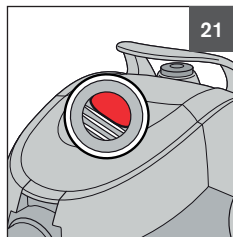

NOTE: As soon as the dust bag change indicator appears in the window (Fig. 21), the dust bag has to be changed. In addition, change the dust bag at least every three months and before storing for a long period.

1. Switch off the appliance.
2. Pull the plug out of the plug socket.
3. Use the lid release button to open the dust compartment cover (Fig. 22).
4. Pull the full dust bag out carefully (Fig. 23 – 24).
5. Insert a new dust bag (Fig. 25).
6. Check whether the dust filter bag is flush with the edges.
7. Unfold the bag after insertion (Fig. 26) so that it can erect itself during vacuuming and fill up optimally.
8. Shut the dust compartment cover (Fig. 27).

MAINTENANCE

Cleaning / changing the pre-motor filter

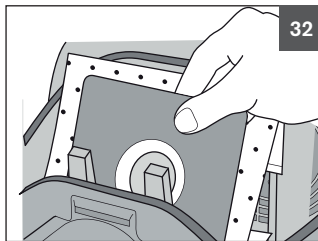
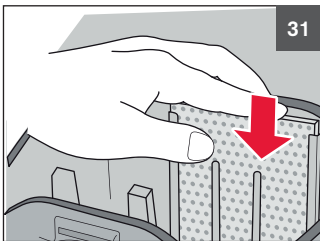
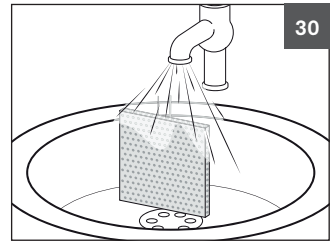
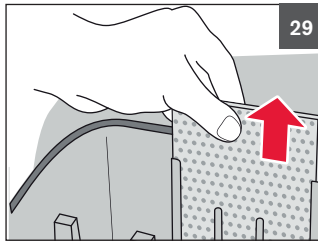
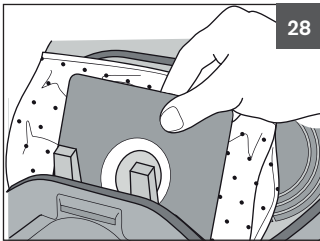

CAUTION: Clean the pre-motor filter every time you change the dust bag, and at least every 3 months. Replace the pre-motor filter at least every 6 months, depending on level of use. As a rule filters must be replaced as soon as they are discoloured, deformed or damaged.

CAUTION: The filter is washable, but it may not be cleaned in dishwashers or washing machines. Also, do not use cleaning agents or brushes with hard bristles. Leave the filter to dry thoroughly after cleaning it with water (approx. 24 hours at room temperature). Only put it back in place when it is completely dry.

1. Switch off the appliance.
2. Pull the plug out of the plug socket.
3. Take the full dust bag out of the appliance (Fig. 28), refer to: 'Changing the dust bag'.
4. Pull the filter up and out of the filter holder (Fig. 29).
5. Rinse out the filter thoroughly with running cold or lukewarm water (Fig. 30).
6. Leave the filter to thoroughly dry (approx. 24 hours at room temperature).
7. Insert the filter back into the filter holder (Fig. 31).
8. Put the dust bag back in (Fig. 32), refer to: 'Changing the dust bag'.

Cleaning / changing the post-motor filter

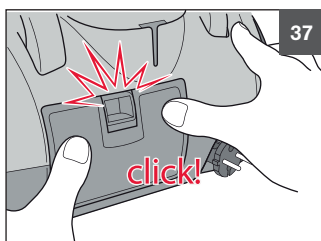
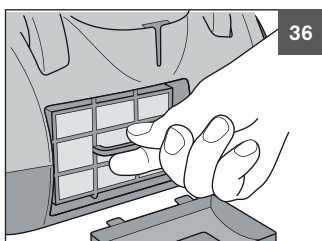
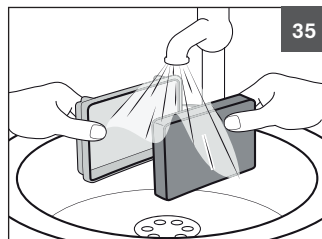
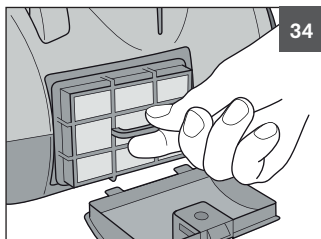
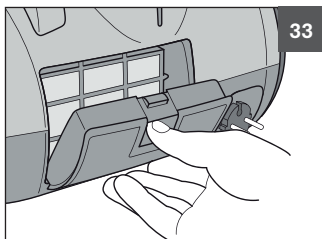

⚠ CAUTION: Clean the post-motor filter each time you clean the pre-motor filter. Replace with a new filter as soon as it has been discoloured, deformed or is damaged or at least every 6 months, depending on level of use.

⚠ CAUTION: The filter is washable, but it may not be cleaned in dishwashers or washing machines. Also, do not use cleaning agents or brushes with hard bristles. Leave the filter to dry after cleaning it with water (approx. 24 hours at room temperature). Only put it back in place when it is completely dry.

1. Switch off the appliance.
2. Pull the plug out of the plug socket.
3. Open the post-motor filter cover as shown (Fig. 33).
4. Take the filter out of the appliance (Fig. 34).
5. Rinse out the post-motor filter thoroughly under running cold or lukewarm water (Fig. 35).
6. Then leave the post-motor filter to dry (approx. 24 hours at room temperature).
7. Put the filter back into its holder (Fig. 36).
8. Put the post-motor filter cover into its recesses.
9. Push the cover until it locks into place (Fig. 37).

FAQ



WARNING: To reduce the risk of personal injury, unplug the vacuum cleaner before performing maintenance/troubleshooting checks.

Problem	Solution
The cleaning results are unsatisfactory in spite of the appliance working correctly	The air auxiliary regulator (Fig. 2) is open. Close the air auxiliary regulator (Fig. 2).
	Position of the suction power control is not appropriate (Fig. 14). Adjust the position of the suction power control (Fig. 14).
	The attached accessory is unsuitable. Change the accessory, 'Assemble appliance and adjust accessories to surface'.
	The collar brush of the combination floor tool is not in a position appropriate to the type of floor (Figures 6 – 7). Adjust the position of the collar brush on the combination floor tool switch using the rocker switch (Figures 6 – 7).
	The dust bag is full. Replace the dust bag 'Changing the dust bag', page 7.
	The filters are dirty. Clean the filters, pages 8-9.
	Accessories, telescopic tube or suction hose is blocked. Remove the obstruction. If necessary, use a long wooden stick (e.g. a broomstick) to do this.
The dust filter bag change indicator appears in the window (Fig. 21).	The dust bag is full. Change the dust bag, page 7.
	The filters are dirty. Clean the filters, pages 8-9.
	Accessories, telescopic tube or suction hose is blocked. Remove the obstacle. If necessary, use a long wooden stick (e.g. a broomstick) to do this.
The vacuum cleaner stops suddenly	<p>The overheating protection has tripped (possibly due to blocked suction channels, filters, or similar).</p> <ol style="list-style-type: none">1. Switch the appliance off and pull the plug out of the socket.2. Remove the cause of overheating (e.g. by disassembling telescopic tube and suction hose and removing the obstacle and/or cleaning filters).3. Wait approx. 1 hour until the appliance has cooled off.4. After the appliance has cooled off, you may switch it on again.

WE'RE HERE TO HELP

Instead of taking me back to the shop, simply call

AU: 1300 361 505
NZ: 0800 800 900

dirtdevil.com.au

This does not affect your statutory rights



OTHER INFORMATION

Dirt Devil Service & Help

Dirt Devil Service Line:

Australia 1300 361 505

New Zealand 0800 800 900

Monday-Friday 8.30am to 5.00pm

If you have queries or concerns about using your Dirt Devil, call the Dirt Devil Service Line. Calls are charged at the standard local rate. Please make a note of the serial number and model number of the vacuum cleaner before calling.

For the nearest Service Agent, please call the Dirt Devil Service Line or visit dirtdevil.com.au

Technical Specification

Model No.	DDBBC
Voltage	220-240V ~50/60Hz
Power	1800W
Dust Container Capacity	2L
Weight	3.9kg
Cord length	6m

Subject to technical change without notice.



Double Insulated



Indoor Use



Read Instructions



Waste electrical products should not be disposed of with household waste. Please recycle where facilities exist. Check with your Local Authority or retailer for recycling advice.

NOTES



NOTES

NOTES



Distributed by Techtronic Industries Australia Pty. Ltd.

Level 1, 660 Doncaster Road,

Doncaster, Australia 3108.

www.dirtdevil.com.au

Service Line:

AU: 1300 361 505 / NZ: 0800 800 900

LET'S GO.