



babybee comet

instruction manual

Please keep in a safe place for future reference

Contact babybee prams by emailing
support@babybeeprams.com.au

www.babybeeprams.com.au

Hello!

Thank you for choosing the babybee Comet.

Before you get started, there's a few quick things we'd like you to note:

Return Policy

Keep in mind that we offer a 9 month free return policy. If for whatever reason this isn't the perfect product for you, please email us at support@babybeeprams.com.au and we'll walk you through the process to return your purchase free of charge.

Please note that as per our returns policy will only accept returns where the product is in its original condition (with no signs of use) and in all original packaging including box and protective plastics and cardboard. Please take care when unpacking and assembling and ensure you keep all packaging components in a safe place and out of reach of any children.

Support

If at any stage you require any assistance with setup or use, please email us for assistance. Alternatively we have an assembly demonstration video which you can access via our website.

Warranty

Rest assured that our travel systems come with an 18 month warranty to cover against faults in materials and workmanship when your products are used under normal conditions, according to our manuals and technical specifications. Please refer to page 14 for further information.

Keep in touch

We love nothing more than seeing our customers with the Comet in action so we hope you connect with us soon via one of our social media channels!

Enjoy the ride!

The babybee team

Safety First

The safety of you and your family is our number one priority. Please take the time to carefully read this manual in full, and keep it in a safe place for future reference.

If you require any assistance please don't hesitate contact us by emailing support@babybeeprams.com.au

Tested to comply with the Australian Safety Standard:
"AS/NZS 20088:2013 Pram and Stroller – Safety Requirements"

WARNING!

With the exception of the outer cardboard packaging, to prevent injury from choking, remove and immediately move out of reach, all protective packaging. Never leave your child unattended with the travel system or packaging.

Using your Comet

What's in the box.....	04
Get to know your Comet - Terminology.....	05
Step 1: Install the brake and wheels.....	06
Collapsing the frame.....	07
Step 2: Attach/release bassinet to the frame.....	08
Step 3: Attach the canopy.....	09
Rear brake, front swivel wheels and adjusting the push-bar.....	10
Switching from bassinet to stroller seat.....	11
Seat position and 5 point safety harness.....	12
Setting up your bassinet.....	13-14
Setting up the canopy.....	15
Maintenance and cleaning.....	16
Warranty.....	17
Safety warnings.....	18-20

What's in the box

please note:

depending on your order, you may receive 2 boxes



- A. Frame/chassis
- B. Push-bar organiser
- C. Foot muff
- D. Bassinet & seat frame
- E. Bassinet base board
- F. Seat liner
- G. Canopy
- H. Seat fabric
- I. Bassinet mattress
- J. Front swivel wheels
- K. Rear wheels
- L. Bassinet & seat belly bar
- M. Brake
- N. Rain cover and mosquito net
- O. Bassinet apron

Get to know your new Comet – Terminology



- A. Canopy with magnetic peekaboo
- B. Bumper bar
- C. 5 point safety harness
- D. Seat liner
- E. Seat frame (same as o)
- F. Front swivel wheel lock
- G. Front swivel wheel
- H. Bassinet/Seat frame release
- I. Seat recline buttons
- J. Frame release clips (to release from folded position)
- K. Push-bar
- L. Bassinet apron
- M. Push-bar height adjustment buttons
- N. Frame collapse levers
- O. Bassinet frame (same as e)
- P. Shopping basket
- Q. Rear wheels
- R. Brake

Step 1: Install the brake and wheels

1. To release the frame from the folded position, simultaneously pull back on the black frame release clips and lift. These clips can be found either side of the frame.



2. When the frame is fully open you will hear a "click".

3. At the rear of the frame, take the brake attachment section and attach this to the frame. Push down until you feel a 'click' and when you can see the two silver locking pins in place.



4. Now you're ready to attach the large rear wheels. Push each wheel onto the pin until you hear a "click".

5. Move around to the front wheel location and insert each front wheel pin into the socket until you hear a "click".



6. With all of the wheels now in place, individually pull them just to make sure they are all securely held in place.

Practice collapsing the frame from this position

1. Hold the push-bar against your body for support.
2. To fold the frame, **pull up** on the 2 black frame collapse levers located on both sides of the frame while pressing the safety button underneath (only on the right lever).



3. Once pulled up, press downwards on the frame and it will collapse on itself.



4. Make sure the black frame release clips have clicked in to place to secure it from opening again.

To release the pram as you did in step one, simply pull back on those same black frame release clips and pull the frame up until it clicks into place. Practice this a few times so you've got the hang of it. Don't worry it will become second nature in no time!

Also note that the pram can be collapsed with the seat attached when in the forward facing position, however the bassinet will need to be removed first.

Step 2: Attach/release the bassinet to the frame

1. Select which direction you'd like the bassinet to face and simply click it on to the side frame connectors.



2. To release simply push the grey bassinet frame release buttons, in the direction of the arrow, and off it pops!



Step 3: Assemble your bassinet

1. Place the bassinet base board into the bottom of the bassinet, and secure with the velcro tabs at each end. Once secured, simply place bassinet mattress on top.



2. Now it's time to zip on the bassinet apron, the zip may seem a little stiff at first, this will soften over time. Attach the bumper bar to the bassinet. Ensure you hear a 'click' so you know it's securely attached. To release the bumper bar, simply press the release buttons located on both sides.



Step 3: Attach the canopy

1. Your canopy should come pre-assembled. To attach it to the frame, first secure the bottom side of the connector to the frame, then pull and clip the topside over and into place. Repeat on other side. Make sure the connectors are as close to the middle of the frame as they can be (as shown in the pictures below, there should be no gap between the bumper bar and the canopy connectors).

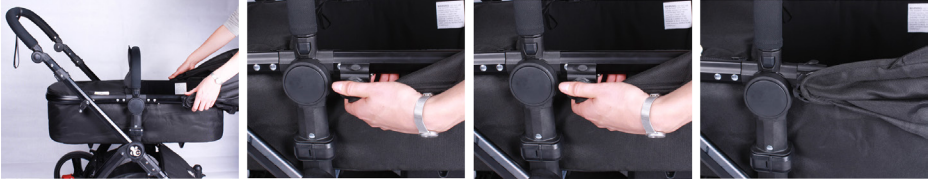

2. You may wish to have the front peak of the canopy flipped forward to provide a little extra protection



3. Finally pull the fabric over the bassinet into place.

Your bassinet is now set up and ready to use!

WARNING!

Only use the bassinet in a flat position. Do not recline.

Please take note of the following 3 features before you get going

Rear brake

When stopping, use the brake at all times by pressing down on the black bar with your foot until you feel it click into place. To start travelling again, lift the bar up with your foot and off you go!



Front swivel wheels

When travelling along straight surfaces the front wheels may spin or cause “wheel shudder”. To lock the front swivel wheels into place simply press down on the grey buttons at the front of the wheel. To go back to 360° swivel mode simply press the buttons up again.



Adjusting the push-bar height

To adjust the push-bar height, simply press both of the grey buttons at the same time and select your height.



Switching from bassinet to stroller seat

There's no set age when your little one should go from bassinet to stroller, however, they should be able to sit up unaided.

1. To get started, remove the bassinet fabric from the frame entirely.
2. Push the grey seat recline buttons to adjust the frame and also note that the metal knobs on either side of the frame should be at the bottom.
3. Pull the headrest section over the top of the frame and pull the rest of the seat down firmly into place.

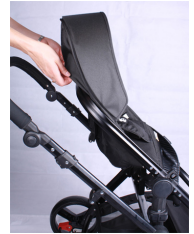

4. Next take the safety straps and hook them onto those metal knobs. Then secure the clip behind the seat, and pull the strap tight.



5. Secure the 4 Velcro tabs around the base of the frame.



6. Next insert the seat liner (optional) through the safety harness (you will need to remove the harness padding for this).

7. Attach the bumper bar
8. Attach the canopy, in the same way you did with the bassinet (page 9) when attached to the seat, ensure the two velcro tabs on the canopy, are secured to the velcro tabs that are located on the back of the seat.



Your stroller is now set up and ready to use!

Please take note of the following two features before you get going:

Seat position

To adjust the seat position, simply press and hold the two circle seat recline buttons simultaneously, and tilt to your ideal height. Make sure you hear the “click”.



5 point safety harness

For the safety of your little one, please ensure the harness is secured at all times.

1. Adjust the straps to suit your little ones size.
2. Make sure all 4 straps are secured into the clip.
3. Once fastened, tug the harness to make sure it is secure.



And you're ready to explore!

Setting up your bassinet

Note: The front of the bassinet (where you baby's feet will lie) will be the side of the frame with the two small metal knobs that jut out. The front of the bassinet fabric is the side that has the zipper edge.



To begin, attach the front half of the bassinet fabric to the front half of the frame. This section can be quite tricky so please take your time. Forcing or pulling the fabric too hard may cause the fabric to tear.

1. Take the front (zipper side) of the bassinet fabric and start feeding the hard fabric (plastic rod inside) through the grooves on the side of the frame. Note this can be difficult, the trick is to press your thumb against the groove to guide the rod in and push the rest through with your other hand (see 3rd photo for where to push thumb). You should not need to force or push too hard.



2. Once the front half is on you'll notice that the plastic rod doesn't go all the way around the other half. Simply take the rod section of fabric on each side and simultaneously feed the fabric through the grooves.



3. Attach the two Velcro straps to the back of the frame.



4. Place the bassinet base board into the bottom of the bassinet, and secure with the velcro tabs at each end. Once secured, simply place bassinet mattress on top.



6. Zip on the bassinet apron, the zip may seem a little stiff at first, this will soften over time. Attach the bumper bar to the bassinet. Ensure you hear a 'click' so you know it's securely attached. To release the bumper bar, simply press the release buttons located on both sides.



Well done!

Setting up the canopy

1. Thread the two canopy rods through the inserts of the canopy fabric.



2. Connect the canopy rods to the canopy connectors. Note the L and R marked on each so you know which is left and right



Please note: the canopy won't extend correctly if the canopy connectors are on the wrong sides and damage may be caused to the canopy rods, resulting in your canopy becoming unusable, please ensure they are on the correct sides of the pram frame.

3. Once the connectors are on you can secure the fabric to them using the two elastic loops on each side.
4. To attach to the frame, ensure your bassinet/seat is facing the push-bar and approach from the front of your pram that has swivel wheels. First secure the bottom side of the connector to the frame, then pull and clip the topside over and into place. Repeat on other side. Make sure the connectors are as close to the middle of the frame as they can be.



5. Finally pull the fabric over the bassinet/seat and into place.

Maintaining your travel system

Your travel system requires regular maintenance. Regularly inspect the locking devices, brakes, harness, catches, joints and fixtures to ensure they are secure and in fully working order.

The brakes and wheels are subject to normal wear and should be replaced if necessary. This can be arranged by contacting us. Should any parts of the travel system become stiff or difficult to operate, ensure that dirt is not the cause, try a light application of sprayable lubricant, ensuring that it penetrates between the components. Take care as excessive application may encourage the buildup of dirt. Regular light lubrication of moving parts will extend the life of your travel system.

Do not leave the travel system in direct sunlight for prolonged periods of time when possible. Do not leave in car on hot days.

Store the travel system in a dry, well-ventilated and safe place.

After exposure to wet or damp conditions, leave the travel system fully opened in a warm, well ventilated environment. You may need to dry with a soft, lint free cloth. Left damp it will encourage mildew or rust to form, damaging the travel system.

We recommend servicing your travel system every 2 years.

Cleaning instructions

All plastic, fabric and metal parts of the travel system may be sponged clean with warm water and mild detergent.

All fabrics are machine washable in cold water. Ensure only delicate detergent and settings are used. Always wash separately.

Never clean with abrasive surfaces or using ammonia, bleach or spirit-based cleaners. Never dry clean.

Allow all parts to dry thoroughly before using. Never tumble dry.

Warranty information

All of our travel systems come with an 18-month warranty to cover against faults in materials and workmanship when your products are used under normal conditions, according to our user manuals and technical specifications. Please note: this excludes accessories.

Our goods come with guarantees that cannot be excluded under the Australian Consumer Law. You are entitled to a replacement or refund for a major failure and compensation for any other reasonably foreseeable loss or damage. You are also entitled to have the goods repaired or replaced if the goods fail to be of acceptable quality and the failure does not amount to a major failure.

The 18-month period starts from the date your travel system is dispatched from our warehouse.

The warranty is not valid in the following cases:

- o Defects resulting from improper care or use;
- o Normal wear and tear, including scratches to the travel system frame;
- o Products that are purchased second hand or from an unauthorised distributor;
- o Faulty or incorrect assembly;
- o Using a part or accessory that is not compatible with the product and/or not manufactured by babybee prams;
- o Tyre punctures;
- o Damage to handlebar grips or fabrics as a result of normal handling and daily use;
- o Claims from anyone other than the original purchaser (i.e. no longer valid if you give you your sibling to use with their family)
- o Damage resulting from extreme heat conditions (i.e leaving in car on hot days)

To make a claim simply email support@babybeeprams.com.au with a detailed description and/or photos of the defect.

SAFETY WARNINGS

The babybee Comet is designed and tested to comply with AS/NZS2088:2013.

The ACCC has identified several hazards associated with prams and strollers

which could result in serious injury or even death:

- **The pram or stroller rolling away from the carer's control.** We strongly advise using parking brakes and tether straps at all times to ensure the pram or stroller cannot move away when stopped. Parking the pram or stroller horizontal to potential dangers is another precaution you can take.
- **Limb and finger injuries.** If children gain access to certain parts of the pram or stroller they may trap and/or injure their limbs or fingers. Ensure children are away from the pram or stroller prior to adjusting it.
- **Falls.** Children not properly restrained in a pram or stroller can either fall out or move to a position where the pram or stroller can topple. This can also occur if additional bags or children are hung or carried or parts of the pram not designed to do so.
- **Strangulation or suffocation.** Strangulation or suffocation can occur if children become trapped in parts of the pram or stroller in particular the rain cover and safety harness.

Bassinet

Only use the bassinet in a flat position. Do not recline. Child should not be left unsupervised in bassinet. Bassinet is not suitable for overnight sleeping.

Operation of the travel system

Do not use or leave the travel system near open fire or exposed flame. Never leave rain covers, hoods and/or aprons on or over the travel system indoors, in a hot atmosphere or near a heat source. Always supervised whilst the travel system is covered.

Brakes

Always engage the brakes when the travel system is stationary. Hold on to your travel system or the tether strap when close to any moving machinery. Even with the brakes engaged, the breeze from vehicles (for example) may cause the travel system to move.

Supervision

Never leave your child unattended and always keep you child in view while the travel system is in use. Do not allow your child to climb unassisted into the travel system. The travel system should only be used under adult supervision.

Safety harness

Please ensure that your child correctly wears the fitted and adjusted harness at all times. Never leave harness buckled when not fitted to the child in the travel system. The harness can form loops which may cause a strangulation hazard.

Adjusting the travel system

Keep children clear of the travel system before making adjustments. To avoid entrapment, keep your own and your children's fingers clear of any folding parts.

Lifting and moving the travel system safely

Do not lift or carry the travel system when occupied by baby. Do not lift or carry the travel system when fully assembled. Only lift and carry when folded. Ensure that the storage latch is engaged when lifting or carrying the travel system. Make sure travel system is secure when carrying in vehicles.

Others using your travel system

If the travel system is being to be used by someone unfamiliar with it (such as grandparents) always explain to them how the travel system works and its safety features.

Maintenance

The travel system requires regular maintenance. Regularly inspect the locking devices, brakes, harness assembly, catches, seat adjusters, joints and fixtures to ensure they are secure and in full working order. The brakes and wheels are subject to wear and should be replaced if required. This can be arranged by contacting us.

General safety

Take care when using on stairs or escalators. Gentle sloping surfaces may be unstable. On steeper sloping and uneven surfaces, there is a possibility that the travel system may tip over.

Do not use the travel system in a manner for which it is not designed.

Incorrect use of the travel system

Overloading, incorrect folding and/or the use of non-approved accessories may damage, break or otherwise render the travel system unsafe for use.

Do not overload the travel system with additional children, heavy packages, goods or accessories. Bags and other items must not be hung from the push-bar as they may damage the frame or otherwise cause the travel system to become unbalanced and tip over.

Do not use replacement parts or accessories, e.g. child seats, bag hooks, rain covers, etc. other than those approved or supplied by babybee prams.

Maximum weight limits:

- Maximum weight for a child in the bassinet is 9kg
- Maximum weight for a child in the seat is 17kg
- Maximum weight for items in the pockets on the back of the seat is 1kg
- Maximum weight for items in the basket is 4.5kg

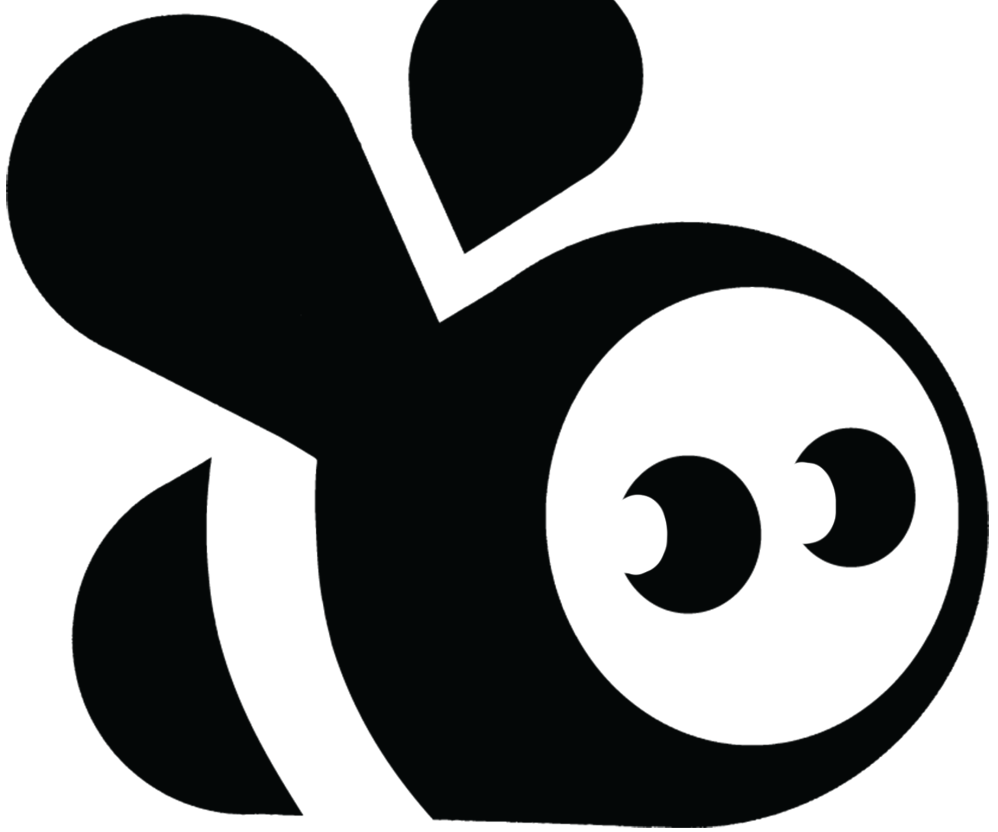

babybee prams

Contact babybee prams

support@babybeeprams.com.au



www.facebook.com/babybeeprams



[@babybeeprams](https://www.instagram.com/babybeeprams)



[pinterest.com/babybeeprams](https://www.pinterest.com/babybeeprams)

Version March 2016