

Vax Service line: AU: 1300 361 505
NZ: 0800 800 900

Machine Overview

- 1 Hose connector
- 2 Dirt container
- 3 Cyclone separator and shroud
- 4 Carry handle
- 5 Dirt container release button
- 6 Cord rewind button (hidden)
- 7 Floor head parking slot
- 8 On/off button
- 9 Post-motor filter cover
- 10 Primary separator
- 11 HEPA H12 antibacterial post-motor filter
- 12 Pre-motor filter
- 13 Motorised powerhead
- 14 Hardfloor tool
- 15 Telescopic extension tube
- 16 Dusting brush
- 17 Crevice tool
- 18 Flexible hose and handle
- 19 Upholstery tool
- 20 Mini turbo tool

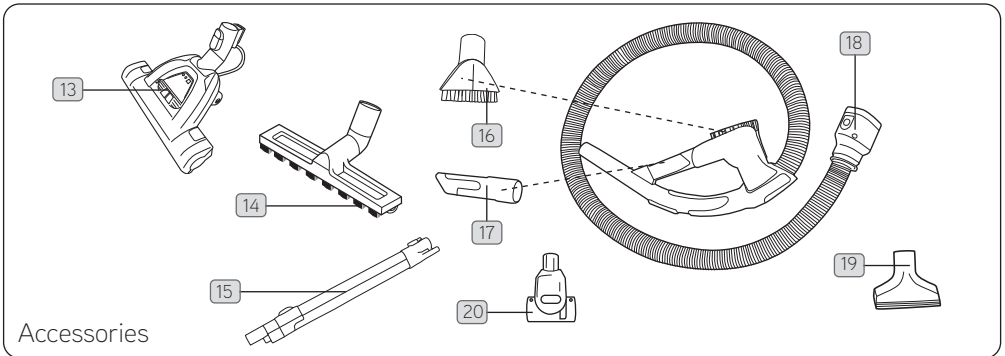
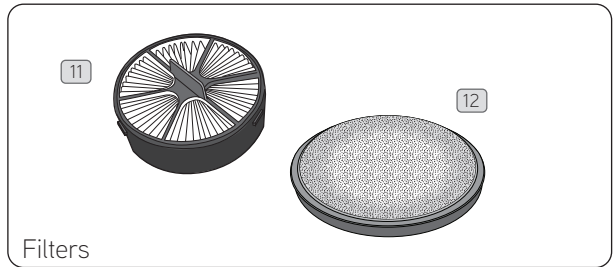
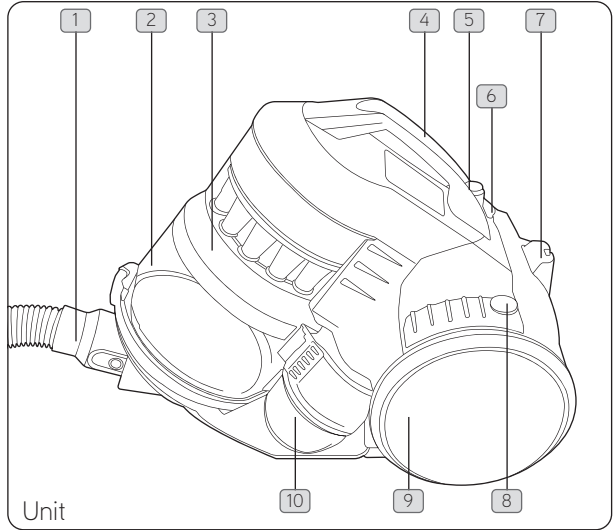

General Safety Information

FOR HOUSE HOLD USE ONLY.

When using the vacuum cleaner, basic safety precautions should always be observed, including the following:

1. Only use the vacuum cleaner indoors on dry surfaces. Do not handle the plug or vacuum cleaner with wet hands. Do not use outdoors or on wet surfaces.
2. Turn off the vacuum cleaner controls before disconnecting or connecting from the electrical socket.
3. Always unplug the vacuum cleaner before connecting or disconnecting the hose and accessories.
4. Children should be supervised to ensure that they do not play with the appliance.
5. This appliance is not intended for use by persons (including children) with reduced physical, sensory or mental capabilities, or lack of experience and knowledge, unless they have been given supervision or instruction concerning use of the appliance by a person responsible for their safety.
6. Only use as described in this manual. Only use Vax recommended attachments.
7. Do not use the vacuum cleaner if it has been dropped, damaged, left outdoors or dropped into water. Do not use the vacuum cleaner with a damaged cord or plug. If the supply cord is damaged, it must be replaced by the manufacturer or a recommended Service Agent to avoid hazard and invalidating the warranty.
8. Do not pull or carry by cord. Do not use the cord as a handle, close a door on the cord or pull cord around sharp edges or corners. Do not run the vacuum cleaner over the cord. Keep the cord away from heated surfaces.
9. Do not put any objects into openings. Do not use with any openings blocked and do not restrict air flow. Keep all openings free of dust, lint, hair or anything that might reduce airflow.
10. Keep hair, loose clothing, fingers and all parts of the body away from openings and moving parts.
11. Do not pick up hot coals, cigarette butts, ash, matches or any hot, smoking or burning objects.
12. Do not pick up flammable or combustible materials (lighter fluid, petrol, kerosene etc.) or use in the presence of explosive liquids or vapours.
13. Do not vacuum harmful or toxic materials (chlorine, bleach, ammonia, drain cleaner etc.).
14. Do not vacuum hard or sharp objects such as glass, nails, screws, coins, etc.
15. Do not vacuum plaster dust, concrete or any other building or vitreous material.
16. Do not use without ALL of the filters in place.
17. Take extra care when vacuuming on stairs.
18. Keep vacuuming area well lit.
19. Store the vacuum cleaner in a cool, dry area.
20. Turn off the on/off switch before unplugging the vacuum cleaner.

21. Use only SAA-approved 10 amp extension cords. Non-approved cords may overheat. Care should be taken to arrange the cord so that the cord cannot be tripped over.



WARNING: Always switch off and unplug the vacuum cleaner from the electrical socket before assembling, opening or emptying the dirt container, or before connecting/disconnecting the attachments.



CAUTION: The vacuum cleaner is a very powerful unit. Before plugging the cord into the electrical socket, make sure the switch is in the 'off' position.



IMPORTANT: If the inlet, hose or telescopic tube is blocked, switch off the vacuum cleaner and remove the blockage(s) before re-starting the vacuum cleaner. See Maintenance: Clearing blockages.



IMPORTANT: Washing filters maintains vacuum performance. Vax recommends that they should be checked and cleaned periodically (depending on the level of use). Make sure all filters are completely dry before inserting back into the vacuum cleaner.



NOTE: If the supply cord is damaged it must be replaced by the manufacturer, or a similarly qualified person in order to avoid a hazard, or invalidating the warranty.



IMPORTANT: Vax recommends the use of a Residual Current Device with a Residual Current Rating.



IMPORTANT: The motor is equipped with a thermal cut-out. If for any reason the unit should overheat, the thermostat will automatically turn the unit off. Should this occur, unplug the vacuum cleaner from the electrical socket and turn off the switch. Remove dirt container and empty. Clean filters. Allow the unit to cool for approximately one (1) hour. To re-start, plug into an electrical socket and switch back on.



CAUTION: This hose contains electrical connections:
– do not use to suck up water (for vacuum cleaners only);
– do not immerse in water for cleaning;
– the hose should be checked regularly and must not be used if damaged.

DAMAGE TO THE VACUUM CLEANER CAUSED AS A RESULT OF NOT ADHERING TO THE GENERAL SAFETY INFORMATION ABOVE INVALIDATES THE WARRANTY.

This machine is intended for house hold use only, and NOT for commercial or industrial use.

PLEASE KEEP THESE INSTRUCTIONS FOR FURTHER USE.

Operation

Keep your Vax like new

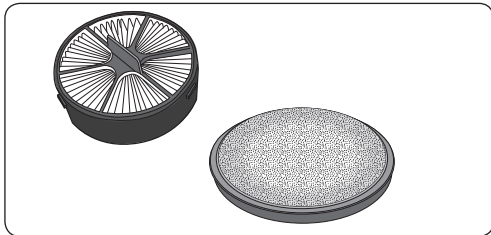

! IMPORTANT: The condition of the filters affects the performance of your machine. Please check and wash filters periodically (depending on the level of use). For full cleaning instructions, see pages 5-8.

! IMPORTANT: Do not use the vacuum cleaner without all of the filters in place.

Assembling your vacuum cleaner

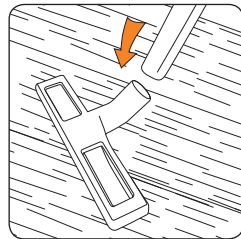
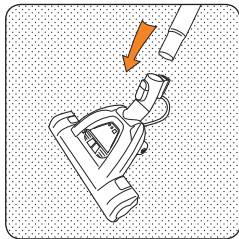
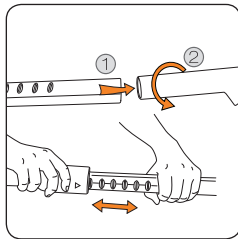
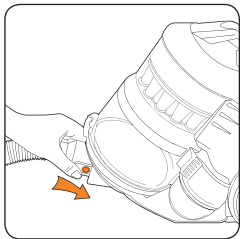

NOTE: The crevice tool, upholstery tool and dusting brush can all be attached to the telescopic tube or hose handle.

The motorised powerhead is used for cleaning carpets.

This tool is for safely cleaning hard floor surfaces such as floorboards, laminate, stone and tiled floors.

Operating the appliance and accessories

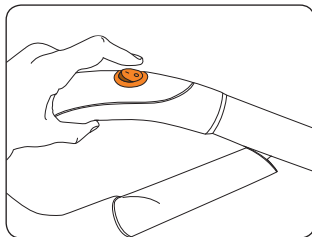
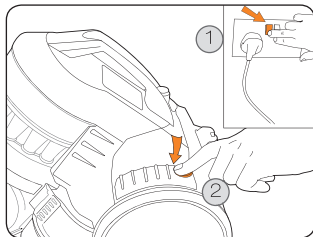
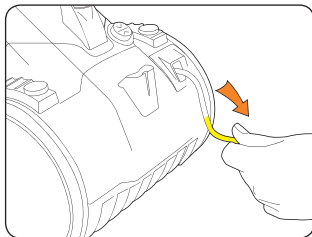

NOTE: Fully unwind the power cord. The yellow mark on the cord indicates the recommended cord length. Do not exceed the cord length beyond the yellow mark.

There is an option to switch the brushbar on the motorised powerhead off when using on carpets. The on/off switch is located on the hose handle.

Maintenance (Keep your Vax as good as new)

Packing away and storage

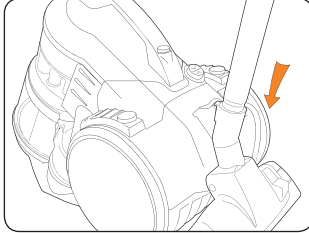
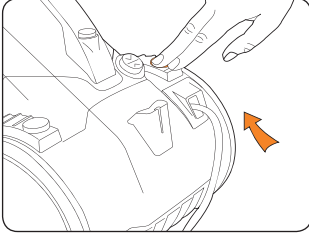

NOTE: For convenience there is a parking slot located at the rear of the vacuum cleaner where the floor head and tubes can be attached for storage and carrying.

Emptying and cleaning the dirt container

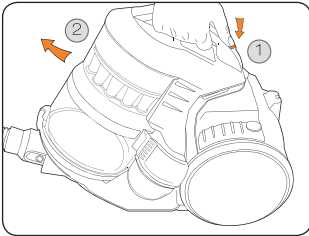

Press dirt container release button and lift.

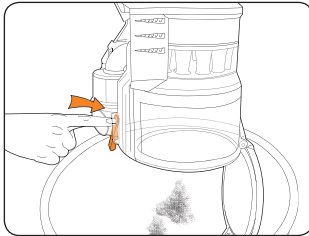

Press the dust release lever to empty dirt.

Maintenance (Keep your Vax as good as new)

Cleaning the pre-motor filter

 **IMPORTANT:** Water temperature should be a maximum of 40° C when washing pre-motor filter.

 **WARNING:** Allow pre-motor filter to completely dry before replacing in vacuum cleaner.

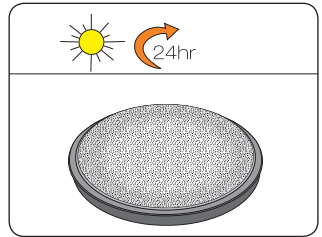
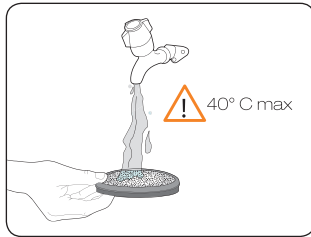
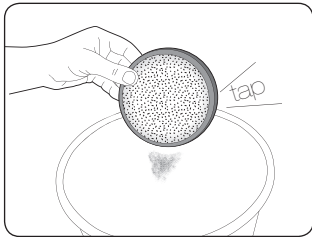
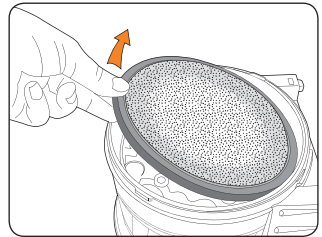
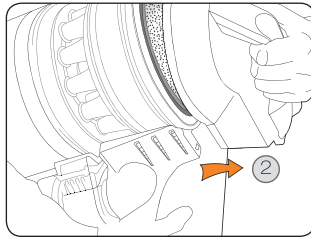
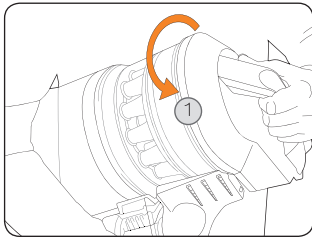

Cleaning the HEPA post-motor filter

 **WARNING:** Do not wash the post-motor filter.

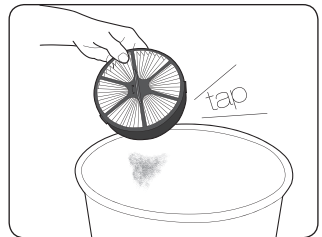
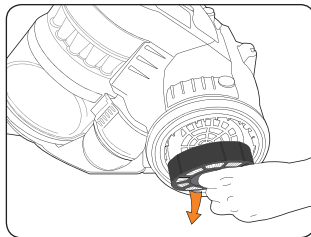
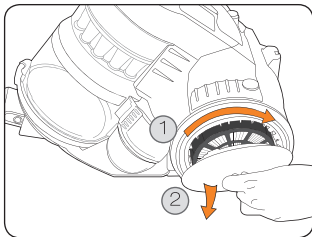

Maintenance (Keep your Vax as good as new)

Advanced cleaning – primary separator

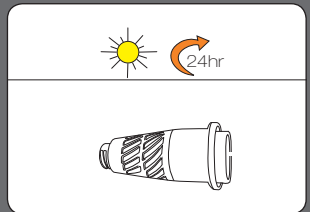
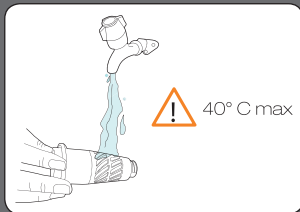
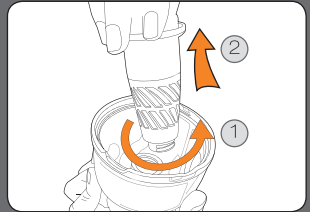
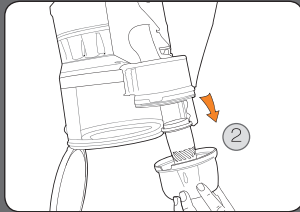
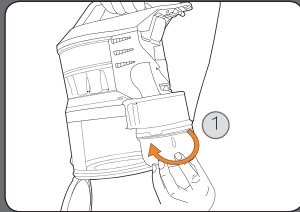

Advanced cleaning – cyclone separator

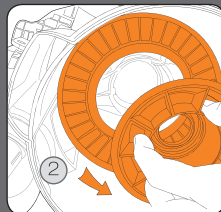
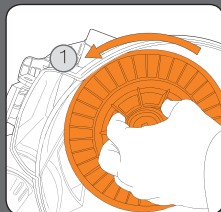
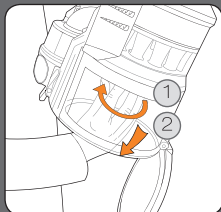

Wipe to clean.
Parts must be
completely dry
before using
your machine.

Maintenance (Keep your Vax as good as new)

Clearing blockages

⚠ WARNING: To reduce the risk of personal injury, unplug the vacuum cleaner before performing maintenance/troubleshooting checks. Disconnect the hose from the vacuum cleaner and remove any blockages found then reconnect the hose securely.

Hose blockages

The flexible hose may be disconnected from the vacuum cleaner. Carefully remove any blockages found and reconnect the hose securely.

Accessory blockages

Remove accessory from the hose/telescopic tube. Carefully remove the blockage and return to the cleaner.

Removing blockages from the Powerhead

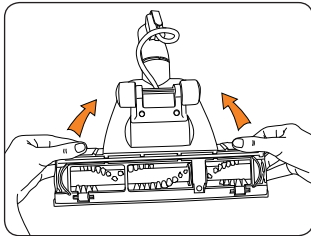

Open clips at either side of the Powerhead.

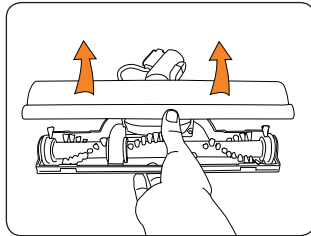

Lift top up to reveal brushbar.

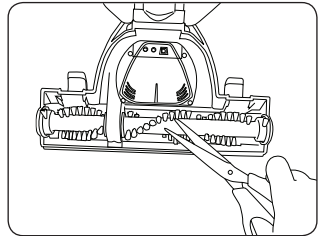

Cut away tangled hairs with a pair of scissors. Be careful not to cut the bristles on the brush bar.

Removing blockages from the TurboTool

NOTE: Switch the cleaner off and disconnect the power plug from the electrical outlet.

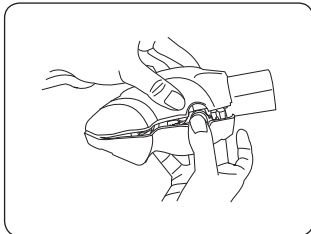

Press the two side buttons together & pull sides apart.

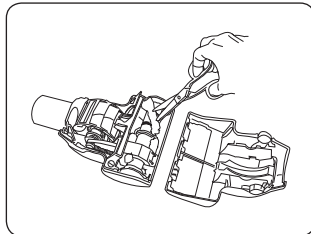

Carefully use scissors to cut out the blockage.

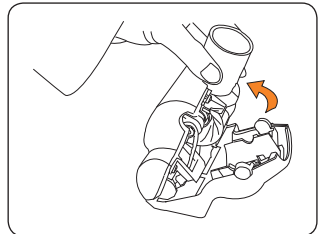

Realign turbo brush sides & press together.

FAQ's



WARNING: To reduce the risk of personal injury, unplug the vacuum cleaner before performing maintenance/troubleshooting checks.

Problem	Solution
There is an accessory missing	Check the 'Machine Overview' page in this guide to make sure the part is definitely included in your unit
	If it is missing, we're here to help. Simply call us on AU 1300 361 505 or NZ 0800 800 900
Why won't the vacuum cleaner pick up?	The dirt container may be incorrectly installed; remove the dirt container from the unit by pressing the dirt container release button and then re-attach it to the unit, ensuring it is locked firmly back into place.
	The filter may be clogged; Refer to 'Maintenance: Cleaning the filters' on page 6.
	The dirt container may be blocked; refer to 'Maintenance; Emptying and cleaning the dirt container' on page 5.
	There may be a blockage in the tube/hose. Disconnect from the vacuum cleaner, carefully remove any blockages found and reconnect securely.
Why is dust escaping from the vacuum cleaner?	The filter may be clogged; refer to 'Cleaning the filters' on page 6.
	The dirt container may be blocked; refer to 'Maintenance; Emptying and cleaning the dirt container' on page 5.
	The dirt container may be incorrectly installed; remove the dirt container from the unit by pressing the dirt container release button and then re-attach it to the unit, ensuring it is locked firmly back into place.
What do I do if the unit/accessory becomes damaged or broken?	We're here to help. Simply call us on AU 1300 361 505 or NZ 0800 800 900 or visit vax.com.au
Why won't the accessory pick up properly?	Hose blockages: remove the hose from the unit. Carefully remove any blockages found and reconnect hose securely.
	Accessory blockages: remove accessory from handle/tube. Carefully remove any blockages found and re-attach to the vacuum cleaner.
	The accessory may be faulty. Simply call us on AU 1300 361 505 or NZ 0800 800 900
Why will the vacuum cleaner not run?	It may not be plugged into the electrical outlet correctly; ensure that the plug is pushed in securely.
	The electrical outlet may not be working properly; check the fuse or breaker, or consult an electrician.
	The motor thermostat may have tripped; switch off and unplug the vacuum cleaner, and leave for one hour before switching the cleaner back on.

we're here to help

Instead of taking me back to the shop, simply call:

AU: 1300 361 505
NZ: 0800 800 900

vax.com.au

This does not affect your statutory rights.

Other Information

Vax Service & Help

Vax Careline:

Australia 1300 361 505
New Zealand 0800 800 900

Monday-Friday 8.30am to 5.00pm

If you have queries or concerns about using your Vax, call the Vax Careline. Calls are charged at the standard local rate. Please make a note of the serial number and model number of the vacuum cleaner before calling.

For the nearest Service Agent, please call the Vax Customer Careline or visit vax.com.au

Technical Specification

Vacuum Cylinder

Wattage: 1500W
Voltage: 220-240V ~50Hz
Capacity: 2.5L
Cord length: 6m
Weight: 5.6kg
Filters: Pre-motor filter (washable)
Post-motor filter – HEPA H12 antibacterial (not washable, tap to clean)

Motorised Powerhead

Voltage: 220-240V ~50Hz
Wattage: 35W

Subject to technical change without notice.



Double Insulated



N197



Indoor Use



Read Instructions



Waste electrical products should not be disposed of with household waste. Please recycle where facilities exist. Check with your Local Authority or retailer for recycling advice.



Performance is everything.™

Distributed by Techtronic Industries Pty. Ltd.
Level 1, 660 Doncaster Road, Doncaster, Australia 3108.
www.vax.com.au Service Line: AU: 1300 361 505 / NZ: 0800 800 900