

# ozito

power  
garden

# Lithium-ion Cordless Lawn Mower 36V

Instruction Manual  
2 Year Replacement Warranty  
**LML-036**

 **WARNING!** Read all safety warnings and all instructions. Failure to follow the warnings and instructions may result in electric shock, fire and/or serious injury. Save all warnings and instructions for future reference.



0612

To view the full range visit: [www.ozito.com.au](http://www.ozito.com.au)

# SPECIFICATIONS - MODEL NO. LML-036

<b>Battery power:</b>	1 x 36V, 2.6Ah Lithium-ion
<b>Charge time:</b>	3-5 Hours
<b>No load speed:</b>	3800/min
<b>Cutting diameter:</b>	370mm
<b>Height adjustments:</b>	5
<b>Cutting heights:</b>	30, 40, 50, 65 & 80mm
<b>Capacity of catcher:</b>	40 Litres
<b>Weight with battery:</b>	16kgs

## KNOW YOUR PRODUCT

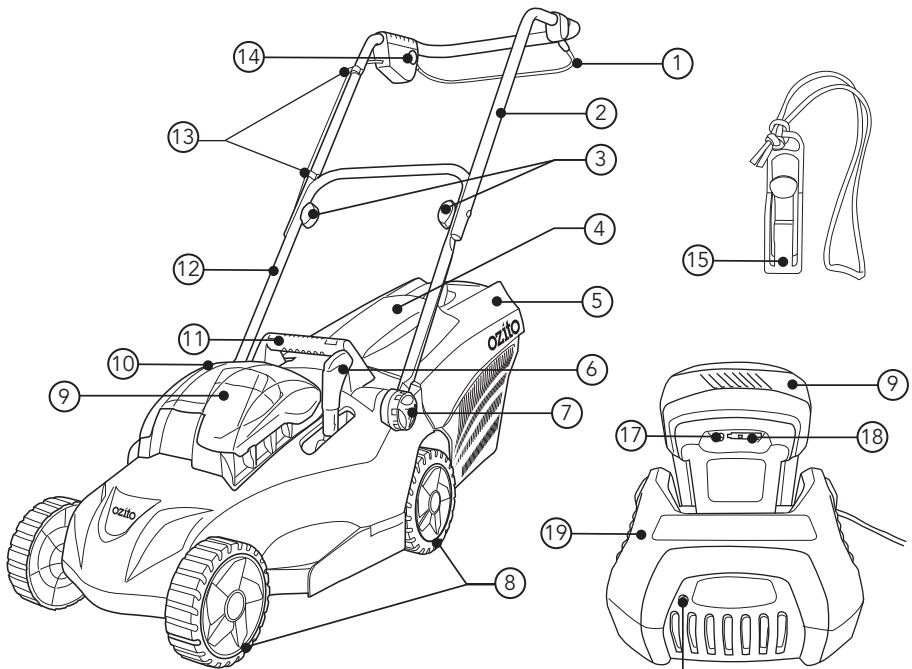

- |                            |                                     |
|----------------------------|-------------------------------------|
| 1. Start/stop lever        | 11. Lifting handle                  |
| 2. Upper handle            | 12. Lower handle                    |
| 3. Handle securing knob    | 13. Cord clips                      |
| 4. Grass catcher flap      | 14. Lock-off button                 |
| 5. Grass catcher           | 15. Safety key                      |
| 6. Height adjustment lever | 16. Securing Latch (not shown)      |
| 7. Quick adjustment knob   | 17. Battery charge indicator button |
| 8. Wheels                  | 18. Battery charge indicator        |
| 9. Battery                 | 19. Charger                         |
| 10. Battery cover          | 20. Charger LED                     |

## TABLE OF CONTENTS

SPECIFICATIONS .....	Page 1
INTRODUCTION.....	Page 3
ELECTRICAL SAFETY.....	Page 3
GENERAL POWER TOOL SAFETY WARNINGS.....	Page 4
BATTERY & CHARGER SAFETY WARNING.....	Page 6
ADDITIONAL SAFETY WARNINGS FOR LAWN MOWER .....	Page 8
ASSEMBLY.....	Page 10
CHARGING THE BATTERY.....	Page 12
OPERATION.....	Page 13
MAINTENANCE.....	Page 15
SPARE PARTS .....	Page 17
DESCRIPTION OF SYMBOLS .....	Page 17
PACK CONTENTS .....	Page 18
WARRANTY.....	Page 19

## INTRODUCTION

Congratulations on purchasing an Ozito Lithium Ion Cordless Lawn Mower. We aim to provide quality tools at an affordable price. We hope you will enjoy using this tool for many years.

Your Lithium Ion Cordless Lawn Mower LML-036 has been designed for small to medium size lawns and being cordless, it offers maximum convenience of operation without the need for a connection to the mains power. It is intended for DIY (Do It Yourself) use only. It is not built for continuous daily use in a trade or professional capacity.



## ELECTRICAL SAFETY

THIS MANUAL CONTAINS IMPORTANT SAFETY AND OPERATING INSTRUCTIONS FOR YOUR BATTERY CHARGER.

- Before using the charger read all instructions and cautionary markings on the charger, battery pack and the product using the battery pack.

**Danger!** If the battery pack case is cracked or damaged, do not insert it into charger. There is a danger of electric shock or electrocution.



**WARNING!** Do not allow any liquid to get inside charger. Electric shock may result. To facilitate cooling of the battery pack after use, avoid placing the charger or battery pack in a warm environment such as in a metal shed, or an uninsulated trailer.



## GENERAL POWER TOOL SAFETY WARNINGS



**WARNING! Read all safety warnings and all instructions.** Failure to follow the warnings and instructions may result in electric shock, fire and/or serious injury.

**Save all warnings and instructions for future reference.**

The term "power tool" in all of the warnings refers to your mains-operated (corded) power tool or battery-operated (cordless) power tool.

### 1) Work area safety

- a) **Keep work area clean and well lit.** Cluttered or dark areas invite accidents.
- b) **Do not operate power tools in explosive atmospheres, such as in the presence of flammable liquids, gases or dust.** Power tools create sparks which may ignite the dust or fumes.
- c) **Keep children and bystanders away while operating a power tool.** Distractions can cause you to lose control.

### 2) Electrical safety

- a) **Power tool plugs must match the outlet. Never modify the plug in any way. Do not use any adapter plugs with earthed (grounded) power tools.** Unmodified plugs and matching outlets will reduce risk of electric shock.
- b) **Avoid body contact with earthed or grounded surfaces, such as pipes, radiators, ranges and refrigerators.** There is an increased risk of electric shock if your body is earthed or grounded.
- c) **Do not expose power tools to rain or wet conditions.** Water entering a power tool will increase the risk of electric shock.
- d) **Do not abuse the cord. Never use the cord for carrying, pulling or unplugging the power tool. Keep cord away from heat, oil, sharp edges or moving parts.** Damaged or entangled cords increase the risk of electric shock.
- e) **When operating a power tool outdoors, use an extension cord suitable for outdoor use.** Use of a cord suitable for outdoor use reduces the risk of electric shock.
- f) **If operating a power tool in a damp location is unavoidable, use a residual current device (RCD) protected supply.** Use of an RCD reduces the risk of electric shock.

### 3) Personal safety

- a) **Stay alert, watch what you are doing and use common sense when operating a power tool. Do not use a power tool while you are tired or under the influence of drugs, alcohol or medication.** A moment of inattention while operating power tools may result in serious personal injury.
- b) **Use personal protective equipment. Always wear eye protection.** Protective equipment such as dust mask, non-skid safety shoes, hard hat, or hearing protection used for appropriate conditions will reduce personal injuries.
- c) **Prevent unintentional starting. Ensure the switch is in the off-position before connecting to power source and/or battery pack, picking up or carrying the tool.** Carrying power tools with your finger on the switch or energising power tools that have the switch on invites accidents.
- d) **Remove any adjusting key or wrench before turning the power tool on.** A wrench or a key left attached to a rotating part of the power tool may result in personal injury.
- e) **Do not overreach. Keep proper footing and balance at all times.** This enables better control of the power tool in unexpected situations.



## GENERAL POWER TOOL SAFETY WARNINGS

- f) Dress properly. Do not wear loose clothing or jewellery. Keep your hair, clothing and gloves away from moving parts.** Loose clothes, jewellery or long hair can be caught in moving parts.
- g) If devices are provided for the connection of dust extraction and collection facilities, ensure these are connected and properly used.** Use of dust collection can reduce dust-related hazards.
- 4) Power tool use and care**
- a) Do not force the power tool. Use the correct power tool for your application.** The correct power tool will do the job better and safer at the rate for which it was designed.
- b) Do not use the power tool if the switch does not turn it on and off.** Any power tool that cannot be controlled with the switch is dangerous and must be repaired.
- c) Disconnect the plug from the power source and/or the battery pack from the power tool before making any adjustments, changing accessories, or storing power tools.** Such preventive safety measures reduce the risk of starting the power tool accidentally.
- d) Store idle power tools out of the reach of children and do not allow persons unfamiliar with the power tool or these instructions to operate the power tool.** Power tools are dangerous in the hands of untrained users.
- e) Maintain power tools. Check for misalignment or binding of moving parts, breakage of parts and any other condition that may affect the power tool's operation. If damaged, have the power tool repaired before use.** Many accidents are caused by poorly maintained power tools.
- f) Keep cutting tools sharp and clean.** Properly maintained cutting tools with sharp cutting edges are less likely to bind and are easier to control.
- g) Use the power tool, accessories and tool bits etc. in accordance with these instructions, taking into account the working conditions and the work to be performed.** Use of the power tool for operations different from those intended could result in a hazardous situation.
- 5) Battery tool use and care**
- a) Recharge only with the charger specified by the manufacturer.** A charger that is suitable for one type of battery pack may create a risk of fire when used with another battery pack.
- b) Use power tools only with specifically designated battery packs.** Use of any other battery packs may create a risk of injury and fire.
- c) When battery pack is not in use, keep it away from other metal objects, like paper clips, coins, keys, nails, screws or other small metal objects, that can make a connection from one terminal to another.** Shorting the battery terminals together may cause burns or a fire.
- d) Under abusive conditions, liquid may be ejected from the battery; avoid contact. If contact accidentally occurs, flush with water. If liquid contacts eyes, additionally seek medical help.** Liquid ejected from the battery may cause irritation or burns.
- 6) Service**
- a) Have your power tool serviced by a qualified repair person using only identical replacement parts.** This will ensure that the safety of the power tool is maintained.
- b) If the supply cord is damaged, it must be replaced by the manufacturer, its service agent or similarly qualified persons in order to avoid a hazard.**

## LITHIUM BATTERY AND CHARGER SAFETY FEATURES

### **Over charging protection**

This feature ensures that the battery is never overcharged. When the battery has reached its full charge capacity the charger will shut off protecting the internal components of the battery from being damaged.

### **Over discharge protection**

An internal component of the battery pack is an over discharge protector. This feature will stop the battery from discharging beyond the recommended lowest safety voltage.

### **Over heat protection**

The battery has an internal thermister cut off sensor which will cease the charging cycle if the battery becomes hot during the charging process. This thermister sensor will also stop the battery from operating should the battery become too hot during the operation of the tool. This can happen when the tool is overloaded or being used for extended periods of time .

Up to 30min in cooling time may be required depending on ambient temperature and the operation being performed.

### **Over current protection**

Should the battery be overloaded and the maximum current draw be exceeded the battery will temporarily stop working to protect the internal components. The battery will resume normal operation once the excessive current draw has returned to a normal level. This may take a few seconds.

### **Short circuit protection**

If the battery pack was to short circuit the short circuit protector would immediately stop the battery pack from operating. This will prevent further internal components of the battery or the tools becoming damaged.



## LITHIUM ION BATTERY AND CHARGER SAFETY WARNINGS



**WARNING!** Do not allow any liquid to get inside charger. Electric shock may result. To facilitate cooling of the battery pack after use, avoid placing the charger or battery pack in a warm environment such as in a metal shed, or an uninsulated trailer.

- Before using the charger read all instructions and cautionary markings on the charger, battery pack and the product using the battery pack.



**Danger!** If the battery pack case is cracked or damaged, do not insert it into charger. There is a danger of electric shock or electrocution.

1. This charger is not intended for any uses other than charging rechargeable batteries. Any other use may result in risk of fire, electric shock or electrocution.
2. Do not place any object on top of the charger or place the charger on a soft surface that may result in excessive internal heat. Place the charger in a position away from any heat source.
3. To reduce risk of damage to the electric plug and cord, pull by the plug rather than the cord when disconnecting the charger.
4. Make sure the cord is located so that it will not be stepped on, tripped over, or otherwise subjected to damage or stress.
5. An extension cord should not be used unless absolutely necessary. Use of an improper extension cord could result in the risk of fire, electric shock or electrocution.
6. Do not operate the charger if it has received a sharp blow, been dropped or otherwise damaged in any way. Have it checked by an electrician or power tool repairer.
7. Do not disassemble charger. Take it to an electrician or power tool repairer when service or repair is required. Incorrect reassembly may result in a risk of electric shock, electrocution or fire.
8. To reduce risk of electric shock, unplug the charger from the outlet before attempting any cleaning. Removing the battery pack will not reduce this risk.
9. Never attempt to connect 2 chargers together.
10. DO NOT store or use the tool and battery pack in locations where the temperature may reach or exceed 40°C (such as inside sheds or metal buildings in summer).
11. The charger is designed to operate on standard household electrical power (240 volts). Do not attempt to use it on any other voltage!
12. The battery pack is not fully charged out of the carton. First read the safety instructions and then follow the charging notes and procedures.
13. The longest life and best performance can be obtained if the battery pack is charged when the air temperature is between 18 - 24°C. Do not charge the battery pack in an air temperature below 10°C or above 40°C. This is important and will prevent damage to the battery pack.
14. Do not incinerate the battery pack even if it is seriously damaged or is completely worn out. The battery can explode in a fire.
15. Never attempt to open the battery pack for any reason. If the plastic housing of the battery pack breaks or cracks, immediately discontinue use and do not recharge.
16. During charging, the battery must be placed in a well ventilated area.





## ADDITIONAL SAFETY WARNING FOR LAWN MOWERS



**WARNING!** If not used properly this lawn mower can be dangerous! This lawn mower can cause serious injury to the operator and others, the warnings and safety instructions must be followed to ensure reasonable safety and efficiency in using this lawn mower. The operator is responsible for following the warning and safety and instructions in this manual and on the lawn mower. Never use the mower unless the catcher or guards provided by the manufacturer are in the correct position.

### 1) Training

- Read the instructions carefully. Be familiar with the controls and the proper use of the appliance.
- Never allow children or people unfamiliar with these instructions to use the appliance. Local regulations may restrict the age of the operator.
- Never mow while people, especially children, or pets are nearby.
- The operator or user is responsible for accidents or hazards occurring to other people or their property.

### 2) Preparation

- While mowing, always wear substantial footwear and long trousers.
- Do not operate the appliance when barefoot or wearing open sandals.
- Thoroughly inspect the area where the appliance is to be used and remove all stones, sticks, wires, bones, and other foreign objects.
- Before using, always visually inspect to see that the blades, blade bolts and cutter assembly are not worn or damaged. Replace worn or damaged blades and bolts in sets to preserve balance.
- On multi-bladed appliances, take care as rotating one blade can cause other blades to rotate.

### 3) Operation

- Mow only in daylight or in good artificial light.
- Avoid operating the appliance in wet grass, where feasible.
- Always be sure of your footing on slopes.
- Walk, never run.
- For wheeled rotary mowers, mow across the face of slopes, never up and down.
- Exercise extreme caution when changing direction on slopes.
- Do not mow excessively steep slopes.
- Use extreme caution when reversing or pulling the appliance towards you.
- Stop the blade(s) if the appliance has to be tilted for transportation when crossing surfaces other than grass, and when transporting the appliance to and from the area to be mowed.
- Never operate the appliance with defective guards or shields, or without safety devices, for example deflectors and/or grass catchers, in place.



## ADDITIONAL SAFETY WARNING FOR LAWN MOWERS (cont.)

- Switch on the motor according to instructions and with feet well away from the blade(s).
- Do not tilt the appliance when switching on the motor, except if the appliance has to be tilted for starting. In this case, do not tilt it more than absolutely necessary and lift only the part which is away from the operator. Always ensure that both hands are in the operating position before returning the appliance to the ground.
- Do not put hands or feet near or under rotating parts. For rotary mowers, keep clear of the discharge opening at all times.
- Never pick up or carry an appliance while the motor is running.
- Pull the plug from the socket:
  - whenever you leave the machine;
  - before clearing a blockage;
  - before checking, cleaning or working on the appliance;
  - after striking a foreign object. Inspect the appliance for damage and make repairs as necessary;
  - if the appliance starts to vibrate abnormally (check immediately).

### 4) Maintenance and storage

- Keep all nuts, bolts, and screws tight to be sure the appliance is in safe working condition.
- Check the grass catcher frequently for wear or deterioration.
- Replace worn or damaged parts for safety.
- For cylinder mowers, be careful during adjustment of the appliance to prevent entrapment of the fingers between moving blades and fixed parts of the appliance.

## ASSEMBLY

Remove the body of the lawn mower from the packaging using the lifting handle (11) and place on a flat surface (Fig. 1).

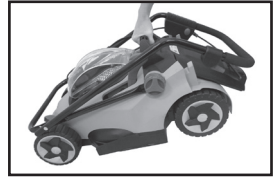

Fig. 1

### Fitting the Upper Handle to the Lower Handles

1. Pull up and back on the upper handle (2) to raise the handles into the operating position.
2. Secure the lower handle with the quick adjustment knob (7) on both sides by aligning the notch and tighten in a clockwise direction (Fig. 2).
3. Secure the upper handle with the tightening of the handle securing knobs (3).

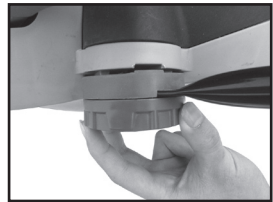

Fig. 2

### Adjusting the height of the upper handle

The upper handle has two height position, to adjust the height

1. Loosen and remove the handle securing knobs (3)
2. Select the appropriate height hole on the lower handle (12). Align the upper handle (2) using either the lower position or higher position (Fig. 3).
3. Place the upper handle (2) over the upper ends of the lower handles (12). Fit the supplied bolts through the outer side of the upper handle (2) and then through the holes in the lower handle (12).
4. Secure in place by screwing the supplied handle securing knobs (3) over the protruding ends of the bolts (Fig. 4).

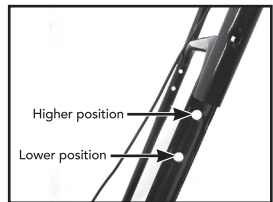

Fig. 3



Fig. 4

## ASSEMBLY (cont.)

### Assembling the Grass Catcher

1. Assemble the two halves of the grass catcher (5) together. Align the two halves and push each individual plastic lug into its opposite location. Start at the rear and work your way forward. Ensure that all the plastic lugs engage correctly with a "Click" together around the entire middle section (Fig. 5).
2. Fasten the two halves of the grass catcher (5) together with the screws located as shown in Fig. 6 on either side.

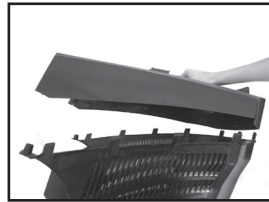

Fig. 5



Fig. 6

### Fitting and removing the grass catcher

The grass catcher (5) must be attached to the two raised hooks on either side of the mower (Fig. 7).

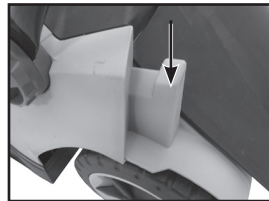

Fig. 7

1. Lift up the grass catcher flap (4) with one hand and guide the grass catcher (5) with your other hand over the two raised hooks on either side of the mower housing (Fig. 8).
2. Lower the grass catcher (5) and allow it to sit in place. Lower the grass catcher flap (4).



Fig. 8



**WARNING! Before performing any maintenance on cleaning, make sure the mower battery and safety key are removed from to avoid accidental starting and possible serious injury.**

After emptying the grass catcher (5) ensure the mowers discharge chute is clear from grass build up before re-assembling the grass catcher (5) onto the mower.

3. To empty the grass catcher (5), lift the grass catcher flap (4) with one hand then lift the grass catcher (5) with the other hand up off the two raised hooks on either side of the mower.

# CHARGING YOUR LITHIUM ION BATTERY

## Battery Charging

The Lawn Mowers' battery (9) has been shipped in a low charge condition, and requires charging prior to use. **Allow several cycles of charging and discharging (through use of the mower) for the battery (9) to reach its optimum performance / Runtime.**

**Caution:** If the battery is too hot or too cold when inserted into the charger, the charging LED (2) will flash red. Charging will automatically begin once the battery reaches to correct charging temperature.

1. Connect the charger into a mains power outlet.
2. The Charger LED (20) will illuminate red showing power is being supplied to the charger (19).
3. With the charger (19) sitting flat on a bench/table, Align the raised ribs on the battery (9) with the recess in the charger (19) and slide onto the charger ensuring a firm connection (see Fig.9).
4. The charger LED (20) will flash green signifying that the battery is charging.
5. A battery takes 3 to 5 hours to become fully charged.
6. The charger LED (20) will illuminate green once the battery is fully charged.



Fig. 9

Charger LED Indicator	
LED Indicator	Situation
RED (illuminated)	Stand By (no battery pack is inserted)
GREEN (Flashing)	Battery is charging
GREEN (Illuminated)	Battery is fully charged
RED (Flashing)	Battery pack is too hot or too cold (charging will begin automatically when battery reaches correct charging temperature).



## Battery Charge Indicator

The Lawn mower battery (9) is equipped with a battery charge indicator (18) to show the state of the battery charge.

- Press the charge indicator button (17).
- Look to see which LED lights (see Fig. 10).



Fig. 10

-  1 green LED indicates that the battery (9) requires immediate charging.
-  2 green LED indicates that the battery (9) has only a low charge and requires charging soon.
-  3 green LED indicates that the battery (9) is fully charged.

**Note:** The battery (9) requires to be removed from the mower to check the state of charge.

# OPERATION

## Inserting the Battery Pack

**Caution:** Before inserting the battery (9) ensure the safety key (15) has been removed to prevent accidental starting and serious injury.

1. Lift the securing latch (16) and lift and hold up the battery cover (10) (Fig. 11).
2. Slide the battery (9) onto the mower by aligning raised ribs on the battery (9) with grooves on the mower. Ensure the latch on the bottom of the battery (9) clicks in place and that it is fully seated and secure. (Fig.12)

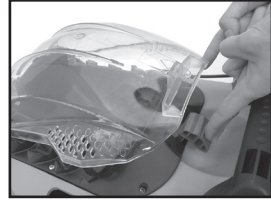

Fig. 11



Fig. 12

3. Insert the safety key (15) as shown (Fig. 13).  
If the mower is not going to be used immediately, do not insert the safety key (15).

**Note:** The safety key (15) must be inserted before the mower can be started.

4. Close the battery cover (10)

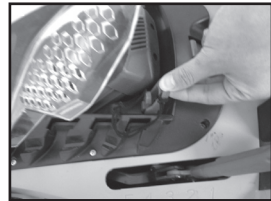

Fig. 13

## Removing the Battery Pack

1. Lift the securing latch (16) and lift and hold up the battery cover (10).
2. Remove the safety key (15).
3. Lift the securing latch (16) and remove the battery (9) (Fig. 14).

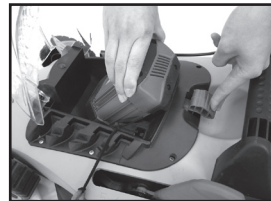

Fig. 14

## Adjusting the cutting height

The height adjustment lever (6) provides 5 cutting heights from 30mm to 80mm.

Pull the height adjustment lever (6) forwards then in to release lever. Adjust until the required cutting height is selected (Fig. 15).

**CAUTION:** Be careful during cutting height adjustments of the lawn mower to prevent entrapment of the fingers between moving height adjustment lever (6) and the mower housing.



Fig. 15

## OPERATION (cont.)

### Switching On/Off

To prevent accidental start up of the motor the mower is fitted with a dual action switch.

1. Press and hold the lock-off button (14) (Fig. 16).



Fig. 16

2. Pull the Start/stop lever (1) towards the handle and then release the lock-off button (14) (Fig 17).

**Note:** There will be a short delay in the motor starting after engaging the start/stop lever (1).

3. Release the start/stop lever (1) to stop the mower.

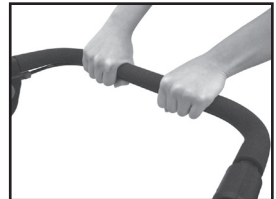

Fig. 17

**Note:** The mower is fitted with a blade brake, this safety feature stops the blade from rotating within a few seconds.

### Mowing Tips

- While using your lawn mower always wear substantial footwear and long trousers.
- Make sure the lawn is clear of sticks, stones, wire and debris; they could be thrown by the blade.
- Before using the lawn mower and after any impact, check for signs of wear or damage and repair as necessary.
- Replace a worn or damaged blade together with the blade bolt to preserve balance.
- **Do Not Overload the Mower.** Mowing long thick grass may cause the motor speed to drop; you will hear a change in the motor sound. If the motor speed drops you may overload your lawn mower, which may cause damage. When mowing in long thick grass first cut with the cutting height set in the highest position, this will help reduce the load. **ALWAYS HANDLE THE BLADE WITH CARE – SHARP EDGES COULD CAUSE SERIOUS INJURY. USE GLOVES.**

# MAINTENANCE



**WARNING!** Always ensure the lawn mower blade has completely stopped, remove safety key (15), battery (9) and grass catcher (5) prior to any maintenance.

## Removing the blade (Fig. 18)

**CAUTION:** ALWAYS HANDLE THE BLADE WITH CARE – SHARP EDGES COULD CAUSE SERIOUS INJURY. USE GLOVES.

1. To remove the blade bolt, hold the blade firmly and with a 16mm spanner (not supplied) loosen the blade bolt by turning it anti-clockwise.
2. Remove the blade bolt, washer and blade.

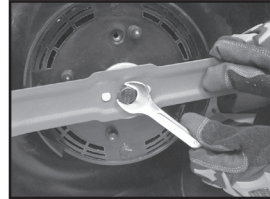

Fig. 18

## Fitting the Blade

1. Place the new blade on the shaft, ensuring the blade is properly seated on the two blade location points of the blade holder. When seated correctly, the blade should be flat against the blade holder
  2. Re-assemble blade bolt with washer through the blade and finger tighten.
  3. Tighten the blade bolt with a 16mm spanner (not supplied), by turning in a clockwise direction. Do not over tighten.
- Check the catcher frequently for wear or deterioration.
  - Replace worn or damaged parts for safety.
  - Only use the replacement blade & blade bolt specified for this product.
  - Be careful during adjustments of the lawn mower to prevent entrapment of the fingers between moving blade and fixed parts of the machine.
  - When not in use, the mower should be stored in a dry, frost-free location, out of reach of children.
  - If the housing of the mower requires cleaning, do not use solvents but a moist soft cloth and brush only.

**Note:** Ozito Industries will not be responsible for any damage or injuries caused by the repair of the tool by an unauthorised person or by mishandling of the tool.



## TROUBLE SHOOTING

<b>Problem</b>	<b>Possible Cause</b>	<b>Solution</b>
Mower is not starting	Possible clogging	Check underneath the mower and clear out as necessary
	Battery is low in charge	Charge battery
	Battery not inserted properly	Insert battery pack correctly
	Grass too long	Raise the cutting height to reduce starting load
	Safety key not inserted correctly	Fit correctly
Mower is hard to push	Height of cut too low	Raise the cutting height
	Cutting blade blunt	Replace the blade
	Possible clogging	Check underneath the mower and clear out as necessary
	Grass too high	Raise the cutting height and walk slower
	Grass is dense	Raise the cutting height, walk slower and cut more frequently
	Wet grass	Wait until the grass dries before mowing
Motor stops while cutting	Height of cut too low	Raise the cutting height
	Battery has no power	Charge battery
Mower is not catching grass properly	Height of cut too low	Raise the cutting height
	Wet grass	Wait until the grass dries before mowing

## SPARE PARTS

Limited spare parts are available subject to availability. Please contact your local Bunnings Special Orders Desk to order the required spare parts.

### Most common spare parts listed below

Spare Part	Part No.
Battery pack (36V Li-Ion)	ACCLB-036
Charger	ACCLC-036

## DESCRIPTION OF SYMBOLS

<b>V</b>	Volts	<b>Hz</b>	Hertz
<b>~</b>	Alternating current	<b>W</b>	Watts
<b>dc/---</b>	Direct current	$\emptyset$	Diameter
<b>mA</b>	Milliamperes	<b>n<sub>o</sub></b>	No load speed
<b>/min</b>	Revolutions or reciprocation per minute		Double insulated
	Electrical Emissions Conformity (EMC)		Charger Energy Rating (MEPS)
	Thermal cut-out protection		Read instruction manual
	Indoor use only		Warning
	Lithium Ion- battery		Do not use or store battery in temperatures exceeding 50°C
	Recycle battery		Do not put in the rubbish
	Do not incinerate		Do not get battery wet
	Always keep the lawnmower on the ground when mowing. Tilting or lifting the lawnmower may cause stones to be thrown out.		
	Keep bystanders away. Do not mow whilst people especially children or pets are in the mowing area.		
	Beware of severing toes or hands. Do not put hands or feet near a rotating blade.		
	Blade continues to rotate after the machine is switched off. Wait until all machine components have completely stopped before touching them.		
	Do not expose the lawn mower or charger to rain.		

## CARING FOR THE ENVIRONMENT



Power tools that are no longer usable should not be disposed of with household waste but in an environmentally friendly way. Please recycle where facilities exist. Check with your local council authority for recycling advice.



Recycling packaging reduces the need for landfill and raw materials. Reuse of recycled material decreases pollution in the environment. Please recycle packaging where facilities exist. Check with your local council authority for recycling advice.

## CONTENTS

- 1 x Cordless Lawn Mower LML-036
- 1 x Battery (36V Lithium Ion)
- 1 x Charger
- 1 x Catcher top
- 1 x Catcher bottom
- 1 x Safety key
- 1 x Instruction manual

## OZITO INDUSTRIES PTY LTD

### **AUSTRALIA (Head Office)**

1 - 23 Letcon Drive, Bangholme, Victoria, Australia 3175

Telephone: 1800 069 486

Facsimile: +61 3 9238 5588

Website: [www.ozito.com.au](http://www.ozito.com.au)

Email: [enquiries@ozito.com.au](mailto:enquiries@ozito.com.au)

# WARRANTY

**YOUR WARRANTY FORM SHOULD BE RETAINED BY YOU AT ALL TIMES. IN ORDER TO MAKE A CLAIM UNDER THIS WARRANTY YOU MUST RETURN THE PRODUCT TO YOUR NEAREST BUNNINGS WAREHOUSE WITH YOUR BUNNINGS REGISTER RECEIPT. PRIOR TO RETURNING YOUR PRODUCT FOR WARRANTY PLEASE TELEPHONE OUR CUSTOMER SERVICE HELPLINE:**

**Australia 1800 069 486  
New Zealand 0508 069 486**

TO ENSURE A SPEEDY RESPONSE PLEASE HAVE THE MODEL NUMBER AND DATE OF PURCHASE AVAILABLE. A CUSTOMER SERVICE REPRESENTATIVE WILL TAKE YOUR CALL AND ANSWER ANY QUESTIONS YOU MAY HAVE RELATING TO THE WARRANTY POLICY OR PROCEDURE.

The benefits provided under this warranty are in addition to other rights and remedies which are available to you at law.

Our goods come with guarantees that cannot be excluded at law. You are entitled to a replacement or refund for a major failure and for compensation for any other reasonably foreseeable loss or damage. You are also entitled to have the goods repaired or replaced if the goods fail to be of acceptable quality and the failure does not amount to a major failure.

Generally you will be responsible for all costs associated with a claim under this warranty, however, where you have suffered any additional direct loss as a result of a defective product you may be able to claim such expenses by contacting our customer service helpline above.

## **2 YEAR REPLACEMENT WARRANTY**

Your product is guaranteed for a period of **24 months from the original date of purchase** and is intended for DIY (Do It Yourself) use only. If a product is defective it will be replaced in accordance with the terms of this warranty. Warranty excludes consumable parts, for example: Blade. Lithium Ion batteries are covered by a 12 month warranty.

## **WARNING**

**The following actions will result in the warranty being void.**

- Professional, Industrial or high frequency use.
- If the tool has been operated on a supply voltage other than that specified on the tool.
- If the tool shows signs of damage or defects caused by or resulting from abuse, accidents or alterations.
- Failure to perform maintenance as set out within the instruction manual.
- If the tool is disassembled or tampered with in any way.

## **OZITO**

Australia/New Zealand (Head Office)  
1-23 Letcon Drive, Bangholme, Victoria, Australia 3175