



wertheim
deep clean engineering



SEgooo

Shampoo Extractor

Congratulations on your purchase of your new Wertheim Steam Mop. Please carefully read this instruction book, and keep it available for future use, so that you may take best advantage of the many useful features of the Wertheim Steam Mop.

BEFORE YOU BEGIN

This product must be operated in accordance with these instructions.

This product is intended for domestic household use only, commercial use will void the manufacturer's warranty.

PLEASE READ THESE INSTRUCTIONS THOROUGHLY.

IMPORTANT SAFETY INSTRUCTIONS

When using your Steam Mop, basic safety precautions should always be observed, including the following:

1. Use indoors only.
2. Do not use machine on hard floors only on carpet and upholstery.
3. Use on hard floor can damage the machine and floor.
4. Do not service machine when it is plugged in.
5. Do not run over supply cord.
6. Do not use machine if the supply cord is damaged.
7. Do not use machine if it has been dropped, damaged, left outdoors or dropped into water.
8. Do not pull or carry by cord, use cord as a handle, close door on cord, pull cord around sharp corners or edges, run appliance over cord, or expose cord to heated surfaces.
9. Do not carry the appliance while in use.
10. Do not unplug by pulling on cord; unplug by grasping plug not the cord.
11. Do not handle plug or appliance with wet hands.
12. Do not put any object into appliance openings, use with blocked opening or restrict air flow.
13. Do not expose hair, loose clothing, fingers or body parts to openings or moving parts.
14. Do not pick up hot or burning objects.
15. Do not pick up flammable or combustible materials (lighter fluid, petrol, kerosene, etc.) or use in the presence of explosive liquids or vapors.
16. Do not use appliance in an enclosed space filled with vapors given off by oil base paint, paint thinner, some moth proofing substances, flammable dust, or other explosive or toxic vapours.
17. Remove plug from electrical outlet before cleaning or maintaining the appliance.
18. Not intended for use by persons (including children) with reduced physical, sensory or mental capabilities, or lack of experience and knowledge, unless they have been given supervision or instruction concerning use of the appliance by a person responsible for their safety.



19. Young children should be supervised to ensure that they do not play with the appliance.
20. Do not pick up toxic material (chlorine bleach, ammonia, drain cleaner, petrol, etc.).
21. Do not modify the Earthed plug.
22. Do not use for any purpose other than described in this User's Guide.
23. Use only manufacturer's recommended attachments.
24. Use only cleaning products formulated by Wertheim for use in this appliance to prevent internal component damage.
25. Keep openings free of dust, lint, hair, etc.
26. Keep appliance on a level surface.
27. Turn off all controls before unplugging.
28. Be extra careful when cleaning stairs.
29. Pay close attention when working around children.

WARNING

This appliance must be earthed.

IMPORTANT

For operation on a 220-240 VOLT A.C. 50/60 Hz power supply only.



SEgooo

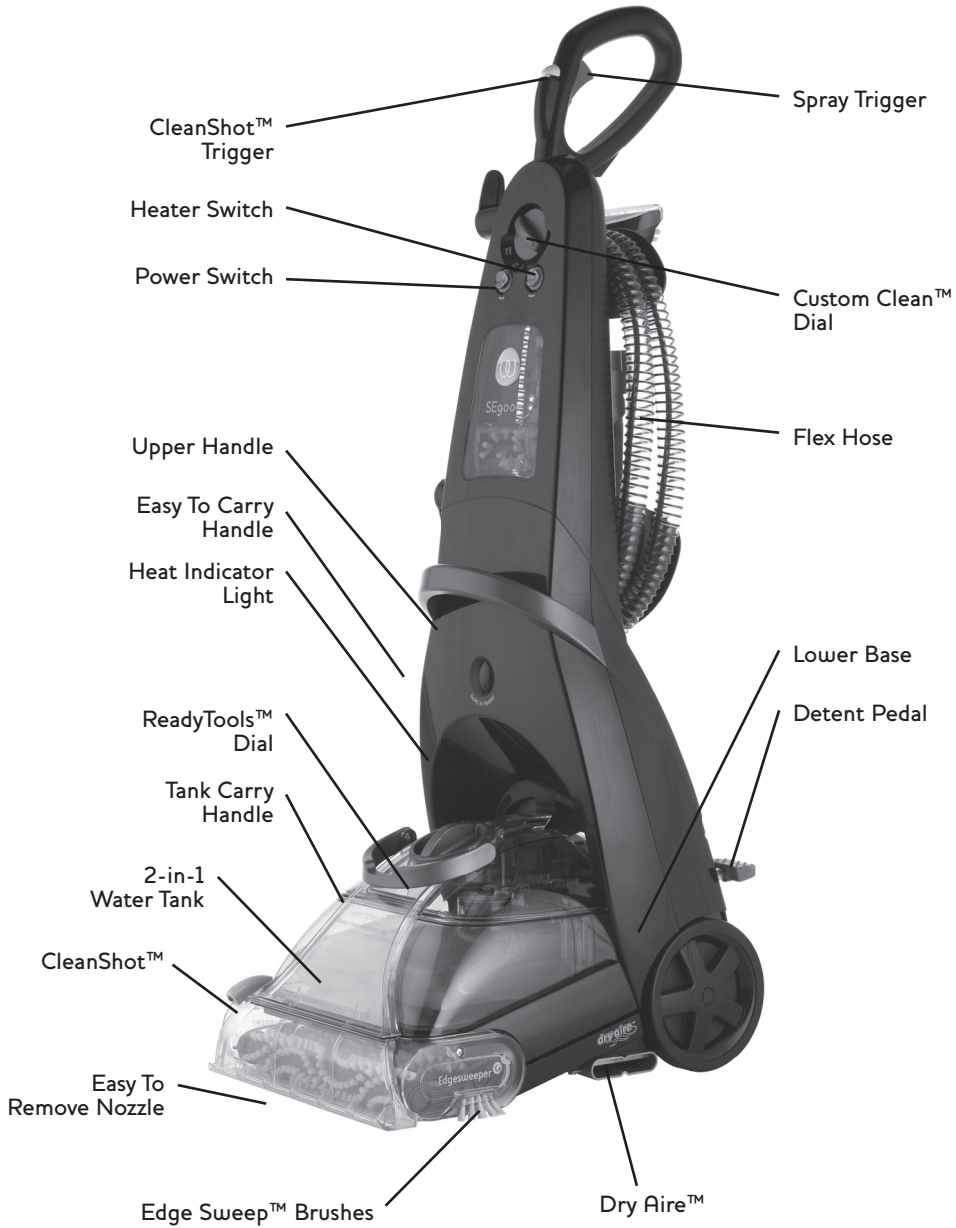



ASSEMBLY

Your SEg000 comes in three, easy to assemble components:

Upper Handle
Lower Handle
Tool Caddy

The only thing you will need to assemble your cleaner is a Phillips head screwdriver.

1. Slide upper handle onto lower handle.
2. Screw 3 screws into the marked holes.
3. Place upper hose rack onto back of upper handle, and secure with tapered screw.
4. Place lower hose rack onto back of upper handle by pushing in and sliding down until it snaps into place.
5. Snap tools into the tool caddy as shown in.
6. Wrap power cord and flex hose as shown in
7. Keep flex hose snugly in place by using the hose secure latch.

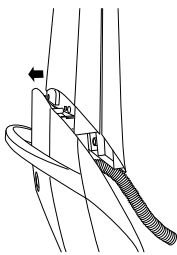

1

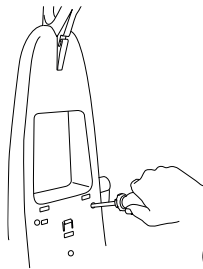

2

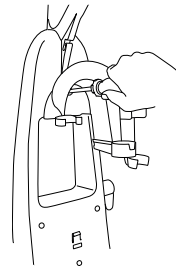

3

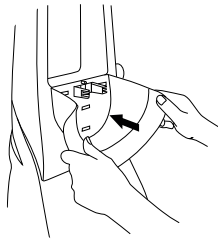

4

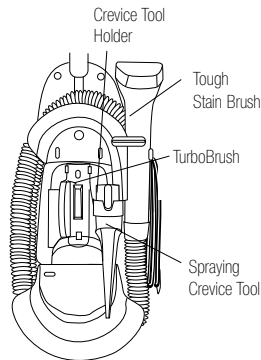

5

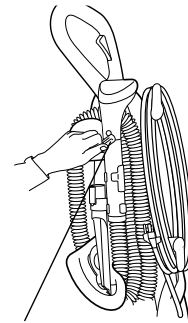

Hose Secure Latch

6



SPECIAL FEATURES

Your Wertheim SE9000 deep cleaner is a home cleaning system that uses the power of heat, brushes and cleaning formula to get the deep down dirt for a maximum clean. Not only does it come with a lot of unique features, it has been designed with you, the customer, in mind.

BUILT-IN-HEATER FEATURE

Wertheim SE9000 models all feature a patented built-in heater which will heat the hot tap water you put in up to 25° deg hotter to safely optimize cleaning effectiveness. The heater will never allow the temperature to exceed 88° deg. The heater switch on the front of the machine controls the heater so you have the option to turn off the heat if you are cleaning delicate wool or oriental rugs.

DUAL DIRTLIFTER™ POWERBRUSHES

The two DirtLifter PowerBrush rolls are designed to enhance cleaning performance. The bristle pattern safely lifts out the deep down dirt while gently grooming carpet fibers. The floating suspension self-adjusts to all carpet heights and protects your carpet if you leave the power switch ON (I). Once the product is in the upright position, the brushes automatically stop spinning. The detent pedal will activate the brushes when floor cleaning.

CUSTOM CLEAN™

The Custom Clean feature automatically mixes hand hot tap water with the Wertheim formula. Simply choose one of the 4 settings (heavy traffic, normal clean, light clean, or water rinse) and the SE9000 will adjust the right amount of cleaning formula to mix with the heated water to fit your cleaning need.

Having a separate formula tank from the water tank also allows no waste of formula. Because the water and formula are stored separately, they are not mixed until you are ready to clean. When your cleaning job is finished, the formula can be stored ready to use in your machine for the next time!

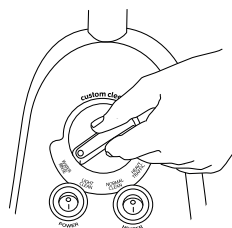

(located on upper handle)

CLEANSHOT™

The CleanShot feature gives you the ability to tackle tough stains with the push of a button. Cleaning formula is sprayed in a concentrated stream, penetrating the stain and allowing for better cleaning focus. Simply spray and suction and the stain is gone! CleanShot is especially effective for spots and stains that would otherwise take a lot of deep cleaning cycles to remove. It allows the cleaning formula and machine to do the work for you.

DRY AIRE™

The Dry Aire system spreads hot air across the carpet to aid in drying. The feature runs while your machine is powered. Heated air is distributed from the bottom and back of the machine and blown across the carpet while you clean!



FLOW GAUGE

The flow gauge is located on the rear cover of your unit and is a convenient performance feedback indicator. The flow gauge will spin when the trigger is depressed and:

- There is liquid in both the clean water tank and the formula tank
- OR
- Custom Clean is set to rinse and there is water in the clean tank.

The flow gauge will stop spinning when:

- The trigger is let go
- The unit runs out of clean water
- The unit runs out of cleaning formula

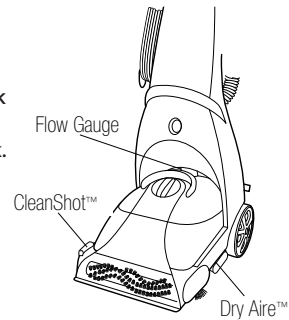

2-IN-1 WATER TANK

Our 2-in-1 water tank full capacity system is designed with a heavy duty bladder inside for clean water. As you clean, the clean water in the bladder will empty and mix with the cleaning formula. Dirty water pulled out of your carpets will collect around the outside of the bladder so that clean and dirty water are always kept separate. This allows the user to maximize tank space, yet only carry one tank to and from the sink for emptying and filling.

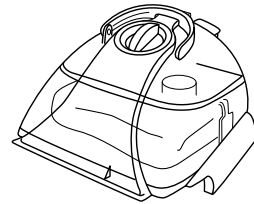

EASY TO REMOVE AND CLEAN NOZZLE

Now, cleaning up your machine after the cleaning process is easier than ever! Simply remove the 2-in-1 water tank and remove the screw to pop out the nozzle for rinsing in the sink. Dirt, loose carpet fibers and remaining pet hair or fuzz get washed away in a snap.

READYTOOLS™ DIAL

This provides either floor cleaning or above floor cleaning with the turn of a knob. If choosing above floor cleaning for upholstery, stairs, or for those creases close to the baseboards, turn knob to “TOOLS” and choose the attachment appropriate for the job. Attach tool to the flex hose and you are ready to go. Be sure to turn knob back to “FLOOR CLEANING” when done.

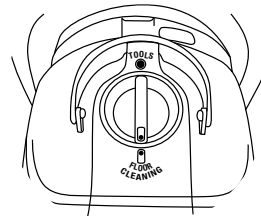

OPERATION

BEFORE YOU CLEAN

1. Plan activities to give your carpet time to dry.
2. Move furniture to another area if cleaning an entire room (optional).
3. Vacuum area with a dry vacuum cleaner thoroughly before deep cleaning.
4. Plan your cleaning route to leave an exit path. It is best to begin cleaning in the corner farthest from your exit
5. Pretreating (optional).

Pretreating is recommended to improve cleaning effectiveness for heavily soiled carpet in high traffic areas such as entry ways and hallways.

CLEANSHOT™

- A. Set Custom Clean for the desired setting.
- B. Press the CleanShot button and aim the focused stream onto the stain. Allow the formula to soak in for 30 seconds.
- C. Run the machine over the stain to extract. Repeat as needed until the stain is gone.
- D. Rinse if desired.

CARPET CLEANING

1. Fill the 2-in-1 water tank. Remove the tank from the base of the machine by lifting up the tank carry handle. Carry like a bucket to the sink.
2. Unlatch the top of the tank from the bottom by lifting up on the tank latch which is located on the back of the tank.
3. Remove the top of the tank by lifting up on the handle. Note how the lip on the top tank separates from the groove in the bottom tank. This placement is important when putting the tank back together.

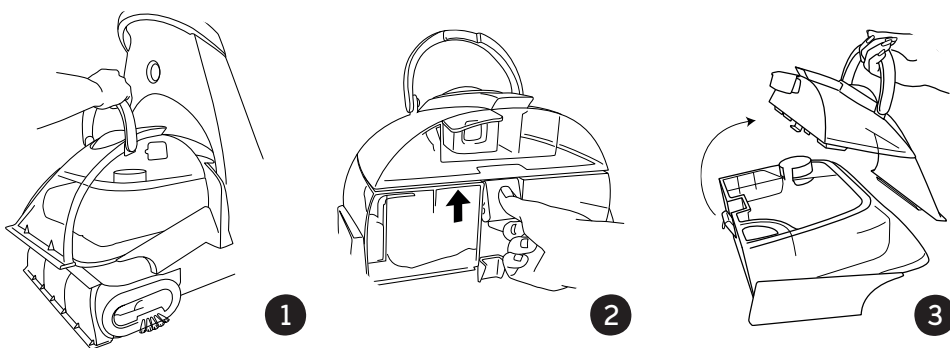

4. Fill the heavy duty bladder with warm (40° deg) water. Do not boil or microwave water as it can destroy the bladder. Destroyed bladder will not be covered by warranty. Do not add detergent or fragrant oils to the bladder can cause damage to the machine and void warranty
5. Leaving the filled bottom of the tank on a flat surface, only maneuver the top of the tank. To attach the top part of the tank to the bottom, carefully hook the lip on the top tank into the groove on the bottom tank.
6. Fasten tanks together by securing the latch in the back. Note: Remember to secure the tank latch in the back and test to make sure it is secure before picking up the tank.

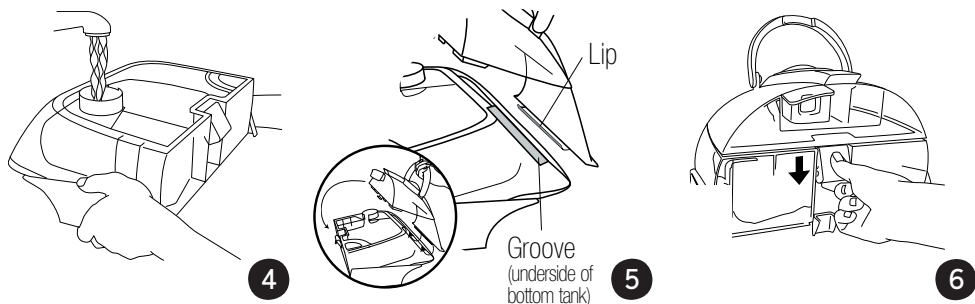

7. Remove formula tank from back of machine.
8. Fill the formula tank by first unscrewing the cap and insert. Always use genuine Wertheim formulas to maximize cleaning and for the safety of your machine. Fill water up to "water line and then fill up to "formula " line with Wertheim Professional Deep Cleaning Advanced Formula. Replace the cap and insert. Place formula tank back into the slot in the back of the machine for a snug fit.
9. Set Custom Clean dial. Simply choose one of the 4 settings (heavy traffic, normal clean, light clean, or water rinse) and the SE9000 will adjust the right amount of cleaning formula to mix with the heated water to fit your cleaning need.



WARNING

To reduce the risk of fire and electric shock due to internal component damage, use only Wertheim cleaning fluids intended for use with the deep cleaner



10. Set ReadyTools dial to the floor cleaning setting.
11. Plug into a proper outlet and turn the power and heater switches to the ON (I) position. Allow 1 minute for the built-in heater to warm-up before cleaning. The SE9000 will be fully warmed and will provide optimal performance after one minute of continuous heated cleaning.
12. Cleaning strokes. While pressing the spray trigger, make one slow forward wet pass and another one back. Let the built-in heater, formula, and DirtLifter PowerBrushes do the work for you.

CAUTION: Do not over-wet. Take care not to run over loose objects or edges of area rugs. Stalling brush may result in premature belt failure.

NOTE: Your machine is equipped with a circuit breaker that will automatically shut off the brush if a large or loose object is caught in the brush roll. If that happens, be sure to unplug your machine, remove the foreign object, and then plug the machine back in to reset the circuit breaker. Release the spray trigger and make one slow forward and backward pass over the same area to remove any residual dirty water and aid in drying. Repeat cleaning passes until solution being pulled up appears clean. Continue passes without pressing the spray trigger until you can't see any more water being pulled up.

13. After cleaning, you may want to turn the Custom Clean dial to rinse to give your carpeting a final water only rinse. This will ensure thorough removal of embedded dirt loosened by the deep cleaning formula. Wertheim deep cleaning formulas contain an anti-resoiling agent that helps your carpets repel dirt and keeps them looking good longer.
14. Remove the tank from the base of the machine by lifting up on the tank carry handle. Carry like a bucket to a utility sink or outside where you will dispose of the dirty water.
15. Unlatch the top of the tank from the bottom by lifting up on the tank latch which is located on the back of the tank.
16. Remove the top of the tank by lifting up on the handle. Note how the lip on the top tank separates from the groove in the bottom tank. This placement is important when putting the tank back together.

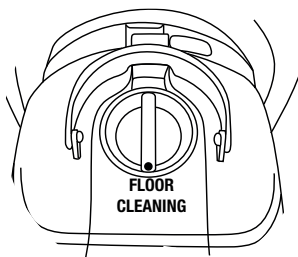

10

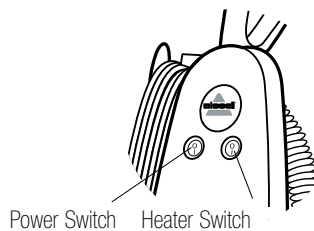

11

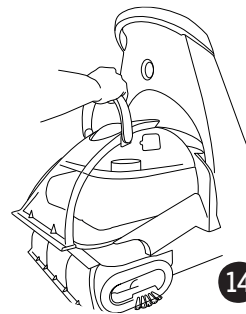

14



17. Lift the bottom portion of the tank; pour out dirty water toward the sink through the triangular shaped opening in the corner of the tank. Note: You may notice hair & debris deposits on the carpet or in the tank that were loosened by the cleaning action (especially with newer carpets that have never been deep cleaned before). This debris should be picked up and thrown away.
18. Fill the heavy duty bladder with hand warm (40°C) tap water, following instructions 4 through 6 on page 10. Note: Remember to secure the tank latch in the back and test to make sure it is secure before picking up the tank. Always check the level of cleaning formula in the formula tank at the same time, and refill as needed.
19. Water rinse (optional). Rinsing is an optional step that can be done during the cleaning process by switching from one of the clean settings on the Custom Clean dial to a water rinse setting, or it can be done after the carpeted area has been cleaned. Simply choose the water rinse setting on the Custom Clean dial, and follow the same path as you did for cleaning, taking care to do a forward (wet) stroke by depressing the spray trigger, a backward (wet) stroke, and a forward and backward (dry) stroke, releasing the spray trigger. Continue this until the water you see coming up the nozzle is clear.
20. CleanShot. CleanShot is an optional feature that can be used to fight tough stains. It can be used as either a tough stain precleaner (see page 9) or can be used during the deep cleaning process itself. To use CleanShot either as a precleaner or during deep cleaning, follow the instructions below.
 - A. Set Custom Clean for the desired setting.
 - B. Press the CleanShot button and aim the focused stream onto the stain. Allow the formula to soak in for 30 seconds.
 - C. Run the machine over the stain to extract. Repeat as needed until the stain is gone.
 - D. Rinse if desired.

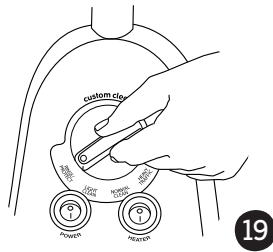
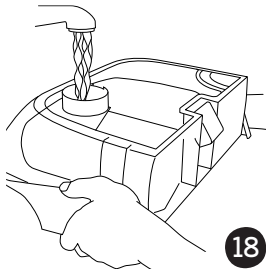
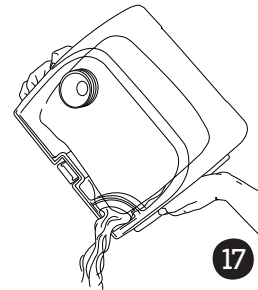
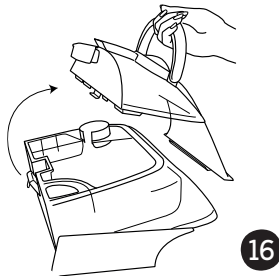
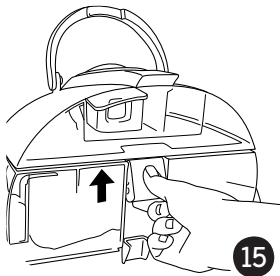

CLEANING WITH ATTACHMENTS

WARNING

To reduce the risk of injury, be extra careful when cleaning stairs.
Make sure machine is secure and level.

Your SE9000 machine comes equipped with a hose and at least one attachment for cleaning stairs, upholstery, and more.

1. Important! If using to clean upholstery, check upholstery tags.
 - A. Check manufacturer's tag before cleaning. "W" or "WS" on the tag means you can use your SE9000. If the tag is coded with an "X" or an "S" (with a diagonal stripe through it), or says "Dry Clean Only", do not proceed with any deep cleaning machine. Do not use on velvet or silk. If manufacturer's tag is missing or not coded, check with your furniture dealer.
 - B. Check for colorfastness in an inconspicuous place.
 - C. If possible, check upholstery stuffing. Colored stuffing may bleed through fabric when wet.
 - D. Plan activities to allow upholstery time to dry.
 - E. Vacuum thoroughly to pick up loose debris and pet hair. Use a vacuum with a brush attachment and a crevice tool to clean in fabric folds.
2. Follow the instructions on pages 10 & 11 for filling the 2-in-1 water tank and the formula tank.
3. Set ReadyTools dial to the hose attachments setting. This will allow spray and suction from the hose.
4. Set Custom Clean dial for heavy traffic, normal clean, light clean, or water rinse as desired.
5. Attach the cleaning tool to the end of the hose.

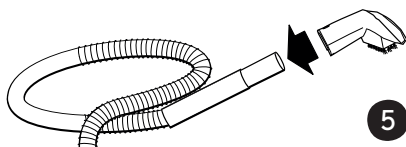

6. Plug in and turn on the power switch and heater (if desired).
7. Clean by pressing the spray trigger to spray solution onto the area to be cleaned. Slowly move the tool back and forth over the soiled surface. Release the spray trigger to suction soiled water. Continue to clean in the area, working in small sections, until no more dirt can be removed. Rinse (optional) and suction as needed.

CAUTION: Do no over-wet

8. Remove and rinse tools in clean, running water. Dry and replace in the tool caddy.



9. It is recommended that you suction clean water from the tap to rinse out the hose.
10. Before replacing lift end of hose and stretch out to ensure all water is cleared from hose.
11. Coil flex hose around the tool caddy.
12. Empty 2-in-1 water tank and rinse out, following the instructions on page 11 & 12.
13. Return ReadyTools dial to floor setting.

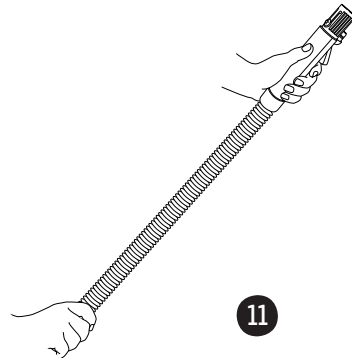
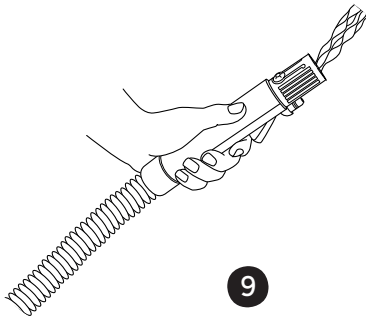

CLEANING FLUID

Keep plenty of genuine Wertheim Advanced Cleaning Formula on hand so you can clean and protect whenever it fits your schedule. Always use genuine Wertheim deep cleaning formulas.



WARNING

To reduce the risk of fire and electric shock due to internal component damage, use only Wertheim cleaning formulas intended for use with the deep cleaner. Non-Wertheim cleaning formulas may harm the machine and void the warranty.



STAIN REMOVAL

Do Not Delay! Attending to an accident soon after it occurs ensures the most optimal clean. Leaving it for an extended period of time may cause it to set and become permanent.

1. Blot up liquids with an absorbent cloth or paper towels. White materials are recommended because certain dyes may bleed and make the stain worse.
2. Gently scrape up any semi-solids with a spoon or spatula. Do not use a knife or other utensil with sharp edges because it could damage the carpet or upholstery.
3. If the area has dried, remove the remaining semi-solids and residue with a sweeper or vacuum.
4. Be sure to test any spot removal formulas in an inconspicuous area first. This is important as some dyes and materials could be damaged or discolored by cleaning solvents. If such a change should occur, try a different solution or call a professional.
5. If cleaning on Berber carpeting, gently run your machine over a hidden area. If no fuzzing occurs, continue cleaning in soiled area.
6. CleanShot. CleanShot is an optional feature that can be used to fight tough stains. It can be used as either a tough stain precleaner (see page 10) or can be used during the deep cleaning process itself. To use CleanShot either as a precleaner or during deep cleaning, follow the instructions below.
 - A. Set Custom Clean for the desired setting.
 - B. Press the CleanShot button and aim the focused stream onto the stain. Allow the formula to soak in for 30 seconds.
 - C. Run the machine over the stain to extract. Repeat as needed until the stain is gone.
 - D. Rinse if desired.
7. Clean using either the FLOOR CLEANING, or TOOLS setting on the ReadyTools dial.



MAINTENANCE & CARE

MACHINE STORAGE

Once your cleaning is complete, make sure the 2-in-1 water tank is emptied, rinsed out, and dried before the next use. The formula tank can remain filled and ready to go, or it can simply be emptied back into the formula bottle if that is more convenient.

NOTE: Store cleaner in a protected, dry area. Since this product uses water, it must not be stored where there is a danger of freezing. Freezing will damage internal components and void the warranty.

WARNING

To reduce the risk of fire, electric shock or injury unplug from outlet before servicing.

MACHINE CARE

For best results, a few simple steps can assure your machine is well maintained after your cleaning is complete.

1. Turn power and heater switches OFF (O). Unplug the machine and wrap the power cord.
2. After emptying the 2-in-1 water tank, rinse it out at a faucet with running hot tap water, taking care to clean underneath the heavy duty bladder, and all around it.
3. The top half of the tank can be rinsed clean through the nozzle area. Also, pop out the red filter underneath the top half of the tank and rinse that out. Replace before putting the top and bottom halves of the tank together.
4. Before you place the cleaned 2-in-1 water tank back onto the machine, simply unscrew the floor nozzle using a Phillips head screwdriver. This can be rinsed out at the faucet. Then replace back onto the machine by starting from the bottom of the nozzle and hooking the tabs into the holes on the bottom sides of the machine. Secure into place with the screw.
5. The inside of the end caps by the brush rolls can be wiped out with a clean paper towel, or, if a more thorough cleaning is desired, the end caps can be taken off using a Phillips head screwdriver and rinsed clean. Replace after cleaning.
6. Any loose hair or debris can be pulled from the brush rolls and thrown away. For the most thorough clean before storage, follow directions on pages 18 & 19 for removal and replacement of the brush rolls and belts.
7. To clean attachments that may have been used, remove from hose and rinse in clean, running water. Dry and replace attachment in the tool caddy. Clean the hose by suctioning clean water from the tap. Before replacing, lift end of hose and stretch out to ensure all water is cleared from hose. Refer to page 14, instructions 9 & 10.
8. After carpet is dry, vacuum again to remove hair and fuzz.

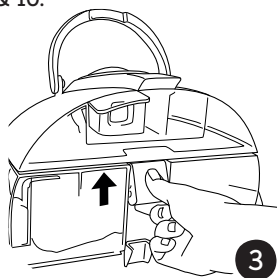

SMALL BELT REMOVAL & REPLACEMENT

Occasional replacement of one or both belts may become necessary. If that is needed, please follow the instructions below.

1. Turn off the machine, and unplug it from the outlet.
2. Remove both the 2-in-1 water tank and the formula tank. Set aside.
3. Unscrew the front nozzle and remove it. Set aside.
4. Turn the machine on its side.

IMPORTANT : Make sure that the cord side is down.

5. Remove the clear end cap by unscrewing the 2 black screws. Take care not to drop the screws into the unit.
6. Remove 1 silver screw.
7. Remove pivot arm by gently lifting up.
8. Remove small brush belt.
9. Replace small brush belt, and reverse steps above.

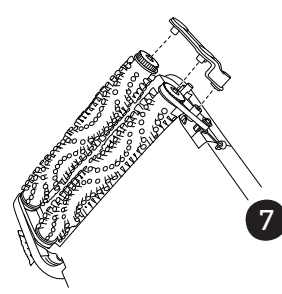
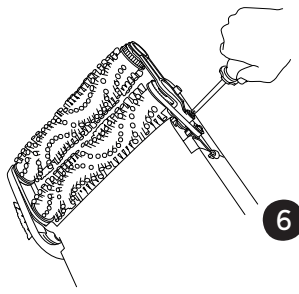
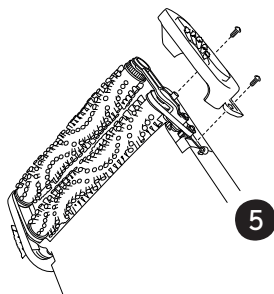
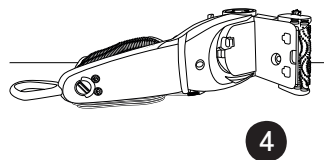
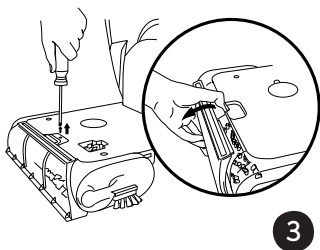
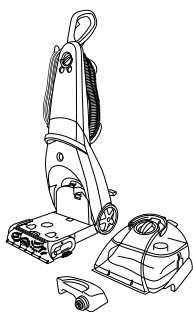

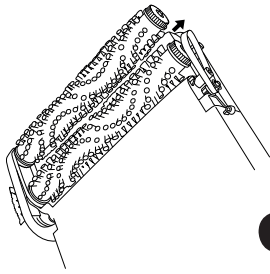

8

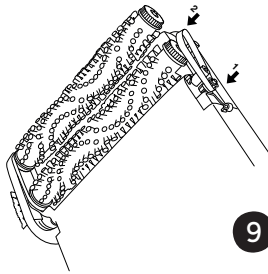

9

BRUSH REMOVAL & LARGE BELT REPLACEMENT

Brushes can be removed for cleaning or replacement as needed.

1. Follow small belt removal Instructions on page 18.
2. Remove brush rolls by pulling them off of the metal rods.
3. Place cleaned or new brush rolls back onto the rods. Make sure one washer is on each end of the rollers prior to sliding onto the rod. Be sure to let the rod slide through the bushing to insure proper fit.
4. Re-attach the long belt on the bottom to the cogs of the small roller brushes.
5. Place small belt over back roller and metal cog.
6. Place pivot arm in place and screw in place using the silver screw.
7. Re-attach clear end cap by tightening with the (2) black screws.
8. Return front nozzle to front of unit, by latching from underneath and then securing with a screw.

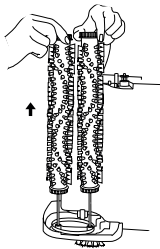

2

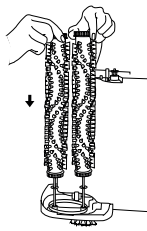

3

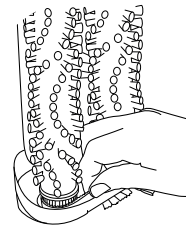

4

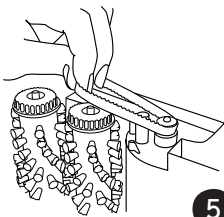

5

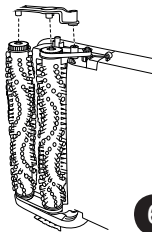

6

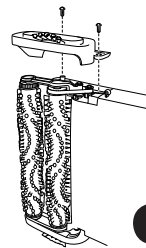

7



PROBLEMS AND TROUBLESHOOTING

Though the product is not out of order, it may not work properly due to inexperienced use of the product or other insignificant reasons. If a minor problem occurs, it usually can be solved quite easily when the cause is found by using the check list below without being assisted by the service center. If your problem continues to resist after checking the lists, please contact your local service center.

PROBLEM	CHECK OFF	POSSIBLE SOLUTION
Built-in heater light does not illuminate	• The heater switch is not turned ON.	• Turn the heater switch ON.
	• The power switch is not turned ON.	• Both switches must be ON to activate the heater ready light.
Reduced Spray or No Spray	• 2-in-1 Water tank may be empty.	• Fill heavy duty bladder with hand hot tap water.
	• Formula tank may be empty	• Fill formula tank with Wertheim Advanced Cleaning Formula for cleaning.
	• 2-in-1 Water tank may not be seated completely.	• Turn power OFF. Remove reseal tank.
	• Pump may have lost prime.	• Turn power OFF and then back ON. Wait one minute, then depress spray trigger.
DirtLifter PowerBrushes do not turn	• The brush belt is off or broken	• Turn power OFF and unplug unit from outlet. Follow instructions on page 18 & 19.
	• The unit is in the upright position.	• Brushes only rotate when the unit is reclined using the detent pedal.
	• Circuit breaker may have tripped.	• Turn the machine OFF and unplug from outlet. Check to see if foreign object is caught in brush roll. Remove object. Plug machine back in to reset circuit breaker.



Cleaner not picking up solution	<ul style="list-style-type: none"> • ReadyTools dial may be at wrong setting. 	<ul style="list-style-type: none"> • Set ReadyTools dial to either FLOOR CLEANING or TOOLS setting.
	<ul style="list-style-type: none"> • 2-in-1 water tank may not be seated properly. 	<ul style="list-style-type: none"> • Pick up both the 2-in-1 water tank and formula tank and reseal them so they fit snugly on the unit.
	<ul style="list-style-type: none"> • 2-in-1 Water tank may not be assembled properly. 	<ul style="list-style-type: none"> • Check to make sure the “lip” of the nozzle is securely hooked into the groove on bottom of Tank (see page 9).
	<ul style="list-style-type: none"> • Solution or 2-in-1 water tank is empty. 	<ul style="list-style-type: none"> • Check fluid levels in heavy duty bladder and formula tank.
	<ul style="list-style-type: none"> • 2-in-1 water tank has picked up maximum dirty water and red float door has closed. 	<ul style="list-style-type: none"> • Empty 2-in-1 water tank. Refill heavy duty bladder with clean hand hot tap water and replace.
	<ul style="list-style-type: none"> • Red float “door” in the tank may have closed as a result of bumping an object or moving machine back and forth too quickly 	<ul style="list-style-type: none"> • Turn the machine OFF, allowing red float door to release into the open position. Turn the unit back ON to continue cleaning. Be sure your forward and backward strokes are done at a slower pace.

Other maintenance or service not included in the manual should be performed by an authorised service representative.



PRODUCT SPECIFICATIONS

MODEL

Rated Voltage

Max. Power Consumption

Weight of Body

Capacity of Water Tank

Duration of Use

Length of Cord

SE9000

220-240V~, 50Hz

1850W

13kg

600mL

Approx. 30min

7m



2 Year GUARANTEE

This guarantee applies in Australia and New Zealand only. For the guarantee in another country, please contact your local retailer/distributor.

Your new Wertheim cleaner which has been fully tested, inspected and adjusted, carries in the case of domestic users, a two year parts and labour guarantee against defects. This product is warranted 90 days for commercial usage.

This cleaner is intended for domestic household use only. Do not use as dry Vacuum machine or on hard floors.

Brushes and filters, unless actually defective in manufacture are not subject to this guarantee since their length of life depends upon usage and care given. Any transportation costs involved in the repair of the appliance or the replacement of a defective part shall be borne by the claimant.

This guarantee commences from the date of purchase of the cleaner.

When properly use and cared for, your new cleaner will render excellent service, and therefore, the purchaser should carefully read the instruction book, as misuse

or failure to follow the instructions makes this guarantee void.

It also becomes void if the product is used on an electric voltage other than that shown on the rating plate.

E.H.A Pty Ltd is unable to accept responsibility under this guarantee for damage from repair work carried out by other than authorised service retailers or centres, or from the use of other than genuine parts.

The guarantee does not apply to the cost of replacing any part of the product due to normal wear at tear, alteration, improper installation, physical abuse, misuse or accident.

In the event of service or advice being needed, please contact your retailer. The benefits conferred by this guarantee are in addition to all other rights and remedies in respect of the product which the consumer has under the Trade Practises Act and other State and Territory laws.

KEEP THIS GUARANTEE AND YOUR RECEIPT AS PROOF OF PURCHASE

Purchase Date/ /.....

Our policy is one of continuous development and accordingly we reserve the right to change specifications without prior knowledge.

e.h.a pty Ltd (ACN 007 539 577)

Locked Bag 120 Silverwater D.C. 1811 NSW





wertheim
deep clean engineering

