



# OWNER'S MANUAL

# DRYER

Please read this manual carefully prior to use.

Keep it for future reference.

Write down model name and serial number of your product.

Have all these details ready when you call for servicing.

RC8011A / RC8011B / RC8011C / RC8011D

TD-C800E / TD-C809E / TD-C8035E

RC8011A1 / RC8011B1 / RC8011C1 / RC8011D1

TD-C803E



P/NO. : MFL32312591

[www.lg.com](http://www.lg.com)

# F eatures



## ● Ultra big Capacity Drum

The Ultra big 8.0kg capacity drum on this LG Dryer allows you to dry your washing in larger loads than ever before

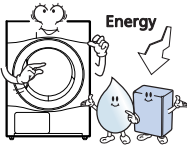

## ● Lower Energy Consumption

LG dryers use less energy than conventional dryers due to the cutting-edge technology we have applied to the drying system and to the heat control mechanism. This LG Dryer has been designed to save you money.

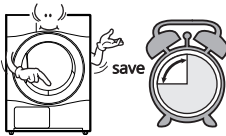

## ● Reduced drying times

Drying times are now shorter due to the efficient air flow mechanism and optimised heater on this LG Dryer.

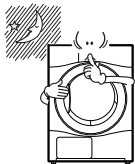

## ● Reduced noise levels

We have reduced the operating noise of this LG Dryer by using innovative sound-absorbing and noise-screening technologies, making it much quieter than conventional dryers.

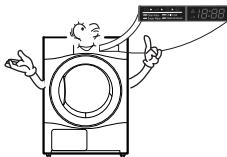

## ● Easy to Use

The wide, electronically controlled LED display on this machine is very easy to use. Simply select the programme you require and your LG Dryer will do the rest.

# C ontents

Safety Instructions .....	3
Installation Instructions .....	6
Appearance & Design .....	10
Operating Your Dryer .....	12
Additional Functions .....	15
Caring for Your Dryer.....	18
Additional Tips for Smart Use .....	21
Troubleshooting Guidelines .....	23
Technical Data .....	25

# Safety Instructions

To help reduce any risk of electric shock, fire, or other personal or property injury when using your dryer, please follow basic safety instructions.

## ⚠ WARNING

Serious injury or death may occur when not observing the following rules.

### ⊘ Not allowed actions.

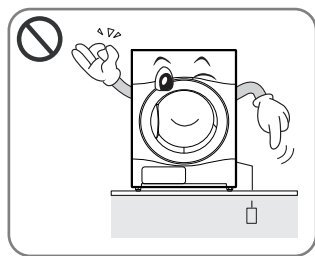

- Before plugging power cord, make sure cord is earthed and connected to circuit breaker.

.....

**No Earthing may cause breakdowns or an electric shock.**

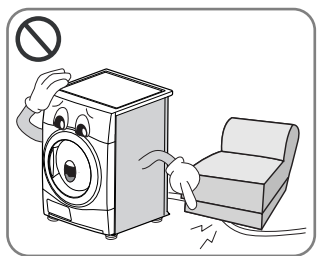

- Do not kink, twist, crush or place heavy objects on power cord. Doing so may damage power cord.

.....

**The damaged power cord may cause a fire or an electric shock.**

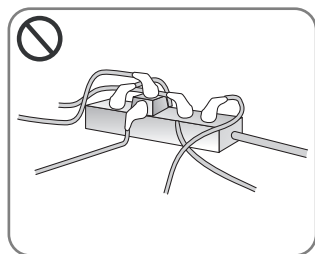

- Do not plug into an adaptor. Do not use an extension lead.

.....

**Abnormal heating of outlet may cause a fire.**

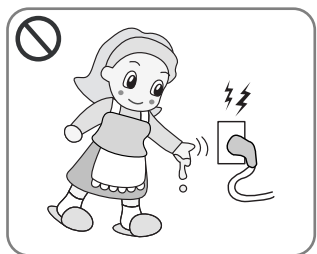

- Do not grasp power cord or switch with wet hands.

.....

**It may cause an electric shock.**

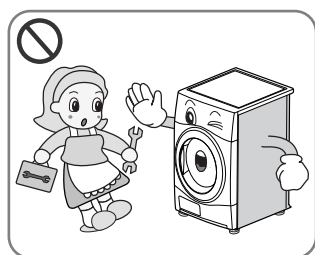

- Do not disassemble the top plate when installing the dryer.

.....

**It may cause breakdowns, a fire or an electric shock.**

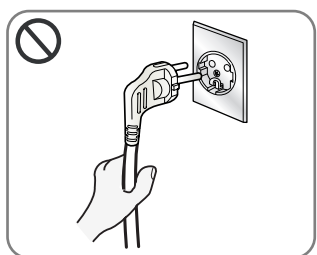

- Disconnect the power cord by grasping the plug, not the cord.

.....

**It may result in the wires becoming loose or breaking. This can lead to a fire or electric shock.**

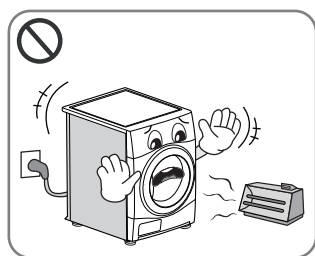

- Keep the dryer away from any external heat source such as heaters, ovens, lit candles etc.

.....

**It may cause melting of some parts or a fire.**

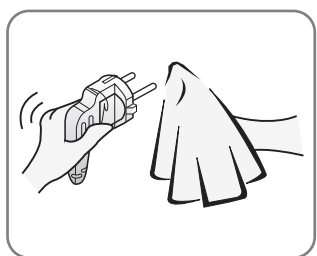

- Wipe out the dirt and stains around the power cord and insert firmly into the socket

.....

**Dirt and poor connection may cause a fire**

# Safety Instructions

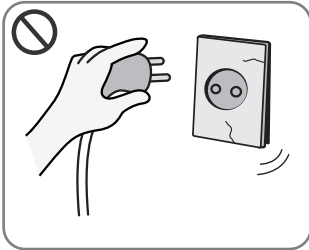

- Do not use damaged power cord, plug and socket.

.....  
**It may cause a fire or an electric shock.**

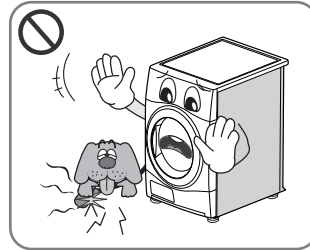

- Prevent pets biting the dryer.

.....  
**Pets may die from an electric shock or the appearance of the washer affected.**

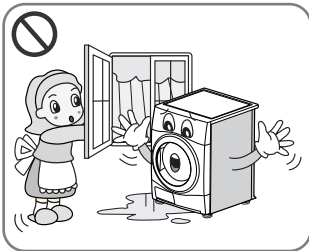

- Do not install or store the dryer where it will be exposed to the weather.

.....  
**It may cause an electric shock, a fire, malfunction or deformation.**

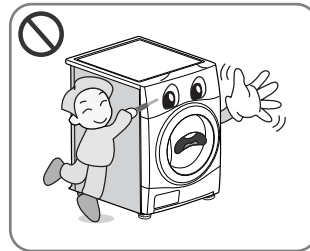

- Do not press the button with sharp edged devices like a screwdriver or a pin.

.....  
**It may cause an electric shock.**

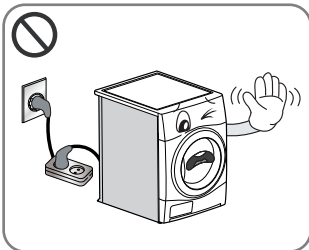

- Do not use an extension cord or an adaptor to connect the power cord.

.....  
**It may cause an electric shock or a fire.**

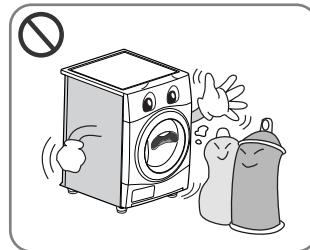

- Do not dry articles that have been cleaned in, washed in, soaked in, or spotted with combustible or explosive substances (such as wax, oil, paint, gasoline, degreasers, dry-cleaning solvents, kerosene, etc.)

.....  
**It may cause an explosion or a fire.**

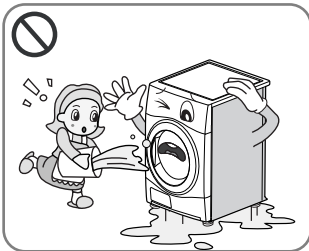

- Do not splash water on to the dryer.

.....  
**It may cause a fire or an electric shock.**

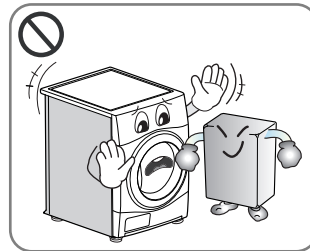

- Do not place flammable items near the dryer.

.....  
**It may cause toxic gas, parts damage, an explosion or a fire.**

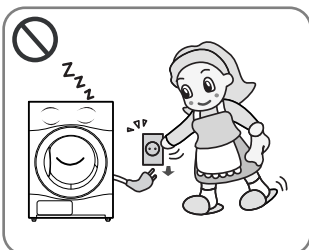

- Unplug the power cord when cleaning or not using the dryer.

.....  
**Water or dirt may cause an electric shock.**

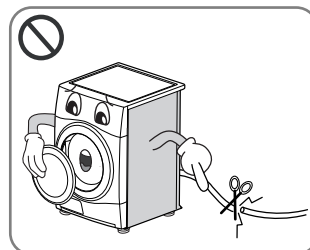

- Before the appliance is removed from service or discarded, disassemble the door and cut off the power cord to prevent any future use.

.....  
**It may cause accidents or physical injuries.**



- Do not allow children or pets to play on or inside the dryer.
- The appliance is not intended for use by young children or infirm persons without supervision.
- Young Children should be supervised to ensure that they do not play with appliance.

.....  
**Children may fall off. Pets or children may be wounded by rotating parts or suffocated inside drum.**

# Safety Instructions

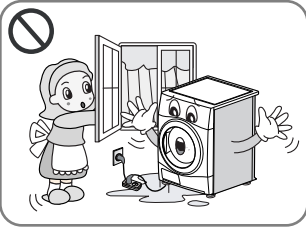

- If this appliance is supplied from a cord extension set or an electrical connector, portable outlet device must be positioned so that it is not subject to splashing or ingress of moisture.

.....  
**It may cause an electric shock, a fire, malfunction and deformation.**

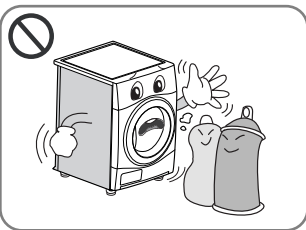

- Items that have been spotted or soaked with vegetable or cooking oil constitute a fire hazard and should not be placed in a tumble dryer
- Items that have been soiled with substances such as cooking oil, acetone, alcohol, petrol, kerosene, spot removers, turpentine, waxes and wax removers should be washed in hot water with an extra amount of detergent before being dried in the tumble dryer.
- Oil-affected items can ignite spontaneously, especially when exposed to heat sources such as in a tumble dryer. The items become warm, causing an oxidation reaction in the oil. Oxidation creates heat. If the heat cannot escape, the items can become hot enough to catch fire. Piling, stacking or storing oil-affected items can prevent heat from escaping and so create a fire hazard.

.....  
**It may cause an explosion and a fire by spontaneous combustion.**

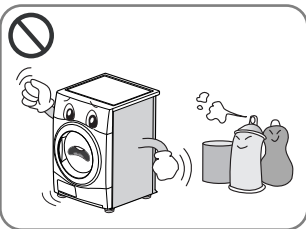

- Items that have been previously cleaned in washed in soaked in or spotted with petrol/gasoline, dry cleaning solvents or other flammable or explosive substances should not be used in a tumble dryer.

.....  
**It may cause an explosion and a fire by spontaneous combustion.**

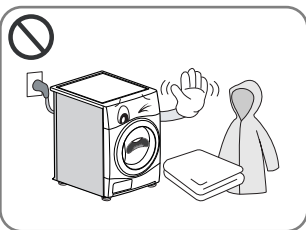

- Items made of foam, rubber, plastic, or other heat-sensitive fabrics (such as bathroom rugs, nonslip mats or raincoats) should not be dried in a tumble dryer on a heat setting.
- Items such as foam rubber (latex foam), shower caps, waterproof textiles, rubber backed articles and clothes or pillows fitted with foam rubber pads should not be dried in the tumble dryer.

.....  
**It may cause an explosion and a fire by spontaneous combustion.**

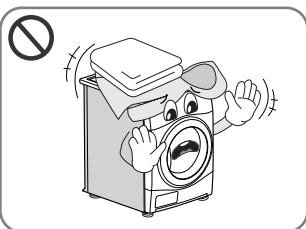

- Plastic articles such as shower caps or waterproof nappy covers should not be placed in a tumble dryer.

.....  
**It may cause an explosion and a fire by spontaneous combustion.**

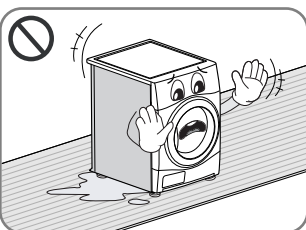

- If the dryer is installed on the carpet, it might be caused some damages by the ventilated air.

.....  
**It may cause an explosion and a fire by spontaneous combustion.**

- Fabric softeners, or similar products, should be used as specified by the fabric softener instructions.

# Installation Instructions

The following instructions will guide you through the initial steps of setting up your dryer. Please note that every section of this manual provides important information regarding the preparation and use of your dryer, and it is important that you review this entire manual before proceeding with any installation or use. Be sure to observe all listed warnings and cautions. These installation instructions are intended for use by qualified installers. Read these installation instructions completely and carefully.

## Safety Information

### Risk of Injury

The dryer is very heavy so you shouldn't try to lift it alone.

Do not lift the dryer by grasping any of the protruding parts e.g. the jog dial or the door. they may break off.

### Risk of Tripping

Risk of tripping caused by hoses hanging down or cables. Ensure there are no loose hoses or cables.

### Check the dryer for damage occurred during transportation.

Do not connect the dryer if it has visible signs of damage.

If you are not confident, contact your local LG agent. Always empty the dryer completely before transporting it.

Your dryer should not be located near gas hob, cooker, heater or eye level grill as flames from the burners could cause damage to your dryer. When the dryer is fitted under a work surface, allow 15 mm space from each side of the dryer for air to exit the rear grille. This airflow is critical to condense the water during drying.

If you use this dryer near or stacked on top of washing machine, separate main plugs and sockets must be used for each appliance. Do not use 2-way adaptor or extension lead.

You can stack the dryer on top of washing machine to save the space. A stacking kit is available from your local shop.

## Stacking Installation Instructions

The LG Dryer can be placed on the top of a front loading washing machine. They MUST be fixed with stacking kit (See the next page). This installation must be conducted by an experienced installer in order to secure robust installation of both washer and dryer. If this work is done carelessly, the dryer may fall off.

More importantly, Different washers require different stacking kits. Please have an experienced installer check the kit.

# Installation Instructions

## Stacking Kit

In order to stack this dryer an LG stacking kit is required.

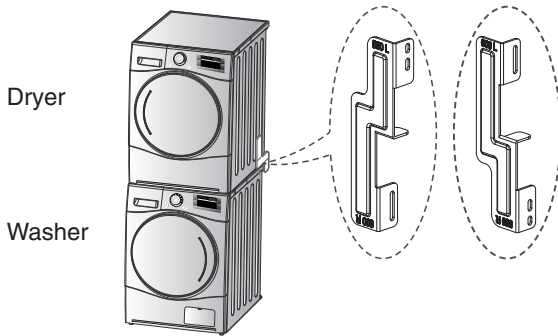

This dryer may only be stacked on top of an LG washer. DO NOT attempt to stack this dryer on any other washer, as damage, injury or property damage could result.

	Washer Top plate size	
	21.7 inch (550mm)	23.6 inch (600mm)
Shape and assembly direction		

## Installation Procedure

1. Place the LG dryer on the LG washing machine.
2. Remove the two screws from the bottom of the rear cover on each side as illustrated below.

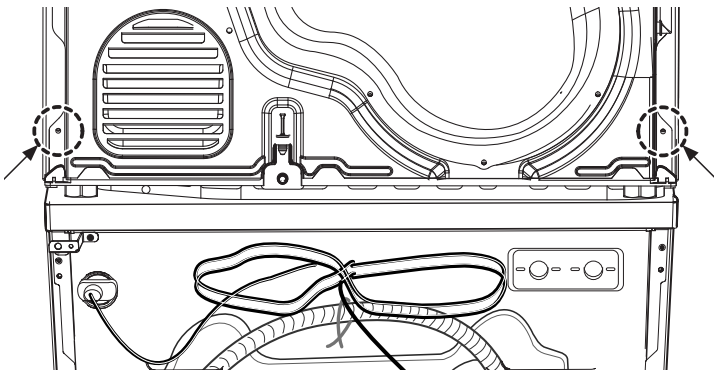

## ⚠ WARNING

- Incorrect installation can cause serious accidents.
- The weight of the dryer and the height of installation makes the stacking procedure too risky for one person. This procedure should be performed by 2 or more experienced service personnel.
- The dryer is not suitable for a built-in installation. Please do not install as a built-in appliance.
- Do not operate if the dryer is disassembled.

3. Align the stacking kit holes and the rear cover holes.

3-1) 23.6 inch(600mm)

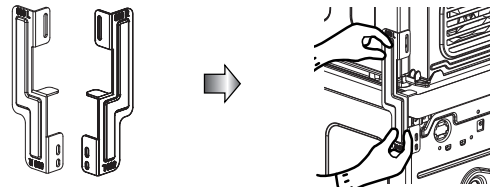

3-2) 21.7 inch(550mm)

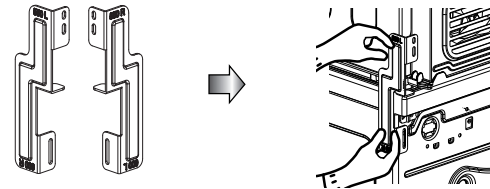

- Fasten the 2 screws that were removed earlier from dryer to stacking kit.
- Use 4 screws in accessory box [0.6inch(16mm)] to assemble washer rear cover and stacking kit.
- The procedure for the opposite side will be the same.

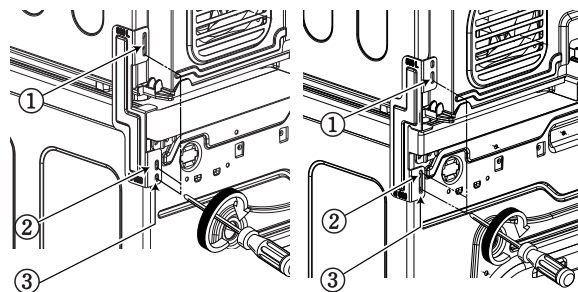

# I nstallation Instructions

## Earthing Instructions

This appliance must be earthed. In the event of malfunction or breakdown, earthing will reduce the risk of electric shock by providing a path of least resistance for the electric current.

This appliance is equipped with a earthed cord and a earthing plug. The plug must be plugged into an appropriate outlet that is properly installed and earthed.

## Additional Grounding Procedure

Some local codes may require a separate ground. In such cases, the required accessory ground wire, clamp and screw must be purchased separately.

## Condensed Water Drain

Can be plumbed directly into the main waste with the adaptor supplied. A Plumber may be required.

## ⚠ CAUTION

### CAUTION Concerning the power cord

Most appliances recommend they be placed upon a dedicated circuit; that is, a single outlet circuit which powers only that appliance and has no additional outlets or branch circuits. Check the specification page of this owner's manual to be certain.

Do not overload wall outlets. Overloaded wall outlets, loose or damaged wall outlets, extension cords, frayed power cords, or damaged or cracked wire insulation are dangerous. Any of these conditions could result in electric shock or fire. Periodically examine the cord of your appliance, and if its appearance indicates damage or deterioration, unplug it, discontinue use of the appliance, and have the cord replaced with an exact replacement part by an authorized servicer.

Protect the power cord from physical or mechanical abuse, such as being twisted, kinked, pinched, closed in a door, or walked upon. Pay particular attention to plugs, wall outlets, and the point where the cord exits the appliance.

## Note

For better drying performance, Please keep the rear of product distance from wall.

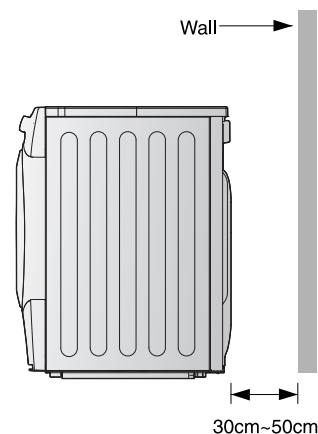



# Installation Instructions

## ● Level the Dryer

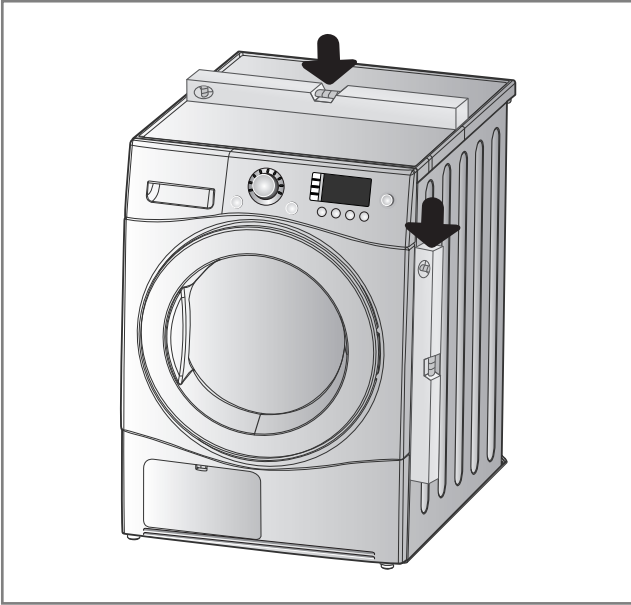

1. Leveling the dryer prevents undesirable noise and vibration. Place your dryer in solid and level Area.

When placing your dryer in an solid and level area where water is not dripping and freezing, flammable materials are not stored.

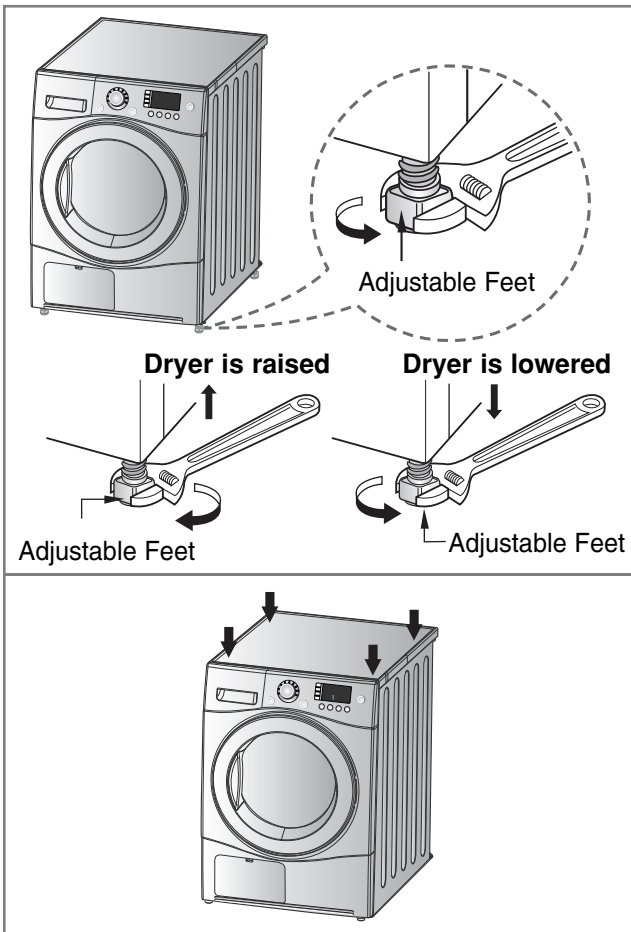

2. If the dryer is not properly level, adjust the front leveling legs up and down as necessary.

Turn them clockwise to raise and counterclockwise to lower until the dryer is not wobbling both front-to-back and side-to-side.

### \* Diagonal Check

*When pushing down the edges of the machine, the machine should not move up and down at all.*

*(Please, check both of two directions)*

*If machine rocks when pushing the machine top plate diagonally, adjust the feet again.*

# Appearance & Design

■ RC8011A / RC8011B / RC8011C / RC8011D / TD-C800E / TD-C809E / TD-C8035E

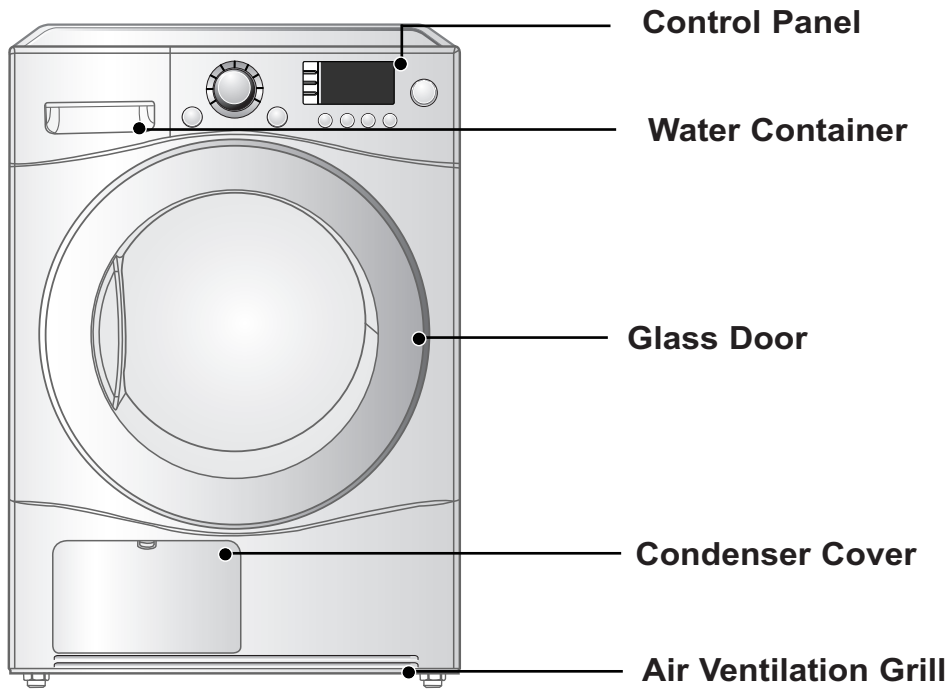

■ RC8011A1 / RC8011B1 / RC8011C1 / RC8011D1 / TD-C803E

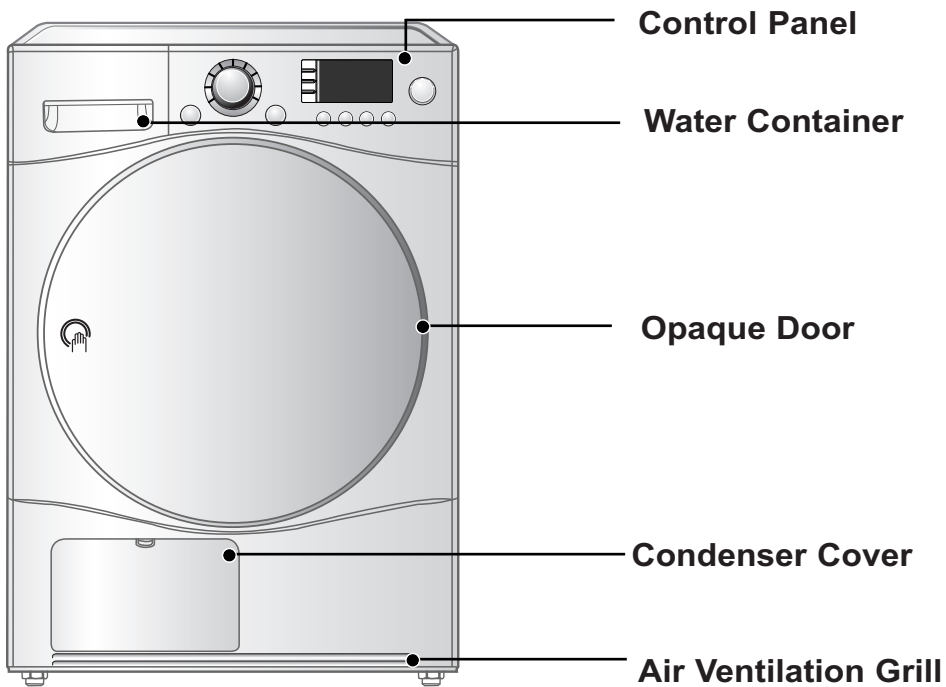

# Appearance & Design

## Control Panel

### RC8011A / RC8011B / RC8011C / RC8011D / TD-C800E

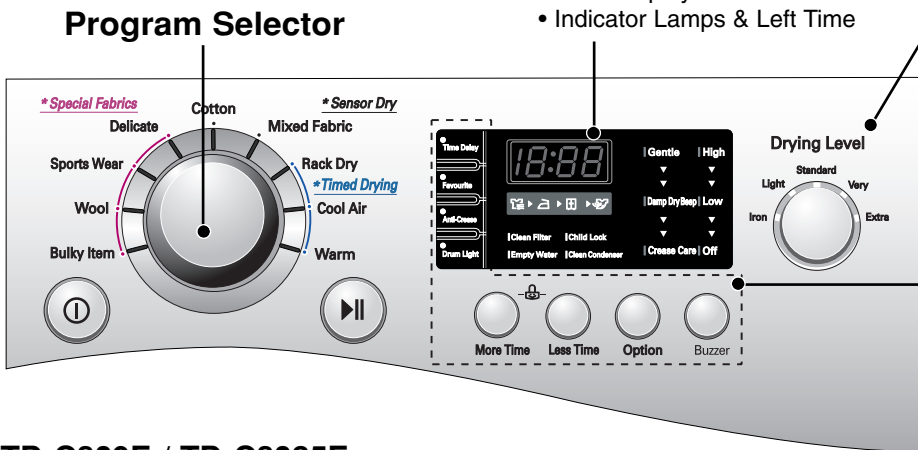

#### LED Display

- Time Display
- Indicator Lamps & Left Time

#### Drying Level

- Iron
- Light
- Standard
- Very
- Extra

#### Additional Function Buttons

- More Time
- Less Time
- Option
- Buzzer
- Time Delay/Favourite
- Anti-Crease/Drum Light

### TD-C809E / TD-C8035E



#### LED Display

- Time Display
- Indicator Lamps & Left Time

#### Drying Level

- Iron
- Light
- Standard
- Very
- Extra

#### Additional Function Buttons

- More Time
- Less Time
- Option
- Buzzer
- Time Delay/Favourite
- Anti-Crease/Drum Light

### RC8011A1 / RC8011B1 / RC8011C1 / RC8011D1 / TD-C803E

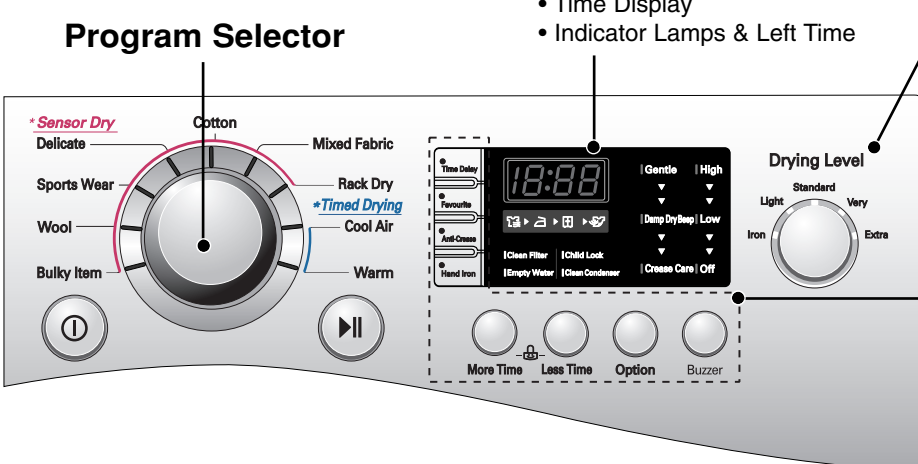

#### LED Display

- Time Display
- Indicator Lamps & Left Time

#### Drying Level

- Iron
- Light
- Standard
- Very
- Extra

#### Additional Function Buttons

- More Time
- Less Time
- Option
- Buzzer
- Time Delay/Favourite
- Anti-Crease/Hand Iron

# Operating Your Dryer

## Cycle Selection Table

Electronic Sensor Dry Course			Drying Level
Cotton Cycles (Note) Select the gentle cycle by pressing the option button for heat-sensitive items	Towels, dressing gowns and bed linen	For thick and quilted fabrics	Extra
	Terry towels, tea towels, towels, bed linen	For thick and quilted fabrics which do not need to be ironed	Very
	Bath towels, tea towels, underwear, cotton socks	For fabrics which do not need to be ironed	Standard
	Sheets, pillowcase, towels	For fabrics which do not need to be ironed	Light
	Bed linen, table linen, towels, T-shirts Polo shirts and work clothes	For fabrics which do need to be ironed	Iron
Mixed Cycles (Note) Select the gentle cycle by pressing the option button for heat-sensitive items	Bed linen, table linen, tracksuits, anorak, blankets	For thick and quilted fabrics which do not need to be ironed	Very
	Shirts, blouses	For fabrics which do not need to be ironed	Standard
	Trousers, dressers, skirts, blouses	For fabrics which do need to be ironed	Iron
Rack Dry	Sweater, Delicate, Fabrics, Sport shoes	For the Fabrics you do not want tumble dry.	-
Special Fabrics Course			
Delicate	Silk, Women's thin clothes, lingerie	For fabrics which are heat-sensitive like synthetic fabrics	-
Sports Wear	Soccer uniform, training wear	For 100% polyester material	-
Wool	Wool	For wool fabrics	-
Bulky Item	Bed clothes, sheets	For bulky items	-
Timed Drying Course			
Cool Air	All fabrics needing freshing, tumbles without heat		-
Warm	Bath towels, bath robes, dishclothes, quilted fabrics made of acrylic	Small clothes & pre-dried laundry normal fabrics using hot temperature	-

### **CAUTION**

If the load is less than 1kg, please use warm programme in timed drying programme.

Wool items should be dried using in "Wool Course" and heat-sensitive fabrics including silk, underwear, lingerie should be dried in Delicate Course.

Please comply with the recommended laundry load when you use the special fabric programme (Refer to the page 21). Otherwise, your clothes may be damaged.

# Operating Your Dryer

## ● Please read before using your LG Dryer for the first time

※ After removing the packaging, please carry out the following checks to ensure the LG Dryer is correctly installed and ready for use.

1. Check the dryer is well balanced by using a spirit level. If not, adjust the feet of the LG Dryer until the machine is balanced.
2. Check the water container, condenser, control panel and drum to make sure everything is in place.
3. Set the machine to dry for 5 minutes to warm up the drum.
4. Open the door between loads the first few times you use the machine to allow any odours from the interior of the LG Dryer to escape.

### 1. Turn the power on.

First, press the “Power” button. The indicator light above the button will become illuminated indicating that the machine is all set to run.

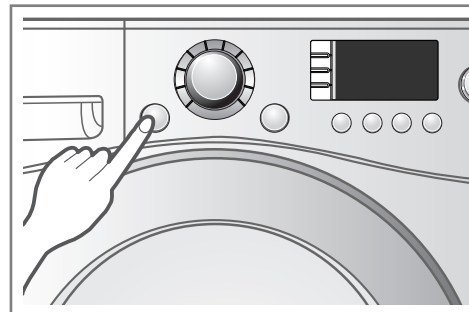

Turn the power on.

### 2. Open the door.

### 3. Check the lint filter, is clean container and condenser.

The lint filter near the door, should be emptied after or before drying operation. Open the door and check if lint filter is cleaned. If not, please clean it referring to page 18. Also check if water container or condenser need to be emptied and cleaned for better drying results.

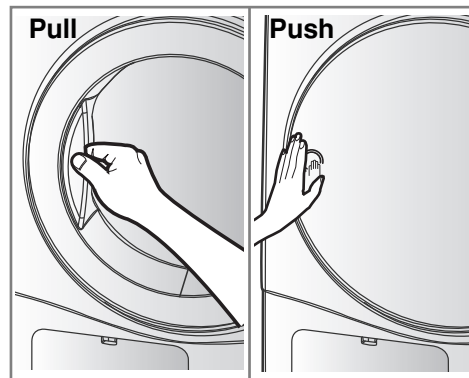

Open the Door.

### 4. Place laundry into the drum after sorting.

The clothes should be sorted by fabric type and dryness level and all the strings and belts of clothes should be well tied and fixed before being put into the drum.

It is desired that you push the laundry to the back to keep it away from the door seal. If not, the door seal and clothes may be damaged.

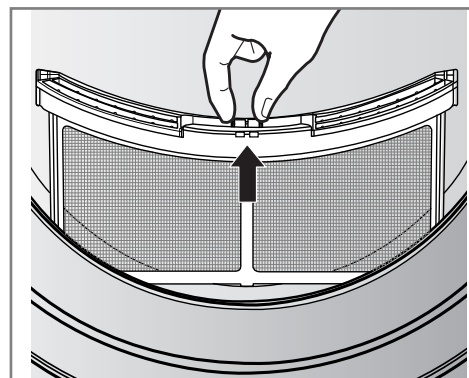

Check the lint filter.

## ⚠ CAUTION

Do not dry unwashed items in the tumble dryer.

# Operating Your Dryer

## 5. Close the door.

Before you close the door, make sure fabrics are well placed inside and that foreign objects, especially flammable ones, are not caught around door.

### ⚠ CAUTION

Be careful not to trap laundry in between the loading door and rubber seal.

## 6. Select the drying cycle you want.

You can choose a cycle by turning the program control knob until the required program is indicated. If you press Start/Pause button without choosing a cycle, the dryer will proceed with the Standard program. [Please refer to following Cycle Selection table (page 12) for the detailed information.

## 7. Press the start button.

You can hear drum rotating.

## 8. After operation is completed, open the door and remove the laundry.

Careful! the drum inside could still be hot. (Operation time varies depending on your cycle selection or options.)

### Note

The final part of a tumble dryer cycle occurs without heat (cool down cycle) to ensure that the items are left at a temperature that ensures that the items will not be damaged.

## 9. Clean the lint filters and empty water container.

The lint filter should be cleaned after each load.

## 10. Turn off the dryer.

Press the "Power" button.

### ⚠ CAUTION

- Be careful of the fact that filter should not be torn when using a vacuum cleaner. If there is a little residue buildup on filter, you can scrub lint screen with the brush to remove.
- If you want to open the door while dryer is operating, please press the Start/Pause button first, wait until drum completely stops and then open the door.

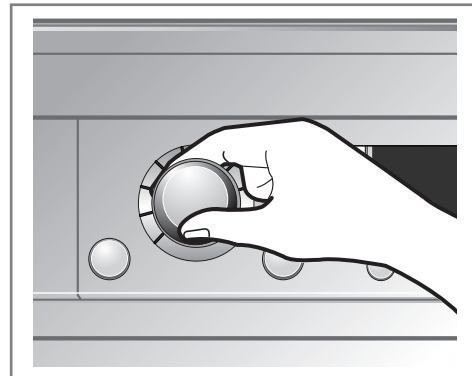

Select the desired cycle.

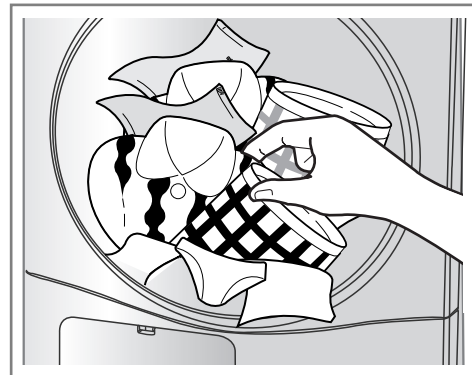

Take out the laundry.

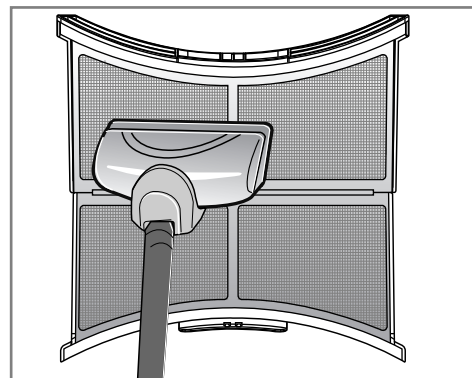

Clean the door lint filter.

### ⚠ WARNING

Never stop a tumble dryer before the end of the drying cycle unless all items are quickly removed and spread out so that the heat is dissipated.

# Additional Functions

## RC8011A / RC8011B / RC8011C / RC8011D / TD-C800E

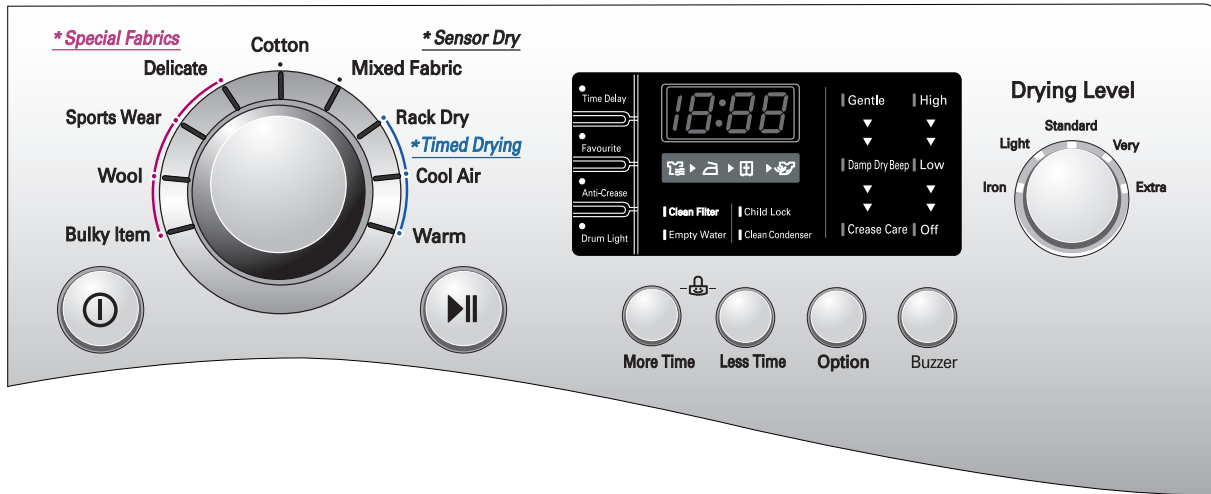

## TD-C809E / TD-C8035E

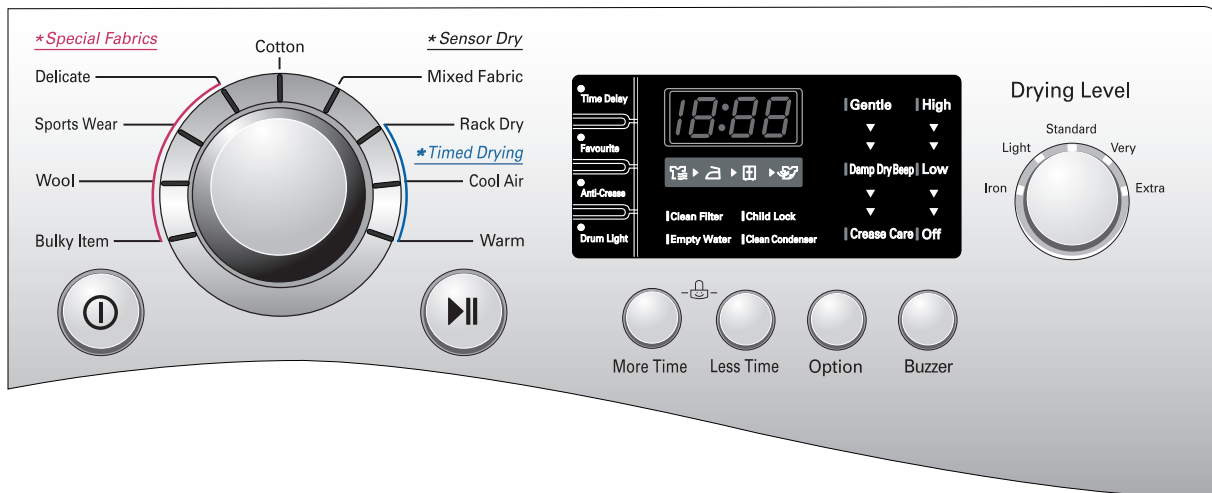

## RC8011A1 / RC8011B1 / RC8011C1 / RC8011D1 / TD-C803E

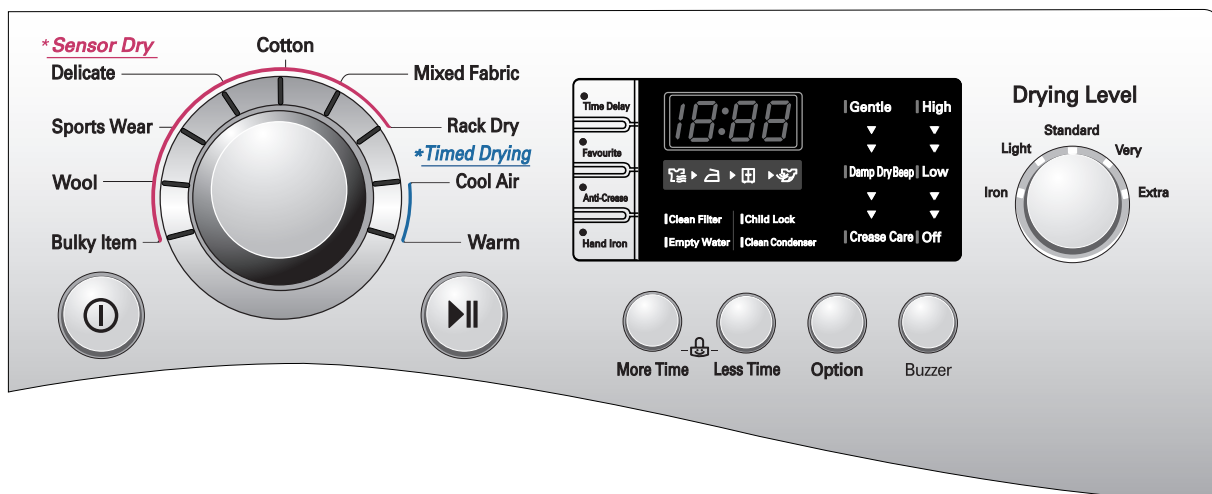

# Additional Functions

## ● Time Delay

You can use the Time Delay function to delay the finishing time of drying cycle.

Maximum Time Delay is 19 hours.

Minimum Time Delay is 3 hours.

1. Turn the dryer on
2. Select cycle
3. Set time delay hour
4. Press Start/Pause button

## ● Favourite

If there is some cycle you would like to make based on your own drying habit, use "Favourite". Once favourite cycle is stored, you can repeatedly use next time before changing the stored setting. For instance, you turn power on and select Extra Dry in Cotton Cycle and Low temp and Anti-Crease in series and then lastly press "Favourite" until the dryer beeps. It's about 3 seconds. That's all you have to do.

The next time, when turning the dryer on and pressing "Favourite" you can see the above options you select displays on the panel.

## ● Anti-Crease

The Anti crease is function to prevent creases and rumples that are formed when the laundry is not unloaded promptly at the end of drying cycle. In this function, the dryer repeatedly runs and pauses to the cycle end.

If the door is open during Anti-Crease process, this function is cancelled.

## ● Drum Light/Hand Iron

### Drum Light (Glass Door)

- During operating cycle, you can see the drum inside by choosing drum light function. It helps easy viewing the drying cycle.

### Hand Iron (Opaque Door)

- This function remains more moist than the condition for ironing.

### Note

This function is available only with Cotton-Iron and Mixed-Iron cycles.

## ● More Time/Less Time

Press More Time or Less Time until the desired drying time is set.

### Note

These buttons are available only with Timed Drying, before you push Start/Pause button.



# Additional Functions

## ● Child Lock ( [L] )

For the safety of your children, press More Time and Less Time buttons at the same time for about 3 seconds. You can see “[L]” sign on LED window.

### Note

For “[L]” off, press More Time and Less Time buttons at the same time for about 3 seconds.

## ● Option

### Gentle

- This is a function to shorten or lengthen the cycle time by increasing or decreasing temperature.
- This option only is used with the Cotton and Mixed Fabrics cycles.

### Damp Dry Beep

- This is a function to inform when is the most suitable for ironing with beeper sound.
- This option only is used with the Cotton and Mixed Fabrics cycles.
- You can not use the ‘Damp Dry Beep’ when you select iron drying level.

### Crease Care

- This is a function to reduce wrinkles.
- This is a function to set up automatically when you only select the Mixed Fabrics cycle, but cancellation is impossible.

### Note

The option might be changed by the number of pressing the option button.

- Once : Gentle is selected.
- Twice : Damp Dry Beep option is selected.
- 3 Times : Gentle and Damp Dry Beep options are selected.
- 4 Times : No selected.

## ● Buzzer

This is a function to able to adjust volume of beeper sound.

# Caring for Your Dryer

## How important care and cleaning is~

It's not very difficult to care for your dryer. All you have to do is to follow the information below.

### Clean Lint Filter

Clean lint filter after each use and check it before each use. It should also be cleaned if the "Clean Filter" light becomes illuminated and the buzzer sounds during operation of the dryer. Cleaning or emptying the filter will reduce drying times and energy consumption and lengthen the dryer life.

#### ⚠ CAUTION

- The lint trap has to be cleaned frequently, if applicable.
- Lint must not be allowed to accumulate around the tumble dryer.

1. Open the door.

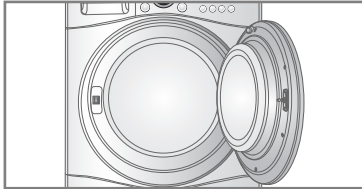

2. Pull the filter out.

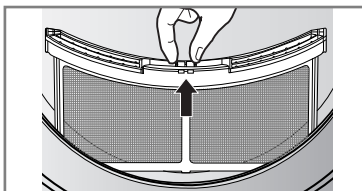

3. Clean the filter by using a vacuum cleaner or rinsing under the tap.

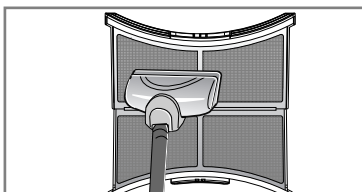

4. Replace the filter.  
- Push the filter all the way down to avoid interference with the door.

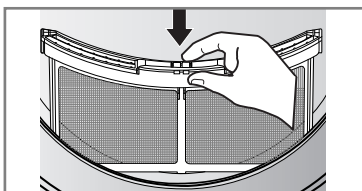

5. Close the door.

#### ⚠ Note

Wash the "Lint Filter" in Clean water.  
Dry thoroughly and replace.

### Clean lint filter during a cycle

If "Clean Filter" indicator lamp flashes during operation, clean the filter promptly.

1. Cool the dryer down and follow the mentioned steps.
2. Press the start/Pause button.

## Empty Water Container

Condensed water is collected to water container

**You should empty the water container after every use.** Not doing this may result in improper drying performance.

If water container is full, "Empty Water" Lamp glows and a buzzer sounds while the dryer is operating. In this case, water container must be emptied in 1 hour

1. Draw water container out.

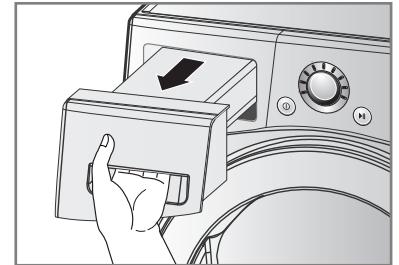

2. Empty water container to sink.

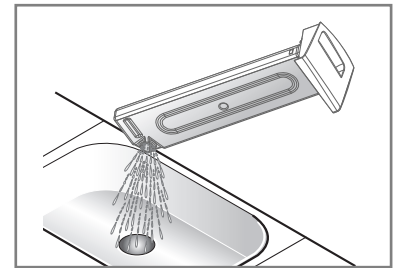

3. Push it back.

4. Press the Start/Pause button.

#### Note

A high surrounding temperature & a small room might increase the drying time as well as energy consumption.

#### ⚠ WARNING

Do not drink the condensed water.

#### ⚠ CAUTION

If the laundry is not spun at high speed, while washing, energy consumption and the Drying time will increase.

In some case, the laundry lamp flashes "Empty Water", then the dryer might stop.

# Caring for Your Dryer

## Condenser

Condenser is also a very important part for efficient drying performance result so it needs a special care from you. It is recommended that condenser be cleaned three or four times a year or when the condenser clean lamp blinks.

1. Push the cap and open the condensing cover.

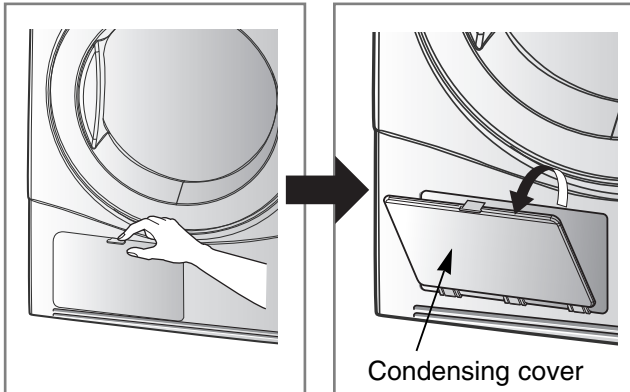

2. Open sealing cover by turning a locking lever.

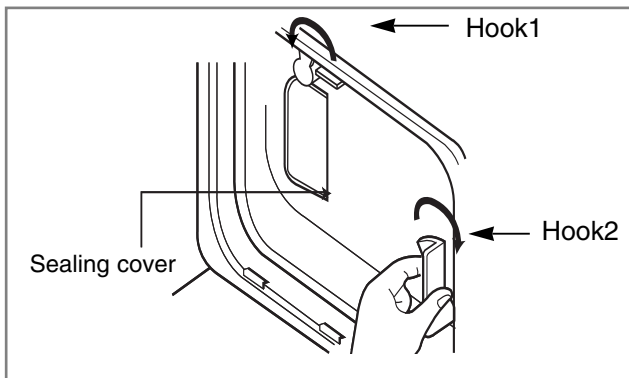

### ⚠ CAUTION

After cleaning the condenser, make sure hooks are closed firmly. Failure to do so may effect control panel with condensation and cause drying inefficiency.

3. Draw the condenser out by inserting a finger into a hole down the front of condenser. (Don't forcefully treat condenser.)

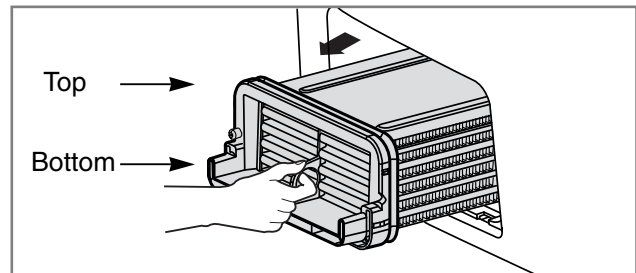

4. Clean the condenser completely under the tap letting water to flow through.

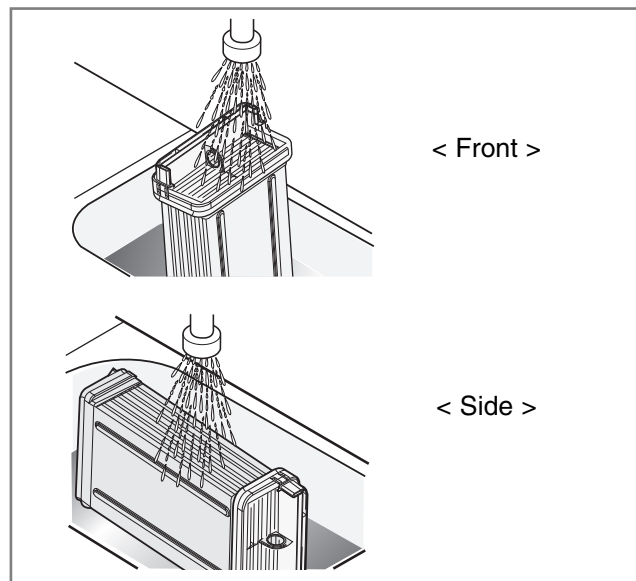

5. Close all with the reverse order of opening.

### ⚠ CAUTION

- Operating when the condenser is clogged with lint can damage the dryer. This also increases energy consumption.
- Do not use sharp objects to clean the heat exchanger. You could damage it an cause leaks.
- Never operate the dryer without the heat exchanger.

# Caring for Your Dryer

## ● Ventilation Grille and Cool Air Inlet Grille

Vacuum the front ventilation grill 3~4 time a year to make sure there must be no build-up of lints or dirt which cause improper intake air flow.

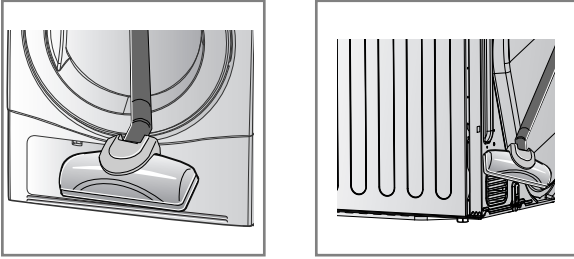

### Note

- The warm air is exhausted through the ventilation grill.
- Adequate ventilation has to be provided to avoid the back flow of gases into the room from appliance's burning other fuels, including open fires.

## ● Condensed Water Drain-out

Normally, condensed water is pumped up to water container where water is collected until emptied. The water container is not the only method, water can be drained out directly to drain hose especially when dryer is stacked on top of washing machine. With connecting kit for drain hose, you can simply change water path and reroute water to the drainage facility. Please follow the below steps.

1. Take connecting kit out.

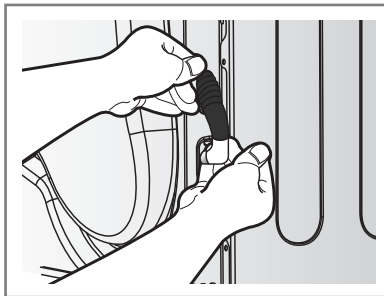

2. Separate water container hose from the kit.

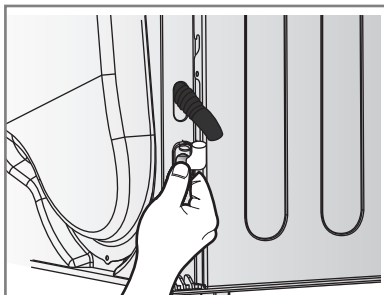

3. Connect drain hose to the kit.

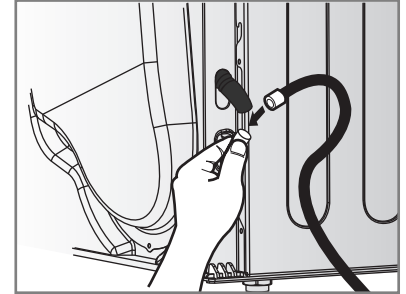

## ● Moisture Sensor?

This device senses the moisture remaining in the contents of the laundry during operation which means it must be cleaned all the time. The main reason for cleaning this part is to remove the build-up of lime scale on the surface of sensor. Wipe the sensors inside drum (Shown in the picture).

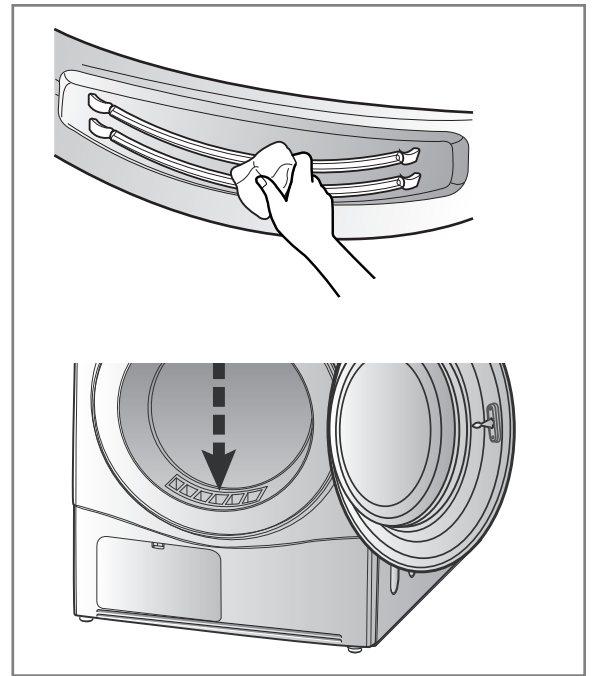

# Additional Tips for Smart Use

## Drying Guide

### Capacity for laundry type

Course		Capacity of Dryer
Cotton	Iron	8kg
	Light	8kg
	Standard	8kg
Mixed Fabric	Standard	4kg
Special Fabrics	Delicate	1.5kg
	Sports Wear	1.5kg
	Wool	1kg
	Bulky Item	1.5kg

### Woolen Article

Dry woolens in "wool" cycle. Be sure to follow fabric care label "symbols", first. Wool is not completely dried from the program so don't repeat drying. Pull woolens to their original shape and dry them flat.

### Woven and Loopknit Materials

Some woven and loopknit materials may shrink, depending on its quality.

### Permanent Press and Synthetics

Do not overload your dryer.

Take out permanent press article as soon as the dryer stops to reduce wrinkles.

### Baby Clothes and Night Gowns

Always check the manufacturer's instructions.

### Rubber and Plastics

Do not dry any items made from or containing rubber or plastics such as:

- Aprons, Bibs and Chair Covers
- Curtains and Table Clothes
- Bathmats

### Fiber Glass

Do not dry fiberglass articles in your dryer.















Glass particles left in the dryer could be picked up by your clothes the next time you use the dryer and irritate your skin.

### Fabric Care Labels

Clothes have its own wash care labels so drying according to wash care labels is recommended. Not only that, the laundry must be sorted according to size and fabric type.

Do not overload in order to save you energy, time and best dry performance.

Below are fabric care labels.

Symbols	Instructions
	Dry
	Tumble dry
	Permanent Press / Wrinkle resistant
	Gentle / Delicate
	Do not tumble dry
	Do not dry
	High heating
	Medium heating
	Low heating
	No heat / air
	Line Dry / hang to dry
	Drip dry
	Dry flat
	In the shade

# Additional Tips for Smart Use

## ● Spare Parts

Spare parts that are required under the terms of warranty are provided free of charge. If the warranty has expired then spare parts must be purchased from the service centre.

## ● Disposal of the Dryer

It is requested that you dispose of your dryer safely to protect children and others from possible injury. The door, lid and other protruding parts must be removed and the power cord should be cut off before safe disposal.

## ● Service Contact

If there is a problem with your dryer, first consult the Trouble Shooting Guide. If you cannot find the error and you are unable to resolve the problem, please contact the Service Centre.

A Customer Service representative will ask you the following questions:

1. Name, address and postcode
2. Phone number
3. Description of problem
4. Model number and serial number of your dryer
5. Date of Purchase

## ● Accessory Parts

- Accessories available for this product

### 1. Dryer Rack (Included)

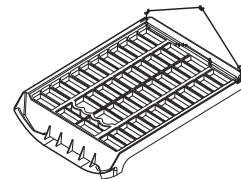

### 2. Condensing Drain Hose and Hose Holder (Purchased Separately)

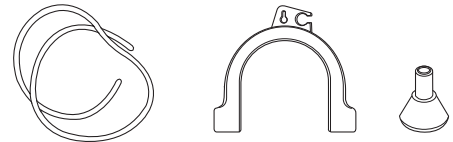

## ● Stacking Kit

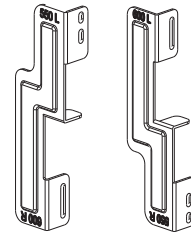

Holder : 2EA, Screw : 4EA

Purchased Separately

- The stacking kit can be used for washer top plate size 550mm and 600mm for both.

**If stacking is needed, you must stack the dryer upon an LG washing machine. A stacking kit is sold separately.**

# Troubleshooting Guidelines

## ● Troubleshooting Tips

To save you time and money, the following page will help answer your questions before service call.

Questions	What to do
<b>Dryer doesn't work</b>	<ol style="list-style-type: none"> <li>1. Check dryer is plugged in.</li> <li>2. Check "Start" button is pressed.</li> <li>3. Check door is properly closed.</li> <li>4. Check Room temperature is above 5°C.</li> <li>5. Check a fuse is not blown or the circuit breaker is tripped and replace them. (Caution : electric dryers generally use two fuses or breakers) After emptying the water container and Cleaning filter during operation, you must press Start button, then the dryer operates again.</li> </ol>
<b>It takes a long time to dry</b>	<ol style="list-style-type: none"> <li>1. Filter should be cleaned after each load.</li> <li>2. Check water container is emptied.</li> <li>3. Check cleanness of condenser.</li> <li>4. Check to select correct program setting for fabric type.</li> <li>5. Check air ventilation grille or rear vents of the dryer are not obstructed.</li> <li>6. Check the clothes are not "excessively wet".</li> <li>7. Check the correct program is selected.</li> <li>8. Check dryer is not overloaded.</li> </ol>
<b>"Clean Filter" lamp flashes</b>	<ol style="list-style-type: none"> <li>1. Check filter is cleaned.</li> <li>2. Check condenser unit is clogged.</li> </ol>
<b>Clothes are covered in Fluff</b>	<ol style="list-style-type: none"> <li>1. Check lint filter is empty.</li> <li>2. Check dryer has only clean items.</li> <li>3. Check laundry is properly sorted in the drum.</li> <li>4. Check laundry is not overloaded.</li> <li>5. Check if there is any paper, tissue, or similar item in the pockets of laundry.</li> </ol>
<b>The drying time is not consistent</b>	The drying time for a load will vary depending on the heat setting, the size of the load, the type of fabrics, the wetness of the clothes and the condition of the lint filter.
<b>Water is leaking</b>	Check the door and sealing cover is not dirty and damaged.
<b>The clothes are wrinkled</b>	Check the laundry is not overloaded. Try a shorter drying time and remove items while they still retain a slight amount moisture.
<b>The clothes shrank</b>	To avoid shrinkage, please carefully follow the care and use instructions for your garment, because some fabrics will naturally shrink when washed. Other fabrics can be washed but will shrink when dried in a dryer.

# Troubleshooting Guidelines

---

## ● Error Mode

- $dE$  : LED displays “ $dE$ ” in case of the door open. The door must be closed and start Button must be pressed for re-operation.
- $EE1, EE3$  : If display errors continue to occur, unplug the power cords and then call the Service Center.

## ● Drum light does not work

- Call customer service



# Technical Data

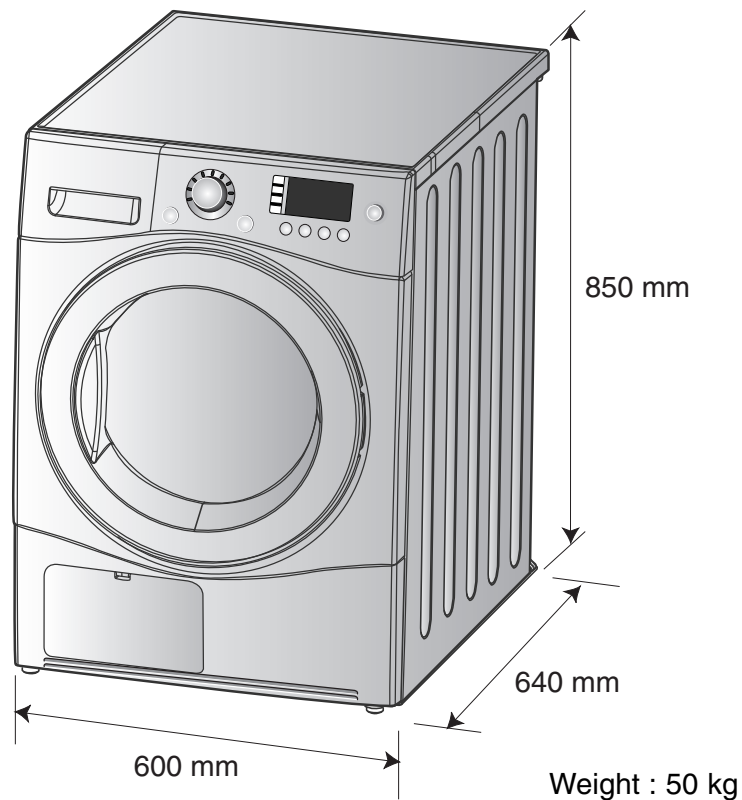

## Electrical Requirements

	Volts	Hertz	Watts
Australia, New Zealand	220-240 V	50 Hz	2250 W

You are sure to check the rating plate on the dryer to make sure the dryer has right rating.

	Alcove or Under Counter	Closet
Sides	1 inch (2.5cm)	1 inch (2.5cm)
Top	0mm	0mm
Rear	5 inch (12.7cm)	5 inch (12.7cm)

## Ventilation Requirement

Alcove or under counter	Closet
Ensure air flow of 112 cu.ft./min through dryer	Closet door must have 2(louvered) openings, each having a minimum area of 60 sq. inches (387 sq.cm), located 3 inches (8 cm) from bottom and top of door.

# T echnical Data

---

## ■ What is not covered.

Service trips to your home to instruct you on the product.

If the product is connected to any voltage other than that shown on the rating plate.

If the fault is caused by accidents, neglects, misuses or Acts of God.

If the fault is caused by reasons except for normal domestic use or use in accordance with the owner's manual.

If the fault is caused by pests, for example, rats or cockroaches etc..

Noise or vibration that is considered normal, for example, water drain sound, spin sound or warning beeps.

Correcting the installation for example, leveling the product, adjustment of drain.

Normal maintenance recommended by the owner's manual.

Removal of foreign objects/substances from the machine including the pump and inlet hose filter, for example, grit, nails, bra wires and buttons etc..

Replace fuses, correct wiring or plumbing within the house.

Correction of unauthorized repairs.

Incidental or consequential damage to personal property caused by possible defects with this appliance.

If this product is used for commercial purposes, it is not warranted.

(Example: Public places such as public bathroom, lodging house, training center, dormitory)

If the product is installed outside the normal service area, any cost of transportation involved in the repair of the products, or the replacement of a defective part, shall be borne by the owner.

# Memo

---

